



Copyright © 2017. RolliBot, LLC. All Rights Reserved



# ROLLICOOL™ MINI-SPLIT AIR CONDITIONER



## USER MANUAL

SAVE THIS MANUAL FOR FUTURE REFERENCE



Important: Do not disassemble the Product. Disassembling the Product will void this Warranty. Only WP or a party expressly authorized by WP should perform service on this Product.

DISCLAIMER OF WARRANTY: THE REMEDIES DESCRIBED ABOVE ARE YOUR SOLE AND EXCLUSIVE REMEDIES AND OUR ENTIRE LIABILITY FOR ANY BREACH OF THIS LIMITED WARRANTY. OUR LIABILITY SHALL UNDER NO CIRCUMSTANCES EXCEED THE ACTUAL AMOUNT PAID BY YOU FOR THE DEFECTIVE PRODUCT, NOR SHALL WE UNDER ANY CIRCUMSTANCES BE LIABLE FOR ANY CONSEQUENTIAL, INCIDENTAL, SPECIAL OR PUNITIVE DAMAGES OR LOSSES, WHETHER DIRECT OR INDIRECT.

SOME STATES DO NOT ALLOW THE EXCLUSION OR LIMITATION OF INCIDENTAL OR CONSEQUENTIAL DAMAGES, SO THE ABOVE LIMITATION OR EXCLUSION MAY NOT APPLY TO YOU.

THE DURATION AND REMEDIES OF ALL IMPLIED WARRANTIES, INCLUDING WITHOUT LIMITATION THE WARRANTIES OF MERCHANTABILITY AND FITNESS FOR A PARTICULAR PURPOSE ARE LIMITED TO THE DURATION OF THIS EXPRESS LIMITED WARRANTY

### FCC STATEMENT :

This device complies with Part 15 of the FCC Rules. Operation is subject to the following two conditions:

(1) This device may not cause harmful interference, and (2) This device must accept any interference received, including interference that may cause undesired operation.

**Warning:** Changes or modifications not expressly approved by the party responsible for compliance could void the user's authority to operate the equipment.

NOTE: This equipment has been tested and found to comply with the limits for a Class B digital device, pursuant to Part 15 of the FCC Rules. These limits are designed to provide reasonable protection against harmful interference in a residential installation. This equipment generates uses and can radiate radio frequency energy and, if not installed and used in accordance with the instructions, may cause harmful interference to radio communications. However, there is no guarantee that interference will not occur in a particular installation. If this equipment does cause harmful interference to radio or television reception, which can be determined by turning the equipment off and on, the user is encouraged to try to correct the interference by one or more of the following measures:

Reorient or relocate the receiving antenna.

Increase the separation between the equipment and receiver.

Connect the equipment into an outlet on a circuit different from that to which the receiver is connected.

Consult the dealer or an experienced radio/TV technician for help.

### FCC Radiation Exposure Statement

This equipment complies with FCC radiation exposure limits set forth for an uncontrolled environment. This equipment should be installed and operated with minimum distance 20cm between the radiator & your body



[www.rollibot.com](http://www.rollibot.com)

Customer Service: 1-844-585-6295

## Section 8. Warranty

### 8.1 – Violation

The RolliCool Mini-Split Air Conditioner cannot be repaired or serviced within its warranty period if any of the following has occurred:

- The warranty has expired
- Damage occurred during or in relation to non-routine and/or unauthorized disassembly
- Failure to provide a valid proof of purchase when requesting service or repair
- Damage occurred as a result of natural disaster etc.
- Damage occurred due to unexpected factors or man-made reasons (including mis-operation, fluid found in any openings, improper insertion or pulling, hauling, bumping, improper voltage input and others)

### 8.2 – Information

#### ONE YEAR LIMITED HARDWARE WARRANTY

Your RolliCool Mini-Split Air Conditioner (“Product”) includes a One Year Limited Hardware Warranty (“Warranty”). The Warranty covers product defects in materials and workmanship under normal use. This Warranty is limited to residents of the United States and Canada only and is available only to original purchasers. This Warranty gives you specific legal rights, and you may also have other rights which vary from state to state.

This Warranty starts on the date of your purchase and lasts for one year (the “Warranty Period”). The Warranty Period is not extended if the Product is repaired or replaced. We may change the availability of this limited warranty at our discretion, but any changes will not be retroactive.

Warranty services are provided by Warranty Pro (“WP”). If a hardware defect arises and a valid claim is received within the Warranty Period, at its option and to the extent permitted by law, WP will: (1) repair the hardware defect by using new or refurbished parts that are equivalent to new in performance and reliability; or (2) exchange the Product with a product that is new or refurbished which is substantially equivalent to the original product. This Warranty is for one replacement only of like-items and does not cover items out of production if the product is no longer made or stocked. This Warranty is not assignable or transferable. The original purchaser may call WP’s toll-free number at 1-844-585-6295 for a service request.

When a product or part is exchanged, any replacement item becomes your property, and the replaced item becomes WP’s property. This warranty only covers technical hardware defectiveness during the warranty period and under normal use conditions. WP does not warrant uninterrupted or error-free operation of this Product.

This Warranty does not cover any damage due to: (a) transportation; (b) storage; (c) improper use; (d) failure to follow the product instructions or to perform any preventive maintenance; (e) modifications; (f) unauthorized repair; (g) normal wear and tear; or (h) external causes such as accidents, abuse, or other actions or events beyond our reasonable control.

Dear Rollibot RolliCool Owner,

Welcome to the new age of cool!

The RolliCool COOL-P800 is an AC unit that uses the latest technology to improve your quality of life. We’ve designed this unit to be easy to install and use in your home. It features multiple modes to help keep you cool no matter what the weather’s like!

The COOL-P800 is designed for indoor use (with exhaust outside) and can be used in different sized spaces. Included accessories make it easy to install the unit just about anywhere. There’s even a remote control for a little more convenience!

All of the unit’s features are available through the RolliCool app. After pairing your AC unit and your smartphone, stay cool however you like!

Thank you for being a part of the Rollibot family!

— The RolliBot Team



Table of Contents

**Section 1. Information & Safety Warnings ..... 5**

**1.1 – Introduction ..... 5**

**1.2 – Safety Warnings ..... 5**

**1.3 – Installation Warnings ..... 5**

**1.4 – FCC Information ..... 6**

**1.5 – Disposal at End-of-Life ..... 6**

**Section 2. RolliCool Parts ..... 7**

**2.1 – Box Contents ..... 7**

**2.2 – Components Overview ..... 7**

**2.3 – Control Panel ..... 8**

**2.4 – Remote Overview ..... 10**

**Section 3. Setting Up the AC ..... 11**

**3.1 – Installing the Indoor Unit ..... 11**

**3.3 – Connecting the Coupler ..... 14**

**Section 4. App Setup ..... 16**

**Section 5. How to Use the RolliCool ..... 16**

**5.1 – Auto Mode ..... 16**

**5.2 – Cooling Mode ..... 17**

**5.3 – Dehumidify Mode ..... 17**

**5.4 – Fan Only Mode ..... 18**

**5.5 – Timer ..... 18**

**Section 6. Maintenance ..... 19**

**6.1 – How to Clean the Filters ..... 19**

**6.2 – How to Clean the Indoor Unit ..... 20**

**6.3 – How to Drain the Unit ..... 20**

**6.4 – How to Clear Water from Drainage Pipe ..... 20**

**Section 7. Troubleshooting ..... 21**

**Section 8. Warranty ..... 22**

**8.1 – Violation ..... 22**

**8.2 – Information ..... 22**

**Section 7. Troubleshooting**

Problems	Possible Causes	Solution(s)
The unit does not work.	There is no electricity.	Turn it on after connecting it to a socket with electricity.
	The overflow indicator displays.	Drain the water inside.
	The indoor temperature is too low or too high.	Use the unit when the indoor temperature is between 44-95 °F (7-35 °C). Change the set temperature.
The cooling effect is weak.	There is direct sunlight.	Cover any direct sunlight coming through the windows.
	Doors or windows are open; there are a lot of people; or there are other sources of heat.	Close doors and windows.
	The filter is dirty.	Clean or replace the filter.
	The air inlet or outlet is blocked.	Clear obstructions.
Excessive Noise	The unit is not placed on a flat surface.	Put the unit on a flat and stable surface.
Compressor Issues	Overheating protection started.	Wait 3 minutes until the temperature is lowered then restart the unit.
The remote control does not work.	The remote and unit are too far apart.	Get closer to the RolliCool and make sure that the remote control directly faces the unit.
	The remote isn't pointed in the right direction.	
	Batteries are dead.	Replace batteries.

When the RolliCool encounters errors, the display may show certain error codes. Refer to the table below.

Code	Possible Cause	Solution(s)
E0	Water has collected in the unit.	Unplug the unit. Use the Drainage Pipe and drain out any water. Restart the unit.
E1	Indoor temp. sensor failure	Contact customer service for troubleshooting.
E2	EVA sensor failure	Contact customer service for troubleshooting.
E6	Overcooling	The unit was turned on when the indoor temperature was too low. Adjust the temperature as needed.
E7	Overheating	If the cooling effect is weak, remove and clean the filters. Restart the unit.

If none of the above information resolves your issue, please visit our website at [www.rollibot.com](http://www.rollibot.com) or contact customer service at 1-844-585-6295.



3. Remove the filter and empty the debris into a waste receptacle.
4. Rinse the filter in lukewarm water if desired and allow time for it to dry before replacing it.
5. Mild detergents may also be used.

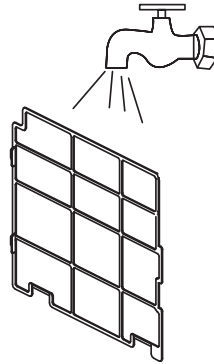

### 6.2 – How to Clean the Indoor Unit

- ! *Wipe the exterior clean with a non-abrasive cloth. If needed, the cloth can be dampened with water.*
- Do not use harsh chemicals to clean as these may damage the unit.*
- Be careful to keep water out of the interior.*

### 6.3 – How to Drain the Unit

In most cases, the Indoor Unit will not require draining. If this is necessary in some special case, follow the instructions below.

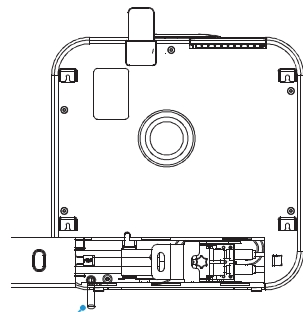

Drainage

- ! *Please make sure your AC unit is completely powered off before performing any type of maintenance.*
1. After turning off the RolliCool, unplug it.
  2. If needed, remove the Drainage Pipe's stopper and drain the water down away from the unit. Using a bucket is recommended.
  3. To completely dry the inside, use Fan Only Mode for at least two hours.
  4. If the Drainage Pipe needs an extension, materials to do so can be purchased at most hardware stores.

### 6.4 – How to Clear Water from Drainage Pipe

If the Drainage Pipe has excessive water that needs to be cleared, follow the instructions below.

- ! *Please make sure your AC unit is completely powered off before performing any type of maintenance.*

- Step 1.** Unplug the unit and remove the Indoor Unit from the wall.
- Step 2.** Place the unit on a sturdy surface and remove the Coupler Cover.
- Step 3.** Use needle nose pliers to pinch the Drainage Pipe's metal clasp to release the pipe from the unit.
- Step 4.** Clear the water from the Drainage Pipe.
- Step 5.** Connect the Drainage Pipe back to the unit and push the clasp around the pipe where it is connected to the unit.
- Step 6.** Use needle nose pliers to fix the metal clasp back in place.
- Step 7.** Replace the cover, add and tighten the screw, and place the unit back on the wall.

## Section 1. Information & Safety Warnings

### 1.1 – Introduction

This user manual will guide you through the functions and usage of your RolliCool Mini-Split Air Conditioner. It is important that you follow all instructions and pay attention to all notes that appear throughout this manual. Consult this manual before you attempt to use your RolliCool Mini-Split AC. If you have questions not answered by this manual or are in need of repair or non-routine service, contact customer service at 1-844-585-6295. Before contacting customer service, please have your purchase information ready as this may be needed during the call. This information may be recorded below.

Date of Purchase: \_\_\_\_\_

Place of Purchase: \_\_\_\_\_

### 1.2 – Safety Warnings

When reading this manual, note these icons:

- ! *Notes with this icon MUST be read, understood, and obeyed to prevent injury or damage etc.*
- 🔄 *Notes with this icon include relevant information.*

#### ! Overall Usage

- Do not insert objects into the product.
- The product is not a toy. Do not leave children unsupervised around the product.
- The product is designed for indoor use only.
- Keep the product upright at all times.
- Do not use the product near any of the following places:
  - Near anything flammable
  - Direct sunlight
  - Damp areas
  - Dusty areas
- Do not use wax, thinner, or solvents when cleaning the air conditioner.
- Clean your filter once or more every couple of weeks.
- Do not place any obstacles in front of the inlet.
- Do not pull the power lines.
- In the event that the product is malfunctioning, shut the power off immediately.
- Switch off the product before cleaning.
- If used in homes near saltwater locations, the unit may be subject to accelerated corrosion.
- You should only use parts you have received from RolliBot™ or that have been included in the original packaging.
- Do not use the product for any purpose other than described in this user manual.

### 1.3 – Installation Warnings

#### INDOOR UNIT

- Do not install the indoor unit in a sloped setting.
- Do not install the indoor unit in direct sunlight.



- Do not install in places with open flames or flammable gas.
- Do not use extension cords etc. Only plug the indoor unit into a grounded wall outlet.
- Install in clear area without any obstructions nearby.
- Avoid installing the indoor unit in damp areas.
- Install near the wall with space to link the coolant lines between the indoor and outdoor unit.

### OUTDOOR UNIT

- Never install the outdoor unit in a place where the product is likely to fall.
- Make sure to drain the outdoor unit with the drainage pipe.
- Do not install the outdoor unit in direct sunlight.
- Do not install the outdoor unit near open flames or by flammable gas.
- Do not install the outdoor unit in extremely windy areas.

### 1.4 – FCC Information

#### DECLARATION OF CONFORMITY:

This device complies with Part 15 of the FCC Rules.

Operation is subject to the following two conditions: (1) This device may not cause harmful interference, and (2) this device must accept any interference received, including interference that may cause undesired operation.

#### FCC RELATED INFORMATION:

This equipment has been tested and found to comply with the limits for a Class B digital device, pursuant to Part 15 of the FCC Rules. These limits are designed to provide reasonable protection against harmful interference in a residential installation. This equipment generates, uses, and can radiate radio frequency energy and, if not installed and used in accordance with the instructions, may cause harmful interference to radio communications. However, there is no guarantee that interference will not occur in a particular installation. If this equipment does cause harmful interference to radio or television reception, which can be determined by turning the equipment off and on, the user is encouraged to try to correct the interference by one or more of the following measures:

- Reorient or relocate the receiving antenna.
- Increase the separation between the equipment and receiver.
- Connect the equipment into an outlet on a circuit different from that to which the receiver is connected.
- Consult the dealer or an experienced radio/TV technician for help.

The manufacturer is not responsible for any radio or TV interference caused by unauthorized modifications to this equipment. Such modifications could void the user's authority to operate the equipment.

### 1.5 – Disposal at End-of-Life

This product must not be disposed of by incineration, landfilling, or mixing with household trash. Improper disposal of the battery contained within this product may result in the battery heating up, rupturing, or igniting which may cause serious injury. The refrigerants contained inside the RolliCool present chemical risks to the environment. The recommended disposal for any RolliCool Portable Air Conditioner at its end-of-life is to dispose of the entire unit by contacting your local recycling company. Local regulations and laws pertaining to the recycling

- When a schedule is active, the unit will not turn on if the chosen temperature is higher than the indoor temperature.

### TO SET A SHUTOFF TIME

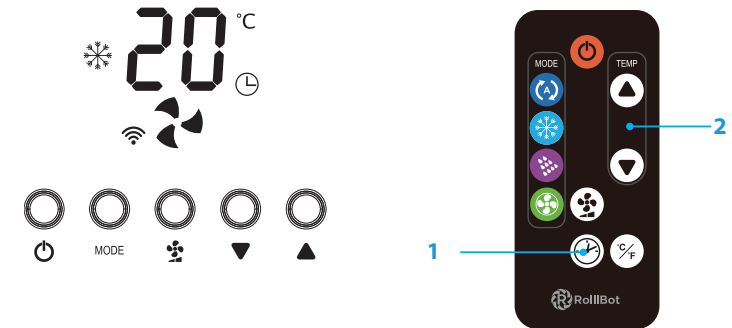

1. When the unit and remote are on, press the Timer Button on the Control Panel or the remote.
2. Use the Up and Down Buttons to select the time the AC unit will turn off i.e. selecting "03" will prompt the unit to turn off in 3 hours' time etc.
3. After the selection is complete, the display will show the current indoor temperature and the Schedule Light.

### Section 6. Maintenance

Proper maintenance will help improve your RolliCool's performance. The RolliCool will periodically need its filter cleaned. For optimal performance, the filters should be cleaned at least twice a month. It is also recommended to regularly inspect the Drainage Pipe.

- ! If any type of non-routine maintenance is needed, such as any maintenance not described in Section 6 of this manual, please contact customer service or a certified HVAC professional as the unit contains refrigerant.

### 6.1 – How to Clean the Filters

- ! Please make sure your AC unit is completely powered off before performing any type of maintenance.
- Do not scrape the air filters as it may sustain damage.
- A hand vacuum or low-powered vacuum or vacuum modes may be used to clean the filters.
- Replace the filters after cleaning. Do not use the RolliCool without the filters.

1. Pull off the front panel.
2. Pull out the filter.

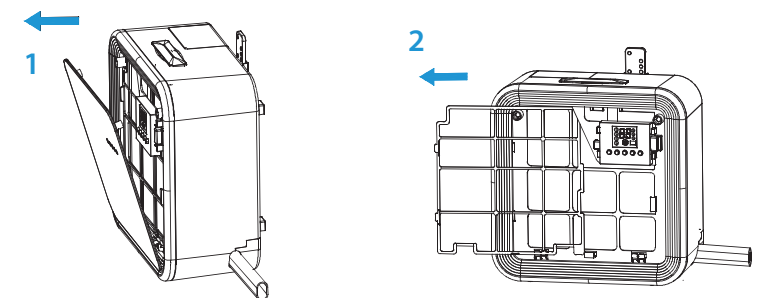

## 5.4 – Fan Only Mode

With this mode, the unit will turn on and begin using the fan to promote air circulation.

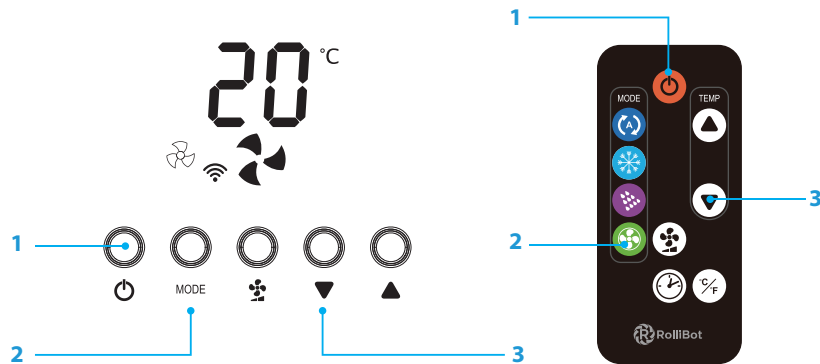

1. Press the Power Button on the Control Panel or the remote.
2. Press the Mode Button on the Control Panel until the Fan Only Mode icon appears. Or simply press the Fan Only Button on the remote.
3. Use the Fan Speed Button to change fan speed. Press it multiple times to cycle through 3 fan speeds.

In Fan Only Mode, the fan speed is automatically set low and cannot be adjusted.

## 5.5 – Timer

With this mode, the unit will automatically turn on or off and regulate temperature according to the selected times.

- Setting the schedule when the unit is off means setting the time the unit will turn on.
- Setting the schedule when the unit is on means setting the time the unit will run before it shuts off.

### TO SET A TURN ON TIME

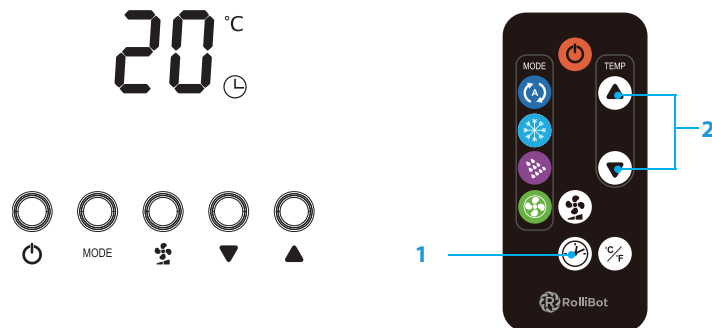

1. When the unit and remote are off, press the Timer Button on the Control Panel or the remote.
2. Use the Up and Down Buttons to select the time the AC unit will turn on i.e. selecting "03" will prompt the unit to turn on in 3 hours' time etc.
3. After the selection is complete, the display will show the Timer icon.

and disposal of any RolliCool unit and/or products containing them will vary according to your country, state, and local governments. You must check laws and regulations corresponding to where you live in order to dispose of your RolliCool unit properly. It is the user's responsibility to dispose of their equipment properly in accordance with local regulations and laws.

For additional information about where you should drop off your RolliCool unit, please contact your local or regional waste management office, your household waste disposal service, or your point-of-sale.

## Section 2. RolliCool Parts

### 2.1 – Box Contents

- 1 x RolliCool Mini-Split AC (Indoor Unit)
- 1 x RolliCool Mini-Split AC (Outdoor Unit)
- 1 x Remote Control
- 2 x Air Filter (pre-installed)
- 4 x Wall Anchors/Screws
- 1 x Window Kit

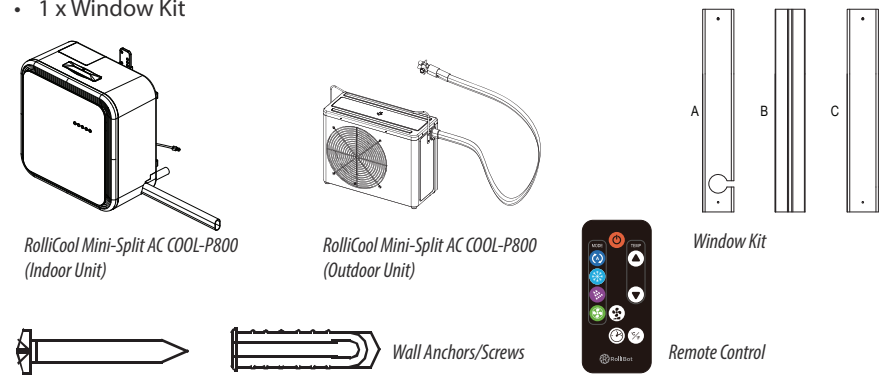

### 2.2 – Components Overview

#### INDOOR UNIT

- 1 Front Panel
- 2 Air Filter
- 3 Handle
- 4 Control Panel
- 5 Remote
- 6 Air Outlet
- 7 Coolant Lines
- 8 Mount Openings
- 9 Coupler Cover
- 10 Drainage Pipe
- 11 Power Cord

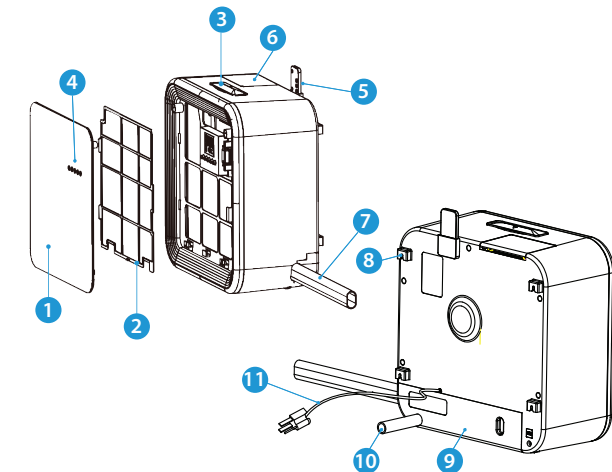

### OUTDOOR UNIT

- 1 Handle
- 2 Air Outlet
- 3 Coolant Lines
- 4 Condensation Outlet
- 5 Coupler

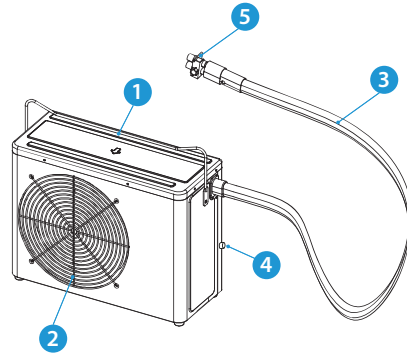

### 2.3 – Control Panel

The RolliCool Mini-Split AC features an LED Control Panel which lights up when the AC unit turns on and includes buttons.

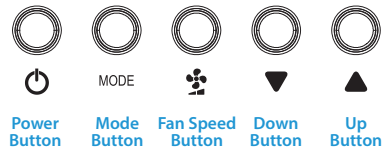

### CONTROL PANEL LIGHTS

- Auto. Mode:** This icon will light up when the unit is in Auto Mode.
- Cool Mode:** This icon will light up when the unit is in Cool Mode.
- Dehumidify Mode:** This icon will light up when the unit is in Dehumidify Mode.
- Fan Only Mode:** This icon will light up when the unit is in Fan Only Mode.
- Celsius:** If selected, this icon will light up when the current temperature is being displayed.

### 5.2 – Cooling Mode

With this mode, the unit will turn on and regulate temperature as selected.

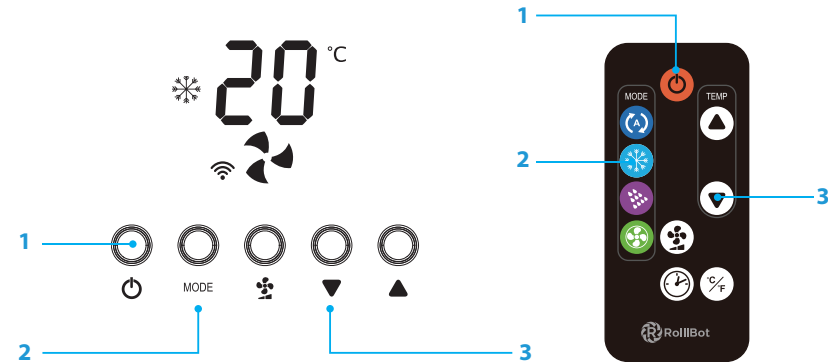

1. Press the Power Button on the Control Panel or the remote.
2. Press the Mode Button on the Control Panel until the Cool Mode light turns on. Press it multiple times to cycle through different modes. Or simply press the Cool Button on the remote.
3. Use the Up and Down Buttons to set the desired temperature between 61~88°F (16~31°C).
4. Use the Fan Speed Button to change fan speed. Press it multiple times to cycle through 3 fan speeds.

When Cool Mode is active, the unit will not turn on if the chosen temperature is higher than the indoor temperature.

### 5.3 – Dehumidify Mode

With this mode, the unit will turn on and begin removing moisture from the air.

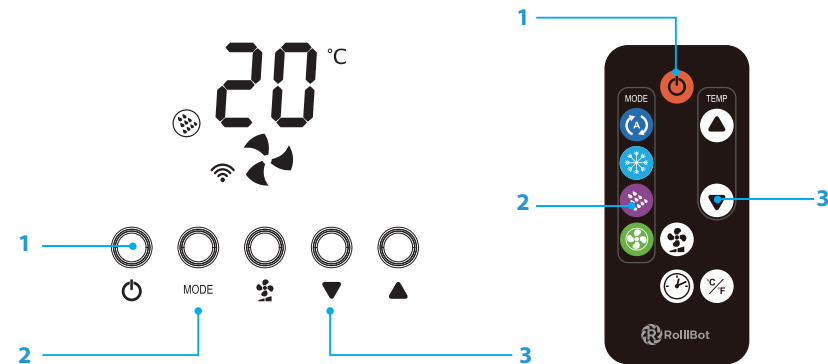

1. Press the Power Button on the Control Panel or the remote.
2. Press the Mode Button on the Control Panel until the Dehumidify Mode icon appears. Press it multiple times to cycle through different modes. Or simply press the Dehumidify Button on the remote.

In Dehumidify Mode, the fan speed is automatically set low and cannot be adjusted.



## Section 4. App Setup

For your convenience, there is an app for the RolliCool. The app is compatible with most Android and iOS smartphones. The app can be used to set cooling schedules, change modes, and more. Use your smartphone to search the Play or App Store for the “RolliCool” application then download and install the app according to your operating system. After downloading the app, see the steps and images below to use it and connect to your AC unit. For your convenience, the steps have been divided into parts.

- *Either wi-fi or Bluetooth® may be used for setup. It is not necessary to set up via both methods.*
- *Powering on the RolliCool will automatically enable Bluetooth® i.e. Bluetooth® will become enabled and stay enabled as long as the RolliCool is turned on.*
- *For instructions on how to turn on Bluetooth®, consult materials for your Bluetooth®-enabled smartphone.*
- *As with most Bluetooth® devices, it is recommended to keep the connected devices at least 32 ft. within each other. The connection may be terminated or fail to work properly if the connected devices are too far apart.*

## Section 5. How to Use the RolliCool

The RolliCool Mini-Split AC features a number of ways to keep cool and comfortable. Most features can be used by pressing the buttons on the unit’s Control Panel, the remote, or via the app.

- *In most cases where the remote can be used, the app can also be used as a substitute.*

### 5.1 – Auto Mode

With this mode, the unit will turn on and regulate temperature as selected.

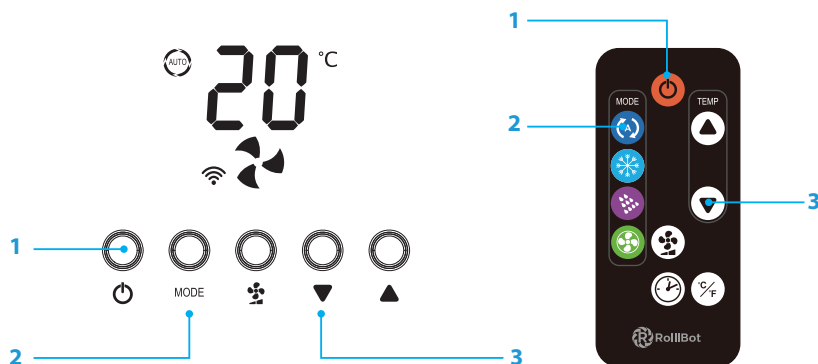

1. Press the Power Button on the Control Panel or the remote.
2. Press the Mode Button on the Control Panel until the Auto Mode light turns on. Press it multiple times to cycle through different modes. Or simply press the Auto Button on the remote.
3. Use the Up and Down Buttons to set the desired temperature between 61~88°F (16~31°C).

- *When Auto Mode is active, the unit will not turn on if the chosen temperature is higher than the indoor temperature.*
- *In Auto Mode, the fan speed is automatically set and cannot be adjusted.*

**°F Fahrenheit:** If selected, this icon will light up when the current temperature is being displayed.

**🕒 Schedule:** This icon will light up when a schedule has been programmed.

**🌀 Fan Speed:** This icon will light up and change according to the selected fan speed.

### CONTROL PANEL BUTTONS

**🔌 Power Button:** Press to turn the unit on or off.

**MODE Mode Button:** Press to cycle between Auto, Cool, Dehumidify, and Fan Only modes.

**🌀 Fan Speed Button:** Press to cycle between 3 fan speeds.

**▼ Down Button:** Press to lower temperature.











**▲ Up Button:** Press to raise temperature.

- *Scheduling can be done and/or adjusted via the Control Panel, remote, or the app. See the following section for more information about the remote. See Section 4 for information about the app.*

## 2.4 – Remote Overview

The RolliCool Mini-Split AC features a remote which may be used with the unit.

### REMOTE BUTTONS

-  **Power Button:** Press to turn the unit on or off.
-  **Auto Button:** Press to turn on Auto Mode.
-  **Cool Button:** Press to turn on Cool Mode.
-  **Dehumidify Button:** Press to turn on Dehumidify Mode.
-  **Fan Only Button:** Press to turn on Fan Only Mode.
-  **Schedule Button:** Press to turn on Schedule Mode.
-  **Up Button:** Press to raise temperature or adjust schedule duration.
-  **Down Button:** Press to lower temperature or adjust schedule duration.
-  **Fan Speed Button:** Press to cycle between 3 fan speeds.
-  **°C/°F Button:** Press to switch between Celsius and Fahrenheit.

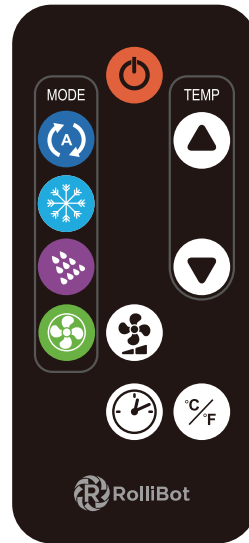

-  • Avoid pressing two buttons simultaneously as this may cause malfunctions.
- Avoid using the remote in areas with extreme temperature fluctuations.
- If the remote will not be used for extended periods of time, remove the battery.
- The remote control's range is approximately 23 ft. Use it within this range.
- The remote uses one CR2 (CR2035 3V) battery. This battery is included.

Before Using the Remote

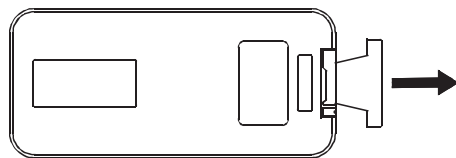

Pull the tab to remove the protective film.

To Change the Battery

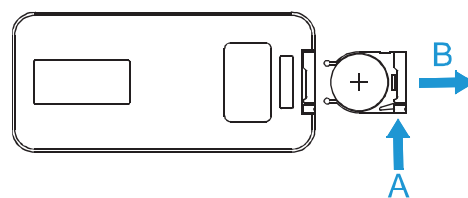

Pull part A in towards the remote then pull part B out to remove the battery tray. Remove any dead battery and replace with a new battery, + side up.

## 3.4 – Separating the Coupler

If needed, the Indoor and Outdoor Units can be disconnected from one another in case any adjustments or maintenance is needed. Before separating the coupler from the unit, turn off the RolliCool, disconnect it from any power supply and wait at least 5 minutes.

 **Never separate the coupler while the unit is on.**

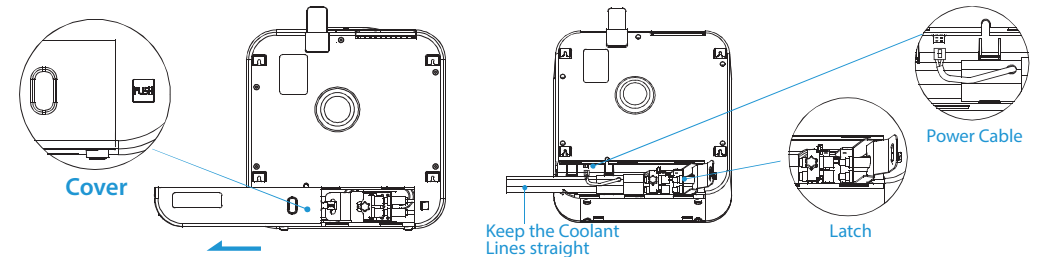

### Step 1.

Unscrew the screw at the right side of the cover. Push the button at the right side of the cover and pull it away from the unit to remove it.

### Step 2.

Slowly open the latch and hold the Coolant Lines so that they're straight. Note, the unit may emit a chugging sound due to the refrigerant; this is normal.

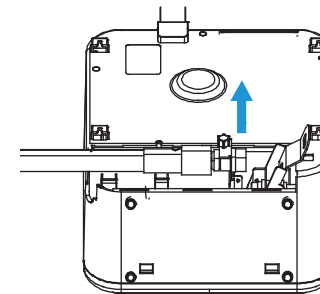

### Step 3.

Disconnect the power cable from the inside of the unit. Lift the Coolant Lines up and away from the unit to remove it.

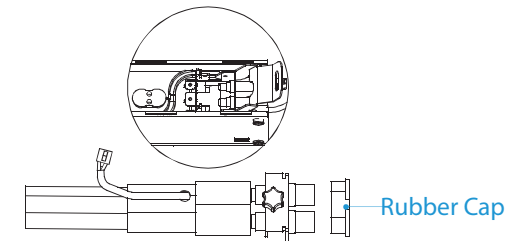

### Step 4.

Insert the rubber stopper into the end of the Coupler to prevent leakage.

### 3.3 – Connecting the Coupler

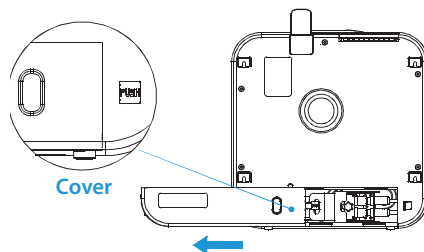

#### Step 1.

Unscrew the screw at the right side of the cover. Push the button at the right side of the cover and pull it away from the unit to remove it.

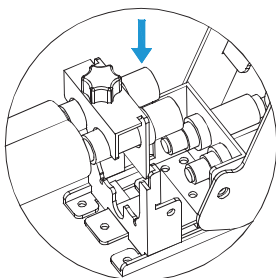

#### Step 3.

Make sure the Coupler is properly threaded into its connectors and push it straight down.

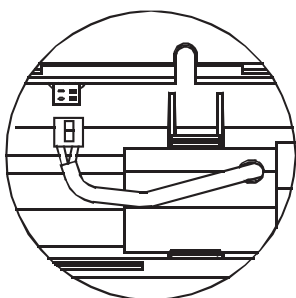

#### Step 5.

Connect the power cable to the inside of the unit.

**!** Ensure that the rubber stopper is placed in a suitable location. If the Indoor and Outdoor Units are disconnected e.g. when the unit is being moved, the rubber stopper should be reinstalled into the end of the Coupler. If separating the two, review the following section.

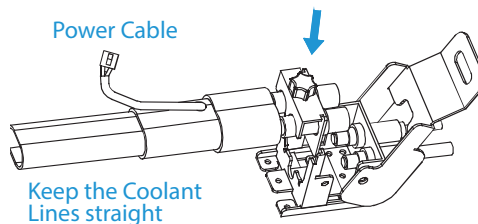

#### Step 2.

Remove the rubber stopper from the end of the Coupler if it is installed. Open the latch and line the Coupler up with its connectors.

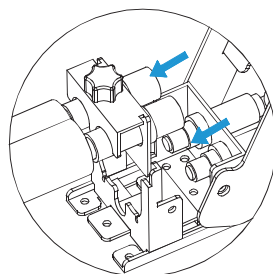

#### Step 4.

Slowly close the latch, taking care to use even pressure on the latch.

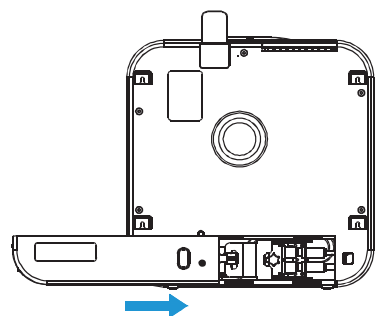

#### Step 6.

Replace the Coupler Cover. Make sure to add the screw.

## Section 3. Setting Up the AC

### 3.1 – Installing the Indoor Unit

- !** Choose a mounting location situated next to a window as the Coolant Lines must be run through a window in order to keep the Indoor and Outdoor Units connected.
- Using a stud detector for detection and installation into wall studs may be desired for more secure mounting.

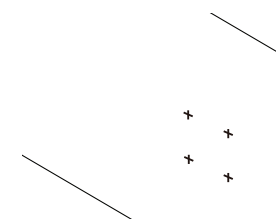

**Step 1.** Choose a suitable location on the wall for mounting the unit.

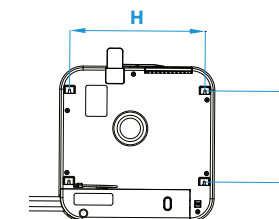

**Step 2.** Measure between the Mount Openings on the back of the unit.

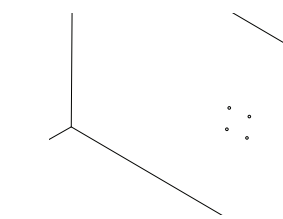

**Step 3.** Mark locations on the wall according to the openings.

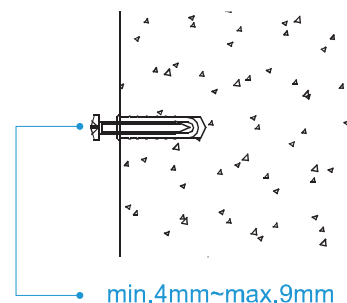

#### Step 4.

Use a drill to make 4 holes at each of the marks.

#### Step 5.

Insert the Wall Anchors into the wall.

#### Step 6.

Add the screws into their anchors making sure a length of 4mm~9mm is left out of the wall.

#### Step 7.

Install the Indoor Unit onto the wall making sure the notches in the Mount Openings slide over the screws.

#### Step 8.

Check to ensure the Indoor Unit is securely installed on the wall.

#### Step 9.

Remove the Indoor Unit for now to prepare for connection. After installing the Outdoor Unit (Section 3.2) and Connecting the Coupler (Section 3.3), reinstall the Indoor Unit on the wall.

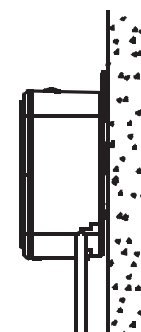

### 3.2 – Installing the Outdoor Unit

In order to let off exhaust and hot air, the Outdoor Unit should be placed on level, stable ground outdoors. The Coolant Lines must be used to connect the two units and may be routed through a window with the help of the Window Kit.

 Please read all installation steps and parts instructions and information before attempting to install.

#### WINDOW KIT PARTS

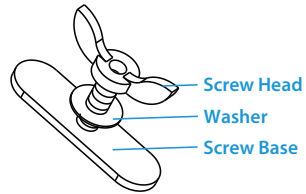
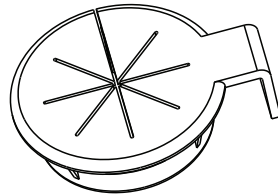
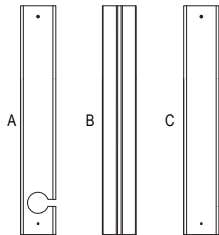

#### SECTIONS

These sections thread into one another and should be placed within a window gap. A may be flipped so that the opening is higher or lower.

#### CONNECTOR

This piece is later inserted into the opening in Section A and used to hold the Coolant Lines in place.

#### SCREW FASTENER

These parts are used to secure the sections together and can be loosened or tightened when adjusting the sections according to window height.

#### INSTALLATION

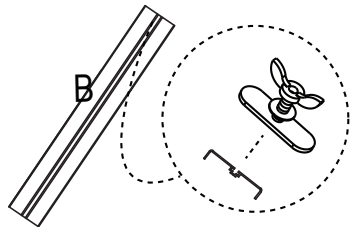

##### Step 1.

Separate one Screw Fastener and thread the Screw Base into one end of Section B.

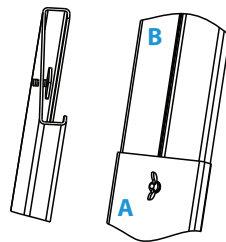

##### Step 2.

Thread Section A onto the end of Section B and use the Screw Head and Washer to secure the sections together.

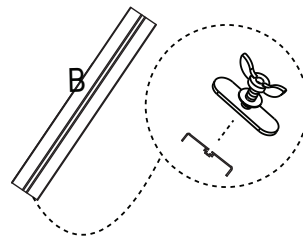

##### Step 3.

Repeat Step 1 one at the other end of Section B.

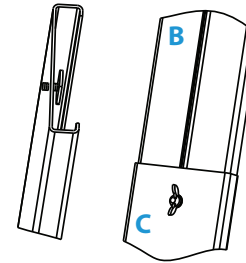

##### Step 4.

Thread Section C onto the other end of Section B and use the Screw Head and Washer to secure the sections together.

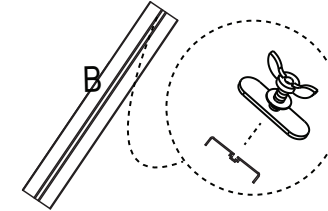

##### Step 5.

Separate one Screw Fastener and thread the Screw Base into one end of the second Section B.

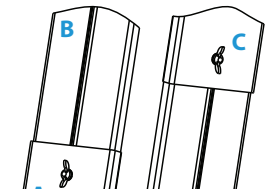

##### Step 6.

Thread the second Section B into the other end of Section C and use the Screw Head and Washer to secure the sections together.

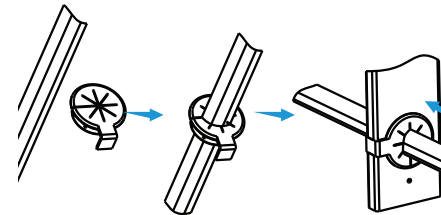

##### Step 7.

Thread the Coolant Lines into the side of the Connector then fit the Connector into Section A making sure the notch is in place.

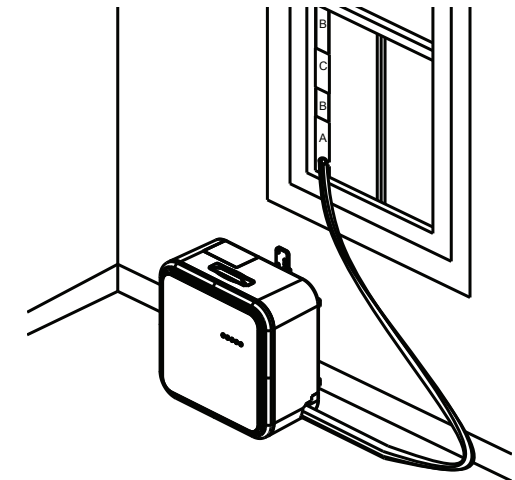

##### Step 9.

Install the assembled kit into a window gap and push the window nearly closed to secure it in place. Use the fasteners to adjust as needed.



Screw Fasteners