

Components FlingPC Remote Controller

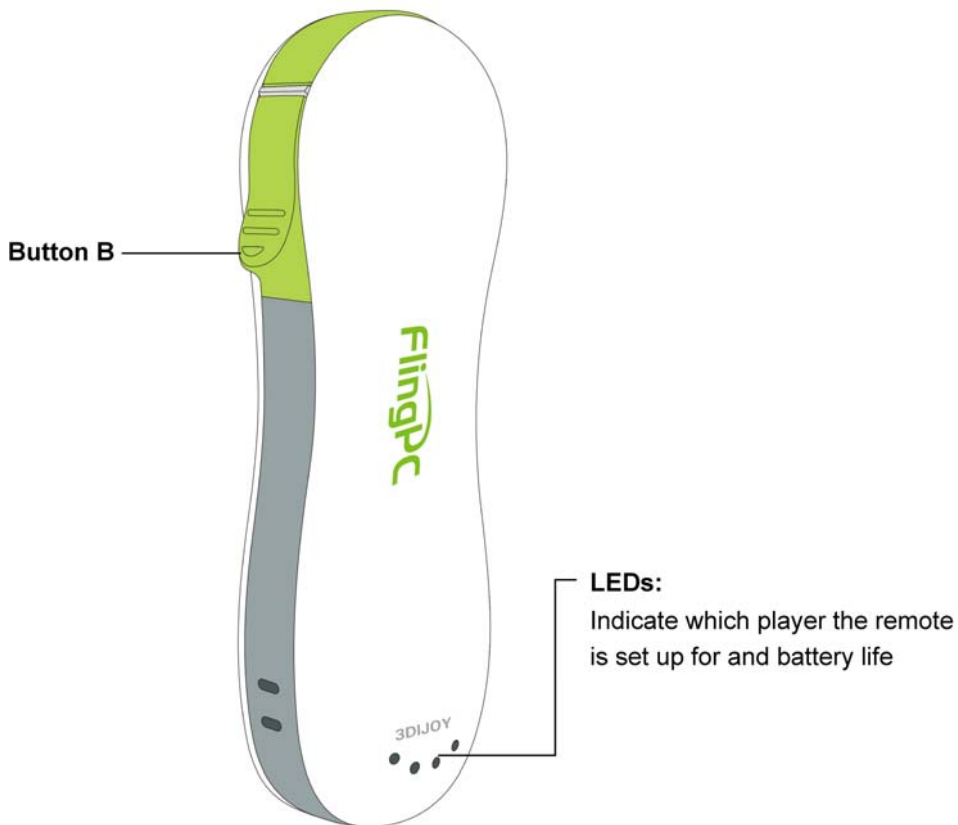

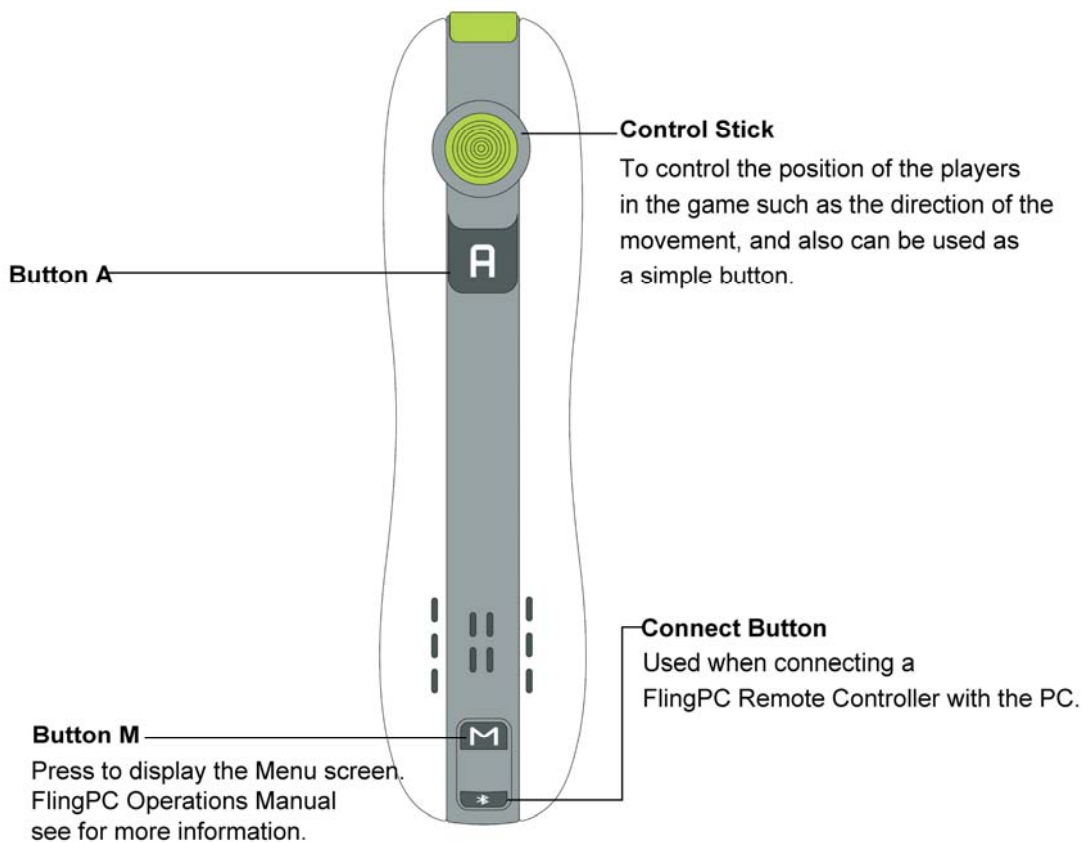
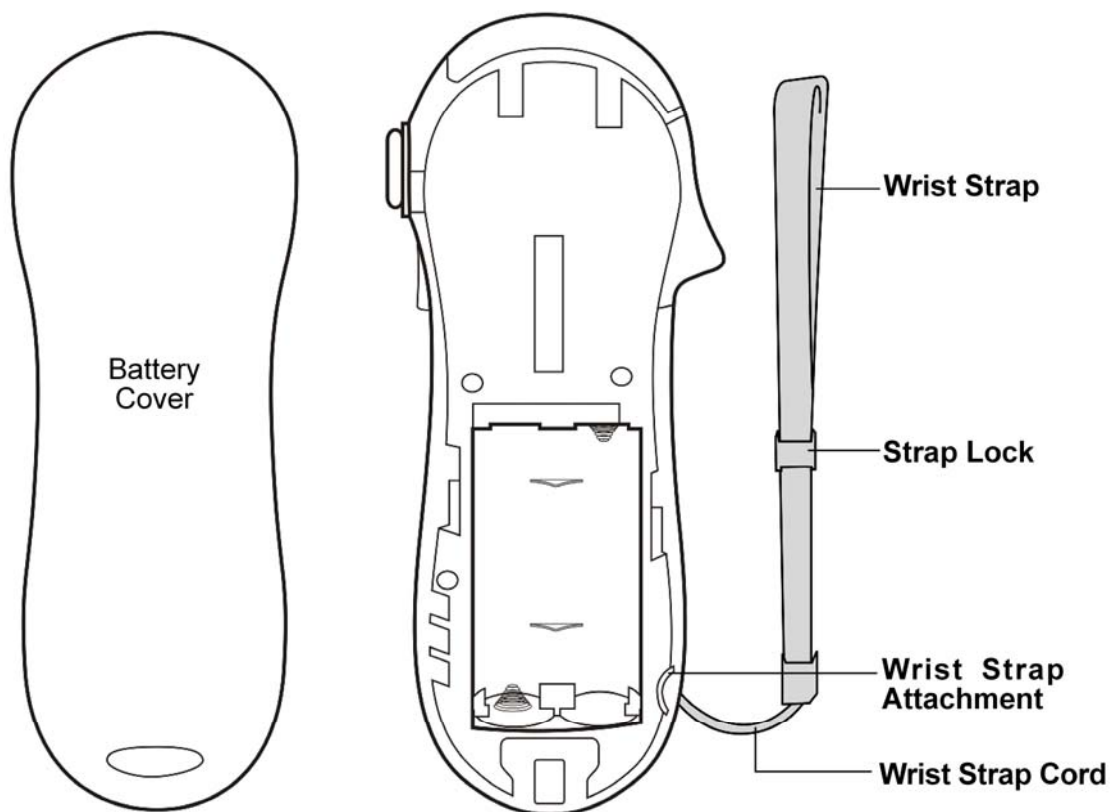

System Setup

Setup of the FlingPC Remote Controller

The Remote Controller uses AA batteries. 3DiJoy recommends high quality alkaline batteries for best performance and longevity of battery life.

WARNING-Battery Leakage

Leakage of battery acid can cause personal injury as well as damage to your Remote Controller. If battery leakage occurs, thoroughly wash the affected skin and clothes. Keep battery acid away from your eyes and mouth. Leaking batteries may make popping sounds.

To avoid battery leakage:

- Do not mix used and new batteries (replace all batteries at the same time).
- Do not mix different brands of batteries.
- 3DiJoy recommends alkaline batteries. Do not use lithium ion, nickel cadmium (nicad), or carbon zinc batteries.
- Do not leave batteries in the Remote Controller for long periods of non-use.
- Do not recharge the batteries.
- Do not put the batteries in backwards. Make sure that the positive (+) and negative (-) ends are facing in the correct directions. Insert the negative end first when removing batteries, remove the positive end first.
- Do not dispose of batteries in a fire.

Installing Batteries

1. Remove the battery cover on the back of the FlingPC Remote Controller and insert two AA batteries.

2. Be sure to insert the minus (-) end first when inserting new batteries, and remove the plus (+) end first when replacing the batteries.
3. Replace the battery cover.

Caution- Use the Wrist Strap

Playing with the FlingPC Remote Controller can involve rapid or vigorous motion. Please use the wrist strap prevent losing your grip on the Remote Controller and causing damage to the Remote Controller or surrounding objects, or injury to other people.

WEAR THE WRIST STRAP WHEN USING THE FLINGPC REMOTE CONTROLLER

- Make sure all players use the wrist strap and that the strap lock is tightened correctly.
- When sharing the FlingPC Remote Controller between multiple players, make sure each person uses the wrist strap properly.
- Wearing the wrist strap will prevent you from dropping or throwing the Remote Controller accidentally when playing the games, which could damage the Remote Controller or surrounding objects, or cause injury to other people.

DO NOT LET GO OF THE REMOTE CONTROLLER WHEN USING THE REMOTE CONTROLLER

- Read the instruction booklet for the game you are playing and follow all game control instructions for correct use of the FlingPC Remote Controller or accessories.
- Hold the Remote Controller securely and avoid excessive motion, as it may cause you to let go of the Remote Controller and may break the wrist strap.
- If your hands become moist, stop and dry your hands.

ALLOW ADEQUATE ROOM AROUND YOU WHEN USING THE REMOTE CONTROLLER

- As you may move around when using the controller, make sure objects and other people are out of your range of movement or arm motion to prevent damage or injury.

Wearing the FlingPC Remote Controller Wrist Strap

1. Place your hand through the wrist strap and hold the Remote Controller firmly in your hand.



2. Slide the strap lock up so that the strap will not fall off your wrist. Do not over tighten the strap lock so that it's uncomfortable. It should just be tight enough to hold the wrist in place.

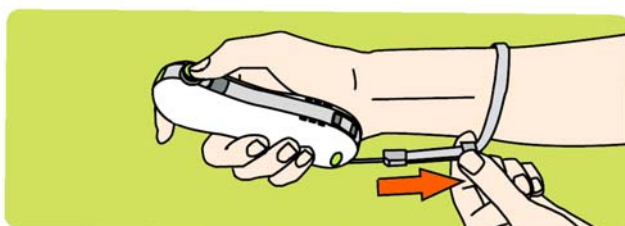

Connection

NOTE: Make sure you have placed batteries in the FlingPC remote controller.

1. Open the 3DIJOY games and follow the instructions to the connection stage
2. Press the CONNECT button on the FlingPC remote controller.
3. The Player LEDs on the FlingPC remote controller will blink and the computer will try to connect to the FlingPC remote controller.
4. When "CONNECTING" in the screen becomes "CONNECTED" and the image of FlingPC remote controller in the screen becomes the solid image. The connection for the controller is complete and the Player LED blinking stops. The LED that is illuminated indicates the player number.

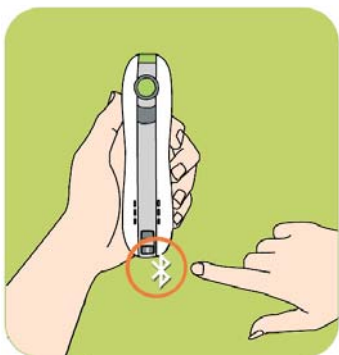

This procedure must be followed for each additional FlingPC Remote Controller added to your system.

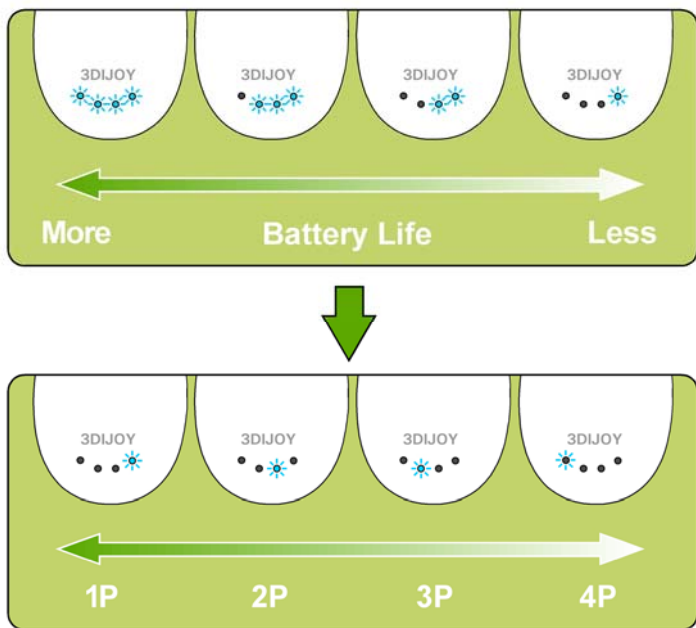

During the connecting process, the number of LEDs that blink will show the battery life of the remote that is being connected.

After the connecting process, LED that is lit shows the player number for that remote.

NOTE:

1. Before connection, please check the computer to make sure that the Bluetooth dongle is plugged into the computer if the computer does not have the Bluetooth module inside and Bluetooth is enabled in the computer
2. If the Player LEDs blinking stops, the connection is not complete. Please repeat 2) and 3) until the connection is complete

Using the FlingPC Remote Controller

FlingPC Remote Controller Configurations

Depending on the game ,the way you hold and operate the Remote Controller will vary ,You may need to hold the Remote Controller in either one or two hands ,Read the instruction booklet for the game you are playing for information about what kind of game play control is required for that game .

The Remote Controller can be used by itself, or in different configurations when connected up to other FlingPC accessories .These configurations can be used right or left handed.

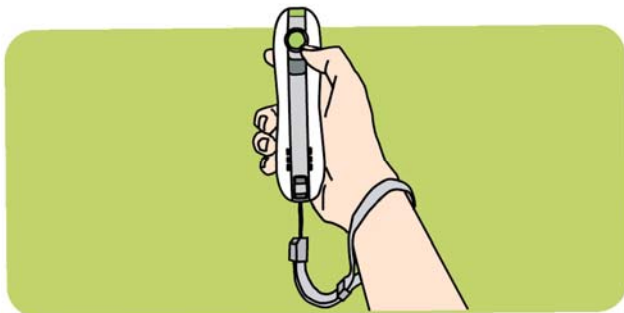

FlingPC Remote Controller-Vertical Position



FlingPC Remote Controller-Horizontal Position

Basic Operations

Point

Point the Remote Controller at a specific place on the TV screen

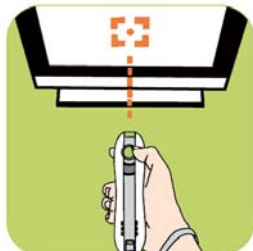

Waving

Wave the Remote Controller back and forth from side to side

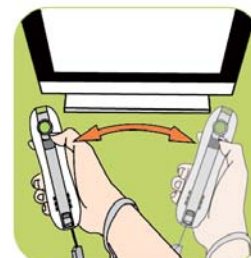

Holding or Grabbing

Point the Remote Controller at a specific place on the TV screen and move the Remote Controller while holding down a button

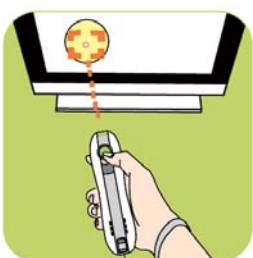

Pushing or Pulling

Move the Remote Controller forward and backward



Twisting

Move the Remote Controller in a twisting motion by rotating your arm



This equipment has been tested and found to comply with the limits for a Class B digital device, pursuant to Part 15 of the FCC Rules. These limits are designed to provide reasonable protection against harmful interference in a residential installation. This equipment generates uses and can radiate radio frequency energy and, if not installed and used in accordance with the instructions, may cause harmful interference to radio communications. However, there is no guarantee that interference will not occur in a particular installation. If this equipment does cause harmful interference to radio or television reception, which can be determined by turning the equipment off and on, the user is encouraged to try to correct the interference by one of the following measures:

- Reorient or relocate the receiving antenna.
- Increase the separation between the equipment and receiver.
- Connect the equipment into an outlet on a circuit different from that to which the receiver is connected.
- Consult the dealer or an experienced radio/TV technician for help.

This device complies with Part 15 of the FCC Rules. Operation is subject to the following two conditions: (1) This device may not cause harmful interference, and (2) this device must accept any interference received, including interference that may cause undesired operation.

FCC Caution: Any changes or modifications not expressly approved by *the party responsible for compliance* could void the user's authority to operate this equipment.

WARNING!**FCC Radiation Exposure Statement:**

This portable equipment with its antenna complies with FCC's RF radiation exposure limits set forth for an uncontrolled environment. To maintain compliance follow the instructions below;

1. This transmitter must not be co-located or operating in conjunction with any other antenna or transmitter.
2. Avoid direct contact to the antenna, or keep it to a minimum while using this equipment.