

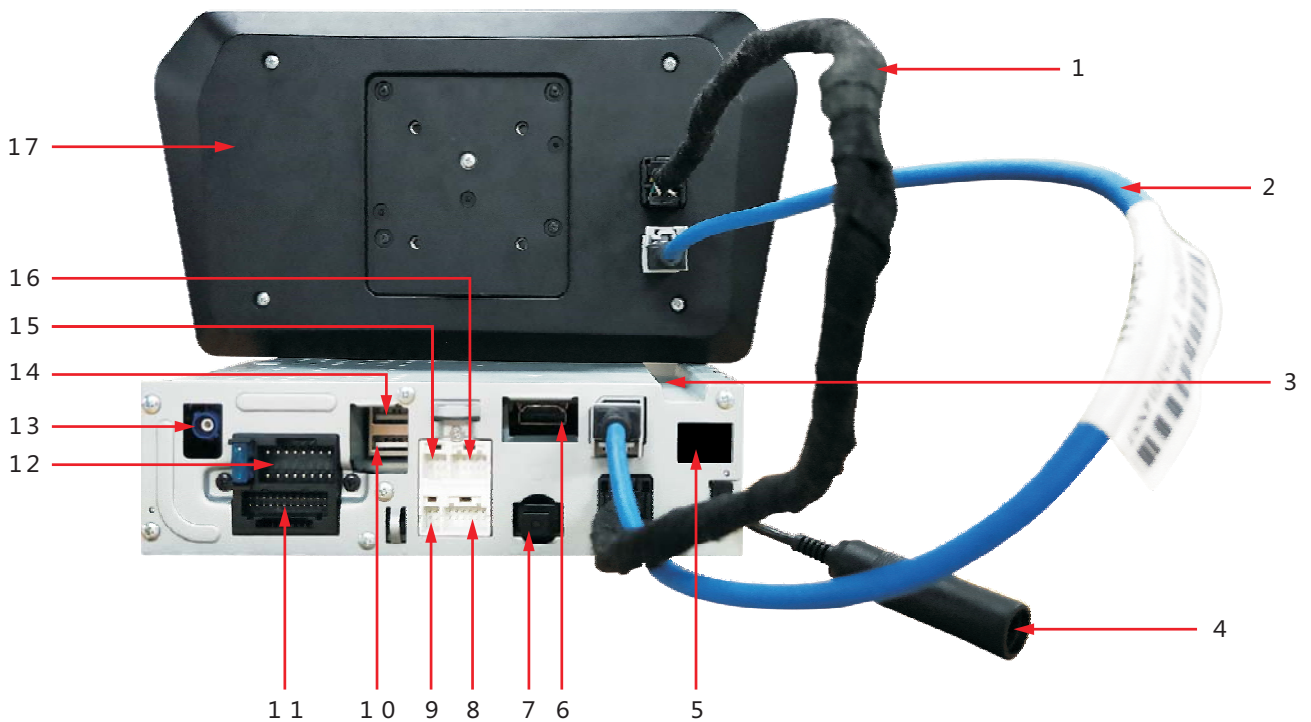

## **Basic Operation Manual for UN1880**

All Rights Reserved. Copyright AAMP of America

<b>9.1.</b>	<b><i>Bluetooth Paring</i></b> .....	<b>21</b>
<b>9.2.</b>	<b><i>Bluetooth Setting</i></b> .....	<b>22</b>
<b>9.3.</b>	<b><i>Telephone operations</i></b> .....	<b>22</b>
<b>9.4.</b>	<b><i>Bluetooth Audio Player Operations</i></b> .....	<b>23</b>
	<b><i>Pausing playback</i></b> .....	<b>23</b>
	<b><i>Playback pauses</i></b> .....	<b>23</b>
	<b><i>Skipping a track</i></b> .....	<b>23</b>
<b>10</b>	<b>Camera Operations</b> .....	<b>23</b>
	<b><i>Switching to Camera mode</i></b> .....	<b>23</b>
<b>11</b>	<b>HDMI Operations</b> .....	<b>24</b>
<b>12</b>	<b>AV IN</b> .....	<b>24</b>



- |                                    |   |
|------------------------------------|---|
| 1.8pin cable connect to panel      | 10.USB2.0_HOST (only USB host)                              |
| 2.LVDS cable connect to panel      | 11.24pin cable for AV in and out                            |
| 3.Car multimedia navigation hosts  | 12.16pin cable for power and speaker                        |
| 4.FM/AM antenna interface          | 13.GPS antenna interface                                    |
| 5.No function                      | 14.USB_OTG (carplay&Android auto&iPod&iPhone)               |
| 6.HDMI signal input                | 15.6pin cable connect to the steering wheel control buttons |
| 7.Toslink output                   | 16.10pin cable connect to camera                            |
| 8.12pin cable connect to Sirius XM | 17.Panel (LCD)  |
| 9.4pin cable connect to microphone |   |

# 1 Operations

## 1.1. Panel buttons



## Functions of Buttons

### 1. [PWR] [VOL] Knob

- Press this knob to turn the unit on.
- Long press this knob to turn the unit off.
- Rotate the knob to increase or decrease the volume.
- Press this knob in radio mode, Rotate the knob within 3 seconds to tune forward or tune backward.

### 2. [RESET] Button

- Press [RESET] button to reset the unit.

### 3. [MUTE] Button

### 4. [HOME] Button

- Press this button to go to the main menu.
- Press this button to go back to the last source.

### 5. [MIC] Button

- Press this button to use CarPlay Siri/Android Auto Google Assistant.

### 6. [Tuning Knob] Button

- Turn to increment frequencies up (clockwise) or down (counter clockwise)

### 7. [→] Tune +/ Skip Forward

### 8. [←] Tune -/ Skip Back

### 9. [NAV] Button

- Press this button to enter NAV.
- Press this button to go back to the last page.

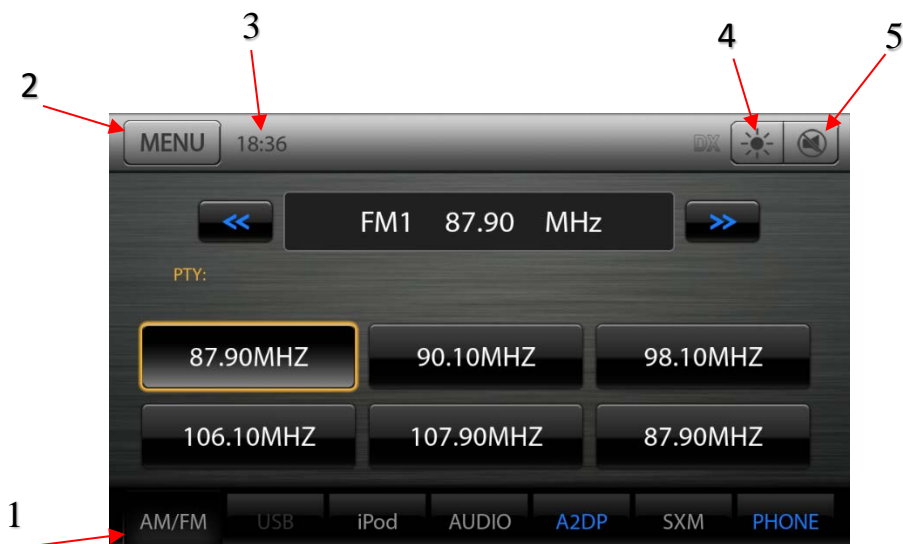

1. Select the tab and enter the available source or option
2. Press to enter Menu or back to the current source.
3. Show the current time
4. Monitor-OFF / Monitor-ON
5. Press to mute OFF/ON

## 1.2. Change Source and options

### • Source Menu:

1. Press “Home” button. Main menu will be displayed.



Available tabs:

- |  |   |
|--|---|
| <ol style="list-style-type: none"> <li>1. Radio – AM/FM</li> <li>2. Phone – Enter for setup</li> <li>3. BT Music – For Audio streaming (A2DP)</li> <li>4. Pandora –</li> <li>5. SXM – SiriusXM tuner required</li> <li>6. Ipod – Play iPod music</li> <li>7. Apple Carplay –</li> <li>8. Android Auto –</li> <li>9. USB – For playing music and video</li> </ol> | <ol style="list-style-type: none"> <li>10. HDMI – Selects HDMI rear input</li> <li>11. AV IN – Selects AV rear input</li> <li>12. Navigation – If installed</li> <li>13. Display – Enter for display setup</li> <li>14. Audio – Audio adjustments</li> <li>15. Rear – Output from AV or USB</li> <li>16. Cameras – Access camera inputs</li> <li>17. Settings – Access setup options</li> <li>18. Display OFF – Turns off screen</li> </ol> |
|--|---|

## 2 AM/FM Radio Operations



1. Frequency display, touch to automatically seek next station in the direction of higher frequencies
  2. Station name
  3. Loc/DX. It is used to set the station is local or dx.
  4. Mute button
  5. Tune backward
  6. Tune forward
  7. Title, PTY, Artist, Text display area. The strings will roll from left to right to display all the characters.
  8. Preset station list
  9. Mode switch buttons bar
  10. AM/FM button
  11. Touch this area to switch to Main page
  12. Title, PTY, Artist, Text display area
- ✓ Using the tuner unit:
1. Touch the **AM/FM** button on **the mode switch buttons bar**, if the unit does not work in tuner mode. The tuner mode screen is displayed.
  2. Touch the **AM/FM** button to select the radio band, when the unit already works in tuner mode. Each time the button is pressed, the radio reception band changes in the following order: FM1 FM2 FM3 AM FM1 FM2 FM3 AM...
  3. Hold one preset station more than 3 seconds to save current station to the preset station list.

## 3 SXM Operations

This function is available when a Satellite Radio Receiver is connected through the dedicated connection.

**Note: Satellite radio is a subscription service.**

Press the [SXM] button on Main Menu display. The SXM mode will be displayed.



1. Channel up button.
2. Play/Pause button.
3. Channel down button
4. Show the channel is live.
5. Choose channel list.
6. Keypad Button.
7. Channel category type.
8. Channel list.
9. Current Channel Number / Category Name / Preset Number,etc.
10. Channel time

# 4 Settings Operation

## 4.1 Main Settings

Press [Settings] button on the Main menu screen. The Setting menu screen will be displayed.

Contains Main, Camera, Style, Tabs.



## 4.2 Camera Settings



## 4.3 Style Settings

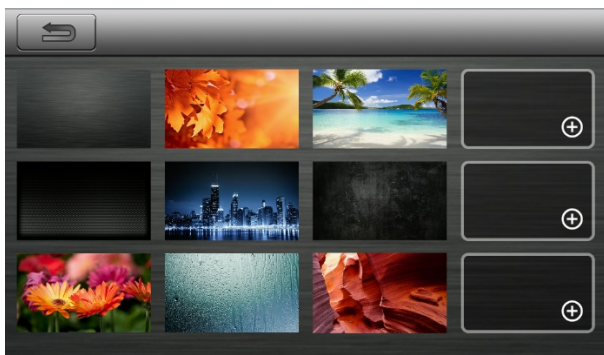



## 4.4 Set Bottom Tabs

1. Seven tabs on the bottom on the screens are shortcuts. Among them the third to the sixth users can customize. User can press [◀] or [▶] button to set different tabs.



2. While user sets tabs, the shortcut will be shown the same on each source.

## 4.5 Display Setup Menu



**TV Shape:** Set TV Shape Normal or Cinema.

**Set Day:** Set Day value from 0 to 20.

**Set Nigh:** Set Nigh value from 0 to 20.

**Auto:** Choose ON or OFF.

**Rear Zone:** Touch the [◀/▶] key to select the Rear Zone source.

## 5 Audio Setup Menu

This menu contains: EQ, Speaker, Sub-Out, Volume, Other

**EQ:** 15 Band adjustable with 3 user presets per audio source

**Speaker:** Set the balance and fader

**Sub-Out:** Set the sound level and crossover

**Volume:** Set the volume start volumes

**Other:** Set Toslink ON or OFF, Set Mic Location, Source Gain, Gain

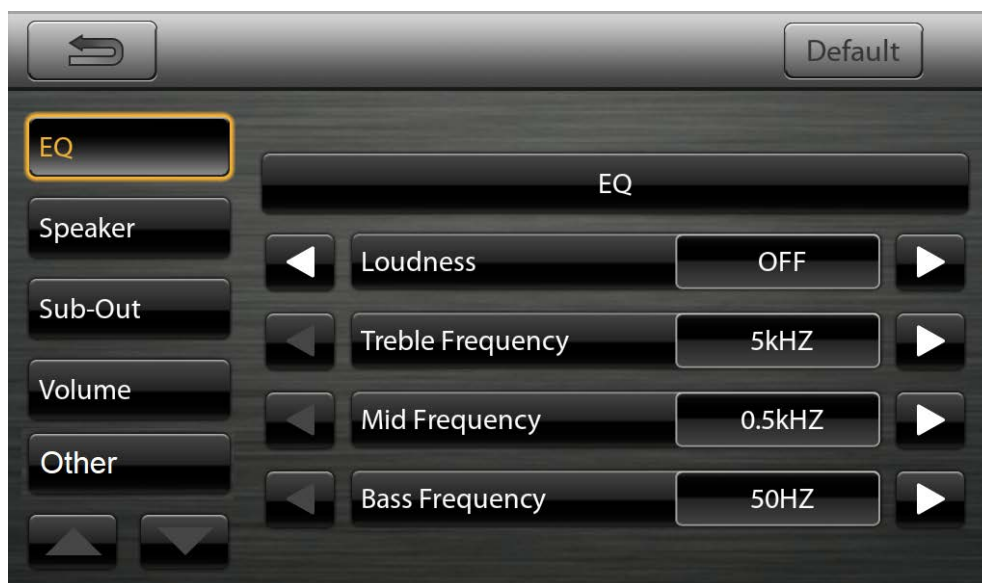

# 6 CarPlay

## 6.1 Set up CarPlay with your iPhone

You can use CarPlay to get directions, make calls, send and receive messages, and more.

You need an iPhone 5 or later to use CarPlay. Also, make sure that you're in an area that supports CarPlay and that Siri is on. To turn on Siri, go to Settings > Siri & Search.

## 6.2 Set up CarPlay

1. Make sure that your car or stereo supports CarPlay.
2. Plug your iPhone into the CarPlay USB port. The USB port might be labeled with a CarPlay icon or a smartphone icon. If the CarPlay Home screen doesn't appear, select the CarPlay logo on your car's display.
  - If your car supports CarPlay over a wired solution, plug your iPhone into the USB port of your car. The USB port might be labeled with a CarPlay icon or a smartphone icon.
  - If your car supports wireless CarPlay, press and hold the Voice Control button on your steering wheel to set up CarPlay. Or make sure that your car is in wireless or Bluetooth pairing mode. Then on your iPhone, go to Settings > General > CarPlay > Available Cars and select your car. See your car's manual for more information.
3. Make sure that your car is running.
4. Ask Siri for what you need. You can do this in a few ways:
  - If your car has one, press and hold the Voice Control button on your steering wheel. Then ask what you need.
  - If you have a touch screen, touch and hold the Home button in CarPlay until Siri appears on your stereo display. Then ask what you need.

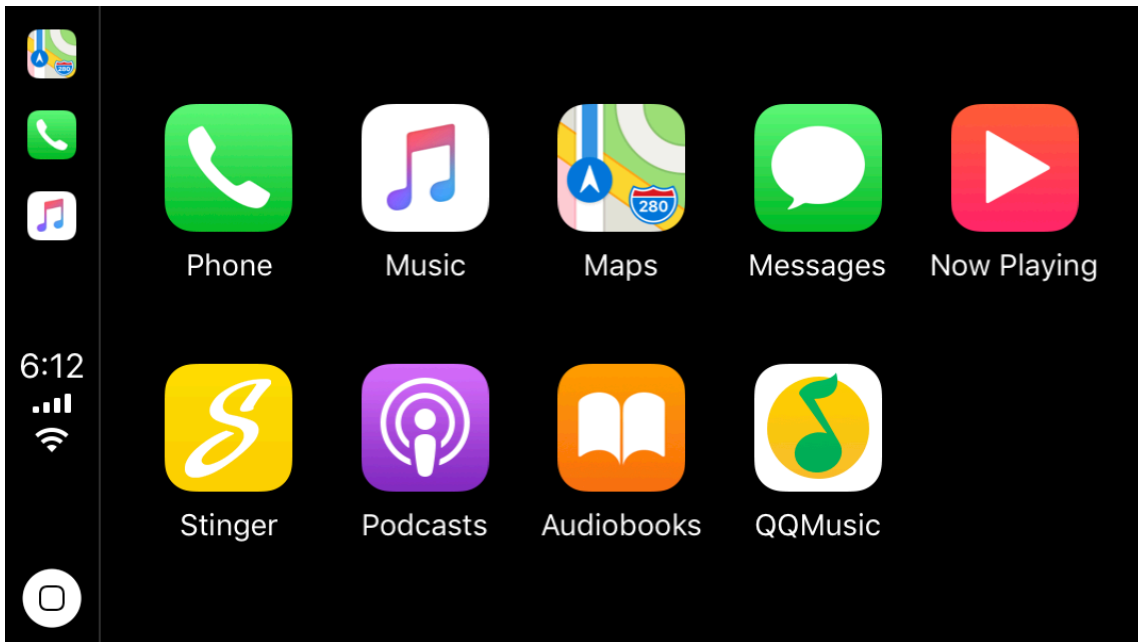

### 6.3 Troubleshooting:

If CarPlay doesn't work like you expect, here's what you can check. After each step, try using CarPlay again.

1. Make sure that Siri is turned on.
2. Restart your iPhone and your car. Depending on your car, you might see the CarPlay Home screen when you turn it on. If you don't, look for the CarPlay logo on your car's display.
3. If possible, connect your iPhone to a different USB port in your car.
4. Try a different Lightning to USB cable. Make sure that the cable is certified.
5. Update to the latest version of iOS.
6. You might need to install firmware updates for your stereo.

# 7 Android Auto

## 7.1 Using Android Auto

### Home screen

The first screen you'll see when you start Android Auto is your Home Screen. You'll find personalized information here, like time to your destination, reminders, recent calls incoming messages, the song you're listening to, and Google Now cards.

Here's what your Home Screen looks like and information about each section:

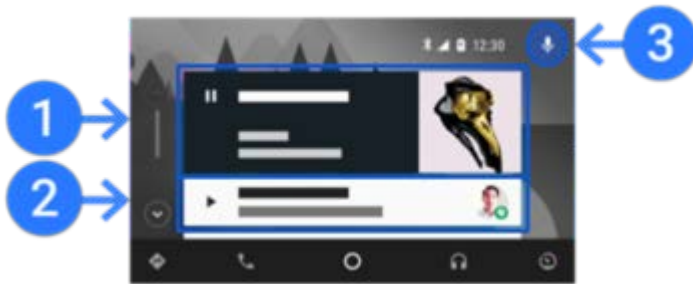

1. Current media selection.
2. Reminders, messages, calls, and other alerts.
3. Microphone.

You can say "OK Google" or select the microphone  to talk to Google. Your car might also have a physical voice command button on the steering wheel that you can press and hold to talk to Google. Check your user guide or consult your car's manufacturer for more information.

### More screens

You'll find the rest of your apps and features on these screens:



1. Maps and navigation. 2. Calls and contacts. 3. Home Screen. 4. Music and audio. 5. Exit

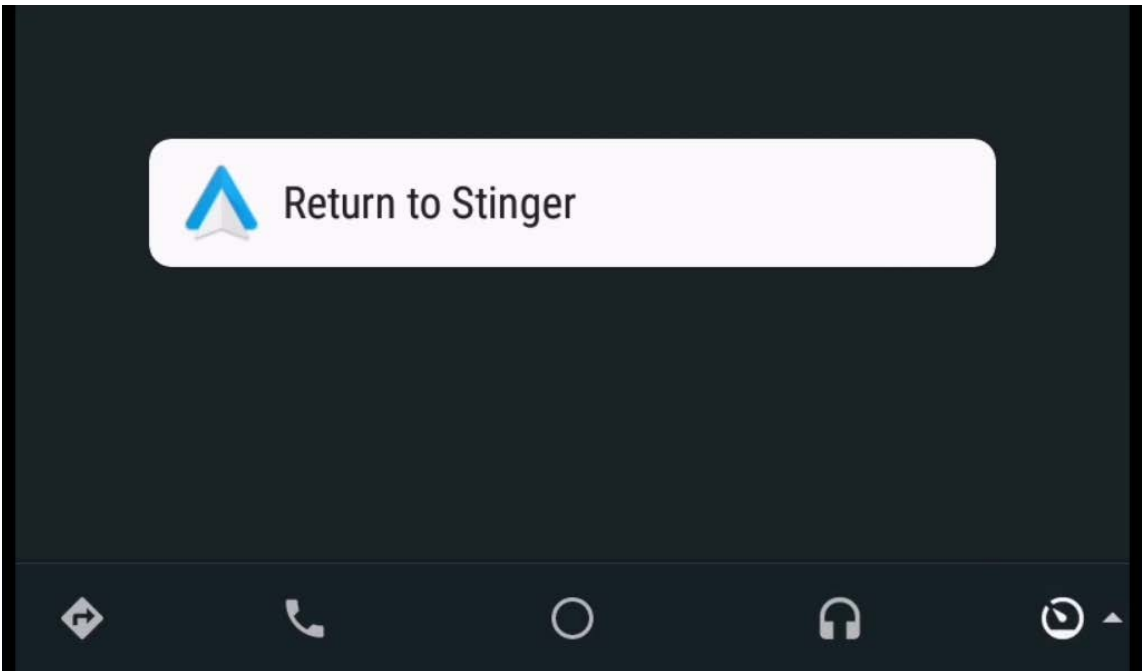

# 8 NNG onboard Navigation (optional)

## 8.1. To initialize: (First power-up timing only)

Basically, just touch “Next” button. If you want, you can customize settings.

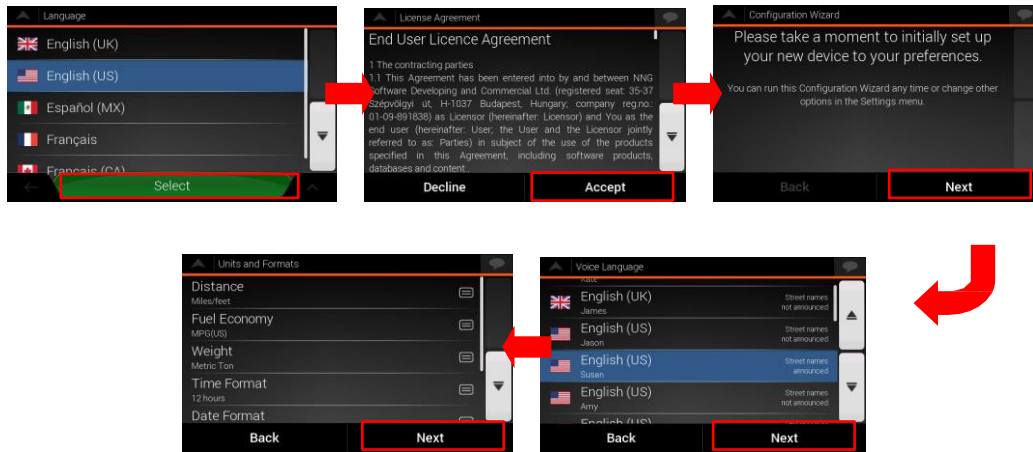

## 8.2. To Set Destination

1. Touch Navigation MENU “☰” icon.
2. Touch “New Route” button.
3. There are several ways to select your destination. Choose one of them.
4. Touch the “Select as Destination”.
5. Touch the “Start Navigation”.

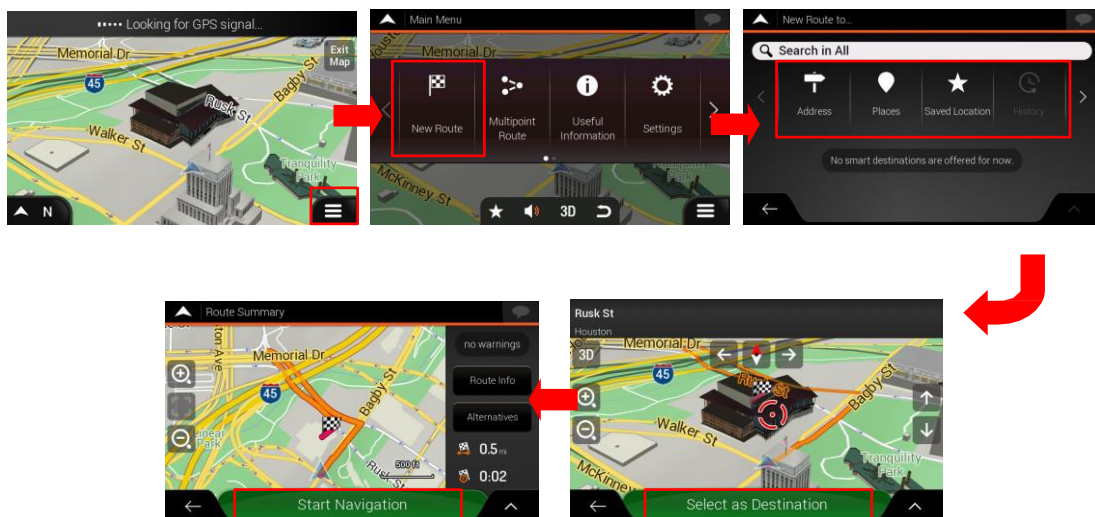

### 8.3. To Start Guidance Simulation

1. Touch Navigation MENU “☰” icon.
2. Touch “Route Summary” button.
3. Touch “^” icon.
4. Select “Simulation”.

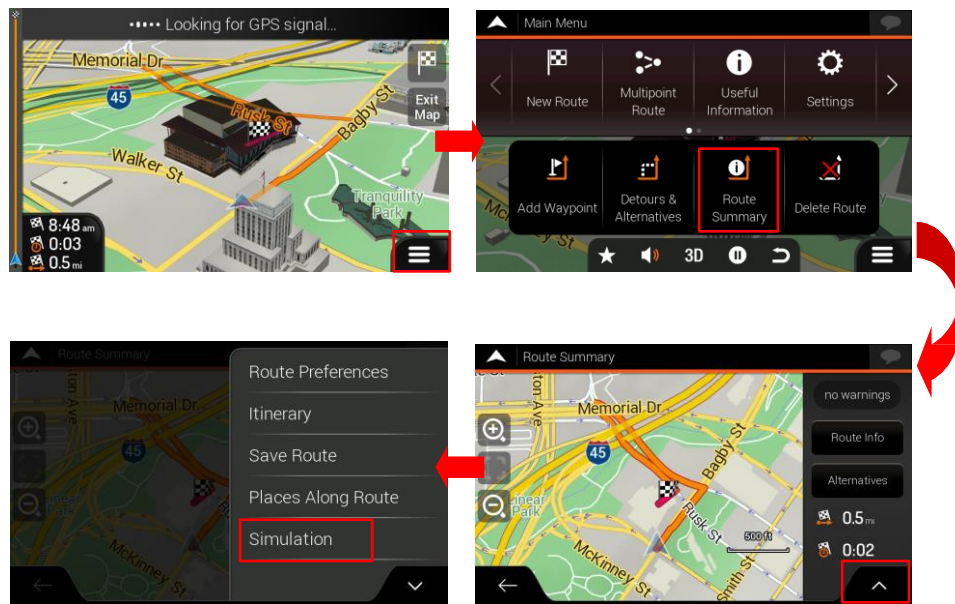

## 9 Bluetooth Operations

### 9.1. Bluetooth Paring

1. Turn on the power of the cellular phone you wish to register.
2. Touch the [Bluetooth] key to display the Device Select screen.
3. Touch the [Add] key to display the Inquiring Device screen.







## 9.2. Bluetooth Setting

1. Touch the  key to display the Devices information on the screen.
2. Touch the **[Setup]** key to display the Setup information on the screen.



## 9.3. Telephone operations

1. Touch the  key to display the Ten-Key pad screen.
2. Enter the telephone number by using the Ten-Key pad displayed on the screen.
3. Touch the  (Send) key to call the number.
4. When the call is finished, touch the  (End) key to hang up.



## 9.4. Bluetooth Audio Player Operations

1. Confirm that Bluetooth device is connected.
2. Press “HOME” button and choose “BT Music” source.
3. Bluetooth Audio mode screen will be displayed.





### Pausing playback

- Touch the [  ] key during playback.

### Playback pauses.

- To resume playback, touch the [  ] key. Playback resumes.

### Skipping a track

- Press the [  ] or [  ] button during playback, Tracks are skipped.

## 10 Camera Operations

### Switching to Camera mode

- Touch the [ **Camera** ] key on Main Menu to select desired mode.
- The LCD will display the external camera video. The screen will display "No Video Signal" menu, if a valid camera is not connect to this head unit.
- Press Menu button on Operational Panel to return to the Main Menu.

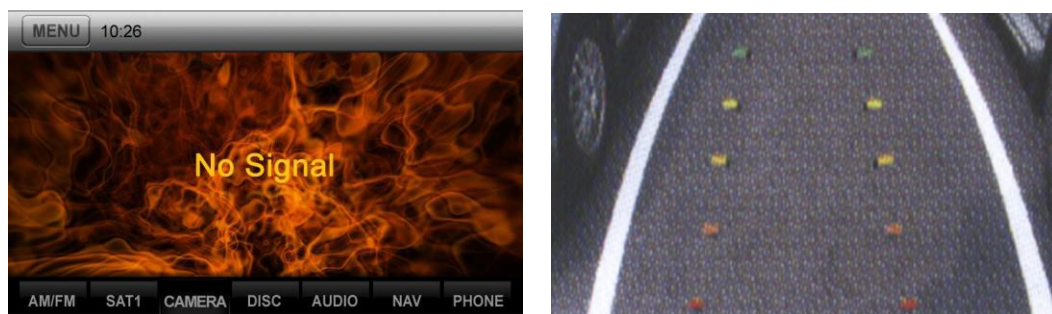

### \*Note:

*If the reverse cable is connected correctly to the car, the head unit will go to camera mode automatically when the car is in reverse.*

# Contents

Basic Operation Manual for UN1880.....	1
1 Operations.....	4
1.1. Panel buttons.....	4
1.2. Change Audio Source.....	10
2 AM/FM Radio Operations.....	11
3 SXM Operations.....	12
4 Settings Operation .....	13
4.1 Main Settings.....	13
4.2 Camera Settings.....	<i>Error! Bookmark not defined.</i>
4.3 Style Settings.....	13
4.4 Set Bottom Tabs .....	14
4.5 Display Setup Menu.....	14
5 Audio Setup Menu .....	15
6 CarPlay .....	16
6.1 Set up CarPlay with your iPhone.....	16
6.2 Set up CarPlay.....	16
6.3 Troubleshooting: .....	17
7 Android Auto.....	18
7.1 Using Android Auto .....	18
Home screen.....	18
More screens .....	18
8 NNG onboardNavigation (optional).....	20
8.1. To initialize: (First power-up timing only).....	20
8.2. To Set Destination.....	20
8.3. To Start Guidance Simulation .....	21
9 BluetoothOperations.....	21



# 11 HDMI Operations

External peripheral devices, including android or iPhone etc. can be connected to the unit through HDMI Line. Then you can see the phone screen on the HDMI app, you can watch movie which in your phone on unit.



# 12 AV IN

External peripheral devices, including a game console, camcorder, navigation unit, iPod/iPhone, etc. can be connected to the AUX 1 connector on the back of this unit using the A/V media cables.

1. Touch [  AV-2 ] button on Main Menu to select desired mode (when unit is reading).
2. Touch [  AV-1 ] or [  ] button in other source to select desired mode.

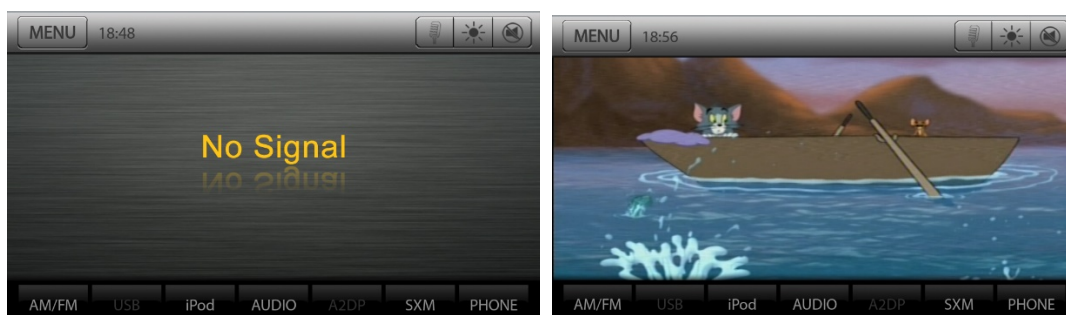

Note: This equipment has been tested and found to comply with the limits for a Class B digital device, pursuant to Part 15 of the FCC Rules. These limits are designed to provide reasonable protection against harmful interference in a residential installation. This equipment generates, uses, and can radiate radio frequency energy, and if not installed and used in accordance with the instructions, may cause harmful interference to radio communications. However, there is no guarantee that interference will not occur in a particular installation. If this equipment does cause harmful interference to radio or television reception, which can be determined by turning the equipment off and on, the user is encouraged to try to correct the interference by one or more of the following measures:

- Reorient or relocate the receiving antenna.
- Increase the separation between the equipment and receiver.
- Connect the equipment into an outlet on a circuit different from that to which the receiver is connected.
- Consult the dealer or an experienced radio / TV technician for help.

Changes or modifications not expressly approved by the party responsible for compliance could void the user's authority to operate the equipment. This device complies with Part 15 of the FCC Rules. Operation is subject to the following two conditions:

- (1) this device may not cause harmful interference, and
- (2) this device must accept any interference received, including interference that may cause undesired operation.

This equipment complies with FCC radiation exposure limits set forth for an uncontrolled environment. This equipment should be installed and operated with a minimum distance of 20cm between the radiator & your body. This transmitter must not be co-located or operating in conjunction with any other antenna or transmitter.