

Hardware Reset

If the device stops functioning properly or has become unresponsive, perform a hardware reset by pressing the reset button gently using a small paperclip. The front LED blinks once during reset.

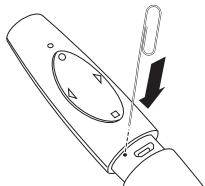

CLASS 2 LASER SAFETY STATEMENT



This laser device complies with International Standard IEC/EN 60825-1: ED 2, 2007, Class 2 Laser Product and also complies with 21 CFR 1040.10 and 1040.11, except for deviations pursuant to laser Notice No. 50, dated June 24, 2007:

1. Emission of a parallel beam of visible light;
2. Maximum Power of 1 milliwatt CW, wavelength range 650±20 nanometers;
3. Operating temp between 0 °C (32° F) to 40° C (104° F).
 - Do not disassemble the device
 - Do not use the device outside of its specified operating temperature range. If the device is exposed to an environment outside of its prescribed operation, turn off the device and allow the temperature to stabilize within the specified operating range before using the device.

901-2624-00
KL

Need More?

For additional instructions and disclosures, see the full Instruction Guide online at:
www.kensington.com/man/K39524

Technical Support

Technical support is available to all registered users of Kensington products.

Web Support

You may find the answer to your problem in the Frequently Asked Questions (FAQ) section of the Support area on the Kensington Website:
www.support.kensington.com.

Telephone Support

There is no charge for technical support except long-distance charges where applicable. Please visit www.kensington.com for telephone support hours.

U.S. 800-535-4242 or 650-572-2700
Canada 800-268-3447

Please note the following when calling support:

- Call from a phone where you have access to your device.
- Be prepared to provide the following information:
 - Name, address, and telephone number
 - Name of the Kensington product
 - Make and model of your computer
 - System software and version
 - Symptoms of the problem and what led to them

Kensington and the ACCO name and design are registered trademarks of ACCO Brands. The Kensington Promise is a service mark of ACCO Brands. Presentair is a trademark of ACCO Brands. All other registered and unregistered trademarks are the property of their respective owners.

© 2012 Kensington Computer Products Group, a division of ACCO Brands USA LLC. Any unauthorized copying, duplicating, or other reproduction of the contents hereof is prohibited without written consent from Kensington Computer Products Group. All rights reserved. 05/12

Kensington®

Presentair™ Bluetooth® Presenter, Laser & Stylus

QUICK START GUIDE

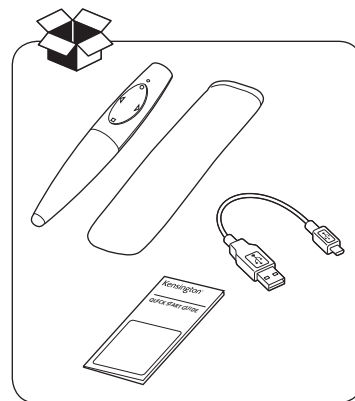

Register New Product Now
To Activate Warranty!
register.kensington.com

S/N:

For technical support visit:
Pour tout support technique veuillez visiter:
www.kensington.com

The Kensington Promise™

Complete warranty terms are available at:
www.warranty.kensington.com

Kensington Computer Products Group
A Division of ACCO Brands
333 Twin Dolphin Drive, Sixth floor
Redwood Shores, CA 94065

ACCO Australia Level 2, 8 Lord St Botany NSW 2019 Australia	ACCO Brands Europe Oxford Road Aylesbury Bucks, HP21 8SZ United Kingdom
---	--

Designed in California, U.S.A.
by Kensington
Made in China
Patents Pending www.kensington.com

Getting Started

- 1 Charge your Presentair™ Bluetooth Presenter Remote on any USB port or charging adapter for 2 hours before initial use or when the front LED blinks orange, indicating the battery is low.

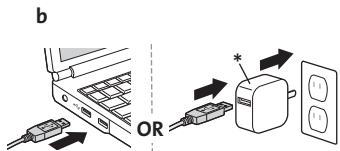
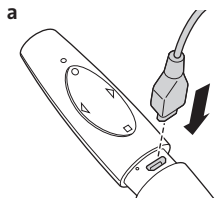

NOTE: This device has USB charging function only, and will not appear on your system as a data device when plugged into a USB port.

- 2 The Rear LED blinks orange during charging. When the Presenter Remote is fully charged, the Rear LED glows solid orange.

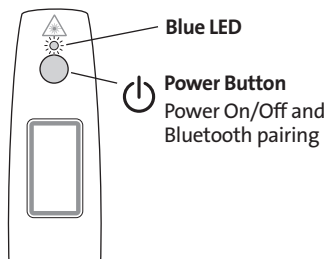

Power On/Off

1 From On State—To Turn Power Off

Press and hold the **Power Button**. The Presentair rear blue LED blinks rapidly. Release button, the LED fades off and the power turns off.

2a From Off State—To Turn Power On

Press the **Power Button** for 1 second and release. The blue LED glows, the power turns on, then the LED turns off.

OR

2b From Off State—To Pair Device

Press and hold the **Power Button** from 3 to 6 seconds. The blue LED blinks slowly and Presentair enters **Pairing Mode**. Release button, it stays in pairing mode for 3 minutes or until paired to a device.

Pairing

On the computer you are pairing Presentair to, be sure the Bluetooth Wireless is on, active, and ready to connect to a device. Follow the Bluetooth pairing instructions from your computer manufacturer for connecting Presentair. Presentair appears as a **mouse device** for pairing.

NOTE: Your computer's Bluetooth configuration settings need to be set to allow devices to connect to this computer. Some Windows configuration and update settings may interfere with the Bluetooth connection or function. Ensure your Windows services for **Bluetooth Service and Support** are **Started** and set to **Automatic** (found in **Administrative Tools > Services**). Ensure your Windows Bluetooth power management is not set to turn off your Bluetooth Wireless (found in **Device Manager > Bluetooth > Properties > Power Management**). Updating Bluetooth Drivers to the latest version found on your equipment manufacturer's website is recommended and may be necessary.

If you experience problems pairing or using Presentair, additional instructions, FAQs, and solutions with illustrations are found in the online guide at:
www.kensington.com/man/K39524

Mode Switching

Press and hold the **Down Button** to switch between Presentation and Media modes.

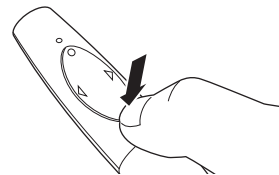

Presentation mode = Orange LED
Media mode* = Blue LED

* Laser does not activate in Media Mode.

Button	Presenter Mode (LED=Orange)	Media Mode (LED=Blue)
Up Button	Turns laser on as long as button is pressed.	Play/Pause
Down Button	Black screen	Stop
Left Button	Page up	Previous song/video
Right Button	Page down	Next song/video

* Power supply not included

**Federal Communication Commission
Interference Statement**

This equipment has been tested and found to comply with the limits for a Class B digital device, pursuant to Part 15 of the FCC Rules. These limits are designed to provide reasonable protection against harmful interference in a residential installation. This equipment generates, uses and can radiate radio frequency energy and, if not installed and used in accordance with the instructions, may cause harmful interference to radio communications. However, there is no guarantee that interference will not occur in a particular installation. If this equipment does cause harmful interference to radio or television reception, which can be determined by turning the equipment off and on, the user is encouraged to try to correct the interference by one of the following measures:

- Reorient or relocate the receiving antenna.
- Increase the separation between the equipment and receiver.
- Connect the equipment into an outlet on

a circuit different from that to which the receiver is connected.

- Consult the dealer or an experienced radio/TV technician for help.

FCC Caution: Any changes or modifications not expressly approved by the party responsible for compliance could void the user's authority to operate this equipment.

This device complies with Part 15 of the FCC Rules. Operation is subject to the following two conditions: (1) This device may not cause harmful interference, and (2) this device must accept any interference received, including interference that may cause undesired operation.

IMPORTANT NOTE:

Radiation Exposure Statement:
The product comply with the US portable RF exposure limit set forth for an uncontrolled environment and are safe for intended operation as described in this manual. The further RF exposure reduction

can be achieved if the product can be kept as far as possible from the user body or reduce output power if it doesn't affect the transmission/receiving quality.

IC Statement

This device complies with RSS-210 of the Industry Canada Rules. Operation is subject to the following two conditions: (1) This device may not cause harmful interference, and (2) this device must accept any interference received, including interference that may cause undesired operation.

Radiation Exposure Statement:
The product comply with the Canada portable RF exposure limit set forth for an uncontrolled environment and are safe for intended operation as described in this manual. The further RF exposure reduction can be achieved if the product can be kept as far as possible from the user body or set the device to lower output power if such function is available.

Ce dispositif est conforme a la norme CNR-210 d'Industrie Canada applicable aux appareils radio exempts de licence.

Son fonctionnement est sujet aux deux conditions suivantes: (1) le dispositif ne doit pas produire de brouillage prejudiciable, et (2) ce dispositif doit accepter tout brouillage recu, y compris un brouillage susceptible de provoquer un fonctionnement indesirable.

Déclaration d'exposition aux radiations:
Le produit est conforme aux limites d'exposition pour les appareils portables RF pour les Etats-Unis et le Canada établies pour un environnement non contrôlé.

Le produit est sûr pour un fonctionnement tel que décrit dans ce manuel. La réduction aux expositions RF peut être augmentée si l'appareil peut être conservé aussi loin que possible du corps de l'utilisateur ou que le dispositif est réglé sur la puissance de sortie la plus faible si une telle fonction est disponible.