

## 2 Setting Up

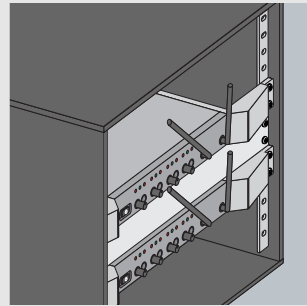

Fitting the receiver in a 19" rack. Leave one unit space free between two receivers in the rack.

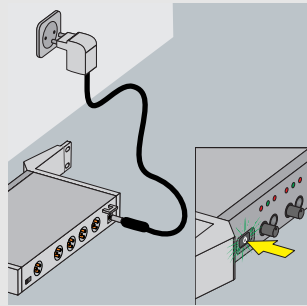

Connect receiver to the mains.

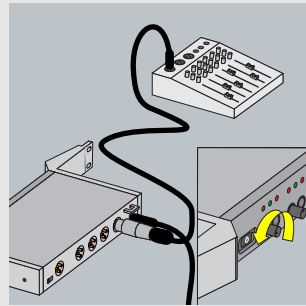

Reduce audio level (2) and connect receiver to balanced input (10).

## 2 Setting Up

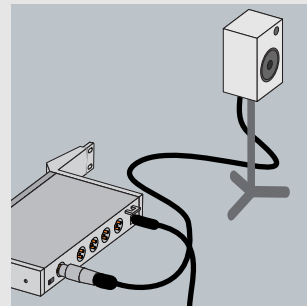

Connect the sum output (9) to a monitor.

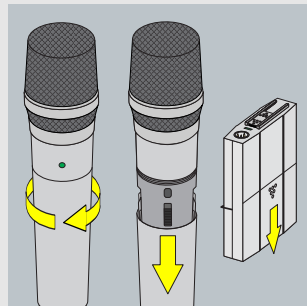

Remove battery cover (14 / 22).

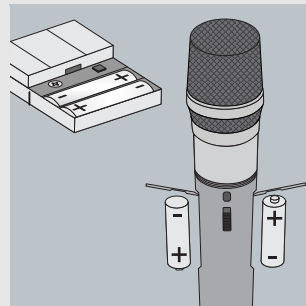

Insert batteries.

## 2 Setting Up

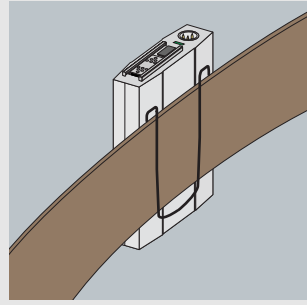

Attach bodypack transmitter to a belt with the battery compartment facing away from the body.

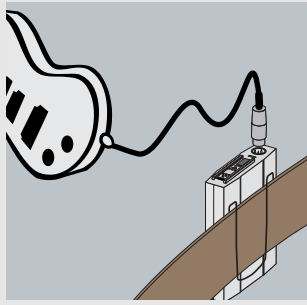

Connect instrument or microphone to the mini XLR connector of the bodypack transmitter.

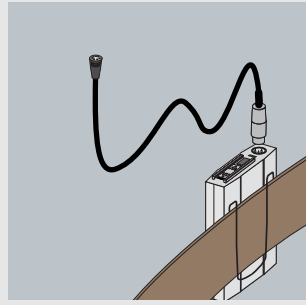

## 3 Channel Recognition

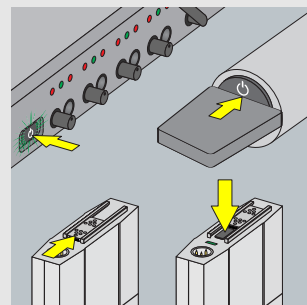

Switch on receiver (1) and transmitter (15).

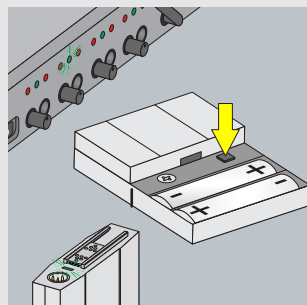

Check channel by pressing **CONNECT** on the transmitter (16) or receiver (3). The **STATUS LEDs** of the transmitter (13) and receiver (5) on the same channel will flash.

## 4 Auto Correction

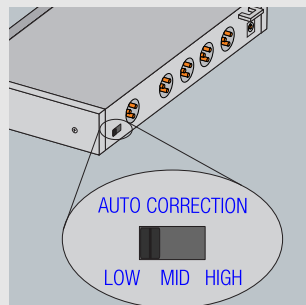

Set **AUTO CORRECTION** (8) to **LOW** in normal operating mode. If there is interference in the 2.4 GHz ISM frequency range, set **AUTO CORRECTION** to **MID** or **HIGH**.

## 5 Channel Assignment

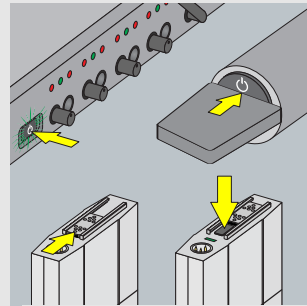

Switch on receiver (15) and transmitter (1).

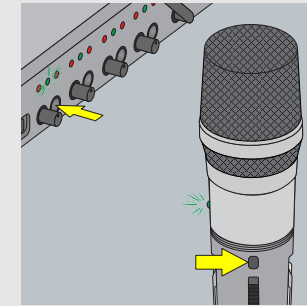

Assignment can be started from both the transmitter and receiver. In this example, it is started from the receiver. Press **CONNECT** (3) on a free channel of the receiver and hold down until the **STATUS LED** (5) starts to flash after approximately 2 seconds. Press **CONNECT** (16) on the transmitter until **STATUS LED** (13) lights up green. The **STATUS LEDs** on the transmitter (13) and the receiver (5) light up green once assignment has been successful.

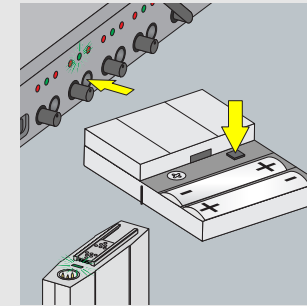

## 6 Registration

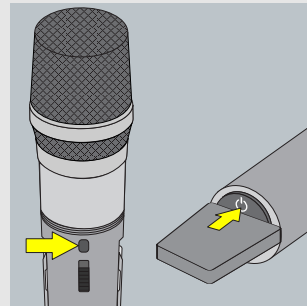

Registration can be started from both the transmitter and receiver. In this example it is started from the transmitter. Switch on the receiver. Press **CONNECT** (16) along with **ON/OFF** (15) on the transmitter until **STATUS LED** (13) starts to flash quickly.

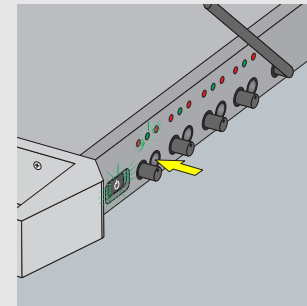
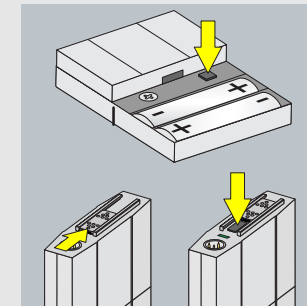

Hold down **CONNECT** (3) on a free channel of the receiver until the **STATUS LED** (5) lights up green. The **STATUS LEDs** on the transmitter (13) and the receiver (5) light up green after successful registration.

## 7 Tips & Tricks

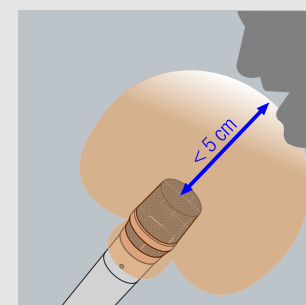

In the case of microphones with a hypercardioid polar pattern, most sound attenuation occurs at 180°. These microphones should therefore preferably be used where there is an interference noise source or a loudspeaker directly opposite the speaker. Holding the microphone less than 5 cm from your mouth will give your voice a voluminous and punchy quality.

## 7 Tips & Tricks

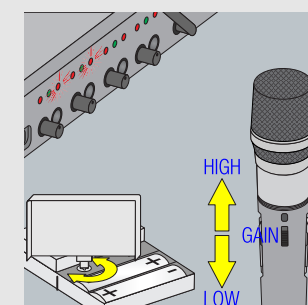

Adjust the input sensitivity on the DPT70 pocket transmitter using the screwdriver included in the battery compartment cover; on the DHT70 manual transmitter, use the slide control: If **CLIP** lights up frequently, set the **GAIN** on the DHT70 to **LOW** and reduce the potentiometer setting on the DPT70.

## 7 Tips & Tricks

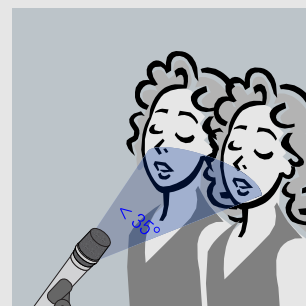

Never let more than 2 people sing into one microphone. The angle of incidence should never be more than 35°!