

User Manual



Contents

1	INFORMATION FOR USER MANUAL.....	3
3.2	KEY EXPLAIN	6
4	LINKING TO THE NETWORKS AND DEVICES.....	7
5	USING THE TOUCH SCREEN	8
6	DIALING CALLS AND SENDING MESSAGES	9
7.1	CAMERA.....	10
7.2	GALLERY	11
7.3	MUSIC.....	11
7.4	FM RADIO	11
7.5	VIDEO PLAYER.....	12
8	USING THE MENUS.....	13
8.1	BROWSER.....	13
8.2	SOUND RECORDER.....	13
8.3	CLOCK.....	13
8.4	FILE MANAGER.....	13
8.5	CANLENDAR	14
8.6	EMAILS.....	14
8.7	PLAY STORE	14
8.8	GOOGLE.....	14
8.9	SEARCH.....	14
8.10	NOTES	14
8.11	VOICE SEARCH.....	15
8.12	STK.....	15
9	APPENDIX	15

1 INFORMATION FOR USER MANUAL

The content of the manual is correct as and when it is released. This manual is for information only and subject to change without prior notice. Reasonable efforts have been made in the preparation of this manual to assure its accuracy and Digicom Trading (pvt) Limited assumes no liability resulting from any errors or omissions in this manual, or from the use of the information contained herein.

Digicom Trading (pvt) Limited operates on a policy of continuous development. Digicom Trading (pvt) Limited reserves the right to make improvements, changes or revisions in the design of the phone or the information contained in the manual without any obligation to notify any person of such revisions and changes and without prior notice.

Some of the contents in this manual may differ from your phone, depending on the software installed, your SIM card or your service provider and is subject to change without prior notice.

You may incur additional charges for usage of data services, such as messaging, uploading and downloading, auto-syncing, or using location services. To avoid additional charges and details, please contact your service provider.

2. UNDERSTAND YOUR PHONE



1. MICRO USB PORT	2. EARPHONE PORT
3. RECEIVER	4. FRONT CAMERA
5. VOLUME KEYS	6. POWER ON KEY
7. BACK CAMERA	8. SPEAKER

3. GETTING STARTED

3.1 Switch off your phone before SIM/memory card insertion/removal and insert the cards into the phone correctly.

a. Switch off your phone and remove the battery cover

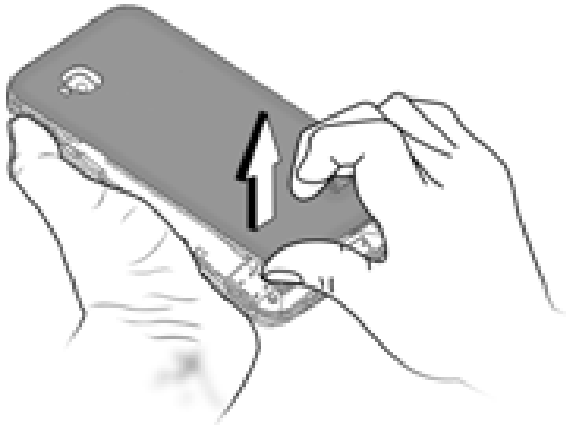

b. Remove the battery if inserted

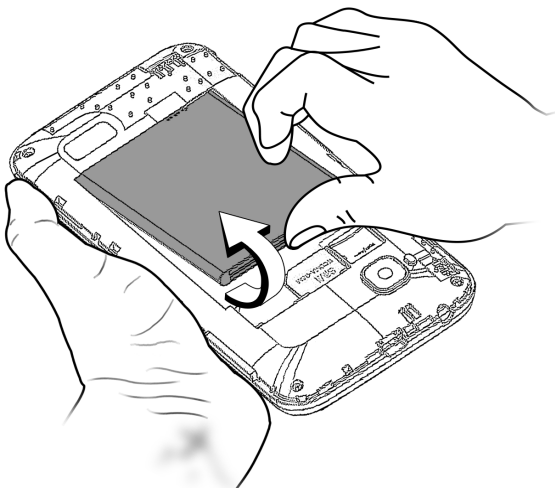

c. Insert SIM card correctly in the card slot(s), as shown:

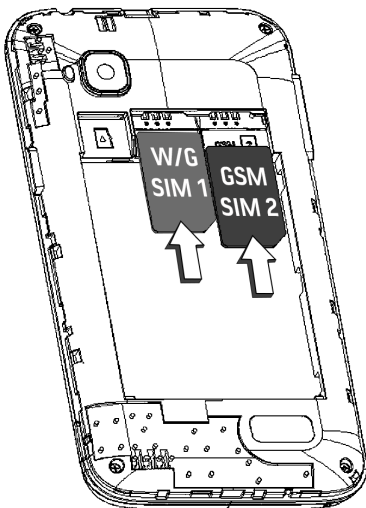

d. Insert the memory card in memory card slot.

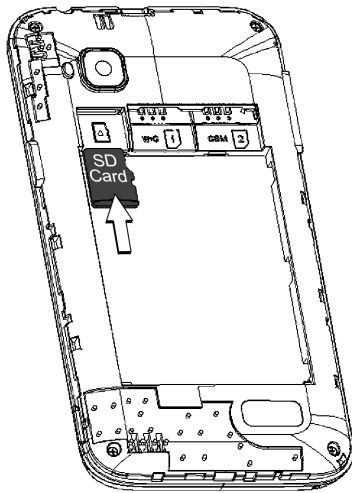

3.2 KEY EXPLAIN

Key	Function
Power (Lock)	Press the key to lock screen in any interface. Long press to power on or off.
Home	Press the key to enter into idle screen in any interface.
Menu	In the menu operation interface, according to the key can open operation menu.
Back	Executive back to operation, withdraw from the current interface.

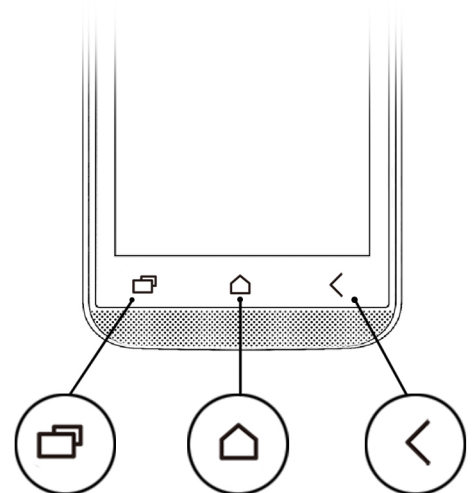
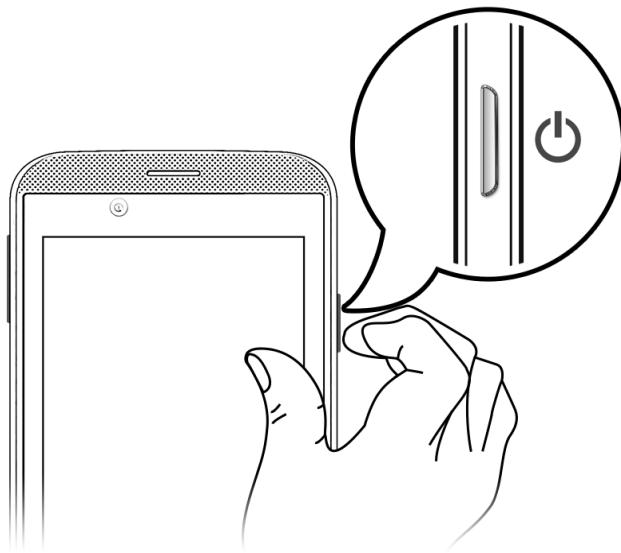

3.3 CHARGING THE BATTERY

Before using the device for the first time, we recommend you to charge the battery for a minimum of 4 hours.

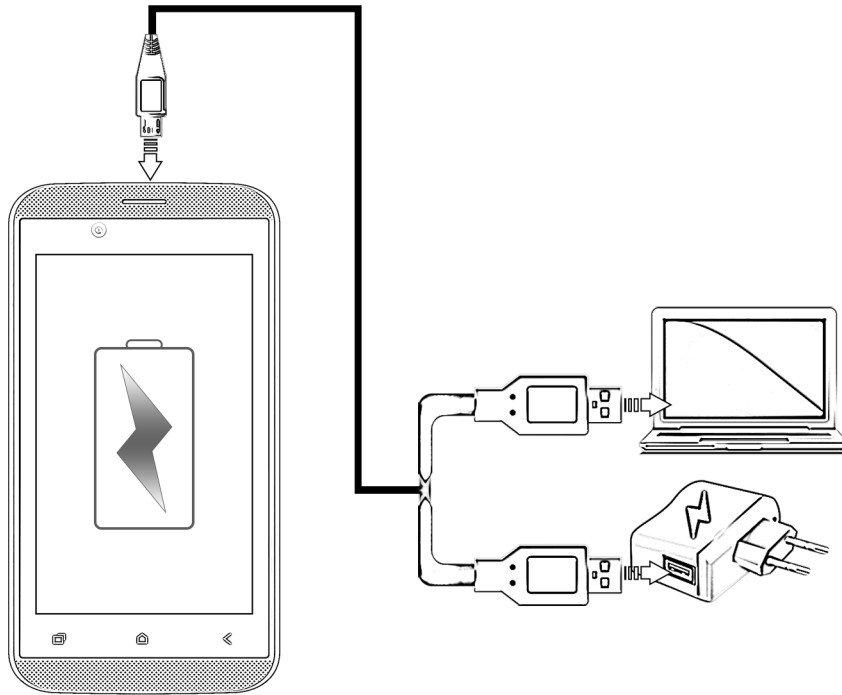

Note: You can charge the device with a travel adapter or connecting the device to a PC via a USB cable.

4 LINKING TO THE NETWORKS AND DEVICES

Your phone can connect to a variety of networks and devices, including mobile networks for voice and data transmission, Wi-Fi data networks, and Bluetooth devices, such as headsets. You can also connect your phone to a computer, to transfer files from your phone's SD card and share your phone's mobile data connection via USB.

4.1 Connecting to mobile networks

When you assemble your phone with a SIM card, your phone is configured to use your provider's mobile networks for voice calls and for transmitting data.

4.2 Connecting to Wi-Fi networks

Go to **Settings** → **Wireless&Networks** → **More** → **Tethering & portable hotspot**

4.2.1 Turn on the Wi-Fi hotspot option in your phone.

4.2.2 On the other Wi-Fi enabled PC/laptop/handset, choose your phone as a Wi-Fi network to connect with it. View and configure Wi-Fi hotspot settings by tapping the Set up Wi-Fi hotspot option.

4.3 Connecting to Bluetooth devices

Go to **Settings** → **Wireless & Networks** → **Bluetooth**

4.3.1 If Bluetooth is off, turn it on. Your phone scans and displays the BT devices in range.

4.3.2 Tap the ID of the other device in the list to pair with it.

4.3.3 You will be prompted to confirm passkey on both devices.

4.3.4 Tap **Pair** to confirm the passkey and pair the devices. On successful pairing, your phone connects to the device.

Note: *If the device you want to pair with is not in the list, make it discoverable and then search. If your phone stops scanning before you make the other device discoverable, tap SEARCH FOR DEVICES.*

4.4 Connecting to a computer via USB

You can connect your phone to a computer with a USB cable, to transfer music, pictures, and other files between your phone's SD card and the computer.

5 USING THE TOUCH SCREEN

5.1 Touch-screen tips

5.1.1 Touch

To act on items on the screen, such as application and settings icons, to type letters and symbols using the onscreen keyboard, or to press onscreen buttons, you simply touch them with your finger.

5.1.2 Touch & hold

Touch & hold an item on the screen by touching it and not lifting your finger until an action occurs. For example, to open a menu for customizing the Home screen, you touch an empty area on the Home screen until the menu opens.

5.1.3 Drag

Touch & hold an item for a moment and then, without lifting your finger, move your finger on the screen until you reach the target position.

5.1.4 Swipe or slide

To swipe or slide, you quickly move your finger across the surface of the screen, without pausing when you first touch it (so you don't drag an item instead). For example, you slide the screen up or down to scroll a list.

5.2 Lock screen

When Screen lock in Security setting is enabled, press Power key to lock the handset. This helps to prevent accidental touching of keys and as well as power saving. When Sleep function in Display setting is enabled, after the handset device has been idle for preset period, the screen will be locked automatically to save power.

5.3 Unlock screen

Press Power key to switch on the handset device. The lock screen appears. Touch and slide right to unlock screen, and the screen being locked last time will show.

6 DIALING CALLS AND SENDING MESSAGES

6.1 DIALING CALLS

6.1.1 Dialing a call to a number in the contacts

Touch the Phone icon or the phone application icon on the Home screen, then select the Contacts tab. Swipe or slide upward/downward to pick out the target contact. Then you can touch the dial icon to originate a call.

6.1.2 Dialing a call to a number in call log

Touch the Phone icon or the phone application icon on the Home screen, then select the call log tab. Swipe or slide upward/downward to pick out and touch the target contact. Then you can originate a call.

6.1.3 Answering incoming calls

Touch the Answer icon to answer an incoming call.

Touch the End icon to end the current conversation.

To reject an incoming call, touch the Decline icon.

6.1.4 Managing multiple calls

If you accept a new call when you're already on a call, you can touch the Answer icon to answer the current calls.

6.2 SENDING MESSAGES

6.2.1 Tap Message on the menu screen or home screen and then tap  to compose a message.

6.2.2 Tap  icon to view the types of files that can be attached and select the desired type of multimedia file.

6.2.3 Tap to select the composition text box and enter your message body in it.

6.2.4 Enter the contact name (if it exists) or enter the phone number. You can also tap the  icon to view and select contact(s) from the contact list.

6.2.5 Tap  to send the message.

7 MULTIMEDIA

7.1 Camera

Touch the Camera icon in the main menu interface or on the home screen, camera opens in Landscape mode, ready to take a picture. In this mode, you can touch the camera icon to take a photo, press photo icon and slide right to switch between camera and video mode.

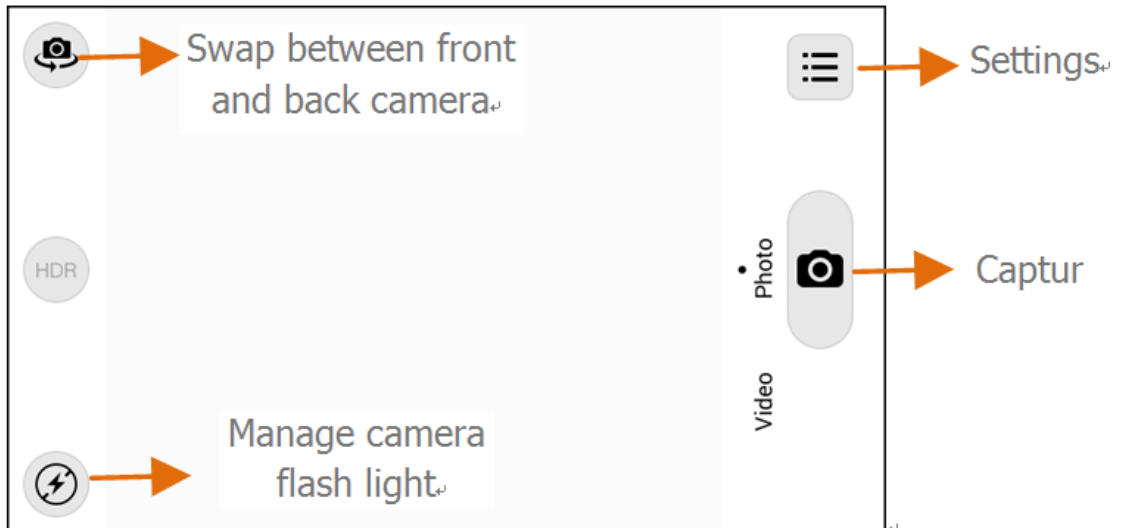

7.2 GALLERY

You can view pictures, play videos and share files from the Gallery. Tap an album to open and view its contents. You can share/copy/move/delete images and videos from the gallery.

7.3 MUSIC

Touch the Music icon in the main menu interface or on the Home screen.

When you copy music to your SD card, Music searches the card for music files and builds a catalog of your music, based on information about each file that is stored in the file itself. This can take from a few seconds to several minutes, depending on how many files you have copied onto the SD card. When the catalog is complete, the Music library screen opens, with tabs that you can touch to view your music library organized by Artists, Albums, Songs or Playlists.

Caution: Any sudden suspend during downloading music via USB cable may result in great damage to your SD card

7.4 FM RADIO

You can listen to your favorite FM channels using the inbuilt FM receiver of your phone. Before starting the FM, plug-in the headset as it works as antenna for the FM radio. Use the intuitive buttons and icons on the phone in the radio interface to enjoy the features of your inbuilt FM radio.



7.5 VIDEO PLAYER

Go to VIDEO PLAYER on home screen

Share Video

Settings



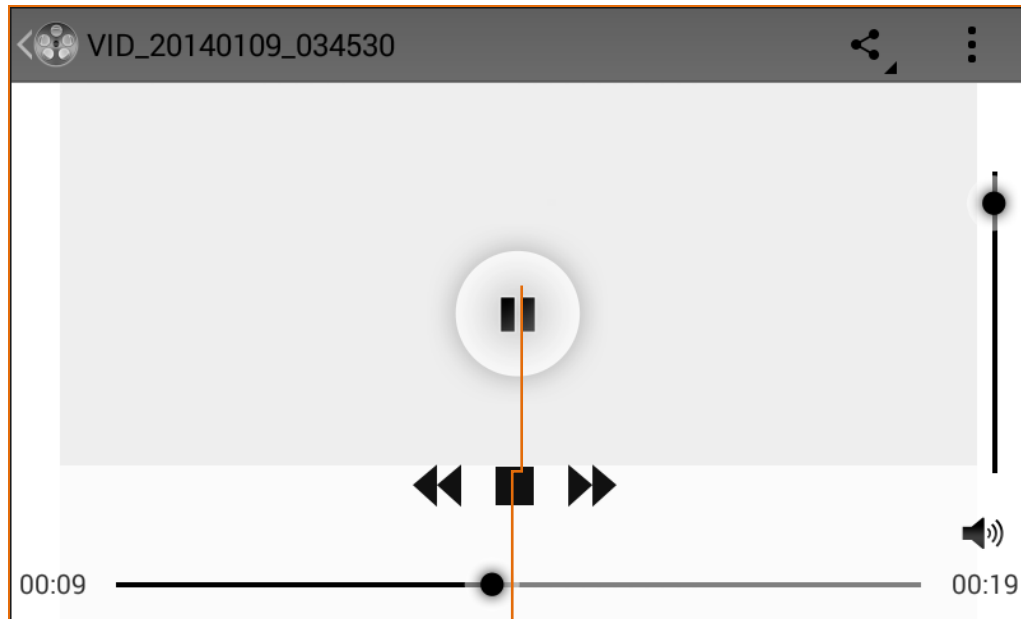

Play/Pause Video

8 USING THE MENUS

8.1 BROWSER

You can use the browser to visit a web page and network application.

Note: Access to the network will produce the extra cost, detailed tariff please consult your network service providers.

8.2 SOUND RECORDER

Enter into main menu, and select sound recorder. The function as follows:

Display recording duration.

Start recording your voice.

Stop or pause the recording.

NOTE: After stopping the recording, click the 'ok' can save this recording to file management corresponding folder, press 'cancel' will clear recorded sound file.

8.3 CLOCK

Touch the Clock icon on the Home screen or in the main menu interface. You can set an alarm by modifying an existing alarm or by adding a new one.

8.4 FILE MANAGER

You can manage your application through this function.

8.5 CANLENDAR

View the calendar. You can create a calendar and notepad.

8.6 EMAILS

You use the Email application to read and send email.

Touch email icon to access it. If the Email account has not been set up, you can set up an Email account in a few steps.

8.7 PLAY STORE

When you first open Play store, a guide will display to guide you to use this function.

8.8 GOOGLE

You can search and view something in your phone or webpage after connect with internet through this function.

8.8.1 GOOGLE SETTINGS

You can set parameters of Google through this function.

8.8.2 MAPS

Google Maps is a web-based service offered by Google Inc. which offers you access to various map-based services. You can view various streets, landmarks and can even plan your routes with the help of Google Maps. It comes with a navigation system (GPS required) which gives step-by-step route guidance while driving or walking. You can even download maps for offline usage. This serves as a useful application for your day-to-day usage.

8.9 SEARCH

You can search all communication on the mobile, contacts, call log, application, as well as specific information on the internet.

Input the search content, click on the button to the right of the input box to start the search and display the results.

8.10 NOTES

You can create new note through this function.

8.11 VOICE SEARCH

You can search any application in your phone or website through voice after connected to internet.

8.12 STK

STK service is the tool kit of SIM card. This phone supports the service function .The specific items are depended by SIM card and network. Service menu will be auto added to the phone menu when supported by network and SIM card.

9 APPENDIX

Troubleshooting

If you find exceptions when operating the mobile phone, restore the factory settings and then refer to the following table to solve the problem. If the problem persists, contact the distributor or service provider.

Fault	Cause	Solution
SIM card error	The SIM card is damaged.	Contact your network service provider
	The SIM card is not in position.	Check the SIM card
	The metal face of the SIM card is polluted.	Clean the SIM card with a clean cloth
Poor received signal quality	Signals are obstructed. For instance, radio waves cannot be effectively transmitted nearby a high building or in a basement.	Move to a place where signals can be effectively transmitted
	Line congestions occur when you use the mobile phone in high-traffic hours	Avoid using the mobile phone in high-traffic hours

The mobile phone cannot be powered on	The battery energy is exhausted.	Charge the battery
Calls cannot be dialed	Call barring is activated	Cancel call barring
The mobile phone cannot connect the network	The SIM card is invalid	Contact your network service provider
	The mobile phone is not in a service area of the GSM network	Move to the network operator's service area
	The signal is weak	Move to a place where the signal quality is high
The battery cannot be charged	The charging voltage does not match the voltage range indicated on the charger	Ensure the charging voltage matches the voltage range indicated on the charger
	An improper charger is used	Use the charger specially designed for the mobile phone
	Poor contact	Ensure the charger plug is in good contact with the mobile phone

FCC Warning:

This equipment has been tested and found to comply with the limits for a Class B digital device, pursuant to Part 15 of the FCC Rules. These limits are designed to provide reasonable protection against harmful interference in a residential installation. This equipment generates uses and can radiate radio frequency energy and, if not installed and used in accordance with the instructions, may cause harmful interference to radio communications. However, there is no guarantee that interference will not occur in a particular installation. If this equipment does cause harmful interference to radio or television reception, which can be determined by turning the equipment off and on, the user is encouraged to try to correct the interference by one or more of the following measures:

- Reorient or relocate the receiving antenna.
- Increase the separation between the equipment and receiver.
- Connect the equipment into an outlet on a circuit different from that to which the receiver is connected.
- Consult the dealer or an experienced radio/TV technician for help.

Changes or modifications not expressly approved by the party responsible for compliance could void the user's authority to operate the equipment.

This device complies with part 15 of the FCC Rules. Operation is subject to the following two conditions: (1) This device may not cause harmful interference, and (2) this device must accept any interference received, including interference that may cause undesired operation.

RF Exposure Information (SAR)

This device meets the government's requirements for exposure to radio waves. This device is designed and manufactured not to exceed the emission limits for exposure to radio frequency (RF) energy set by the Federal Communications Commission of the U.S. Government.

The highest reported SAR values for head and body are below:

Head: **0.816W/kg(1g)**; Body:**0.904W/kg(1g)** respectively.

WARNING!! Read this information before using your phone

In August 1986 the Federal Communications Commission (FCC) of the United States with its action in Report and Order FCC 96-326 adopted an updated safety standard for human exposure to radio frequency (RF) electromagnetic energy emitted by FCC regulated transmitters. Those guidelines are consistent with the safety standard previously set by both U.S. and international standards bodies. The design of this phone complies with the FCC guidelines and these international standards. Use only the supplied or an approved antenna. Unauthorized antennas modifications, or attachments could impair call quality, damage the phone, or result in violation of FCC regulations. Do not use the phone with a damaged antenna. If a damaged antenna comes into contact with the skin, a minor burn may result. Please contact your local dealer for replacement antenna.

BODY-WORN OPERATION:

This device was tested for typical body-worn operations with the back of the phone kept 1.0cm from the body. To comply with FCC RF exposure requirements, a minimum separation distance of 1.0cm must be maintained between the user's body and the back of the phone, including the antenna, whether extended or retracted. Third-party belt-clips, holsters and similar accessories containing metallic components shall not be used. Body-worn accessories that cannot maintain 1.0cm separation distance between the user's body and the back of the phone, and have not been tested for typical body-worn operations may not comply with FCC RF exposure limits and should be avoided.

For more information about RF exposure, please visit the FCC website at www.fcc.gov

Your wireless handheld portable telephone is a low power radio transmitter and receiver. When it is ON, it receives and also sends out radio frequency (RF) signals. In August, 1996, the Federal Communications Commission (FCC) adopted RF exposure guidelines with safety levels for hand-held wireless phones. Those guidelines are consistent with the safety standards previously set by both U.S. and international standards bodies:

<ANSI C95.1> (1992) / <NCRP Report 86> (1986) / <ICIMIRP> (1996)

Those standards were based on comprehensive and periodic evaluations of the relevant scientific literature. For example, over 120 scientists, engineers, and physicians from universities, government health agencies, and industry reviewed the available body of research to develop the ANSI Standard (C95.1). Nevertheless, we recommend that you use a hands-free kit with your phone (such as an earpiece or headset) to avoid potential exposure to RF energy. The design of your phone complies with the FCC guidelines (and those standards).

Use only the supplied or an approved replacement antenna. Unauthorized antennas, modifications, or attachments could damage the phone and may violate FCC regulations.