

FCC statement

This equipment has been tested and found to comply with the limits for a class B digital device, pursuant to Part 15 of the FCC Rules. These limits are designed to provide reasonable protection against harmful interference in a residential installation.

This equipment generates uses and can radiate radio frequency energy and, if not installed and used in accordance with the instructions, may cause harmful interference to radio communications. However, there is no guarantee that interference will not occur in a particular installation if this equipment does cause harmful interference to radio or television reception, which can be determined by turning the equipment off and on, the user is encouraged to try to correct the interference by one of the following measures:

- Reorient or relocate the receiving antenna.
- Increase the separation between the equipment and receiver.
- Connect the equipment into an outlet on a circuit different from that to which the receiver is connected.

To assure continued compliance, any changes or modifications not expressly approved by the party responsible for compliance could void the user's authority to operate this equipment. (Example-use only shielded interface cables when connecting to computer or peripheral devices).

FCC Radiation Exposure Statement

This device complies with Part 15 of the FCC Rules. Operation is subject to the following two conditions:

- (1) This device may not cause harmful interference, and
- (2) This device must accept any interference received, including interference that may cause undesired operation.

Mini Wireless *Laser Mouse* L213



User's Guide

Introduction

Congratulations on your purchase of the most innovative mini wireless mouse. With an incredible sensitivity to surface details and high tracking speed than other mice, the mouse can track reliably even on tricky polished or wood-grain surfaces. It offers even more advance that will make you more productive and more comfortable.

ⓘ Safety Notice

- ▶ This product complies with IEC 60825-1 Class II laser product (for Laser mouse models only)
- ▶ Your product complies with FCC class B limits.

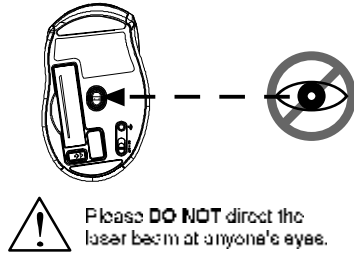

Features

- 2.4GHz (distance 6~8m), 16 Channels/4096 ID
- Using state-of-art technology, High tracking speed and sensitivity.
- Nano receiver.
- 4-way scrolling.
- Longer battery life.
- Auto-Link, Plug and Play! No need to set the channel ID.
- Power on/off switch.
- Ergonomic design.
- 800/1600 dpi switchable button.
- Rubber side grips and finger grooves.
- 2*AAA Alkaline batteries included.

Mouse

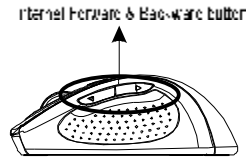
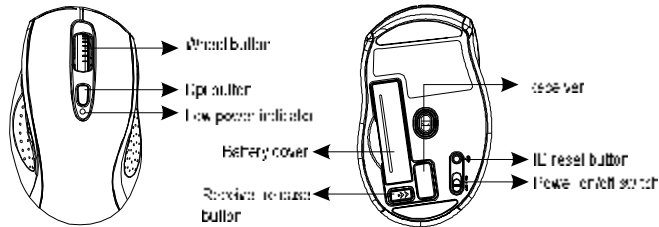

A. Hardware Installation

1. Insert the batteries

- a. Remove the battery compartment cover on the bottom case of the mouse.
- b. Fit in the batteries accordingly to the diagram indicated in the battery cabinet.
- c. Close the battery compartment cover properly.
- d. Make sure the Power on-off switch on the bottom of the mouse is ON.
- e. The Low Power LED in the scroll wheel will blink 3 seconds if the mouse power is on.

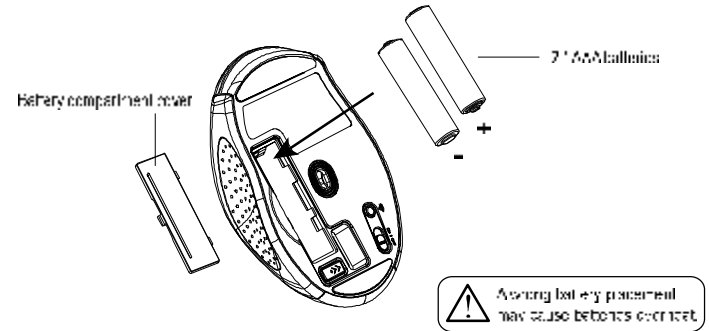

ⓘ Note

- ▶ The unit has a strong power saving management. Once the mouse accesses the sleeping mode, "clicking any button of the mouse" is compulsory to wake it up.
- ▶ **Power on/off:** There is a Power on/off switch designed to save the batteries power while non-usage of a longer period.
- ▶ Also our push DPI button to change the resolution. The LED on wheel barrel will blink when dpi has been successfully set from:

2. Connect the receiver

- a. Turn on your PC.
- b. Connect the receiver to USB port on PC

