

ASUS[®]

ASGuru S1
Wireless VoIP Phone



E2406
First edition V1
January 2006

Copyright © 2006 ASUSTeK COMPUTER INC. All Rights Reserved.

No part of this manual, including the products and software described in it, may be reproduced, transmitted, transcribed, stored in a retrieval system, or translated into any language in any form or by any means, except documentation kept by the purchaser for backup purposes, without the express written permission of ASUSTeK COMPUTER INC. ("ASUS").

Product warranty or service will not be extended if: (1) the product is repaired, modified or altered, unless such repair, modification or alteration is authorized in writing by ASUS; or (2) the serial number of the product is defaced or missing.

ASUS PROVIDES THIS MANUAL "AS IS" WITHOUT WARRANTY OF ANY KIND, EITHER EXPRESS OR IMPLIED, INCLUDING BUT NOT LIMITED TO THE IMPLIED WARRANTIES OR CONDITIONS OF MERCHANTABILITY OR FITNESS FOR A PARTICULAR PURPOSE. IN NO EVENT SHALL ASUS, ITS DIRECTORS, OFFICERS, EMPLOYEES OR AGENTS BE LIABLE FOR ANY INDIRECT, SPECIAL, INCIDENTAL, OR CONSEQUENTIAL DAMAGES (INCLUDING DAMAGES FOR LOSS OF PROFITS, LOSS OF BUSINESS, LOSS OF USE OR DATA, INTERRUPTION OF BUSINESS AND THE LIKE), EVEN IF ASUS HAS BEEN ADVISED OF THE POSSIBILITY OF SUCH DAMAGES ARISING FROM ANY DEFECT OR ERROR IN THIS MANUAL OR PRODUCT.

SPECIFICATIONS AND INFORMATION CONTAINED IN THIS MANUAL ARE FURNISHED FOR INFORMATIONAL USE ONLY, AND ARE SUBJECT TO CHANGE AT ANY TIME WITHOUT NOTICE, AND SHOULD NOT BE CONSTRUED AS A COMMITMENT BY ASUS. ASUS ASSUMES NO RESPONSIBILITY OR LIABILITY FOR ANY ERRORS OR INACCURACIES THAT MAY APPEAR IN THIS MANUAL, INCLUDING THE PRODUCTS AND SOFTWARE DESCRIBED IN IT.

Products and corporate names appearing in this manual may or may not be registered trademarks or copyrights of their respective companies, and are used only for identification or explanation and to the owners' benefit, without intent to infringe.

ii

This device complies with Part 15 of the FCC Rules. Operation is subject to the following two conditions: (1) this device may not cause harmful interference, and (2) this device must accept any interference received, including interference that may cause undesired operation.

Changes or modifications not expressly approved by the party responsible for compliance could void the user's authority to operate the equipment.

Max. SAR Measurement (1g)

Head 802.11b: **0.815** W/kg Body 802.11b: 0.352 W/kg

Head 802.11g: **0.466** W/kg Body 802.11g: 0.225 W/kg

Safety precautions

For your safety and to keep your phone in good operating condition, read the following tips and reminders carefully before using your phone.



Always keep the phone dry and free from dust.



Make sure that the phone is switched off before removing/replacing the battery.



Refer phone servicing only to qualified personnel.



Use only approved accessories and batteries. Do not connect incompatible products or devices.



Use the phone following the instructions in this user guide.

Conventions

To make sure that you perform certain tasks properly, take note of the following conventions used throughout this user guide.



NOTE: Tips and information to aid in completing a task.



IMPORTANT: Instructions that you **MUST** follow to complete a task.



CAUTION: Information to prevent injury to yourself when trying to complete a task.



WARNING: Information to prevent injury to the unit when trying to complete a task.



NETWORK DEPENDENT/SUBSCRIBED FEATURE: The phone feature is network dependent or subscribed.

Welcome!

Thank you for choosing the **ASGuru S1 WiFi Skype** phone!

This phone optimizes the latest in Voice Over Internet Protocol (VoIP) technology, which allows you to make calls through an Internet connection using the Skype™ program.

The phone features the Wireless technology that allows you the convenience of communications without being stuck on your seat and to the computer. Move around and keep in touch without the hassle of cords and cables.

The phone is much more than a wireless Skype phone, though. You can also use it as a remote controller for your Windows Media Player. Wherever you are within the wireless antenna's range, you can listen to your favorite playlists.

With these advanced features, the ASGuru S1 is your handy companion to a world of communication and entertainment possibilities.



Skype™ is a registered trademark of Skype Technologies S.A. and is not in any way connected to ASUSTek Computer, Inc. To create an account, download the Skype™ program, and know more about this program, visit www.skype.com.

Package contents

Check your phone package for the following items:



ASGuru S1
phone

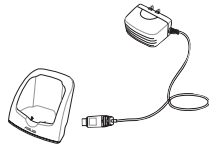

USB cradle and power cord

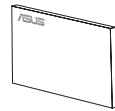

User guide



Battery



USB cable

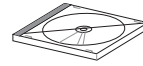

Support CD

Chapter 1

Basic information



1.1 Phone layout

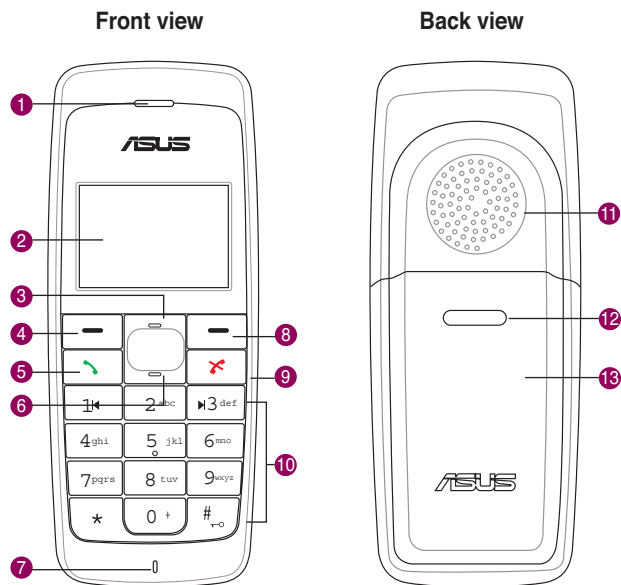

1. **Earpiece**
2. **LCD screen.** Displays information such as time, battery status, signal strength, and menus.
3. **Up key.** Scrolls up menu lists.
4. **Left key.** Allows you to perform the function indicated on the screen.
5. **Call key.** Initiates a call.
6. **Down key.** Scrolls down menu lists.

- 7. **Microphone**
- 8. **Right key.** Allows you to perform the function indicated on the screen.
- 9. **End key.** Terminates a call.
- 10. **Alphanumeric keypad.** Allows you to enter numbers, letters, and symbols.
- 11. **Speaker**
- 12. **Battery latch.** Secures the battery cover to the phone.
- 13. **Battery cover.** Covers the battery.

Side view (left)

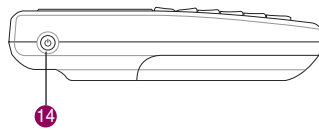

Side view (right)

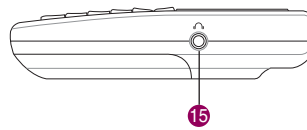

- 14. **Power button.** Turns the phone on or off.
- 15. **Earphone port.** Connects an earphone.

Bottom view

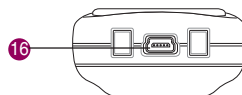

- 16. **Charging socket.** Connects a USB B series plug to charge the phone battery.

1.2 Battery information

A rechargeable battery powers the ASGuru S1 WiFi Skype phone. Make sure that the battery is fully charged to prevent interrupted communications due to power loss.

1.2.1 Battery power levels

The battery icon on the LCD screen helps you keep track of the remaining battery power so you will know when you need to charge the battery. Note the battery icon indicating the batter power levels.

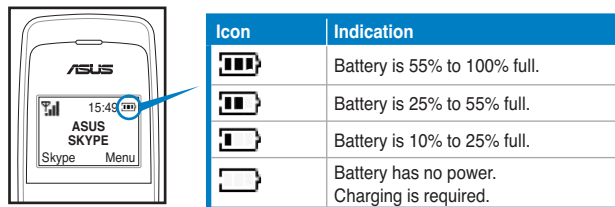

1.2.2 Removing and installing the battery

The rechargeable battery comes installed with the ASGuru S1. In the future, you may need to replace the current battery. Follow the instructions in this section to remove and install the battery.



Before removing or installing the battery, make sure the phone is not connected to a power source.

To remove the battery:

1. Push the battery latch in the direction of the arrow until the battery cover disengages from the phone.

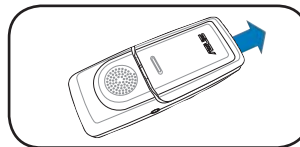

3. Lift the cover then set it aside.

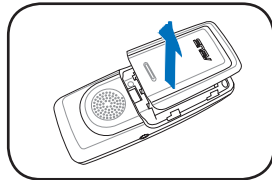

3. Unplug the battery cable from the connector on the phone.

4. Lift the battery and set it aside.

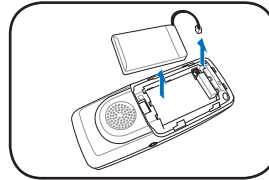

To install the battery:

1. Plug the battery cable to the connector on the phone.

2. Position the battery over the phone, then install it into the slot.

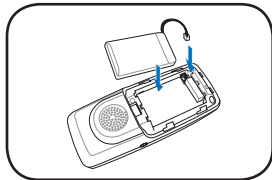

3. Position the battery cover as shown, matching the tabs on the cover with the grooves on the phone.

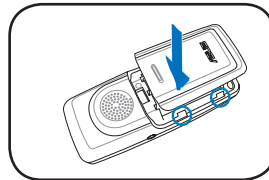

4. Slide the battery cover in the direction of the arrow until the latch snaps in place.

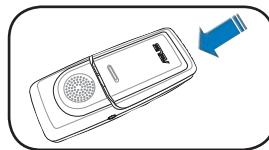

1.2.3 Charging the battery

When the battery indicator shows , you need to charge the battery to continue using it.



To know the charging status of the phone, note the LED color of the **Up/Down** key. Refer to the table below.

Color	Indication
Orange	Battery is charging in idle mode (backlight is off)
Purple	Battery is charging while being used (backlight is on).
No color (LED off)	Charging is complete

USB direct charging

1. Connect the USB Series B plug (with the squarish end) to the port at the bottom of the phone.

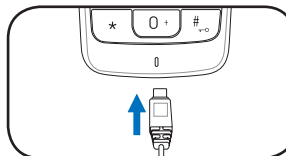

2. Connect the USB Series A plug (with the flat rectangular end) to a USB 2.0 port on your computer.



Make sure your computer is turned on.

USB cradle charging

1. Connect the USB Series B plug (with the squarish end) of the power cable to the port at the back of the USB cradle.

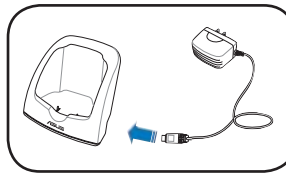

2. Slide the phone into the cradle until it fits.

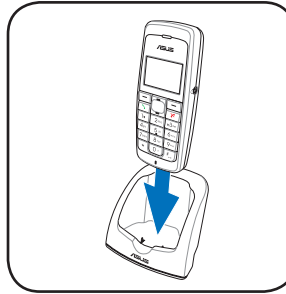

3. Connect the power plug to a power source.

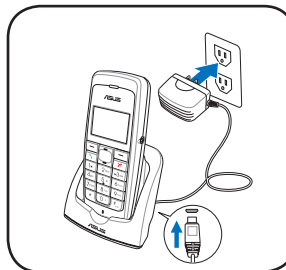

1.2.4 Turning the phone on or off

To turn the phone on or off:

1. Locate the power button on the left-hand side of the phone.
2. Press the power button for a few seconds until the display turns on or off.

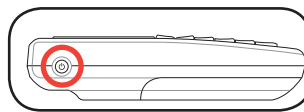

1.2.5 Locking the keypad

There are two ways to lock the keypad.

To lock the keypad using the on-screen **Menu**:

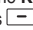
1. Press  (right) to display the Menu .
2. Scroll down to the **Keypad Lock** item, then press  (left) to **Enter** and confirm.

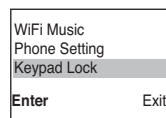
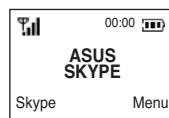

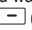
3. The padlock lock icon appears to confirm whether you want the keypad or not. Press  (left) for **Yes**.
4. The key lock icon appears at the bottom right corner of the screen to indicate that the keypad has been locked.



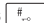

To lock the keypad using **phone keys**:

1. Press  (right).
2. Press .
3. The key lock icon appears at the bottom right corner of the screen to indicate that the keypad has been locked.



1.2.6 Unlocking the keypad

To lock the keypad using **phone keys**:

1. Press  (right).
2. Press .
3. Press the # key to unlock the keypad.

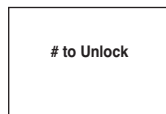

3. Press the # key to unlock the keypad. The main screen then appears, indicating that the keypad is ready to use.

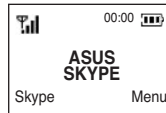

1.2.7 Display layout

Idle mode

The phone is in idle mode when it is ready for use and you have not performed any action.

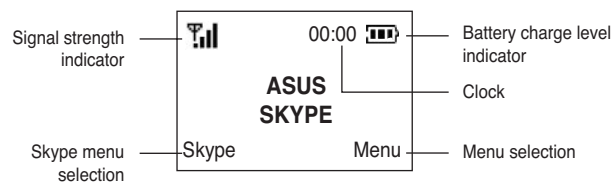

Menu mode

When you press  (right), the main menu appears. You can go to this mode to listen to WiFi music, configure phone settings, and lock the keypad.

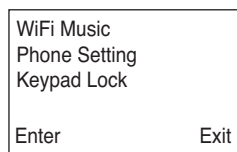

Skype mode

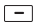
When you press  (left), the Skype menu appears. You can go to this mode to open the Skype phone book, enable the loud speaker, retrieve recorded messages, view the call history, initiate a conference call, or configure answering machine settings.

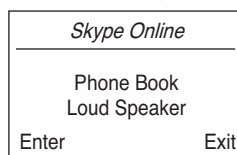

Chapter 2

Getting started



2.1 Setting up

Before using your ASGuru S1 WiFi Skype™ phone, make sure you have the following:

1. Skype™ account



Skype™ is a registered trademark of Skype Technologies S.A. and is not in any way connected to ASUSTek Computer, Inc. To create an account, download the Skype™ program, and to know more about this program, visit www.skype.com.

2. Internet connection
3. Wireless-enabled desktop computer or notebook
4. Wireless LAN antenna



- This phone is best used with a system using an ASUS motherboard with onboard Wireless LAN module.
- Refer to your hardware documentation for your wireless LAN settings and configuration.
- Consult your Internet Service Provider for required network settings.



Make sure that the wireless LAN antenna is plugged to a USB 2.0 port on your computer, and the ASGuru S1 Wireless Utility is installed before you begin using your phone. **Refer to Chapter 3: Installing and using the ASGuru S1 Utility** for details.

2.1.1 PC setup

Below is an example of a setup using a desktop computer.

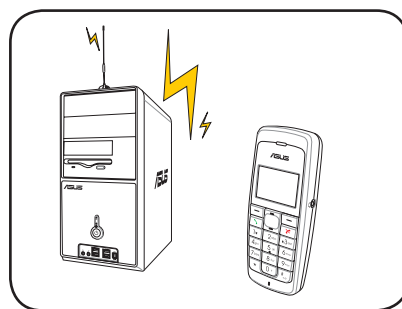

2.1.2 Notebook setup

Below is an example of a setup using a notebook.

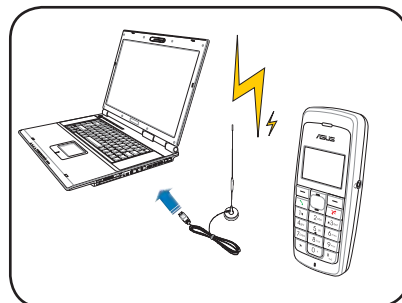



2.2 Changing settings

Refer to this section to change your phone settings. The Phone Settings menu allows you to change the default language, ringing volume, and display settings.

Changing the default language

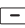
To change the default language:

1. Press  (right) to display the Menu
2. Scroll down to **Phone Setting**, then press  (left) to **Enter** and confirm.

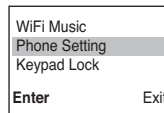
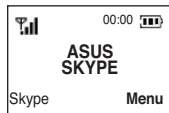

3. When the next screen opens, the item **Language** is automatically highlighted. Press  (left) to **Enter**.
4. Scroll down to choose your desired language. A **✓** mark appears before your choice.

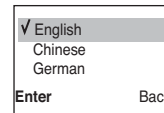
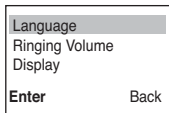

The following language options are currently available: English, Chinese, German, and French.

Changing the ringing volume

To change the ringing volume:

1. Follow steps 1 and 2 of the previous section, **Changing the default language**.
2. Scroll down to **Ringing Volume**, then press (left) to **Enter** and confirm.
3. The following screen appears. Use the **Up/Down** key to increase/decrease the volume. Press (left) to choose **Ok** when done.

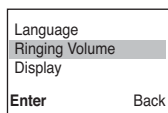

Changing the display settings

You may change the display settings to set the backlight time and to adjust the brightness and contrast of your display.

To set the **backlight time**:

1. Follow steps 1 and 2 of the section **Changing the default language**.
2. Scroll down to **Display**, then press (left) to **Enter** and confirm.
3. When the next screen opens, the item **Backlight Time** is automatically highlighted. Press (left) to **Enter**.

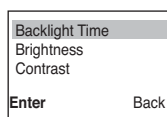
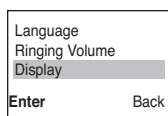

4. Scroll to your desired setting. Press **[Left]** to **Select**. A **✓** mark appears before your choice. Refer to details on the table below.

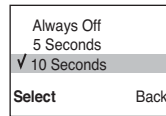

Backlight settings	
Item	Description
Always Off	Backlight is turned off all the time.
Always On	Backlight is turned on all the time
5 Seconds	Backlight turns off after 5 seconds
10 Seconds	Backlight turns off after 10 seconds
15 Seconds	Backlight turns off after 15 seconds

To set the **brightness level**:

- Follow steps 1 and 2 of the section **Changing the default language**.
- Follow step 2 of the previous section on setting the backlight time.
- Scroll down to **Brightness**, then press **[Left]** to **Enter** and confirm.
- The following screen appears. Use the **Up/Down** key to increase/decrease the brightness level. Press **[Left]** to choose **Ok** when done.

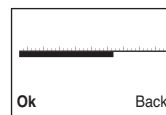
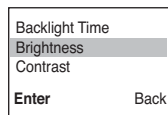

To set the **contrast level**:

1. Follow steps 1 and 2 of the section **Changing the default language**.
2. Follow step 2 of the previous section on setting the backlight time.
3. Scroll down to **Contrast**, then press **[Left]** to **Enter** and confirm.
3. The following screen appears. Use the **Up/Down** key to increase/decrease the brightness level. Press **[Left]** to choose **Ok** when done.

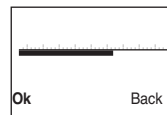
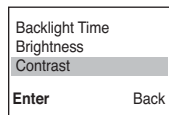

Chapter 3

Installing and using the ASGuru S1 Utility



3.1 Installing the ASGuru S1 Utility

Before using your ASGuru S1 WiFi Skype™ phone, you need to install the ASGuru S1 Utility. This utility allows you to take full advantage of your phone's features and settings.

Requirements for installing the ASGuru S1 utility:

1. Windows® XP operating system
2. Skype account
3. Microsoft® DirectX 9.0c
4. ASGuru S1 support CD

To install the ASGuru S1 Utility:

1. Place the ASGuru S1 support CD in the optical drive.

The AsGuru S1 Control Panel appears. Click **Install Skype WiFi Phone**.



2. Select the setup language.



3. Select the program folder where you want to save the ASGuru S1 Utility. A default destination folder is provided. You may choose another folder by clicking **Browse**. Click **Next**.

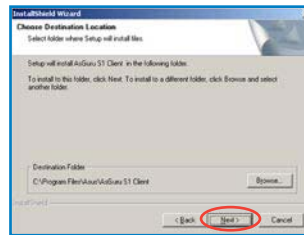

4. You will be prompted to review settings before the files are copied to your system. Click **Next**.

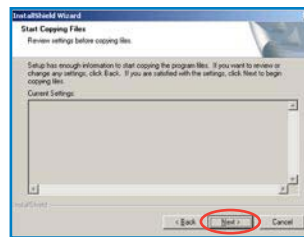

5. The ASGuru S1 Utility is copied to your system. The **Setup Status** window appears, indicating the progress of the installation.

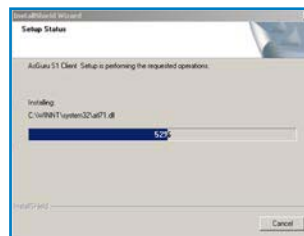

6. When prompted whether or not you want the Virtual Audio Cable installed, click **Yes**.

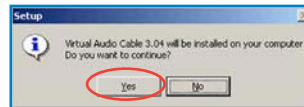

7. Read the License Agreement, then click **Accept**.

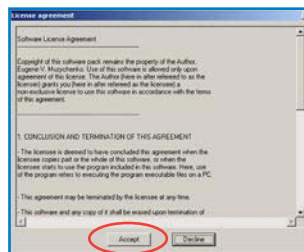

8. A warning message appears, reminding you to uninstall any previous version of the application. The window also shows the installation directory and the program group name. Click **Install**.

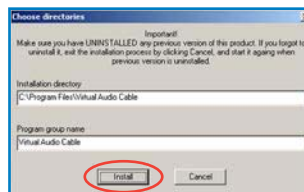

9. A message appears, confirming that the installation process is complete.
Click **OK**.



10. The **InstallShield Wizard Complete** window appears, indicating that the ASGuru S1 Utility has been installed successfully.
Click **Yes** to restart your computer now or **No** to restart later.
Click **Finish**.



3.2 Configuring the ASGuru S1 Utility settings

After installing the ASGuru S1 Utility, it is time to configure the settings to optimize the features of your phone.

To launch the ASGURU S1 Utility:

1. Turn on your phone.
2. Connect the phone to your computer using the USB cable that came with the package.
3. Start your computer.
4. Launch the Skype application and sign in to your account.
5. Launch the ASGuru S1 Utility by double-clicking the Skype Wi-Fi phone icon on your desktop or the taskbar.



6. The ASGuru S1 Utility main screen appears.

3.2.1. Wireless LAN configuration

Follow the instructions in this sections for the default wireless LAN (WLAN) auto-configuration settings.

To configure WLAN automatically:

1. Click the **WLAN** tab or the  icon on the ASGuru S1 Utility main screen.
2. Click **Search Device** to search for your phone.
3. Click the **Auto Config** option.
4. Enable the **WEP** item for security, then enter the key or passphrase.
5. The utility automatically detects the PC IP address and Netmask, assigns the Phone IP Address, and shows the ESSID, and WEP status.
6. Click **Refresh** to display the information.
7. Click **Configure** to effect the settings.

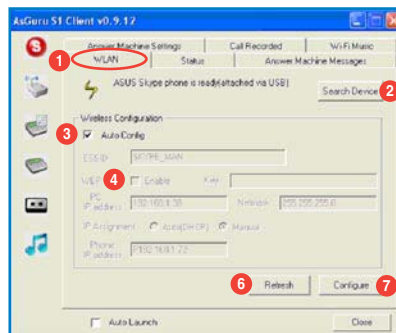

8. Detach the phone from your computer.
9. Restart the phone to reset its IP address.
Your phone is now ready to use.

To configure WLAN manually:

1. Follow steps 1 and 2 of the previous section "To configure WLAN automatically."
2. Enter the Extended Service Set ID (**ESSID**).
3. Enable the **WEP** item for security, then enter the key or passphrase.
4. Enter your computer's IP address and Netmask.
5. To let the utility assign the phone IP address automatically, click **Auto (DHCP)**; otherwise, click **Manual**, then enter the **Phone IP Address**.
6. Click **Refresh** to display the information.
7. Click **Configure** to effect the settings.

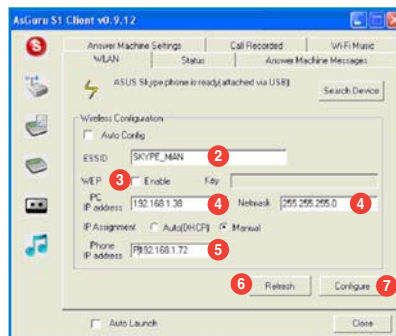

8. Detach the phone from your computer.
9. Restart the phone to reset its IP address.
Your phone is now ready to use.

3.2.2. Displaying phone status

Click the **Status** tab to display the following information:

1. **Software Version** - shows the version number of the ASGuru S1 Utility.
2. **Hardware** - lets you know if the phone is connected or is within the operating range of the WLAN module.
3. **Skype** - lets you know if you are signed in to your Skype account or not.



3.2.3. Wi-Fi Music

Click the **Wi-Fi Music** tab or the  icon to select the playlist you would like to listen to on your phone.

Click **Browse** to find your desired playlist, and click **Set as Default** to set the playlist as the default.



3.2.4 Answer Machine Settings

You can set the ASGuru S1 Utility to give a pre-recorded message to a caller in case you are unable to answer the call.

To use the answering machine function:

1. Click the **Answer Machine Settings** tab or the  icon.
2. Click the **Enable Answer Machine Function**.
3. Set the time period within which the function is activated if you do not receive the call.
4. Choose whether to use the stored **Default Greeting Message**, or record your **Customized Message**.



- The Default Greeting Message is saved in C:\Program Files\ASGuru S1 Utility\Greeting\greetingdefault.wav.
- The Customized Message is saved in C:\Program Files\ASGuru S1 Utility\Greeting\greetingcustom.wav.

To listen to the Default Greeting Message:

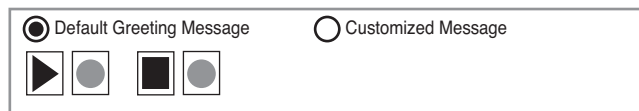

1. Click **Default Greeting Message**.
2. Click ▶ to play the message.
3. Click ■ to stop.

To create your Customized Message:



1. Click **Customized Message**.
2. Click ● to start recording your message.
3. Click ■ to stop recording.
4. Click ► to play the message or || to pause.

3.2.5 Answer Machine Messages

Click the **Answer Machine Messages** tab or the  icon to retrieve messages left on your answering machine.

Saved message(s) appear here

Slide up or down to adjust volume

Click to play

Click to delete

Click to rename and save the message

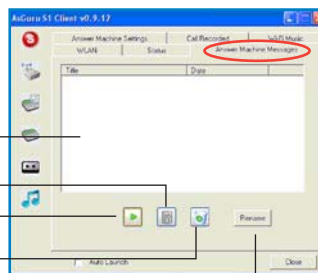

By default, answering machine messages are saved in C:\Program Files\ASGuru S1 Utility\Greeting Message.

3.2.6 Call Recorded

Click the **Call Recorded** tab or the  icon to play back recorded calls.

Recorded call(s) appear here

Slide up or down to adjust volume

Click to play

Click to delete

Click to rename and save the message

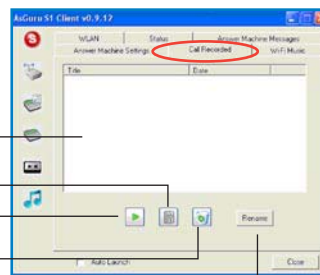

By default, recorded calls messages are saved in C:\Program Files\ASGuru S1 Utility\Call Recorded.

Chapter 4

Using your phone



4.1 Making a call



Before using your ASGuru S1 WiFi Skype™ phone, make sure you have installed the ASGuru S1 Utility and configured the required settings. Do not quit the utility while you are signed in to Skype. Refer to Chapter 3 for details.

4.1.1 Using an entry in the phone book:



To make a call to a mobile phone or land line using Skype out, you need to purchase credits. Visit the Skype website at www.skype.com for details.



The phone book on your phone only displays the contacts saved in your Skype account.

To make a call from a phone book entry:

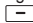
1. Turn the phone on. The main screen displays your Skype account name.
2. Press  (left) open the Skype menu.
3. Scroll down to highlight **Phone Book**, then press  (left) to **Enter**.

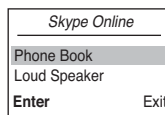
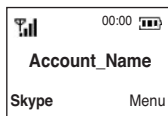

4. Scroll up/down to choose the contact you want to call, then press  to make the call.

4.1.2 Using the numeric keypad:

To make a call using the numeric keypad:

1. Turn the phone on. The main screen displays your Skype account name.
2. Dial the telephone number you want to contact.

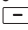
3. Press  (left) to save the number; otherwise, press  (right) to delete.



4. Press  to make the call.

4.1.3 Terminating a call:

When you are done with the phone conversation, press .

4.1.4 Using the hands-free feature:

1. From the Skype menu, scroll down to **Loud Speaker**, then press  (left) to **Enter**

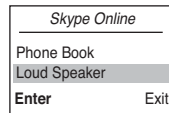

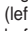
2. Highlight **On**, then press  (left) to **Select**. A  mark appears before your choice.

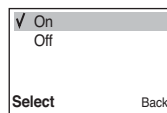



4.2 Retrieving recorded messages

4.2.1 Retrieving voice mail

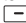
To retrieve voice mail:

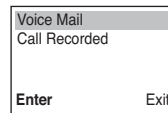
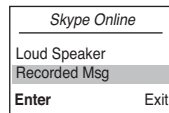
1. From the Skype menu, scroll down to **Recorded Msg**, then press  (left) to **Enter**.
2. Highlight **Voice Mail**, then press  (left) to **Enter**.



3. Scroll up or down to select the voice mail message you want to retrieve, then press  (left) to open the **Option** screen.
4. Select either to **Play** or **Delete** the voice mail, then press  (left) for **OK**.

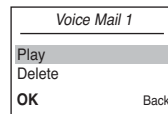
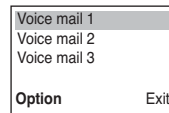

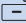
If you choose to delete the voice mail, a succeeding screen displays a message confirming the action. Press  (left) for **Yes**. You cannot undo this action.

4.2.2 Retrieving recorded calls

To retrieve recorded calls:

1. From the Skype menu, scroll down to **Recorded Msg**, then press **[Left]** to **Enter**.
2. Highlight **Call Recorded**, then press **[Left]** to **Enter**.

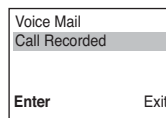
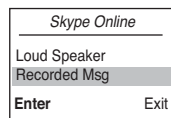

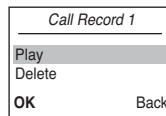
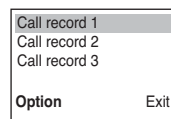

3. Scroll up or down to select the voice mail message you want to retrieve, then press **[Left]** (left) to open the **Option** screen.
4. Select either to **Play** or **Delete** the voice mail, then press **[Left]** (left) for **OK**.







If you choose to delete the recorded call, a succeeding screen displays a message confirming the action. Press **[Left]** for **Yes**. You cannot undo this action.

4.3 Viewing/clearing the call history

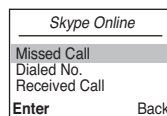
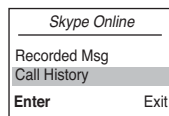

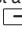
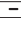
To view the call history:

1. From the Skype menu, scroll down to **Call History**, then press  (left) to **Enter**.
2. Scroll up or down to highlight the type of call you want to view, then press  (left) to **Enter**.

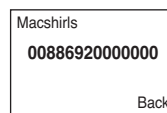
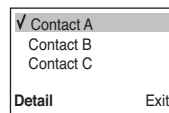

3. Scroll up or down to select a contact name, then press  (left) to open the **Detail** screen, or press  (right) to **Exit**.
A  mark appears before your choice.
4. The selected contact's Skype account name and/or phone number appears on the next screen. Press  to call the selected contact, or press  (right) to go **Back** to the previous screen.



If you opted to make a call, press  (left) for more call options or press  (right) to enable the hands-free feature (**SPK**). See section "4.6 Call options" for details.

Use the **Up/Down** key to increase/decrease the speaker volume.

To terminate the call, press .

To clear the call history:

1. From the Skype menu, scroll down to **Call History**, then press (left) to **Enter**.
2. Scroll up or down to highlight **Clear History**, then press (left) to **Enter**.

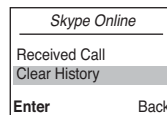
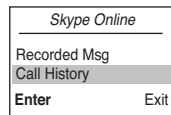

3. Scroll up or down to select the type of call you want to clear, then press (left) to **Enter**, or press (right) to **Exit**.
4. A message appears, prompting you to confirm the action. Press (left) for **Yes**, or press (right) for **No**.

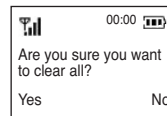
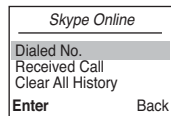

4.4 Hosting a Skype conference call



You can hold a Skype conference call with one host and up to four participants.

To host a Skype conference call

1. From the Skype menu, scroll down to **Skype Conference**, then press (left) to **Enter**.

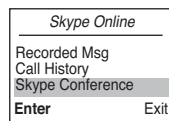

2. From the **Contact List**, scroll up or down to highlight a participant's name, then press (left) to **Select**. Repeat the process until you have chosen all participants.

A **✓** mark appears before your choice(s). To remove the contact from the participants' list, press (left) to **deselect**.

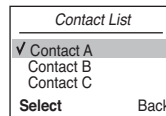

3. Press  to make the conference call.

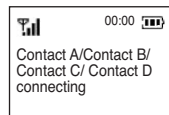

4. When connected, press (left) for more call options or press (right) to enable the hands-free feature (**SPK**). See section "4.6 Call options" for details.

Use the **Up/Down** key to increase/decrease the speaker volume.

To terminate the call, press .

4.5 Using the answer machine

To use the answering machine feature:

1. From the Skype menu, scroll down to **Skype Conference**, then press (left) to **Enter**.
2. The next screen automatically highlights **Setting**. Press (left) to **Enter**.

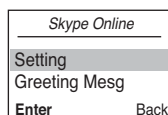
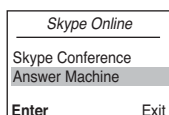

3. Scroll up or down to **On** or **Off**, depending on your preference, then press (left) to **Select**. A ✓ mark appears before your choice.
4. To choose the greeting message to use, go back to the Answer Machine menu. Scroll down to **Greeting Msg**, then press (left) to **Enter**.

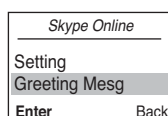
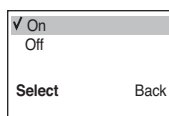

5. Scroll up or down to choose the greeting message to use, then press (left) to **Select**.
6. If you chose **Customize**, you may record your own greeting message. Highlight **Record**, the press then press (left) to **Start**.

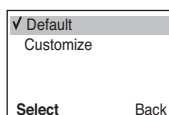

To playback the recorded message, scroll down to **Play** then press (left) to **Start**.

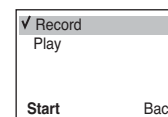



4.6 Call options



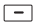

4.6.1 Call waiting

This feature allows you put a call in progress on hold to initiate or receive another call.

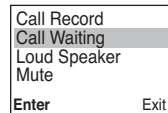
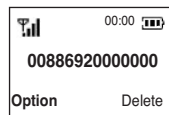
To use the call waiting function for outgoing calls:

1. Make a call. Refer to section "4.1 Making a call."
2. While the call is in progress, press  (left) to open **Options**.
3. Scroll down to **Call Waiting**, then press  (left) to **Enter**.



4. The following screen appears. Note the  icon on the upper right portion of the screen, indicating that the current call is on hold.
5. Dial another number using the numeric keypad. When connected, The following screen appears. The  icon before a number indicates it is on hold. The  icon before a number indicates it is in progress. Press  (right) to **Swap** the two numbers.

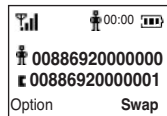
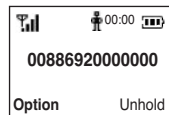

To use the call waiting function for incoming calls:

1. While a call is in progress, and you receive another call, you have the option to receive or reject the incoming call.
2. To receive the call, press **[Left]** for **Option**.
3. Scroll down to **Call Waiting**, then press **[Left]** to **Enter**.

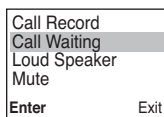
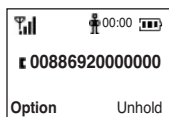

4. The following screen appears. Note the **[Hold]** icon on the upper right portion of the screen, indicating that the incoming call is on hold.

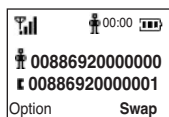

The **[Hold]** icon before a number indicates it is on hold.

The **[Progress]** icon before a number indicates it is in progress.

Press **[Right]** to **Swap** the two numbers.

To terminate a call.

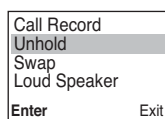
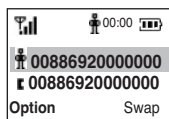

1. Scroll to highlight the number you want to hang up
2. Press **[Left]** to open **Option**.
3. Scroll to **Unhold**, then press **[Left]** to **Enter**.





4.6.2 Call record

This feature allows you to record a call in progress.

To record a call:

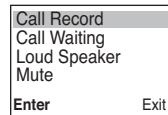
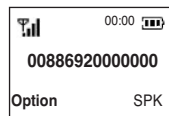
1. Make a call. Refer to section "4.1 Making a call."
2. While the call is in progress, press  (left) to open **Options..**
3. Highlight **Call Record**, then press  (left) to **Enter**.



4. The following screen appears, indicating the time elapsed. Press  (right) to **Stop**.
5. To play a recorded call see section "4.2.2 Retrieving recorded calls."

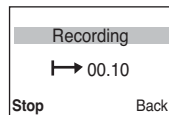



4.6.3 Loud speaker

This feature allows you to use the phone speaker for hands-free calling. For details on this feature, see section "4.1.4 Using the hands-free feature."

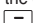

4.6.4 Mute

This feature allows you to set the phone on mute mode.

To enable or disable the mute function:

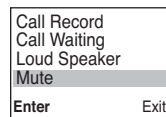
1. Make a call. Refer to section "4.1 Making a call."
2. While the call is in progress, press  (left) to open **Options**.
3. Scroll down to **Mute**, then press  (left) to **Enter**.

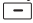

3. Scroll up or down to **On** or **Off**, depending on your preference, then press  (left) to **Select**. A ✓ mark appears before your choice. Press  (right) to exit and go **Back** to the previous screen.
3. The following screen appears. Note the  icon, indicating that the current call is in mute mode.

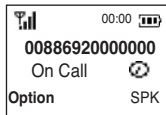
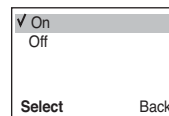



4.7 WiFi Music

Your ASGuru S1 phone can function as a Windows Media Player remote controller, allowing you to play audio files while you are away from your computer, within the operating range of the WLAN module

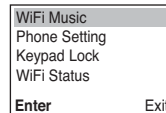
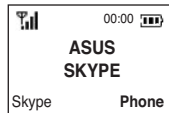

To enable WiFi Music:

1. From the main menu, press  (right) to enter the **Phone** menu.
2. From the Phone menu, scroll to **WiFi Music**, then press  (left) to **Enter**.

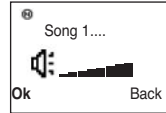
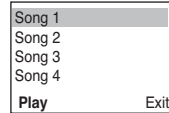

3. Scroll up or down to select the music file that you want to play, then press  (left) to **Play**.
4. Scroll up or down to increase or decrease the volume.





5. To play the previous song in the list, press **1** on the numeric keypad. To play the next, press **3**
6. For playing mode, refer to the icon indications below.
 - Play all in order at once
 - Play all in loop
 - Randomly play all in loop

4.7 WiFi Status

This item allows you to view the status of your WLAN connection.

To view Wifi Status:

1. From the main menu, press  (right) to enter the **Phone** menu.
2. From the Phone menu, scroll to **WiFi Status**, then press  (left) to **Enter**.

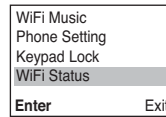
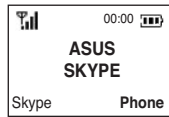

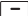
4. The following screen appears, displaying information on your WLAN connection. Press  (right) to go **Back** to the main screen.

