

# Graphite

O2/Graphite

# USER MANUAL

## ASUS contact information

### **ASUSTeK COMPUTER INC. (Asia-Pacific)**

Address 15 Li-Te Road, Peitou, Taipei, Taiwan 112  
Web site [www.asus.com.tw](http://www.asus.com.tw)

#### **Technical Support**

Telephone +886-2-2894-3447  
Support Fax +886-2-2890-7698  
Software download [support.asus.com](http://support.asus.com)\*

### **ASUS COMPUTER INTERNATIONAL (America)**

Address 44370 Nobel Drive, Fremont, CA 94538, USA  
Fax +1-510-608-4555  
Web site [usa.asus.com](http://usa.asus.com)

#### **Technical Support**

Telephone +1-502-995-0883  
Support fax +1-502-933-8713  
Software download [support.asus.com](http://support.asus.com)\*

\* Available on this site is an online Technical Inquiry Form that you can fill out to contact technical support.

## 02 Xda Graphite

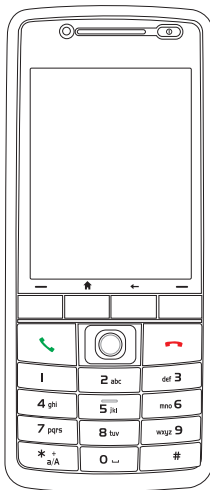

# User Manual

**E2695**

**First edition**

**August 2006**

**Copyright © 2006 ASUSTeK COMPUTER INC. All Rights Reserved.**

No part of this manual, including the products and software described in it, may be reproduced, transmitted, transcribed, stored in a retrieval system, or translated into any language in any form or by any means, except documentation kept by the purchaser for backup purposes, without the express written permission of ASUSTeK COMPUTER INC. ("ASUS").

Product warranty or service will not be extended if: (1) the product is repaired, modified or altered, unless such repair, modification or alteration is authorized in writing by ASUS; or (2) the serial number of the product is defaced or missing.

ASUS PROVIDES THIS MANUAL "AS IS" WITHOUT WARRANTY OF ANY KIND, EITHER EXPRESS OR IMPLIED, INCLUDING BUT NOT LIMITED TO THE IMPLIED WARRANTIES OR CONDITIONS OF MERCHANTABILITY OR FITNESS FOR A PARTICULAR PURPOSE. IN NO EVENT SHALL ASUS, ITS DIRECTORS, OFFICERS, EMPLOYEES OR AGENTS BE LIABLE FOR ANY INDIRECT, SPECIAL, INCIDENTAL, OR CONSEQUENTIAL DAMAGES (INCLUDING DAMAGES FOR LOSS OF PROFITS, LOSS OF BUSINESS, LOSS OF USE OR DATA, INTERRUPTION OF BUSINESS AND THE LIKE), EVEN IF ASUS HAS BEEN ADVISED OF THE POSSIBILITY OF SUCH DAMAGES ARISING FROM ANY DEFECT OR ERROR IN THIS MANUAL OR PRODUCT.

SPECIFICATIONS AND INFORMATION CONTAINED IN THIS MANUAL ARE FURNISHED FOR INFORMATIONAL USE ONLY, AND ARE SUBJECT TO CHANGE AT ANY TIME WITHOUT NOTICE, AND SHOULD NOT BE CONSTRUED AS A COMMITMENT BY ASUS. ASUS ASSUMES NO RESPONSIBILITY OR LIABILITY FOR ANY ERRORS OR INACCURACIES THAT MAY APPEAR IN THIS MANUAL, INCLUDING THE PRODUCTS AND SOFTWARE DESCRIBED IN IT.

Microsoft, Activesync, Outlook, Pocket Outlook, Windows, and the Windows logo are either registered trademarks or trademarks of Microsoft Corporation in the United States and/or in other countries. Microsoft products are licensed to OEMs by Microsoft Licensing, Inc., a wholly owned subsidiary of Microsoft Corporation.

# Table of Contents

<b>Chapter 1</b>	<b>Getting Started</b> .....	<b>1</b>
1-1	Introducing the O2 Xda Graphite .....	1
1-2	Getting to know your Smartphone.....	2
1-3	Installing the SIM card and battery.....	5
1-4	Installing and removing a micro SD card.....	6
1-5	Charging your Smartphone .....	7
1-6	Turning your Smartphone ON/OFF .....	8
<b>Chapter 2</b>	<b>Learning to Use Your Smartphone</b> .....	<b>9</b>
2-1	Home screen .....	11
2-2	Start menu .....	13
2-3	Quick List.....	14
<b>Chapter 3</b>	<b>Using Call Features</b> .....	<b>15</b>
3-1	Making a voice call .....	15
3-2	Retrieving voice mail messages .....	19
3-3	Responding to a voice call .....	19
3-4	Options during a call.....	20

<b>Chapter 4</b>	<b>Synchronizing with ActiveSync.....</b>	<b>23</b>
4-1	Microsoft ActiveSync .....	23
4-2	Installing ActiveSync on your PC.....	24
4-3	Connecting your phone to a PC .....	25
4-4	Creating a partnership.....	25
4-5	Synchronizing with a PC .....	26
4-6	Synchronizing with an Exchange Server.....	28
4-7	Creating a synchronization schedule .....	39
4-8	Remote synchronization.....	31
<b>Chapter 5</b>	<b>Managing Your Smartphone .....</b>	<b>33</b>
5-1	Personalizing your Smartphone .....	33
5-2	Improving performance .....	37
5-3	Turning on/off wireless mode .....	39
5-4	Keeping your Smartphone secure.....	39
5-4	Setting network options.....	43
5-5	Emergency restarting of your phone .....	43
5-6	Resetting your phone .....	43
5-7	Adding and removing programs .....	44
5-8	Managing and backing up files.....	45
<b>Chapter 6</b>	<b>Getting Connected.....</b>	<b>49</b>
6-1	Connecting to the Internet.....	49
6-2	Using your phone as an external modem.....	52
6-3	Using Internet Explorer Mobile .....	54
6-4	Using Bluetooth® .....	56

<b>Chapter 7</b>	<b>Messaging</b> .....	<b>61</b>
7-1	Entering text and numbers .....	61
7-2	Setting up accounts .....	65
7-3	Managing accounts .....	66
7-4	Text and e-mail messages .....	67
7-5	MMS messaging .....	70
7-6	Using Pocket MSN .....	73
<b>Chapter 8</b>	<b>Organizing Your Life</b> .....	<b>77</b>
8-1	Using Contacts .....	77
8-2	Using Calendar .....	81
8-3	Using Tasks .....	83
8-4	Using Voice Notes .....	84
<b>Chapter 9</b>	<b>Multimedia</b> .....	<b>85</b>
9-1	Working with pictures and videos .....	85
9-2	Listening to music and watching videos .....	87
9-3	Using Java (MIDlet Manager) .....	91
<b>Appendix</b>	<b>Notices</b> .....	<b>93</b>

## ASUS 02 XDA Graphite specifications

Processor + Modem	Intel PXA270 416MHz +Intel Hermon
Operating system	Microsoft® Windows Mobile™ 5.0 (Smartphone)
Network system	UMTS (3GPP Band I), Tri-Band GSM (900/1800/1900), GPRS class 10
Memory	128MB Flash ROM 64MB SDRAM
LCD Screen	2.2" screen size, QVGA screen resolution, 65K screen color, TFT screen technology
Expansion slot	One slot for a micro SD card
Wireless transmission	Bluetooth® v2.0 / USB v1.1 (Client + Host)
Audio	2.5 mm stereo earphone / microphone jacks, built-in speakerphone
Dimensions	109.5 mm x 46 mm x 18 mm
Weight	100 grams (with battery)
Battery	1100mAh rechargeable Lithium-Ion
Battery life	Standby time: Up to 275 hours (GSM) / 300 hours (WCDMA) Talk time: 5 hours (GSM) / 2.5 hours (WCDMA)
Audio/Video	Music formats accepted: MP3, WMA, WAV, AMR-NB, and A/V Streaming supported
Internet browsing	HTTP and WAP2.0
Messaging	SMS, MMS 1.2 and E-mail
JAVA	J2ME (CLDC 1.1 + MIDP2.0)
Ringtones	40 channels polyphonic ringer & MP3

\* The actual performance is dependent on multiple factors, including network and usage environment.



## Package contents

Your package includes several accessories for the Smartphone. After unpacking, check the items against the list below and make sure that they are in good condition. If any item is missing or damaged, contact your dealer or retailer immediately.

### Standard items

- ASUS O2 Xda Graphite Smartphone
- USB sync cable
- AC adapter with DC\_IN via mini-USB plug
- Software CD
- Standard battery
- Stereo headset with microphone
- Manual / Quick Start Guide
- Carrying case (can be added at an extra cost)

**IMPORTANT** To avoid damaging your Smartphone and accessories, it is recommendable to operate this unit within a temperature range of 0 ~ 40 °C (68 ~ 86 °F) and 50% humidity. Anything that goes beyond or below this temperature range may damage the unit and/or shorten the battery life.

---

# Chapter 1 Getting Started

## 1-1 Introducing the ASUS 02 Xda Graphite Smartphone

The ASUS® 02 Xda Graphite Smartphone is a tri-band mobile phone with practical features such as messaging capabilities, organizer, GPRS functionality, and a micro SD card slot.

In addition to 128 MB phone memory, the micro SD card extends storage space, which allows you to save photos, messages, texts, graphics, and audio files.

## 1-2 Getting to know your Smartphone

### Front features

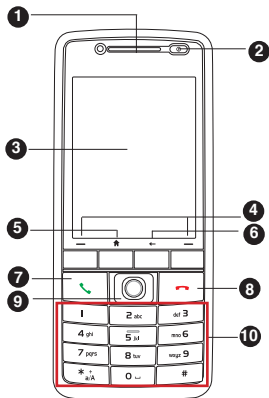

LED INDICATOR	STATUS
Steady amber	Battery is charging.
Steady green	Battery is fully charged.
Flashing green	Signal/network detected.
Flashing blue	Bluetooth is set to "On" or "Discoverable."
Flashing amber	Event alarm/notification

FEATURE
1. Earpiece
2. Power On/Off button / LED indicator Allows you to turn your 02 Xda ON/OFF. It also indicates the status of your battery, signal/network, Bluetooth, etc. See the LED indicator table for more information.
3. LCD Screen Displays the menu, current time, battery power , signal strength, and current profile.
4. Left and Right Soft keys The Left and Right Soft keys perform the command indicated above the button. The Left Soft key unlocks the keypad, just press this button and the Asterisk (*) key  .
5. Home key Takes you to the Home screen.
6. Back key Takes you back to the previous screen.
7. Call key Answers a call or dial a number. Press twice to redial last number.
8. End key Ends a call. Press and hold to lock the keypad.

### FEATURE

#### 9. 5-way joystick

Push left, right, up, and down to scroll through the menu files, program icons, and folders.

Press to launch a chosen program, list the contents of a folder, or open a file.

#### 10. Keypad



Alphanumeric keys enter numbers and texts.



Asterisk (\*) key enables you to switch between cases (upper/lower cases) and caps lock within a text messaging mode. In a text field, press and hold to display an entire list of input mode to make a selection.



In a text field, press this key to enter zero (0). Press and hold to enter a plus sign (+) for making international calls.



In a text field, press to enter a space. Press and hold to access the symbols menu.

### Back features

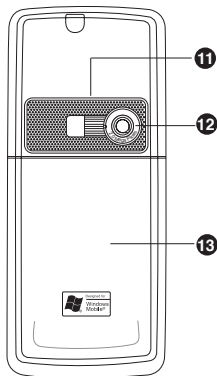

### FEATURE

#### 11. Speakerphone

Enables you to listen to music or to talk over the phone handsfree.

#### 12. Camera lens

#### 13. Back cover

## Side features

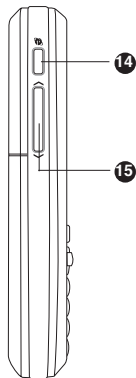

### FEATURE

**14. Internet button**

Launches the Internet Explorer.

**15. Volume button**

Adjusts the volume of your phone.

**16. Mini-USB sync/power connector**

Synchronizes data in your phone with your PC or charges your battery.

**17. Microphone**

**18. Earphone jack**

Insert a headphone to listen to music or to use your phone handsfree.

## Bottom features

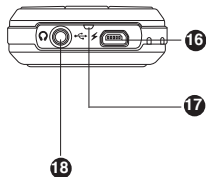

## 1-3 Installing the SIM card and battery

The phone operator provides you with a Subscriber Identity Module (SIM) card that stores your mobile phone number, phone book entries, SMS/MMS messages, etc. Install the SIM card before you install the battery.

**NOTE**

The SIM card usually comes embedded on a plastic card. Read the SIM card documentation before removing the SIM card. Remove any rough edges on the SIM card before you install it into the phone.

### To install the SIM card

1. Press down the back cover release latch (A) and slide it open in the direction of the arrow as shown.
2. Lift and remove the battery.
3. Insert the SIM card into the card slot with the contacts area facing down.

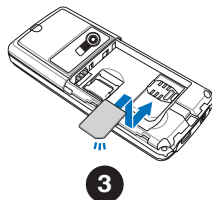
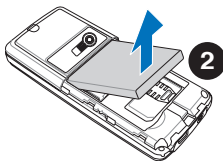
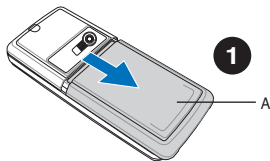

### To insert the battery

1. Align the exposed metal contacts on the edge of the battery with the contacts on the phone.
2. Slide the back cover into your phone.

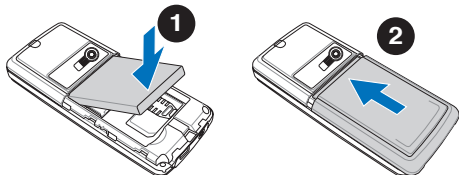

## 1-4 Installing and removing a micro SD card

### To install / remove a micro SD card

1. Remove the back cover and the battery.
2. The micro SD card slot is located above the SIM card slot. Slide the metallic part of the slot to the left, and flip it open.
2. **To install a micro SD card:** With the label side (usually the side with the card manufacturer's name) face up, and the barcode/serial number side face down, slide the card gently into the micro SD card slot.

**To uninstall a micro SD card:** Slide the micro SD card out.

3. Flip the metallic part of the cover back into its position, and slide it to the right to secure it.
4. Put back the battery and the back cover.

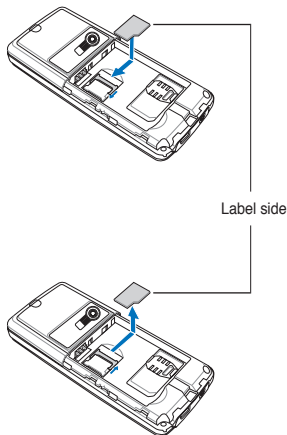

**CAUTION** A micro SD card fits only in one orientation. DO NOT force the card into the slot!

## 1-5 Charging the battery

Fully charge the battery before using the phone for the first time. This may take about eight (8) hours. You can charge the battery whether the phone is on or off.

A battery icon on the main and external displays indicates the battery power level. Refer to “Status indicator icons” in **2-2 Home screen** for battery icon indications.

### To charge the battery

1. Connect the AC adapter to a power source.
2. Connect the power cable plug to the mini USB sync and power connector.

---

**NOTE** The power LED lights up amber to indicate that the battery is charging and lights up green when the battery is fully-charged.

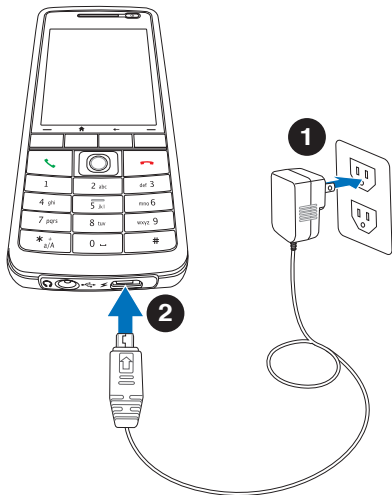

---



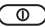

## 1-6 Turning your Smartphone ON/OFF

### To turn ON your phone

1. Press and hold the **Power button**  for about three seconds until the display turns on.
2. If you are asked for a Personal Identification Number (PIN) code, key in the code using the keypad, then press . The main display shows the idle screen.
3. Enter your PIN code (if necessary) and press **Done**.  
Wait for your operator and Microsoft screens to load.

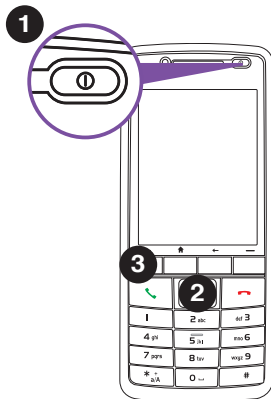

### To turn OFF the phone

Do one of the following:

- Press and hold the **Power button**  for about three seconds until the Microsoft Mobile power off screen shows and wait for the display to turn off.
- Press and quickly release the **Power button**  and select **Power off** from the Quick List screen.

## Chapter 2 Learning to Use Your Smartphone

### 2-1 Home screen

The Home screen automatically displays when you turn on your Smartphone or leave it idle.

The top of the Home screen displays the five most recently-used programs. The center of the display shows the service provider, the time, your next appointment, your current profile, and the number of new text messages. Scrolling to any of these items and pressing the joystick  opens the associated program.

---

**NOTE** Pressing  at any time takes you back to the Home screen.





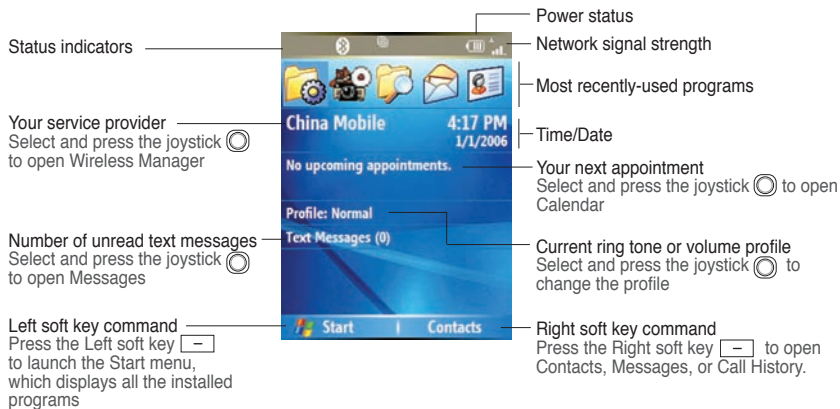





















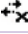

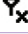
To customize the Home screen (layout, color scheme, background image), press **Start > Settings > Home Screen**.

---

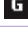

## Status indicator icons

Status indicators appear at the top of the screen and on the Home screen. The following table lists common status indicators and their meanings.

	New e-mail or text message (SMS)		Battery charging		T9 text input mode, lowercase
	New voice mail		Bluetooth		T9 text input mode, smart case
	New instant message		Signal strength		T9 text input mode, caps lock
	XXXVoice call		No signal		Numeric input mode
	Voice call in progress		Roaming		1XRTT connection available
	Data call in progress		Sync connection off		No voice mail
	Calls are forwarded		XXXRadio off		Pending alarm
	Call on hold		Ringer off		GPRS available
	Missed call	abc	Multipress input mode, lowercase		GPRS in use
	Battery level	Abc	Multipress input mode, smart case		Missing SIM card
	Low battery	ABC	Multipress input mode, caps lock		Faulty SIM

**NOTE** Actual status indicator icons may vary from the ones represented in this guide.

## 2-2 Start menu

Your Smartphone comes with many pre-installed programs that you can use. These programs can be accessed from the Start menu.

### To use the Start menu

1. On the Home screen, press **Start**.
2. Do one of the following:
  - Scroll to a program using the navigation keypad and press **○**.
  - Press the corresponding number on the alphanumeric keypad. For example, press **1** to open Internet Explorer and **9** to open Settings.

You can download programs from the Internet and use ActiveSync to add these programs to the Start Menu on your phone.

To remove programs, use File Explorer (**Start > More > File Explorer**) or Remove Programs (**Start > Settings > Remove Programs**).

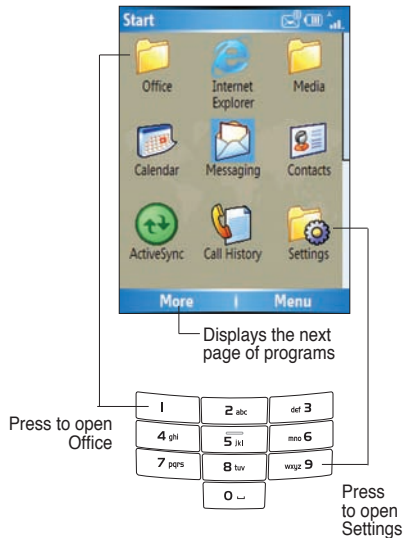

## 2-3 Quick List

The Quick List provides you with a quick access to the commonly-used commands such as turning off/locking the phone, turning off wireless capabilities, and changing the profile type.

### To use the Quick List

1. Press and quickly release the **Power button**  to display the Quick List.
 

**NOTE:** If you press and hold too long, the phone will be powered off.
2. Select the command you want by scrolling through the list and pressing . You can also press the corresponding number on the alphanumeric keypad.
3. To return to the Home screen, press **Cancel**.

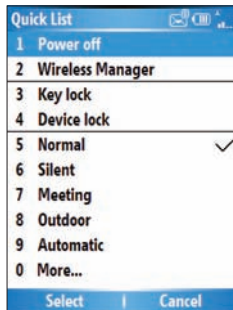

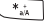

QUICK LIST COMMAND	DESCRIPTION
Power off	Turns off the phone
Wireless Manager	Turns on/off the phone and/or all wireless capability.
Key lock	Locks the keypad. To unlock the keypad, press <b>Unlock</b> , and then press the Asterisk key  .
Device lock	Select how soon your phone will lock after the last keypress.
Normal / Silent / Meeting / Outdoor / Automatic / Headset / Car / Speakerphone	Select to make one of these profiles the current one. A check indicates the current profile. To change profile settings, select a profile and press <b>Menu &gt; Edit</b> .

# Chapter 3 Using Call Features

## 3-1 Making a call

### Calling from the Home screen

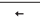
#### To call from the Home screen

1. On the Home screen, enter the phone number you want to call.  
If you entered the wrong number, press **Back**  to delete the last digit; press and hold to delete all digits.
2. Once you have entered the number, press **Call** or  to make the call.
3. Press  to end the call.



**NOTE** As you enter a phone number, the Smartphone searches Contacts, Call History, and the Speed Dial lists to find a matching name and/or number. When you see the name or number of the person you want to call on the list, select it using the Up/Down navigation keys.

To redial the last number called, press  twice.

## Calling a Contacts entry

### To call a Contacts entry

1. On the Home screen, press **Contacts**.
2. Use the Up/Down navigation keys to select the contact name you want to call.

---

**TIP** To quickly find a contact in a long list of contacts, you can enter the first few letters of the contact's name to narrow the search.

---

3. Press **Call** or  to make the call.

---

**NOTE** By default, the contact's mobile telephone number is dialed first when you make a call from Contacts unless you specify otherwise.

---

### To change the default number for a Contact

1. On the Home screen, press **Contacts**.
2. Select the contact whose default phone number you want to change.
3. Use the Left/Right navigation keys to change the default number. The letter to the right of the contact's name indicates the default number — m (mobile), w (work), or h (home).

## Calling a number from the Call History list

### To make a call from the Call History list

1. On the Home screen, press  or press **Start > Call History**.
2. Select the number or name you want to call, and press  or .



### Calling using speed dial

You can create speed dials for frequently-called phone numbers or frequently-accessed items. You may choose Speed Dial entries from 2-99. Speed Dial 1 is reserved for voice mail access and the number is configured in your settings. You can create a Speed Dial for a phone number, a program on the Start menu, an E-mail address, or Web page address (URL) that is stored in your phone's Contacts.



---

**NOTE** You must assign a speed dial key to a phone number before you can use the speed dial feature.

You can create a speed dial only for a phone number, e-mail address, or Web page address that is stored in your phone's Contacts. You cannot create a speed dial for a contact stored in the SIM card.

---

#### To create a speed dial for a phone number, e-mail address, or URL address

1. On the Home screen, press **Start > Contacts**.
2. Select a contact and press  to view the contact details.
3. Select the phone number, e-mail address, or URL address, for which you want to assign a speed dial and press **Menu > Add to Speed Dial**.
4. Enter appropriate details in Name, Value, and Keypad assignment . In **Keypad assignment**, use the Left/Right navigation keys to select, or press  to view the full list of choices.
5. Press **Done**.

---

**NOTE** To quit at any time during this process, press **Menu > Cancel**.

---

### To make a call using speed dial

On the keypad, press and hold the speed dial's assignment. If the keypad assignment consists of two digits, press the first digit then press and hold the second digit.

### To create a speed dial for an item on the Start menu

1. On the Home screen, press **Start**.
2. Select an item and press **Menu > Add Speed Dial**.
4. Enter the appropriate details in Name, Value, and Keypad assignment . In **Keypad assignment**, use the Left/Right navigation keys to select, or press  to view the full list of choices.
5. Press **Done**.

### Making emergency calls

Calls to emergency service numbers can be made even if you have locked the SIM card and/or your phone.



### To place an emergency call

Enter the emergency number appropriate for your location, and press **Send** .

### Making international calls

To make international calls, you must first enter the international prefix (+), followed by the country code and the rest of the phone number.

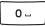
### To place an international call

1. Press and hold **0**  on the keypad to enter a plus sign.
2. Enter the full phone number with the country code, area code, and phone number, and then press .

## 3-2 Retrieving voice mail messages

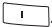
On the Home screen, press **Voice Mail** or press and hold **1** . Follow the voice instructions to retrieve your messages.

## 3-3 Responding to a call

When you receive a call, the screen displays the caller's name and phone number. If the caller is not in your Contacts list, the screen displays the number only. When you receive a phone call, you have the option to answer or to ignore it.

### To answer a voice call

Press **Answer** or .

### To ignore a voice call

Press **Ignore** or .

---

**NOTE**

Selecting **Ignore** or  will send the caller to your voice mailbox if it is enabled. If it is not, the caller will hear a busy tone.

---

## 3-4 Options during a call

Below are the options during or for making a call. Some of these options are available only when multiple calls are in progress or during a conference call.

IN-CALL MENU OPTION	DESCRIPTION
Hold	Places the active call on hold.
Unhold	Activates the call that's on hold.
Mute on	Switches off the microphone for the active call (you can hear the caller but the caller can't hear you).
Mute off	Turns the microphone <b>back on for the active call</b> .
Speakerphone On/Off	Activates/deactivates the speakerphone. <b>NOTE:</b> You can also press and hold  during an active call.
Conference	Joins together all existing calls if you have subscribed to this service.
Turn Hands-free On/Off	Activates/deactivates the hands-free function. This function is only available if your phone has been connected to a hands-free kit. When activated, the call will be redirected to the hands-free kit, allowing you to talk using the remote earphone/microphone set.
Contacts	Opens the Contacts list.
View Contact	Display information about the caller.
View Calendar	Opens the Calendar program
Call History	Opens the Call History list.

## Chapter 3

---

---

---

---

---

---

---

---

---

---

---

---

---

---

---

---

---

---

---

---

---

---

---

# Chapter 4 Synchronizing with ActiveSync

## 4-1 Microsoft ActiveSync

With ActiveSync, you can synchronize the data on your PC with that on your Smartphone. Synchronization compares the data on your phone with your PC and updates both with the most recent information. You can also use synchronization to add new programs to your phone.

Before you can synchronize your phone with your PC, you need to complete the following steps:

1. Install ActiveSync on your PC.
2. Connect your phone to the PC.
3. Create a partnership between the two devices.

---

**NOTE** For more information about synchronization, see the **ActiveSync Help** on your PC.

---

## 4-2 Installing ActiveSync on your PC

The **ActiveSync** program is pre-installed on your Smartphone. To synchronize the data on your phone with your PC, you must also install ActiveSync on your PC. Install ActiveSync from the **Getting Started CD** included in your product package.

---

**NOTE** Before starting the ActiveSync installation, make sure that you have Microsoft® Outlook® installed on your PC. If you do not have Outlook, install the Microsoft® Outlook® from the Getting Started CD. If you have Outlook 98 or Outlook 2000 installed, you are encouraged to update to the Outlook bundled in the Getting Started CD.

---

**IMPORTANT** Do not connect your phone to your PC until you have finished installing ActiveSync.

---

### To install ActiveSync on your PC

1. Place the Getting Started CD into the CD drive of your PC and follow the on-screen instructions to install ActiveSync.
2. Click **Start Here** to display the Overview screen.
3. If you have not installed Outlook, install it now. Click **Install Outlook** and follow the screen instructions to complete the installation.
4. Click **Install ActiveSync**, then follow the on-screen instructions to complete the installation.

## 4-3 Connecting your phone to a PC

### To connect your Smartphone to a PC

1. When prompted, connect the appropriate end of the USB sync cable to the mini USB and power connector at the bottom of your phone and the other end to a USB port on your PC.
2. ActiveSync will autostart when it detects your phone, and the **Smartphone Sync Setup Wizard** will open.

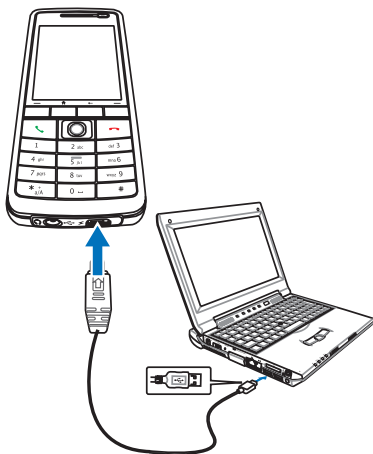

## 4-4 Creating a partnership

The wizard guides you through the steps in creating a partnership. In the **Sync Setup Wizard**, you can do the following:

- Create a synchronization relationship between your PC and your phone.
- Configure an Exchange Server connection to synchronize directly with your phone. Before doing this, obtain the name of the Exchange Server, and the domain name from your administrator.
- Choose the information types (Calendar, Contacts, Tasks, Outlook E-mail, Favorites) to synchronize.

When you finish the wizard, ActiveSync automatically **synchronizes your phone**. Once synchronization is completed, you can disconnect your phone from your PC. After the first synchronization, your selected information from your PC that you selected will appear in your Smartphone.



## 4-5 Synchronizing with a PC

### Changing information to synchronize

By default, ActiveSync does not automatically synchronize all Outlook information. You can use ActiveSync options to turn synchronization for specific information types on and off:

1. On the Home screen, press **Start > ActiveSync**.
2. Press **Menu > Options**.
3. Do one or more of the following:
  - Select the check box for the items you want to synchronize.
  - Clear the check box for any items you do not want to synchronize.
  - To customize synchronization of a PC, select the PC name then press **Menu > Settings**.
  - To customize synchronization of a particular type of information, select the information type then press **Settings**.
  - To stop synchronizing with a PC completely, select the PC name and press **Menu > Delete**.

---

**NOTE** E-mail can be synchronized with only one PC.

---

### Using USB sync cable

When you connect your phone to the PC, ActiveSync automatically detects it and starts synchronizing.

1. Connect your phone to a PC using the USB sync cable.
2. ActiveSync should automatically detect it and start synchronizing. If not, on the Home screen, press **Start > ActiveSync**.
3. Press **Sync** to start synchronizing.
4. Press **Stop** to stop synchronization before it completes.

### Using Bluetooth



You can synchronize your phone with a PC using local wireless technologies such as Bluetooth.

#### To synchronize using Bluetooth

1. Follow the instructions in ActiveSync Help on the PC for configuring Bluetooth on your PC to support ActiveSync.
2. On the Home screen, press **Start > ActiveSync**.
3. Press **Menu > Connect via Bluetooth**. Ensure that the phone and PC are within close range.

---

**NOTE**

If this is the first time you have connected to this PC using Bluetooth, you must complete the Bluetooth wizard on the phone and set up a Bluetooth partnership with the PC before synchronizing. For more information about setting up a Bluetooth partnership, see “Creating a Bluetooth partnership” in **6-4 Using Bluetooth**.

---

4. Press **Sync**.
5. When finished, press **Menu > Disconnect Bluetooth**. To preserve battery power, turn off Bluetooth.

## 4-6 Synchronizing with an Exchange Server

To set up an Exchange Server connection, you will need to get the name of the server and the server domain name from your service provider or system administrator. You must also know your Exchange user name and password.

---

**NOTE** Before you change synchronization settings on the phone, disconnect it from your PC.

---

1. On the Home screen, press **Start > ActiveSync > Menu > Configure Server**. If you have not yet set up sync with Exchange Server, this will say **Add Server Source**.
2. In **Server address**, enter the name of the server running Exchange Server, and press **Next**.
3. Enter your user name, password, and domain name, and press **Next**.  
If you want the phone to save your password so that you will not need to enter it again when connecting, select the **Save password** check box.
4. Select the check boxes for the types of information items that you want to synchronize with the Exchange Server.
5. To change available synchronization settings, select the type of information, and press **Menu > Settings**.
6. To change the rules for resolving synchronization conflicts, **Menu > Advanced**.
7. Press **Finish**.

### 4-7 Creating a synchronization schedule

You can create a schedule for automatically synchronizing information on your Smartphone with your PC or with Microsoft Exchange Server.

To set up a synchronization schedule with your PC, you must use ActiveSync on the PC. For more information on synchronization, see ActiveSync Help on the PC.

To set up a synchronization schedule with an Exchange server, you must use ActiveSync on your phone. See the next section for details.

# Scheduling synchronization

Before changing the synchronization settings on the phone, disconnect the phone from your PC.

## To schedule synchronization

1. On the Home screen, press **Start > ActiveSync > Menu > Schedule**.
2. Do one or more of the following:

TO SYNC	DO THIS
Automatically as items arrive.	Under <b>Peak times</b> , select <b>As items arrive</b> . It's more cost-efficient to synchronize on at regular intervals when mail volume is high. Under <b>Off-peak times</b> , select <b>As items arrive</b> . This can be more cost-efficient than synchronizing on a regular schedule when mail volume is low.
When you are working, or e-mail volume is high.	Select an appropriately frequent interval in the Peak times list.
When e-mail volume is low.	Select a longer interval or As items arrive in the Off-peak times list.
While roaming	Select the <b>Use above settings while roaming</b> check box. To minimize roaming charges, clear the check box, and synchronize manually while roaming.
When you press Send in Messaging on the phone	Select the <b>Send outgoing items immediately</b> check box.

**NOTE** To change peak time settings to more accurately adjust to periods of e-mail volume for you, press **Menu > Peak Times**.

### 4-8 Remote synchronization

Remote synchronization is synchronizing your phone over a wireless connection instead of using a direct local connection to a PC. Synchronizing remotely with your PC may depend on your network configuration. For example, you may need to set up a virtual private network (VPN) connection to your network.

To synchronize remotely, you need to set up a connection first and then configure your phone. For more information on remote synchronization, see the **ActiveSync Help** guide.



# Chapter 5 Managing Your Smartphone

## 5-1 Personalizing your Smartphone

### Settings screens

You can view and change the settings on your Smartphone according to your preferences. This includes changing the Home screen layout, adding your own ring tone, and setting options for received calls, call forwarding or call waiting.

On the Home screen, press **Start** > **Settings** to display the Settings screen.

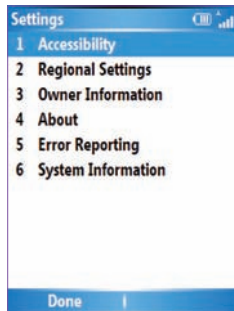

---

**NOTE** Selecting **More** from the Settings screen will display a second screen of Settings options.

---



### Personalizing your Home screen

#### To personalize your Home screen

1. On the Home screen, press **Start > Home Screen**.
2. Make your desired changes and press **Done**.

#### To personalize the Home screen with your own image

1. On the Home screen, press **Start > More > Pictures & Videos**.
2. Select an image to use as the background image and press .
3. Press **Menu > Use as Home Screen**.
4. Use the **Left/Right** navigation keys to select the display area and press **Next**.
5. Use the **Left/Right** navigation keys to adjust the transparency and press **Finish**.

### Setting the date, time, and alarm

#### To set the date and time

1. On the Home screen, press **Start > Settings > Clock and Alarm > Date and Time**.
2. Enter the correct information and press **Done**.

#### To set an alarm

1. On the Home screen, press **Start > Settings > Clock and Alarm > Alarm**.
2. Enter the correct information and press **Done**.

# Changing regional settings

## To change regional settings

1. On the Home screen, press **Start > Settings > More > Regional Settings**.
2. In **Language**, select your preferred language for the phone interface and menus.
3. In **Locale**, select your current location. The Locale option automatically changes the format of the remaining options, such as date, time, and currency, to reflect those used in that locale.
4. Press **Done** after you have finished making changes.

---

**NOTE** To activate the new language settings, you will need to turn the phone off and back on.

---

# Changing profile settings

A profile determines how you get notified of events such as incoming calls, upcoming appointments, and new messages. Your current profile is displayed on the Home screen.

## To quickly change the current profile

To quickly switch to a different profile, press and quickly release the **Power Button**  and scroll to the desired profile in the Quick List screen and press **Select**. To open the second page of the Quick List screen for more profile options, select **More**.

---

**NOTE** When profile is set to **Automatic**, your phone will automatically switch to Silent mode whenever you have a meeting set up in Calendar.

---

### To modify a profile

1. On the Home screen, press **Start > Settings > Profiles**.
2. Scroll to the profile you want to change, press **Menu**, and select **Edit**.
3. Change the settings and press **Done**.

---

**NOTE** To restore the default settings of a profile, press **Menu** and select **Reset to default**.

---

### Customizing sounds for ring tones

Use Sounds settings to customize the sounds for ring tones, notifications, reminders, alarm clock, alert, and key tones. The phone comes with 20 pre-installed polyphonic ring tones from which you can choose.

### To change the sound

1. On the Home screen, press **Start > Settings > Sounds**.
2. Highlight the item for which you want to change the sound.
3. Do one of the following:
  - Scroll left/right to select a different sound.
  - Press  to open the full list of sounds available for that event.

### To use your own sound

1. Locate the sound file on your PC and copy the file.

---

**NOTE** The file must be in .wav, mid, .wma, or .mp3 format.

---

2. Connect your phone to the PC.

3. Open ActiveSync on your PC and click **Explore**.
4. Go to the **Storage\Application Data\Sounds** folder on your Smartphone and paste the file.
5. On the Home screen of your phone, press **Start > Settings > Sounds**.
6. Highlight the item to customize and scroll left/right to find the sound file.

## Entering your contact information

The Owner Information screen is for entering and displaying personal information, such as your name, phone number, and e-mail address. Entering this information is recommended as it allows the person who finds the phone to be able to contact you in case it is lost.

### To enter owner information

1. On the Home screen, press **Start > Settings > More > Owner Information**.
2. Enter your details and press **Done**.

## 5-2 Improving performance

### Changing accessibility settings

#### To change accessibility settings

1. On the Home screen, press **Start > Settings > More > Accessibility**.
2. You may set your preferences for the following:

**Multipress time out:** Set the length of time to wait between keypresses when entering text in Multipress mode.

**Confirmation time out:** Set the delay before an unconfirmed action times out.

**In-call alert volume:** Set the volume for incoming call or receiving new message alerts while you are on the phone.

### Smartdial Setting:

3. Press **Done** when finished.

## Changing power settings

Use Power Management to check the battery level and to configure power-saving settings, such as backlight and display time-outs.

1. On the Home screen, press **Start > Settings > Power Management**.

The first item showed is **Main battery** indicator, where you can see how much power is left in the battery. This item is not adjustable.

2. You may set your preferences for the following:

**Backlight time out on battery:** Set the amount of time for the phone to be idle before the backlight turns off.

In **Backlight time out on AC:** Set the amount of time for the phone to be idle before the backlight turns off when using AC power.

**Display time out:** Set the time limit for the phone to be idle before the screen turns off.

3. Press **Done** when finished.

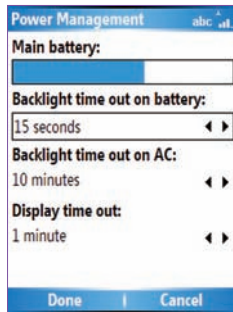



## 5-3 Turning on/off wireless mode

### To turn on/off Bluetooth

Do one of the following:

- Press and quickly release the **Power button**  to display the Quick List screen and select **Wireless Manager**. Select **Bluetooth** and press .
- On the Home screen, press **Start > Settings > Connections > Bluetooth**. Select **On, Discoverable, or Off**.

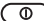
### To turn on/off radio mode

Press and quickly release the **Power button**  to display the Quick List screen and select **Wireless Manager**. Select **All** and press  to toggle between on and off mode.

---

**NOTE** Turn off all radio interfaces of your phone when on an aircraft or in a hospital. You will not be able to make calls or send messages/emails but will still be able to use the organizer functions of your phone.

---

## 5-4 Keeping your Smartphone secure

Customize the level of security you want your phone to have by locking the keypad, the SIM card, or the entire phone.

### Locking the keypad and multimedia player controls

#### To lock the keypad

Press and quickly release the **Power button**  to display the Quick List screen and select **Key lock**.

### To unlock the keypad

Press **Unlock** followed quickly by the \* key .

### Locking the SIM card

Locking the SIM card prevents unauthorized use of your phone, but you will still be able to make emergency calls. When you turn on the phone, you will be asked to enter your PIN1 password.

#### To lock the SIM card and set the PIN

1. On the Home screen, press **Start > Settings > Security > Enable SIM PIN**.
2. Enter the password (SIM card's PIN1), and press **Done**.

Once the PIN is enabled, your Smartphone will ask you to enter the PIN whenever you turn it on.

#### To unlock the SIM card

1. On the Home screen, press **Start > Settings > Security > Disable SIM PIN**.
2. Enter the password (SIM card's PIN1), and press **Done**.

#### To change the PIN



1. On the Home screen, press **Start > Settings > Security > Change SIM PIN**.
2. Enter the original PIN1 code.
3. Enter and confirm the new PIN, and then press **Done**.

#### To change PIN2

1. On the Home screen, press **Start > Settings > Security > Change PIN2**.
2. Enter the original PIN2 code (SIM card's PIN2).
3. Enter and confirm the new PIN2, and then press **Done**.

# Locking the phone

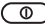
## To lock the phone

1. Do one of the following:
  - On the Home screen, press **Start > Settings > Security > Device Lock**.
  - Press and quickly release the **Power button**  to display the Quick List screen and select **Device lock**.
2. Select the **Prompt if device unused for** check box by pressing .
3. Scroll down to the field below and select the amount of time for the phone to be inactive before it locks automatically.
4. In **Password type**, select the type of password you want to use.
5. Enter and confirm your password, and then press **Done**.

## Controlling outgoing calls

Fixed dialing allows you to restrict your outgoing calls to selected phone numbers, if supported by your SIM card. You need the PIN2 code for this function. When this function is active, you can only call those phone numbers that are in your fixed dialing list. Call barring, on the other hand, blocks certain types of call. Before you can use it, you must set up a Fixed dialing list.

1. On the Home screen, press **Start > Settings > Phone > Fixed Dialing**.
2. Select **Enable fixed dialing** by pressing  and then press **Done**.
3. Enter your SIM PIN 2, and press **Done**. Once fixed dialing has been turned on, you can begin to store fixed dialing numbers.



4. Press **Menu > Edit Numbers**.
5. Press **Menu > Add** and enter the phone number to add to your fixed dialing list.
6. Press **Done**.
7. Repeat steps 2 and 3 to add more numbers.

### Blocking incoming/outgoing calls

Emergency calls can still be made with Call Barring on.

1. On the Home screen, press **Start > Settings > Phone > Call Barring**.
2. In **Block incoming calls**, select **Off**, **When roaming**, or **All calls**.
3. In **Block outgoing calls**, select **Off**, **Int'l except to home**, **Int'l calls**, or **All calls**.
4. Press **Done**.

## 5-4 Setting network options

To change the phone network, press **Start > Settings > Phone > GSM/3G Networks**. You may choose between GSM, 3G or automatic, which automatically detects your network every time you power on your phone.

---

**NOTE** You must turn your phone off and then turn back on to apply the network changes.

---

## 5-5 Restarting your phone

You may sometimes need to restart your phone such as when a program is not performing properly, or the phone does not respond to key presses.

### To restart the phone

1. Remove the battery.
2. Reinsert the battery and turn on your phone.

## 5-6 Resetting your phone

Resetting your phone will remove all the data from memory and restore the phone back to its factory default settings.

---

**NOTE** When you reset your phone, all the data you have entered in RAM, including all files, system settings, and additional programs you have installed, will be erased.

---

### To reset your phone

1. On the Home screen, press **Start > More > Tools > Default Settings**.
2. Enter **1234** to confirm that you want to restore default settings and press **OK**.

The phone will restart automatically after it has been reset.

## 5-7 Adding and removing programs

You can use ActiveSync to add programs to your phone or add a program directly from the Internet.

### To add programs

1. Download the program to your PC.
2. Read the installation instructions or documentation that comes with the program. Many programs provide special installation instructions.
3. Connect your phone to the PC.
4. Double-click the \*.exe file.
  - If the executable file is an installation wizard, follow the instructions on the screen. Once the program has been installed on your PC, the wizard will automatically transfer the program to your phone.
  - If an installation wizard does not start, you will see an error message stating that the program is valid but that it is designed for a different type of PC. You will need to copy this program to your phone. If you cannot find any installation instructions for the program, use ActiveSync to copy the program file to the Program Files folder on your phone.

### To remove a program

Programs that come with the phone cannot be removed.

1. On the Home screen, press **Start > Settings > Remove Programs**.
2. Scroll to the program to remove.
3. Press **Menu > Remove**.

## 5-8 Managing and backing up files

To manage your files, you can use the File Explorer or a storage card (micro SD card) on your Smartphone, or the ActiveSync on your PC.

You can back up files to your PC using ActiveSync or copy files to a storage card on your phone. You can also efficiently manage your files and folders using the File Explorer program on your phone. Changes you make to the information on one PC will not affect the information on the other PC. If you want to automatically update information on both your phone and PC, synchronize the information instead. For more information about copying and synchronizing files, see the **ActiveSync Help** guide on your PC.

### To copy a file using ActiveSync

Copying a file results in separate file versions on your phone and your PC. Because the files are not synchronized, changes made to one file will not affect the other.

1. Connect your phone to your PC.
2. In ActiveSync, click **Explore**.
3. Go to the file that you want to copy on your phone or PC.
4. Do one of the following:
  - To copy the file to your phone, right-click the file, and click **Copy**. Right-click the desired folder on your phone, and click **Paste**.

---

**NOTE** To copy files to a storage card, insert a micro SD card (see **1-4 Installing and removing a micro SD card**). You can play MP3 and other media files directly from a micro SD card inserted into your phone.

---

- To copy the file to your PC, right-click the file and click **Copy**. Right-click the desired folder on your PC, and click **Paste**.

## Using File Explorer

File Explorer allows you to manage the files and folders on your phone just like you do on your PC.

### To start File Explorer

- On the Home screen, press **Start > More > File Explorer**.

Once in the File Explorer application, you can do the following:

TO	DO THIS
Create a new folder	Go to where you want to create the new folder. Press <b>Menu &gt; Edit &gt; New Folder</b> . Enter a name for the new folder and press the joystick.
Rename a file or folder	Select the file or folder that you want to rename, and press <b>Menu &gt; Edit &gt; Rename</b> .
Delete a file or folder	Select the file or folder that you want to delete, and press <b>Menu &gt; Edit &gt; Delete</b> .
Beam a file	Select the file that you want to send. Press <b>Menu &gt; Beam</b> . Select the device to which you want to send and press <b>Beam</b> .

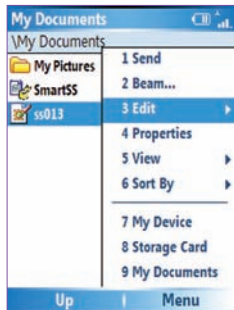

TO	DO THIS
Send a file by e-mail	Select the file to send, press <b>Menu &gt; Send &gt; Outlook E-mail</b> . The Outlook E-mail screen will open with the selected file already attached.
Display information about a file or folder	Select the file or folder, and press <b>Menu &gt; Properties</b> .
Sort files and folders	Press <b>Menu &gt; Sort By</b> , and select a sort option.
Move a file or folder from one location to another	Select the file or folder that you want to move. Press <b>Menu &gt; Edit &gt; Cut</b> . Navigate to the new location and press <b>Menu &gt; Edit &gt; Paste</b> .
Duplicate a file or folder	Select the file or folder that you want to duplicate. Press <b>Menu &gt; Edit &gt; Copy</b> . Navigate to the new location and press <b>Menu &gt; Edit &gt; Paste</b> .



## Chapter 6 Getting Connected

You can set up an Internet or a network connection to do such activities as browse the Internet or intranet, send and receive email and instant messages, and synchronize information using ActiveSync.

With an active connection, you can browse the web, download e-mails, chat using MSN Messenger, or synchronize wirelessly with the server. Check with your Internet Service Provider to see if a connection has already been set up for you, and if over-the-air configuration is supported.

### 6-1 Connecting to the Internet

On the Home screen, press **Start > Settings > Connections** to open the Connections screen. Connections settings allow you to set up Dial-up, Virtual Private Network (VPN), Bluetooth, Proxy, and General Packet Radio Service (GPRS) connections, so you can connect to the Internet or your corporate network.

#### Dial-up connection

##### To create a Dial-up connection

Every network connection is different. You should gather all of the relevant information or network settings you need before starting this process.

1. On the Home screen, press **Start > Settings > Connections > Dial-up**.
2. Press **Menu > Add**.
3. Enter the appropriate information.



**NOTE** In **Connects to**, select **The Internet** to connect directly to the Internet, **Work** to connect to your corporate network, **WAP Network** to connect to a Wireless Application Protocol network, or **Secure WAP Network** to connect to secure WAP sites, such as a bank.

---

4. Press **Done**.

## GPRS, Proxy, and VPN connections

You can create GPRS, Proxy, and VPN connections using the same procedure as that for a Dial-up connection.

### GPRS connection

GPRS is a high-speed transmission through the mobile phone network, which provides permanent online connection. To use GPRS to connect to the network, you need to apply for GPRS service with your Internet Service Provider.

### Proxy connection

If you are connected to your ISP or private network during synchronization, your Smartphone should download the proper proxy settings from your PC. If these settings are not on your PC or need to be changed, ask your Internet Service Provider or network administrator for the proxy server name, server type, port, type of Socks protocol used, and your user name and password. A proxy connection is used to access the Internet using an existing connection to your corporate network.

### VPN connection

A VPN connection helps you to securely connect to servers, such as a corporate network, using an existing Internet connection. Ask your network administrator for your user name, password, domain name, TCP/IP settings, and host name or IP address of the VPN server.

### Changing option settings

The Options screen enables you to specify the number of redial attempts, time to wait before disconnecting, and how your PC connects to the network.

#### To access the Options screen

1. On the Home screen, press **Start > Settings > Connections**.
2. Press **Menu > Advanced > Menu > Options**.

### Adding a URL exception

Some companies use periods in their intranet URLs (for example, intranet.companyname.com). A Work URL exception tells Internet Explorer Mobile to look on the Work network to find the URL instead of searching the Internet.

#### To add a URL exception

1. On the Home screen, press **Start > Settings > Connections**.
2. Press **Menu > Advanced > Menu > Work URL Exceptions**.
3. Press **Menu > Add**.

4. In **URL Pattern**, enter the URL, and press **Done**.

---

**NOTE** Separate multiple URLs with a semicolon (;).  
You should not create URL exceptions for URLs on the Internet.

---

## 6-2 Using Internet Explorer Mobile

You can use Internet Explorer Mobile to browse mobile favorites and channels that have been downloaded to your device without connecting to the Internet. You can also connect to the Internet through an ISP or a network connection to browse the Web.

---

**NOTE** Make sure that you have set up your Smartphone's connection (see **6-1 Connecting to the Internet**).

---

### Opening Internet Explorer Mobile

#### To open Internet Explorer

On the Home screen, press **Start > Internet Explorer**.

With Internet Explorer Mobile, the Favorites list is displayed as the main screen instead of a home page, so you can easily go to your favorite Web sites. You can add Web sites that you visit frequently to this list.

TO	DO THIS
Change connection options	<ol style="list-style-type: none"><li>1. Press <b>Menu &gt; Tools &gt; Options &gt; Connections</b>.</li><li>2. Do one of the following:<ul style="list-style-type: none"><li>• To allow Internet Explorer to select network settings, select <b>Automatically detect settings</b>.</li><li>• To manually choose network settings, in Select <b>network</b>, select the network to which Internet Explorer should connect.</li></ul></li></ol>
View your Favorites list	From any Web page, press <b>Favorites</b> .
Go to a Web page	In Internet Explorer, press <b>Address Bar</b> . Enter the Web page address and press <b>Go</b> .
Go to a Web page in the History list	Press <b>Menu &gt; History</b> . Select a Web page, and click Go.
Clear history, cookies, or temporary files	Press <b>Menu &gt; Tools &gt; Options &gt; Memory</b> .
Add a Web page to the Favorites list	From the Web page that you want to add, press <b>Menu &gt; Add to Favorites</b> .
Change the size of text on Web pages	Press <b>Menu &gt; Zoom</b> and select the size you want.
Show or hide pictures on Web pages	Press <b>Menu &gt; View &gt; Show Pictures</b> . A check mark next to <b>Show Pictures</b> indicates that pictures will be displayed on Web pages.
View a page in full screen mode	Press <b>Menu &gt; View &gt; Full Screen</b> .
Exit full screen mode	Press one of the soft keys, and then press <b>Menu &gt; View &gt; Full Screen</b> to cancel the selection.
Change Web page display options	Press <b>Menu &gt; View</b> . Select one of the display options.
Create a new folder in Favorites	Press <b>Favorites &gt; Menu &gt; Add Folder</b> .

TO	DO THIS
Move a favorite to a folder	Press <b>Favorites</b> . Select the favorite to move. Press <b>Menu &gt; Edit</b> . Under <b>Folder</b> , scroll to the folder to which you want to move the favorite and press <b>Done</b> .
Send a link via e-mail	Go to the Web page you want to send and press <b>Menu &gt; Tools &gt; Send Link via E-mail</b> . Select <b>Text Messages</b> or <b>Outlook E-mail</b> .

### 6-3 Using Bluetooth®

Bluetooth is a short-range wireless communications technology that allows you to communicate with other devices, such as headsets, printers, PCs, GPS receivers, and other users' mobile devices. Devices with Bluetooth capabilities can exchange information without requiring a physical connection. Unlike infrared, you do not need to line up devices to exchange information through Bluetooth. The devices only need to be within a range of about 10 meters (30 feet) in an open space environment. You can even beam information to a device in a different room, as long as it is within the specified range.

#### Setting the Bluetooth mode

By default Bluetooth is turned off. If you turn it on, and then turn off your phone, Bluetooth also turns off. When you turn on your phone again, Bluetooth turns on automatically.

#### To set the Bluetooth mode

1. On the Home screen, press **Start > Settings > Connections > Bluetooth**.
2. Select **On**, **Off**, or **Discoverable**, and press **Done** .

---

**NOTE** You can also turn Bluetooth on and off by pressing and quickly releasing **Power** to access the Quick List and selecting **Wireless Manager**. Select **Bluetooth > Menu > Bluetooth Settings** to set Bluetooth mode or select **Bluetooth** and press **⊙** to quickly toggle Bluetooth on and off.

---

BLUETOOTH MODE	DESCRIPTION
On	The Bluetooth radio is turned on and you can use Bluetooth features.
Off	The Bluetooth radio is turned off. You might want to turn the radio off at times to conserve battery power, or in situations where radio use is prohibited, like on airplanes and in hospitals.
Discoverable	The Bluetooth radio is turned on, and other Bluetooth devices within range (about 10 meters) can detect your phone.

### Creating a Bluetooth partnership

Before your phone can communicate with another device, you need to create a partnership between your phone and the other Bluetooth-enabled device. Your phone can create partnerships with up to 10 other Bluetooth devices.

#### To create a Bluetooth partnership

1. Ensure that the two devices are within close range and that both Bluetooth-enabled devices are discoverable.
2. On the Home screen, press **Start > Settings > Connections > Bluetooth**.
3. Press **Menu > Devices > Menu > New**. Your phone searches for other Bluetooth-enabled devices and displays them in the list.
4. Select the device with which you want to create a Bluetooth partnership, and press **Add**.
5. Enter a personal identification number (PIN) between 1 and 16 characters, and press **Done**.

6. Enter the same PIN on the other device.

---

**NOTE** Once you create a partnership, the devices don't need to be discoverable to beam information between them; Bluetooth needs only to be turned on.

---

### Pairing with a Bluetooth headset

1. On the Home screen, press **Start > Settings > Connections > Bluetooth** and set Bluetooth on your phone to **Discoverable**.
2. Turn on your Bluetooth headset and bring it to within 30 meters of your Smartphone.
3. Put your Bluetooth headset into pairing mode. Refer to your Bluetooth headset's user manual for instructions.
4. On your phone, press **Menu > Devices > Menu > New**.
5. Select the Bluetooth headset on the Add Devices list and press **Next**.
6. Enter the passkey provided in the headset user manual. The phone will now pair with the headset.
7. Set the Bluetooth mode on your phone to **On** and you are ready to talk hands free.

### Listening to streaming audio with a Bluetooth headset

1. Make sure that your phone is paired with a Bluetooth headset by following the instructions in "Pairing with a Bluetooth headset."
2. On the Home screen, press **Start > Settings > Connections > Bluetooth Profiles > Audio** and select a Bluetooth headset in **Default headset**.
3. Select the **Stream audio to headset** check box and press **Done**.



**NOTE** Select the **Automute** checkbox if you want to enable audio streaming to the Bluetooth headset only and clear it if you want to enable audio streaming to both the phone speaker and the Bluetooth headset.

---

4. Open Windows Media Player and start playing music.

TO	DO THIS
Beam information using Bluetooth	Make sure that Bluetooth is turned on and that the device that you want to beam to is discoverable. Select the item that you want to beam and press <b>Menu &gt; Beam [item]</b> . Select the Bluetooth device to which you want to beam the item and press <b>Beam</b> .
Accept a Bluetooth partnership	Make sure that Bluetooth is turned on and that your phone is discoverable. When prompted to accept a Bluetooth partnership with the other device, press <b>Yes</b> . In <b>PIN</b> , enter a personal identification number (PIN) between 1 and 16 characters, and press <b>Done</b> . You must enter the same PIN that was entered on the device requesting the Bluetooth partnership.
Receive beamed information	On the Home screen, press <b>Start &gt; Settings &gt; Connections &gt; Beam</b> . Select <b>Receive incoming beams</b> . Do the following: <ul style="list-style-type: none"> <li>To receive beams by using Bluetooth, ensure Bluetooth is turned on and that your phone is discoverable and within close range.</li> </ul> Press <b>Yes</b> .
Rename a Bluetooth device	On the Home screen, press <b>Start &gt; Settings &gt; Connections &gt; Bluetooth &gt; Menu &gt; Devices</b> . Select the Bluetooth device to rename and press <b>Menu &gt; Rename</b> . In <b>Name</b> , enter a new name for the Bluetooth device, and press <b>Done</b> .
Synchronize using Bluetooth	On the Home screen, press <b>Start &gt; ActiveSync &gt; Menu &gt; Connect via Bluetooth</b> . See “Using Bluetooth” in <b>4-5 Synchronizing with a PC</b> for more information.
End a Bluetooth partnership	On the Home screen, press <b>Start &gt; Settings &gt; Connections &gt; Bluetooth &gt; Menu &gt; Devices</b> . Select the Bluetooth device with which you want to end the partnership and press <b>Menu &gt; Delete</b> .
Specify a folder for received images from the Image server	On the Home screen, press <b>Start &gt; Settings &gt; Connections &gt; Bluetooth Profiles &gt; Image</b> . In <b>Default image directory</b> , enter the desired directory for storing received images.

TO	DO THIS
Open received images from the Image server in the image viewer	On the Home screen, press <b>Start &gt; Settings &gt; Connections &gt; Bluetooth Profiles &gt; Images</b> . Select the <b>Open received images</b> check box.
Save a thumbnail version of received images in the same folder as the received images	On the Home screen, press <b>Start &gt; Settings &gt; Connections &gt; Bluetooth Profiles &gt; Images</b> . Select the <b>Request thumbnail</b> check box.
Configure security for Bluetooth use	On the Home screen, press <b>Start &gt; Settings &gt; Connections &gt; Bluetooth Profiles &gt; Security</b> .
Specify a folder on your phone to share with another Bluetooth-enabled device	On the Home screen, press <b>Start &gt; Settings &gt; Connections &gt; Bluetooth Profiles &gt; File Transfer</b> . In <b>Root directory</b> , enter the path to the folder. Select the <b>Use server authorization</b> check box if authorization is required each time a remote client wants to connect.
Configure a Bluetooth printer	On the Home screen, press <b>Start &gt; Settings &gt; Connections &gt; Bluetooth Profiles &gt; Printer</b> .
View the status of individual printing jobs	On the Home screen, press <b>Start &gt; Settings &gt; Connections &gt; Bluetooth Profiles &gt; Printer</b> . Press <b>Menu &gt; Status</b> .



# Chapter 7 Messaging

Your Smartphone is capable of composing, sending, and receiving Outlook e-mail, Internet e-mail, Multimedia Messaging Service (MMS) messages, and text messages.

## 7-1 Entering text and numbers

You can enter text and numbers by using the keypad. The phone supports three input modes for entering text and numbers: **Multipress**, **T9**, and **Numeric**. Multipress and T9 modes are used for entering text, and Numeric mode is used for entering numbers. When you select a field that requires text or numbers, the phone automatically selects the appropriate input mode. The status indicator on the top right side of the display screen shows the input mode that is currently active.

### To change the input mode

1. In text messaging mode, press and hold \* .
2. Select the input mode and press .

The status indicator for the selected input mode appears at the top right corner of the screen.

INDICATOR	INPUT MODE
abc	Multipress text input mode, lowercase
Abc	Multipress text input mode, smart case
ABC	Multipress text input mode, caps lock
<b>t9</b>	T9 text input mode, lowercase
<b>T9</b>	T9 text input mode, smart case
<b>T9</b>	T9 text input mode, caps lock
123	Numeric input mode

### Using Multipress mode

Multipress mode allows you to enter text by pressing the assigned key once, twice quickly, or so until your desired character appears. For example, to enter the letters P, Q, R, or S, you use the **7 key** . Press once for P, twice for Q, three times for R, and four times for S. The letter entered most recently is underlined until you have completed the keypresses for the letter and moved on to the next letter.

In Multipress mode, you can lock in a letter in several ways: press the Right navigation key, press the **space key** , or pause and enter the next letter.

### To Change the Multipress time out

On the Home screen, press **Start > Settings > More > Accessibility**. In **Multipress time out**, select the length of the pause between key presses.

### Using T9 mode

To form a word in T9 mode, press the numeric keys that contain the letters you want. As you enter letters, T9 analyzes your keypresses and attempts to complete the word. For example, to enter the word “today”, press 8 , 6 , 3 , 2 , 9 .

### To enter text in T9 mode

1. Press and hold \* and select **T9**. The T9 indicator appears at the top of the screen.
2. Enter letters by pressing the keys on which the letters appear. Press a key only once for each letter. If there is more than one choice in the T9 dictionary for your entry, a list of available words is displayed.



**NOTE** Press #  to enter a space after the word as entered, or select one of the available words, and the space is added automatically.

If you do not see the desired word, select **Add Word?** from the list, and press . Press **Done** to add the word to your text and save it in the phone's dictionary, or **Cancel** to add the word to your text without saving it.

---

## Using Numeric mode

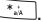
To enter numbers, use Numeric mode. If you need to enter a number within a line of text, change to Numeric mode to enter the number, and then change back to Multipress or T9 mode to finish entering the text.

1. If necessary, change to Numeric mode by pressing and holding \* .
2. Enter the number or numbers you want using the keypad.
3. Change back to Multipress or T9 input mode by pressing and holding \* , and then finish entering your text.

**NOTE** If a field permits a numeric entry only, such as a phone number, the input mode automatically defaults to Numeric mode.

---

TO	DO THIS
Change between uppercase, lowercase, and caps lock	Press the * key within a text input mode. The status indicator for the selected mode appears at the top right corner of the screen.
Enter a space	In Multipress or T9 mode, press the # key.
Enter punctuation in Multipress mode	Press <b>1</b> repeatedly until you see the punctuation mark that you want. To see all of the available symbols, press and hold the # key.
Enter punctuation in T9 mode	Press <b>1</b> , and select from a list of common punctuation.
Enter a symbol	Press and hold the * key. Select <b>Symbols</b> to display the Symbol screen. Select the symbol you want and press <b>Action</b> .
Enter the plus sign for international calls	In a numeric entry field, press and hold the <b>0</b> key
Start a new line	In a multi-line text box such as the Notes area of a contact or a calendar appointment, press <b>Action</b> . This works in any input mode.
Backspace and delete a single character in any input mode.	Press the <b>Back</b> key.
Backspace and delete an entire text or numeric field in any input mode.	Press and hold the <b>Back</b> key.

## 7-2 Setting up accounts

Before you can send and receive e-mails, you need to set up an e-mail account that you have with an Internet service provider (ISP) or an account that you access using a VPN server connection (typically a work account). You can send e-mail messages by synchronizing or by connecting directly to an E-mail server through your Internet service provider or a corporate network.

---

**NOTE** Before you set up e-mail on your Smartphone, you must have an Internet or e-mail account.

---

### To set up an e-mail account

1. On the Home screen, press **Start > Messaging > Outlook E-mail**.
2. Press **Menu > Options > New Account**.
3. In **Your Name**, enter your display name for this account, and in **E-mail address**, enter the e-mail address for this account.
4. Select **Attempt to obtain e-mail settings from the Internet**. Automatic setup attempts to download necessary e-mail server settings so that you do not need to enter them manually.
5. Press **Next**.

---

**NOTE** If Automatic setup is successful, your user name is already entered and you can press **Next**, and then **Finish** to complete setting up your account, or press **Options** to access additional settings.

If Automatic setup is unsuccessful or you have an account you access using a VPN server connection, you will have to contact your ISP (Internet Service Provider) or network administrator to obtain information for entering settings manually.

---





## 7-3 Managing accounts

TO	DO THIS
View a list of accounts	On the Home screen, press <b>Start &gt; Messaging</b> . A list of accounts is displayed with the number of unread messages in the Inbox of each account shown in parenthesis.
Send/receive Internet e-mail messages	On the Home screen, press <b>Start &gt; Messaging</b> . Select the Internet e-mail account for which you want to send and receive messages and press <b>Menu &gt; Send/Receive</b> . To stop this process, press <b>Menu &gt; Stop Send/Receive</b> .
Mark a folder for synchronization	On the Home screen, press <b>Start &gt; Messaging &gt; Outlook E-mail</b> . Press <b>Menu &gt; Folders &gt; Menu &gt; Manage Folders</b> . Select a folder to synchronize and press <b>Sync</b> . The next time you synchronize, the folder(s) that you marked on your Smartphone are synchronized with the corresponding folders in Outlook on your PC.
Delete an account	On the Home screen, press <b>Start &gt; Messaging</b> . Select an account and press <b>Select</b> . Press <b>Menu &gt; Options &gt; Account Options</b> and then select the account you want to delete. Press <b>Menu &gt; Delete</b> .
Switch between accounts	With an account open, press <b>Menu &gt; Switch Accounts</b> or use the Left/Right navigation keys to quickly switch to another account.
Changing account options	On the Home screen, press <b>Start &gt; Messaging</b> . Select an account and press <b>Select</b> . Press <b>Menu &gt; Options</b> and then select the type of option you want to change. Select <b>Done</b> to confirm.

## 7-4 Text and e-mail messages

### To compose and send a text or e-mail message

1. On the Home screen, press **Start > Messaging**.
2. Select **Text Messages** or an e-mail account and press  or **Select**.
3. Press **New**.
4. In **To**, enter the mobile phone number or e-mail address of the person to which you want to send the message or press  to select the person from your contacts.

---

**NOTE** If you are sending a message to more than one recipient, separate them with a semicolon (;).

You can only send text messages to contacts with a mobile phone number.

---

5. Press the Down navigation key, and enter your message.
6. When finished, press **Send**.

---

**NOTE** If you are working offline, e-mail messages are saved to the Outbox folder and sent the next time you connect.

---

TO	DO THIS
Insert a picture into an e-mail message	While composing your message, press <b>Menu &gt; Insert &gt; Picture</b> .
Insert a voice recording into an e-mail message	While composing your message, press <b>Menu &gt; Insert &gt; Voice Note</b> .
Set the priority, security, and language of an e-mail message	While composing your message, press <b>Menu &gt; Message Options</b> .
Cancel a message	While composing your message, press <b>Menu &gt; Cancel Message</b> .
Save a message	While composing your message, press <b>Menu &gt; Save to Drafts</b> .
Delete a message	With the message you want to delete selected, press <b>Menu &gt; Delete</b> .
Move a message to another folder	With the message you want to move selected, press <b>Menu &gt; Move</b> . Scroll to the new folder and press <b>Select</b> .
Sort messages	On any account screen, press <b>Menu &gt; Options &gt; Display</b> . In <b>Sort Messages by</b> , select your desired sort method.
Insert a signature	On any account screen, press <b>Menu &gt; Options &gt; Signatures</b> .
Change message options	On any account screen, press <b>Menu &gt; Options</b> .

## Downloading e-mail messages

Use Messaging to send and receive e-mail messages in one of two ways:

- Synchronize e-mail messages with Microsoft Exchange or Microsoft Outlook on your PC
- Send and receive e-mail messages by connecting directly to an e-mail server through an Internet Service Provider (ISP) or a network

### Synchronizing e-mail messages

You can e-mail messages as part of the general synchronization process. You will need to enable mail synchronization in ActiveSync. For more information on enabling mail synchronization, see the ActiveSync online help on your PC.

---

**NOTE** To connect directly to an e-mail server, see **4-6 Synchronizing with an Exchange Server**.

---

### Managing folders

Each Messaging account has a set of five folders: Deleted Items, Drafts, Inbox, Outbox, and Sent Items. These folders store messages that you send and receive through the account. You can move a message to a different folder within the same account.

TO	DO THIS
View message folder contents	On the Home screen, press <b>Start &gt; Messaging</b> . Select the account that you want to view. Press <b>Menu &gt; Folders</b> and select the folder that you want to view.
Moving a message to a different folder	On the Home screen, press <b>Start &gt; Messaging</b> . Select the account with the message that you want to move. Scroll to the message you want to move and press <b>Menu &gt; Move</b> . Select the folder into which to move the message.
Empty the Deleted Items folder	On the Home screen, press <b>Start &gt; Messaging</b> . Select the account with the Deleted Items folder that you want to empty. Select Deleted Items and press <b>Select</b> . Press <b>Menu &gt; Empty Folder</b> .

## 7-5 MMS messaging

MMS (Multimedia Messaging System) allows you to send text messages with multiple slides. Included on each slide can be a picture, video or audio, and/or text. MMS messages are sent by GPRS (General Packet Radio Service) to e-mail accounts or other MMS-enabled mobile devices.

---

**NOTE** You need to subscribe to the GPRS and MMS services with your service provider before you can send and receive MMS messages. Ask your phone operator on how to activate the MMS feature. Only mobile phones with MMS feature can send/receive MMS messages.

Depending on the service that you subscribe to, you may not be able to send and receive MMS messages to users using a different mobile phone network.

---

### Accessing MMS

Do one of the following:

- On the Home screen, press **Start > Messaging > MMS**.
- After capturing a picture or video clip, press **Menu > Send > MMS**.

### Editing MMS settings

On the MMS main screen, press **Menu > Options > Account Options > MMS** to open the Preferences screen and edit MMS settings. Select or clear check boxes according to your needs.

On the MMS main screen, press **Menu > MMS Settings > MMSC Settings**, and select your Internet Service Provider from the list. Press **Menu > Edit** to access Multimedia Messaging Service Center (MMSC) settings. You should contact your mobile service operator for detail settings.

## Composing and sending an MMS message

### To compose and send an MMS message

1. On the Home screen, press **Start > Messaging > MMS > New**.
2. In the To: field, enter the mobile phone number or e-mail of your recipient. You can enter it using the keypad or press **Menu > Add Recipient** to select from your Contacts. If you have more than one recipient, separate them with semicommas.
3. In the Subject field, enter a subject for the message.
4. Select the Insert Picture/Video box and press . All of your pictures and video clips will be displayed in thumbnail view.
5. Select a picture or video clip and press  or **Select**.
6. Select the Insert Audio box and press . All of your available audio clips will be displayed in thumbnail view.
7. Select the audio clip you want to attach, then press  or **Select**.

---



**NOTE** You will not be able to attach an audio file to a slide with a video clip.

---

8. Press the Down navigation key to scroll down to the text field and enter your message.
9. Press **Send** to send the message.

## Chapter 7

The following assumes that you are on the MMS message screen.

TO	DO THIS
Copy the message to other recipients	Use the Up/Down navigation keys to scroll up to display the Cc field. Enter the recipient's phone number or e-mail address or press  to select a recipient from your Contacts list.
Hide a recipient's contact information from other message recipients	Use the Up/Down navigation keys to scroll up to display the Bcc field. Enter the recipient's phone number or e-mail address or press  to select a recipient from your Contacts list.
Hide sender information	Press <b>Menu &gt; MMS Settings &gt; Send Options</b> . Select the <b>Hide Sender</b> check box.
Go to the next slide	Press the Right navigation key.
Go to the previous slide	Press the Left navigation key.
Create an MMS message from a template	Press <b>Menu &gt; Template &gt; Gallery</b> to compose a message using a predefined template.
Create an MMS message template	Create a message or open an existing message, and press <b>Menu &gt; Template &gt; Save</b> .
Add preset or frequently used text strings to a message	In a text field, press <b>Menu &gt; Insert &gt; My Text</b> . Select the text string that you want to add and press  or <b>Insert</b> .
Create or edit a preset message before adding it to the message body	In a text field, press <b>Menu &gt; Insert &gt; My Text</b> to open the My Text screen. Press <b>Menu &gt; Add My Text</b> or <b>Menu &gt; Edit My Text</b> .
Request message delivery notification	Press <b>Menu &gt; MMS Settings &gt; Send Options</b> . Select the <b>Delivery Report</b> check box.

## 7-6 Using Pocket MSN

Pocket MSN on your device is an instant messaging program that allows you to do the following:

- See who among your contacts is online and chat with them by sending and receiving instant messages.
- Access your hotmail account, if you have one, and send and receive emails.

To use Pocket MSN, you must have a Passport to use the MSN Messenger Service. If you have a Hotmail® or MSN account, you already have a Passport. Once you have obtained either a Microsoft Passport or Microsoft Exchange account, you are ready to set up your account.

Sign up for a Microsoft Passport account at <http://www.passport.com>.

Get a free Microsoft Hotmail e-mail address at <http://www.hotmail.com>.

### Using MSN Messenger

#### To sign in and out of MSN Messenger

1. On the Home screen, press **Start > More > Pocket MSN > MSN Messenger**.
3. On the MSN Messenger main screen, press **Sign In**.
4. Enter the e-mail address and password for your Passport or Hotmail account.
5. Select **Save password** if you don't want to enter your password again in the future and press **Sign In**.
6. To sign out, press **Menu** and then select **Sign Out**.

---

**NOTE** If you do not sign out of MSN Messenger, you will remain connected. This may result in additional charges from your service provider.

---