

# Quick Start Guide

RP-AC51  
Wi-Fi AC Repeater

E16302 / Third Edition / January 2020

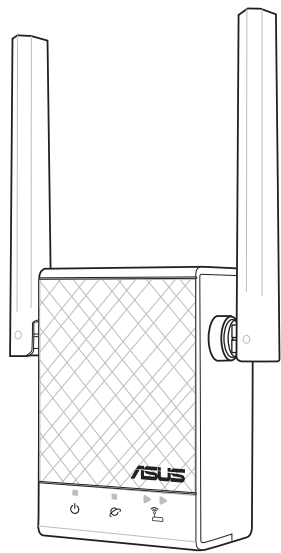

## LED explanations

- POWER**  
On: RP-AC51 is power on.  
Off: RP-AC51 is power off.
- EXISTING NETWORK**  
On: Connected to the router/AP.  
Off: Not connected to the router/AP.
- MOVE CLOSER**  
Need to move RP-AC51 closer to the router/AP.
- MOVE AWAY SLIGHTLY**  
Need to move RP-AC51 slightly away from the router/AP.

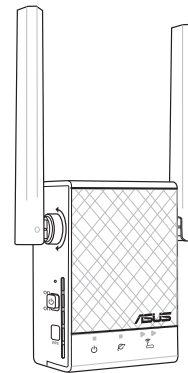

## Button explanations

- POWER SWITCH**  
Switch this button on/off to turn RP-AC51 on/off.
- WPS BUTTON**  
Press this button to quickly connect to the router/AP via the WPS method.
- RESET BUTTON**  
Use a pin to push this button to reset RP-AC51 to its factory default settings.

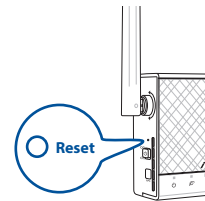

## BEFORE SETUP WE SUGGEST...

### 01 Placing your RP-AC51

- Place your RP-AC51 near your router/AP.
- Check the LEDs and see the LED explanations.

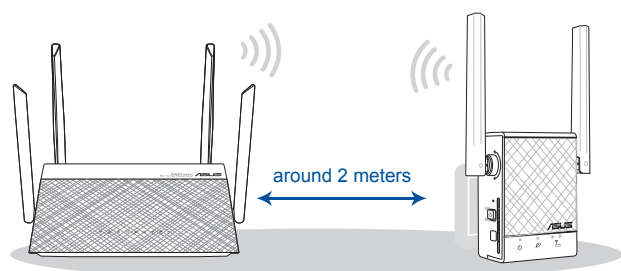

### 02 Power On

- Plug your RP-AC51 to a power outlet.
- Turn on the power switch.

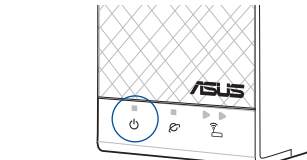
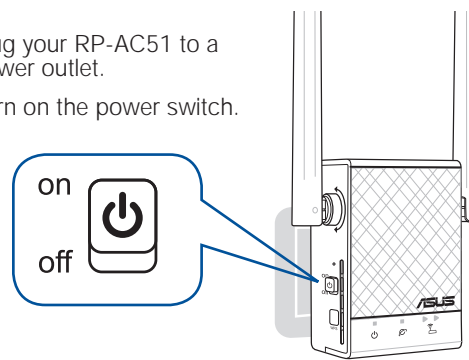

Wait until the power LED turns blue, indicating that your RP-AC51 is ready to connect to your existing router/AP.

## SETUP METHODS

### METHOD 1 APP SUPPORT

#### 01 Download the app



#### 02 Use the app

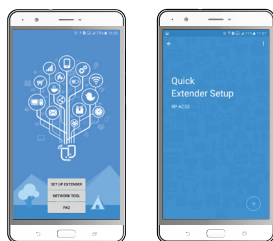

- Tap **SET UP EXTENDER**.
- Open your phone Wi-Fi, and connect to your RP-AC51's SSID.

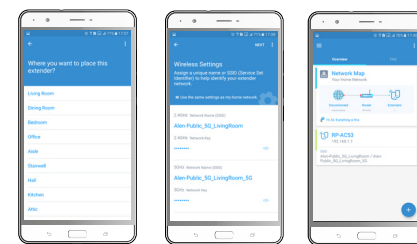

- Follow the Quick Extender Setup instructions.
- Assign a unique network name (SSID) for your extended network.
- Wait until the setup is completed.

### METHOD 2 WPS SUPPORT

#### 01 Connect via WPS

- Press the WPS button on your router/AP.
- Press the WPS button on your RP-AC51 for more than two (2) seconds until the power LED starts to blink.

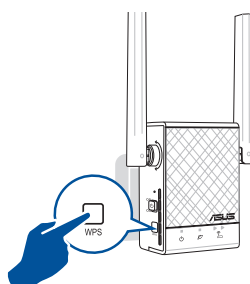
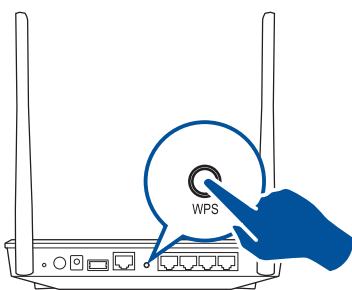

**NOTE:** Wait until the existing network LED blinks for about two (2) minutes, then turns solid blue, indicating the WPS process is completed.

#### 02 Enjoy Wi-Fi

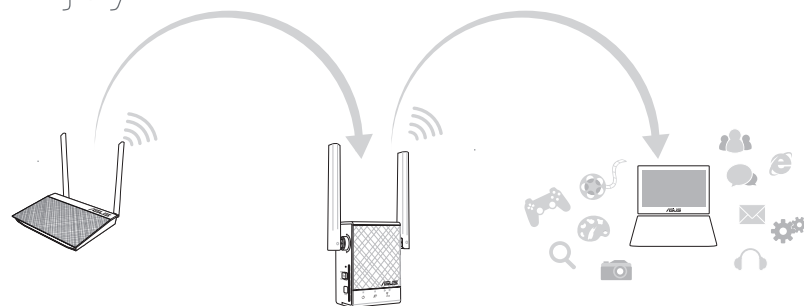

Your RP-AC51's wireless network name (SSID) changes to your existing Wi-Fi network name, ending with **\_RPT** or **\_RPT5G** and shares your router/AP's Wireless Password.

### METHOD 3 WEB SUPPORT

#### 01 Connect

NOTE: The screenshot below is from a desktop PC.

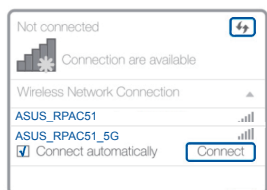

Disconnect your Ethernet (wired) connection from your computer. Click the Wi-Fi icon on the taskbar and connect to RP-AC51's network: **ASUS\_RPAC51** or **ASUS\_RPAC51\_5G**.

#### 02 Extend

- On a web browser, enter <http://repeater.asus.com>.
- Set a unique repeater login name and password.
- Select the existing network you want to extend.

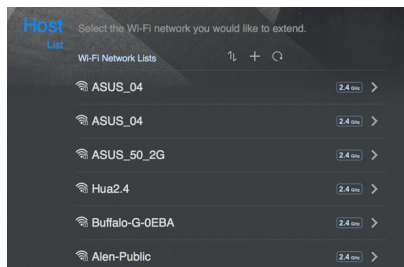

#### 03 Configure

- Tick **Same with Parent AP SSID/Password** to copy the router/AP's SSID and password for your extended network. You could also set a unique SSID and password for your extended network by typing in the text box. When done, click **Apply**.

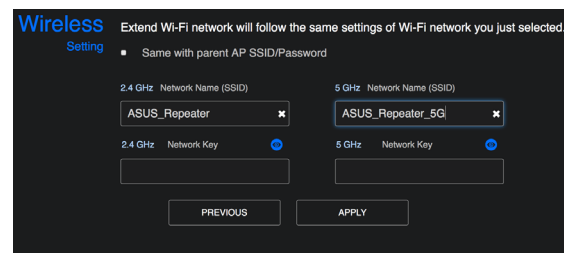

# RELOCATION

## FIND THE BEST PLACE

### After a successful setup

Place your RP-AC51 between your router/AP and wireless device to get the best performance.



- MOVE CLOSER**  
Need to move RP-AC51 closer to the router/AP.
- MOVE AWAY SLIGHTLY**  
Need to move RP-AC51 slightly away from the router/AP.

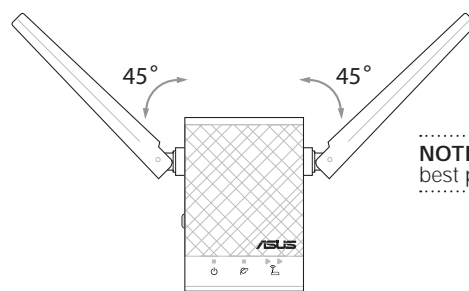

**NOTE:** Orient the two antennas at 45° angle for the best performance.

**NOTE:** To minimize maintenance, keep your RP-AC51 away from devices such as cordless phones, Bluetooth devices, and microwave ovens.

**IMPORTANT!** We recommend that you place your RP-AC51 in open or spacious location.

# AP MODE

## AP MODE SETUP

### 01 Connect

**NOTE:** The screenshot below is from a desktop PC.

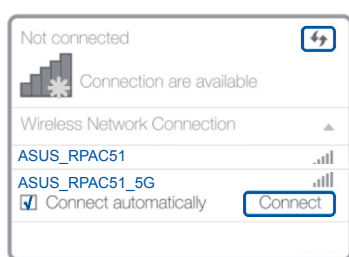

Disconnect your Ethernet (wired) connection from your computer. Click the Wi-Fi icon on the taskbar and connect to RP-AC51's network: **ASUS\_RPAC51** or **ASUS\_RPAC51\_5G**.

### 02 Log in

- Enter your login account and password.
- From your RP-AC51's web interface, click **Administration**, and select **Access Point mode**.

**NOTE:** You can also change to different modes from this page.

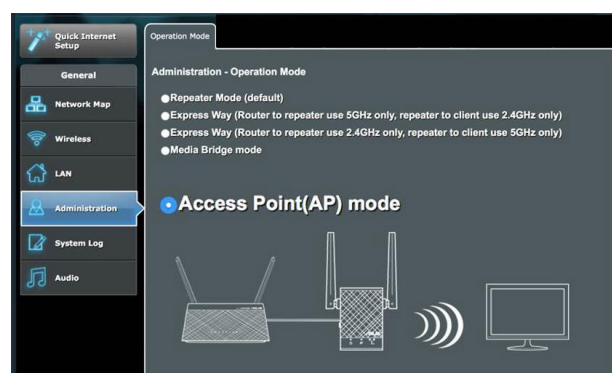

### 03 Setup

- Set up the network name (SSID) and click **Apply**.
- After your RP-AC51 has rebooted, connect your RP-AC51 and router/AP using an Ethernet cable.

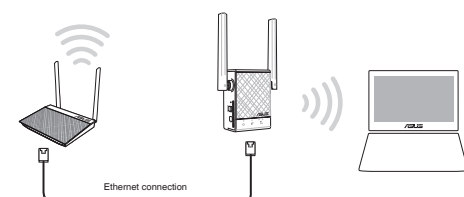

**NOTE:** We recommend that you use Cat 5 or higher Ethernet cable.

# FAQ

## FREQUENTLY ASKED QUESTIONS

Q1

**What should I do if my router does not support WPS?**

**A:** You can use Method One or Method Three to set up your RP-AC51.

Q2

**Why is it that the LED indicator for the current network does not light up after the Wi-Fi setup is complete?**

**A:** You may have entered the wrong password for the router/AP. Please restart your RP-AC51, enter the correct password, and try to set up your RP-AC51 again.

Q3

**Why is it that I cannot see the login page after entering <http://repeater.asus.com> in the browser?**

**A:** Ensure that your computer is connected to your RP-AC51 network only, and set your computer to Obtain an IP address automatically. If you still cannot find the login page, please download the ASUS Device Discovery utility.

Q4

**How do I reset RP-AC51?**

**A:** Press the RESET button on the side of RP-AC51 for about two (2) seconds. Wait for about five (5) seconds until the existing network LED blinks slowly.

### Federal Communication Commission Interference Statement

This device complies with Part 15 of the FCC Rules. Operation is subject to the following two conditions: (1) This device may not cause harmful interference, and (2) this device must accept any interference received, including interference that may cause undesired operation.

This equipment has been tested and found to comply with the limits for a Class B digital device, pursuant to Part 15 of the FCC Rules. These limits are designed to provide reasonable protection against harmful interference in a residential installation. This equipment generates, uses and can radiate radio frequency energy and, if not installed and used in accordance with the instructions, may cause harmful interference to radio communications. However, there is no guarantee that interference will not occur in a particular installation. If this equipment does cause harmful interference to radio or television reception, which can be determined by turning the equipment off and on, the user is encouraged to try to correct the interference by one of the following measures:

- Reorient or relocate the receiving antenna.
- Increase the separation between the equipment and receiver.
- Connect the equipment into an outlet on a circuit different from that to which the receiver is connected.
- Consult the dealer or an experienced radio/TV technician for help.

#### FCC Caution

Any changes or modifications not expressly approved by the party responsible for compliance could void the user's authority to operate this equipment.

This transmitter must not be co-located or operating in conjunction with any other antenna or transmitter.

#### Radiation Exposure Statement

This equipment complies with FCC radiation exposure limits set forth for an uncontrolled environment. This equipment should be installed and operated with minimum distance 20cm between the radiator & your body.

Operations in the 5.15-5.25GHz band are restricted to indoor usage only.

### Industry Canada statement

This device complies with ISED's licence-exempt RSSs. Operation is subject to the following two conditions: (1) This device may not cause harmful interference, and (2) this device must accept any interference received, including interference that may cause undesired operation.

Le présent appareil est conforme aux CNR d'ISED applicables aux appareils radio exempts de licence. L'exploitation est autorisée aux deux conditions suivantes : (1) le dispositif ne doit pas produire de brouillage préjudiciable, et (2) ce dispositif doit accepter tout brouillage reçu, y compris un brouillage susceptible de provoquer un fonctionnement indésirable.

Caution :

- the device for operation in the band 5150-5250 MHz is only for indoor use to reduce the potential for harmful interference to co-channel mobile satellite systems;
- where applicable, antenna type(s), antenna model(s), and worst-case tilt angle(s) necessary to remain compliant with the e.i.r.p. elevation mask requirement set forth in section 6.2.2.3 shall be clearly indicated.

Avertissement:

- les dispositifs fonctionnant dans la bande 5150-5250 MHz sont réservés uniquement pour une utilisation à l'intérieur afin de réduire les risques de brouillage préjudiciable aux systèmes de satellites mobiles utilisant les mêmes canaux;
- lorsqu'il y a lieu, les types d'antennes (s'il y en a plusieurs), les numéros de modèle de l'antenne et les pires angles d'inclinaison nécessaires pour rester conforme à l'exigence de la p.i.r.e. applicable au masque d'élévation, énoncée à la section 6.2.2.3, doivent être clairement indiqués.

### Radiation Exposure Statement:

This equipment complies with ISED radiation exposure limits set forth for an uncontrolled environment. This equipment should be installed and operated with greater than 20cm between the radiator & your body.

### Déclaration d'exposition aux radiations:

Cet équipement est conforme aux limites d'exposition aux rayonnements ISED établies pour un environnement non contrôlé. Cet équipement doit être installé et utilisé à plus de 20 cm entre le radiateur et votre corps.