

User's Manual



BT DF 311

Bluetooth Speakerphone

With Caller ID

Contents

1. About BT DF 311 Bluetooth speakerphone	2
2. About Bluetooth technology	2
3. BT DF 311 Bluetooth speakerphone overview.....	3
4. How to replace the battery	4
5. Installation on the Sun Visor	5
6. Charging the battery.....	6
7. Battery information	7
8. Pair to your Mobile phone	8
9. Turning On/Off the BT DF 311.....	10
10. Phonebook synchronization.....	12
11. Language Switching.....	14
12. Using the BT DF 311	14
13. Reset the user's information.....	20
14. Safety and general information	22
15. Trouble shooting	23
16. Product specifications	24
17. Warranty	25

1. About BT DF 311 Bluetooth speakerphone

This versatile Bluetooth speakerphone is portable and specially designed for the people who want to use their cellphone while driving. **BT DF 311** is built in advanced CVC technology for Echo cancellation & Noise ppression. **BT DF 311** has a LCD display to show the caller's name or number, it is also built-in Text-To-Speech engine, provides the artificial-voice prompting for operation and caller's name or number spelling. **BT DF 311** brings excellent hands-free conversation quality and convenient, safest way to talk and drive.

2. About Bluetooth technology

Bluetooth is a short-range wireless communication technology. The Bluetooth wireless technology makes it possible to connect any compatible portable and stationary communications device without using cables. The technology is based on a radio link that offers fast and reliable transmission of voice and data information. Bluetooth refers to a worldwide standard designed to operate in the internationally recognized ISM (Industrial Scientific and Medical) frequency band. Within the ISM band (2.4GHz~2.485GHz), Bluetooth

transmissions hop between 79 separate frequencies 1,600 times every second, and with a communication range of about 10 meters.

3. BT DF 311 Bluetooth speakerphone overview

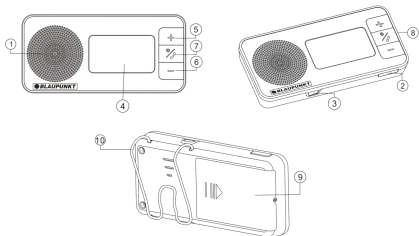

1. Speaker
2. Mode Button
3. Charging Socket (Mini-USB)
4. LCD display
5. Volume Up(V+)
6. Volume Down (V-)
7. MFB (Multi-Function Button)
8. Microphone
9. Battery Door
10. Sun Visor Clip

4. How to replace the battery

Follow the below diagram to replace the battery.

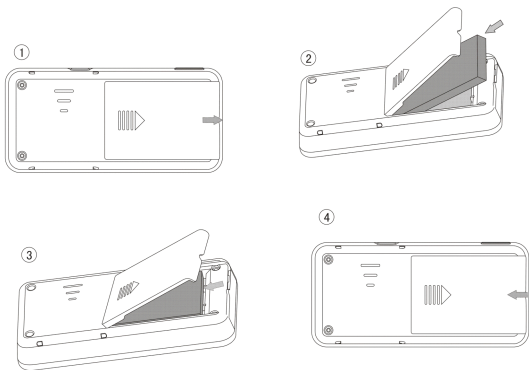

5. Installation on the Sun Visor

Follow the below diagram to Install the speakerphone on the sun visor, The clip is available for 2 direction installation.

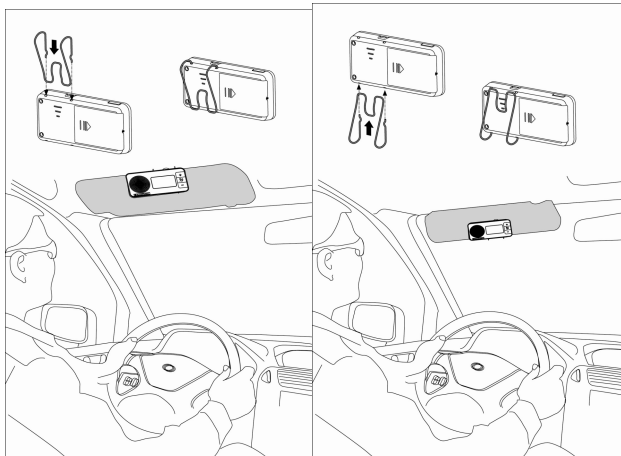

6. Charging the battery

This device has a rechargeable battery.

1. For first time use, please fully charge the speakerphone.
2. Plug the car charger into the car lighter socket and put the MINI USB plug into the socket of the speakerphone.

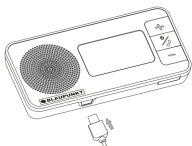

3. While the charger is connected, the device will display "**Charging**" on the screen during charging. Charging the battery fully may take up to 3 hour.

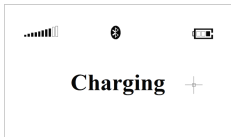

4. When the battery is fully charged, the device will display "**Battery Full**". Please disconnect the car charger from the speakerphone and the car lighter socket.

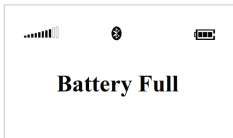

The fully charged battery can keep the power up to 10 hours of talk-time. When the speakerphone is powered on and battery power is low, it will display "**Battery low**" with voice prompt every 30 seconds. It is need to charge now.

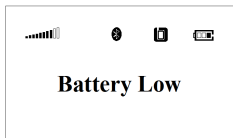

The speakerphone will turn off automatically while the battery is reached to 3.0V.

7. Battery information

Your device is powered by a chargeable battery. The full performance of a new battery is achieved only after two or three complete charge and discharge cycles. The battery can be charged and discharged hundreds of times, but it will eventually wear out.

Unplug the charger from the electrical plug and the device when not in use. Do not leave a fully charged battery connected to a charger, since overcharging may shorten its lifetime. If left unused, a fully charged battery will lose its charge over time.

Important:

It is recommended that you fully charge the speakerphone before leaving it unused for a long time. To prevent overdischarge and endanger the battery, you are recommended to fully charge the speakerphone **each 2 months**.

8. Pair to your mobile phone

Before you use the **BT DF 311** first time, you must pair the unit with a Bluetooth-enabled mobile phone. This operation guide is based on a Bluetooth-enabled phone as the host device.

Please refer to the following steps to pair **BT DF 311** speakerphone.

- a) Put the **BT DF 311** close to a Bluetooth-enabled mobile phone less than 1 meter distance.
- b) Ensure the **BT DF 311** is turned OFF.
- c) Press and hold the MFB for 5 seconds, the device displays "Pairing" with a voice prompt, it is now ready for pairing.



- d) Activate your mobile phone's Bluetooth function by referring to your mobile phone's instruction guide for details, start to search the Bluetooth devices.
- e) Select "**BT DF 311**" from the new device list.
- f) If necessary, enter the PIN code "0000" and confirm to complete pairing. When pairing is completed the **BT DF 311** will connect to your phone automatically, and the

Device displays "**Paired**" with voice prompt and then enter standby status.

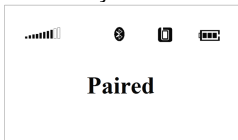

Note:

- If you did not finish pairing operation within 2 minutes, the **BT DF 311** will exit pairing mode and displays "**Pairing fail**", and then return to standby status. Please repeat the operation follows step (c) to (f) to pair the **BT DF 311** and mobile phone again.

9. Turning On/Off the BT DF 311
[Turning on]

When the **BT DF 311** is on power off status, press and hold the MFB for 3 seconds until you hear the voice "power on", the screen displays "**Welcome**", The **BT DF 311** is now turned on, and then enter stand-by status.

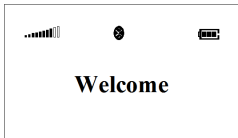

Note: If the **BT DF 311** has been paired successfully, it will connect to the device that you last connected automatically and displays your host device's name with a voice prompt "*Phone is ready for use*", and then return to stand-by status.

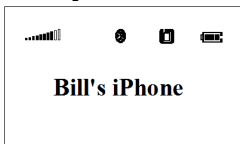

[Stand-by status]

The device will return to stand-by status from any status if there is no any button action within 20 seconds. In the stand-by status, the screen will display "**BT DF 311**" in the screen without backlight. The backlight will turn on when any button is pressed or a call is incoming.

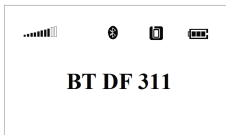

[Connect to a Bluetooth-enabled mobile phone]

If the **BT DF 311** has been complete the pairing operation successfully, when the speakerphone turns on, it will connect to the phone you last connected automatically. Please ensure your phone's Bluetooth function is activated.

[Turning off]

At any state after the **BT DF 311** is turned on, press and hold the MFB for 5 seconds, the screen displays "***Power Off***" with voice, and then turns off.

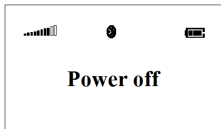

10. Phonebook synchronization

[Single Item copy]

- a) In the standby status, press MODE button shortly, the speakerphone will enter discovery mode and display "**Waiting**" with voice prompt.

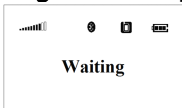

- b) Search the contacts item in your mobile phonebook, synchronize via bluetooth connection, select device name "BT DF 311" to transfer the single item. When synchronize completed, it will display "**Completed**" with voice prompt.

[One Key synchronization]

In the standby status, press and hold MODE button for 4s, the speakerphone will disconnect from your mobile, the old phonebook in the speakerphone will be deleted. Few seconds later, the speakerphone display "**Download start**" with voice prompt, and then synchronization will start. When synchronization completed, it will display "**Completed**" with a voice prompt.



11. Language Switch

The **BT DF 311** speakerphone supports 5 languages(English, German, Spanish, French, Italian) artificial-voice for prompting and caller ID function.

In the stand-by status without connection, Long press Mode button for 3s to switch the Language in a circular manner.

12. Using the BT DF 311

After the pairing is completed and battery is fully charged, please follow the bellow instruction to use the **BT DF 311**.

[Making a call]

a) Use Voice-Dialing

In the stand-by status, press the MFB shortly, you will hear 2 short tones with displaying "Voice Dial", you need to speak the voice tag which you have already recorded to your phonebook. If the voice tag is identified by the phone, the related number will be dialed. Please insure that your mobile phone supports

this voice dialing function, and voice tags have been set up on your mobile phone. Refer to your mobile phone's user guide or contact your service provider for help. Press MFB once again will cancel Voice-dial.

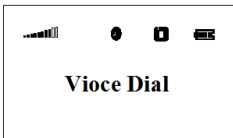

b) Last number re-dialing

In the stand-by status, double press MFB to redial the last number you dialed.

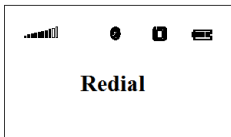

c) View the Contacts list and dial-out

If there is contact information has been synchronized to the speakerphone, in the standby status, press and hold "V-"

button for 3s the speakerphone will display the contact information on the screen, you can press "V+" button or "V-" button to leaf the list. If no information inside, the speakerphone will display "Not Found". Press MFB shortly will dial-out the number which is showing on the screen.



Press and hold "V-" button 3s again to quit the viewing mode.

d) View the calling list and dial-out

In the standby status, press and hold "V+" button for 3s the speakerphone will display the incoming call information on the screen with recent 10 records limit, you can press "V+" or "V-" button to leaf the list. If no information inside, the speakerphone will display "Not Found".

Press MFB shortly will dial-out the number which is showing on the screen.

Press and hold "V+" button 3s again to quit the viewing mode.

[Answering a call]

When you receive an incoming call, the device will read out the caller's name and display it on the screen if this contact information has been synchronized to the speakerphone, otherwise, the caller's number will be read out and display. Press the MFB shortly to answer your incoming call. You can also answer an incoming call directly on your phone.

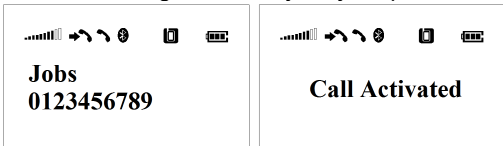

[Ending a call]

While a call is in progress, press the MFB shortly end the call. You can also end a call on your mobile phone keypad.

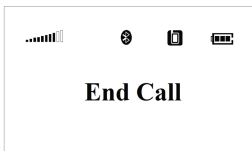

[Reject an incoming call]

When you receive an incoming call, press and hold MFB for 2 seconds, you will hear a middle tone, and then the incoming call will be rejected.

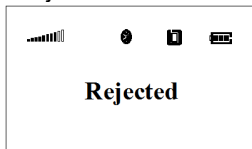

[Transfer a call]

While a call is in progress on your mobile phone, press and hold MFB for 2 seconds, you will hear a middle tone, and the call will be transferred from speakerphone to mobile phone. Repeat the operation can transfer the call between your speakerphone and your mobile phone.



[Volume control]

While a call is in progress, you can adjust the volume by pressing the "V+" or "V-" button. You can also adjust the volume on your mobile phone.

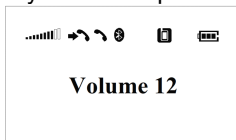

[Mute]

While a call is in progress, press the MODE button, you will hear 2 tones. The speakerphone's MIC is now muted. You will hear remindful tone every 5 seconds to notify you that your MIC is still on muted. Repeat the operation to turn off muting.



[Privacy mode]

While a call is in progress, press the MODE button for 2s, you will hear 2 low tones, the speakerphone will switch to privacy mode, that means the volume will decrease to a low level, then you can take it up and talking close to your ear like a mobile phone. Repeat the operation to switch off privacy mode.

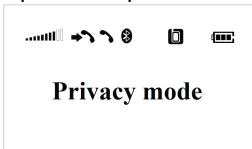

13. Reset the user's information

You may want to reset the phonebook and erase the previous pairing list of **BT DF 311**, please follow these simple steps.

- (a) Ensure the **BT DF 311** is under standby status without connection.
- (b) Press and hold the “V+”& “V-” buttons for 5 seconds, the speakerphone will start erase the user's information. When the screen displays “*Erased*”, the pairing list has been erased.

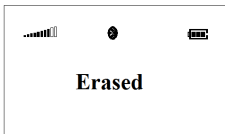
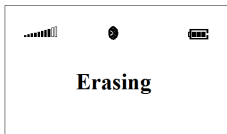

- (c) After reset the pairing list, the speakerphone will power off automatically.

[Music streaming]

BT DF 311 supports A2DP profile. If connect to a A2DP-enabled mobile phone, the music can be stream to the speakerphone.

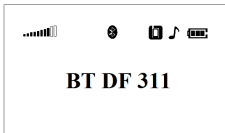

If there is an incoming call received while the music streaming, the music will be paused automatically, and resume the playing while the call is end.

14. Safety and general information

1. Please read this guidebook carefully and follow the instructions.
2. To avoid any damage or malfunction of the device do not drop device from high places.
3. Keep device away form humidity, water and any other liquid. If the device is exposed to water, moisture and other liquid , do not operate it to avoid any electrical shock, explosion and damage to the device or yourself.
4. Do not place or keep this device near any heat sources, such as, direct sun light,radiators, stoves or other

apparatus which produce heat. It may cause explosion, degrade the performance and/or reduce battery life.

5. Do not modify, repair or disassemble device at discretion(Especially battery:It may cause an explosion). Doing this will avoid the warranty.
6. Do not place the heavy objects on the device.
7. Use only supplied and approved charger.
8. Replacement or service must be done by qualified service center or manufacturer.
9. Unplug this device when unused for long periods of time or during lightening storms.

15. Trouble shooting

If you are unable to connect your speakerphone and mobile phone, please try the following:

- (a) Ensure the speakerphone is paired with your mobile phone.
- (b) Ensure your mobile phone's Bluetooth function is activated. Please refer to your mobile phone user guide for specific instruction.

- (c) Ensure the speakerphone is within a maximum of 10 meters of your mobile phone(s) and there are no obstructions, such as wall or other electronic devices in between as it may cause shorter or interference transmission.
- (d) If all the above steps do not resolve your problem, please remove the battery for a while.
- (e) The Bluetooth speakerphone is compliant with and adopts the Bluetooth Specification v2.1. However, interoperability between the device and other Bluetooth-enable products is not guaranteed because it depends on compatibility. For more information on the compatibility between the devices with other Bluetooth-enabled products, please check with the manufacturer/importer.

16. Product specifications

Bluetooth Specifications	Version 2.1, Class 2
Bluetooth Profile Supported	Headset & Hands-Free Profiles

Operating Frequency Band	2.402 to 2.480GHz unlicensed ISM band
Dimension	115(L)x45(W)x15(H) mm
Weight	80g
Normal Charge Time	3 hrs.(approx.)
Talk Time	10 hrs.
Standby Time	400 hrs
Rechargeable Li-ion Battery	3.7V DC, 650mAH, (NKI #BL-5B compatible)
AC/DC Charger	DC 5 to 6 V, 300 mA

17. Warranty

The condition of this warranty and our responsibilities under this warranty are as follows:Warranty is non-transferable, and is limited to the original purchaser only.

- a) You must be able to prove the date of original purchase of the unit with a dated receipt.

- b) The warranty is not applicable if the product has been subject to physical abuse, improper installation, modification or repair by unauthorized third party.
- c) The responsibility of supplier,s products shall be limited to the repair or replacement of the roduct at it,s sole discretion.
- d) Specifically exempt from any warranty are limited-life consumable components subject to normal wear and tear, such as, batteries and other accessories.
- e) Supplier will not take any responsibility if the failure of the unit has resulted from accident, abuse, misuse, or any unauthorized repair, modification or disassemble.
- f) Modification and repair of the unit this device must be done by an authorized and qualified service center or returned to the manufacturer.
- g) This warranty gives you specific legal rights, and you may also have other rights which vary under local laws.

FCC WARNING

This device complies with Part 15 of the FCC Rules. Operation is subject to the following two conditions:

- (1) this device may not cause harmful interference, and
- (2) this device must accept any interference received, including interference that may cause undesired operation.

NOTE 1: The manufacturer is not responsible for any changes or modifications not expressly approved by the manufacturer for compliance, such modifications could void the user's authority to operate the equipment.