

80g书写纸, 285×210mm

WATERPROOF SPORTS EARPHONES



Quick Start Guide
Item # MZX499N



1. Make sure the following items are included in your package.

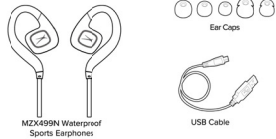

2. For a look at the various buttons and parts of your earphones, view the graphic below.

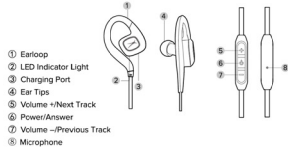

3. **Charging:** When charging, a red LED light will illuminate. When the battery is fully charged, the light will turn blue when your unit is fully charged. Your earphones can take up to three hours to fully charge.

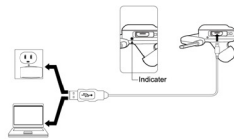

4. **Powering ON/Powering OFF Your Earphones:**

-Press and hold the Power button for approximately 3-5 seconds to power on your earphones. Your earphones will automatically connect with the last phone they were paired with if they have previously been paired.
Once powered on, you can press and hold the Power button again for approximately five seconds to power off your earphones.

NOTE: In order to save power, your earphones will automatically power off if left unpaired and idle for ten minutes.

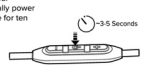

5. **Pairing Your Earphones With a Bluetooth Phone**

-To power on your earphones, press and hold the Power button for approximately 3-5 seconds. Once powered on, you will hear your earphones audibly say "Powering on, welcome to ALTEC LANSING".

-Immediately after powering on your earphones, the LED Indicator Light will alternately flash red and blue to indicate that your earphones are ready to be paired.

-Go to the Bluetooth Manager on your phone. Search Bluetooth devices and select "Altec Sport 4" to start connecting. Once paired, the LED Indicator Light will slowly flash blue every few seconds.

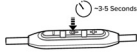

6. **Wearing Your Earphones**

For the best sound performance and a secure, comfortable fit, be sure that the ear buds rest gently in your ear and drape around the back of your neck. Use the ear caps that work best for you.

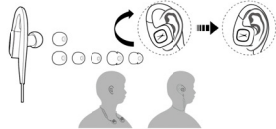

7. **Listening to Music**

Play/Pause Press the Power button to get music from your audio source to play or pause.

Next/Previous Song Press and hold the Volume Up or Volume Down buttons to advance to the next song or go back to the previous one.

Increase/Decrease Volume Repeatedly tap the Volume Up or Volume Down buttons to increase or decrease the volume.

NOTE: Music will automatically pause when a call is dialed out or when there is an incoming call. It will resume when the call ends.

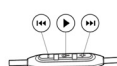

8. **Using Your Earphones During Phone Calls**

Launch Voice Assistant Quick press Power button 2 times to activate your device's voice assistant (if available) for the voice interaction.

Answering an Incoming Call To answer an incoming call, quickly press the Answer button.

Ending a Call To end a call, quickly press the Answer button.

Reject an Incoming Call Press and hold the ANSWER button for 2 seconds to reject an incoming call.

Adjusting Volume By pressing the Volume Up or Volume Down buttons you can increase or decrease the volume of the phone call.

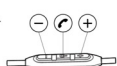

80g书写纸, 285×210mm

WATERPROOF SPORTS EARPHONES



Quick Start Guide
Item # MZX499N



Care & Maintenance

- Before using your earphones, inspect them carefully to make sure that they are clear of dust and debris before charging.
- Use a soft cloth to clean your earphones. Never use any harsh chemicals or detergents. Make sure your earphones are dry before charging.
- When your earphones are not in use, they should be stored in a cool, dry place.
- Never tap or yank on the cables. Doing so can damage your earphones.
- Never expose your earphones to high temperatures, or extreme cold.
- Give your ears a break. Do not listen to your earphones at high volumes for extended periods of time.
- If exposed to salt water, rinse your earphones with tap water to maintain proper long term performance.
- Please recycle or dispose of your earphones properly based on the laws and rules of your municipality. Contact local recycling facilities and/or the manufacturer of your earphones for further information.

Altec Lansing One Year Warranty Card

This warranty covers the original consumer purchaser only and is not transferable.

This warranty covers products that fail to function properly UNDER NORMAL USAGE, due to defects in material or workmanship. Your product will be repaired or replaced at no charge for parts or labor for a period of one year.

What is Not Covered by Warranty

Damages or malfunctions not resulting from defects in material or workmanship and damages or malfunctions from other than normal use, including but limited to, repair by unauthorized parties, tampering, modification or accident.

To Obtain Warranty Service and Troubleshooting information:

Call 1-855-292-4087 or Visit our website at www.alteclansing.com

To receive Warranty service along with the name and address of an authorized product service center, the original consumer purchaser must contact us for problem determination and service procedures. Proof of purchase in the form of a bill of sale or receipted invoice, evidencing that the Product is within the applicable Warranty period(s), MUST be presented in order to obtain requested service. It is your responsibility to properly package and send any defective products along with a dated copy of proof of purchase, a written explanation of the problem, and a valid return address to the authorized service center at your expense. Do not include any other items or accessories with the defective product. Any products received by the authorized service center that are not covered by warranty will be returned unrepaid.

NO WARRANTIES, WHETHER EXPRESS OR IMPLIED, INCLUDING, BUT NOT LIMITED TO, ANY IMPLIED WARRANTIES OF MERCHANTABILITY OR FITNESS FOR A PARTICULAR PURPOSE, OTHER THAN THOSE EXPRESSLY DESCRIBED ABOVE, SHALL APPLY. DISTRIBUTOR FURTHER DISCLAIMS ALL WARRANTIES AFTER THE EXPRESS WARRANTY PERIOD STATED ABOVE. NO OTHER EXPRESS WARRANTY OR GUARANTEE GIVEN BY ANY PERSON, FIRM OR ENTITY WITH RESPECT TO THE PRODUCT SHALL BE BINDING ON DISTRIBUTOR. REPAIR, REPLACEMENT, OR REFUND OF THE ORIGINAL PURCHASE PRICE - AT DISTRIBUTOR'S SOLE DISCRETION - ARE THE EXCLUSIVE REMEDIES OF THE CONSUMER. IN NO EVENT WILL DISTRIBUTOR, ITS MANUFACTURERS, OR SAKAR INT. BE LIABLE FOR ANY INCIDENTAL, DIRECT, INDIRECT, SPECIAL, PUNITIVE OR CONSEQUENTIAL DAMAGES (SUCH AS, BUT NOT LIMITED TO, DAMAGES FOR LOSS OF PROFITS, BUSINESS, SAVINGS, DATA OR RECORDS) CAUSED BY THE USE, MISUSE OR INABILITY TO USE THE PRODUCT. EXCEPT AS STATED HEREIN, NO OTHER WARRANTIES SHALL APPLY. NOTWITHSTANDING THE FOREGOING, CONSUMER'S RECOVERY AGAINST DISTRIBUTOR SHALL NOT EXCEED THE PURCHASE PRICE OF THE PRODUCT SOLD BY DISTRIBUTOR. THIS WARRANTY SHALL NOT EXTEND TO ANYONE OTHER THAN THE ORIGINAL CONSUMER WHO PURCHASED THE PRODUCT AND IS NOT TRANSFERABLE.

Some countries, states or provinces do not allow the exclusion or limitation of incidental or consequential damages or allow limitations on warranties, so limitation or exclusions may not apply to you. This warranty gives you specific legal rights, and you may have other rights that vary from state to state or province to province. Contact your authorized retailer to determine if another warranty applies. This product is manufactured, distributed and sold by SAKAR International, Inc. All other trademarks are the property of the respective owner, who has not sponsored, endorsed or approved this product.

Important Safety Precautions & Battery Information

- Do not allow children or the infirm to play with your earphones without adult supervision.
- Do not immerse your earphones in excessive heat, flames or fire.
- Always press all buttons carefully. Do not manipulate your earphones.
- Do not use in extremely dry environments, as this can lead to static discharge during usage.
- Do not expose your earphones to temperatures above 40°C. Keep out of direct sunlight.
- Do not attempt to repair this product yourself. Contact a qualified service center if your earphones are in need of service.
- Do not drop, puncture or expose your earphones to excessive trauma.
- Your earphones are not intended for commercial use.
- Do not place near objects that generate a strong magnetic field.
- Do not charge during lightning storms.
- The device is equipped with an integrated lithium-polymer battery. The battery cannot be replaced. Do not attempt to remove the battery from the device.
- The battery used in this device may present a risk of fire or chemical burn if mis-treated.

SPECIFICATIONS
Driver: 7mm
Frequency range: 20Hz-20kHz
IPX6
WATER PROOF
10 HOURS OF PLAYTIME
LIGHT & SLIM DESIGN

Technical Support
For technical support issues please visit our website at www.alteclansing.com. You can find manuals, software and FAQs at the website. Can't find what you are looking for? Call 1-855-292-4087 to access our technical support information on the phone.

This device complies with part 15 of the FCC rules. Operation is subject to the following two conditions: (1) this device may not cause harmful interference, and (2) this device must accept any interference received, including interference that may cause undesired operation.

Caution: Changes or modifications not expressly approved by the party responsible for compliance could void the user's authority to operate the equipment.
NOTE: This equipment has been tested and found to comply with the limits for a Class B digital device pursuant to Part 15 of the FCC Rules. These limits are designed to provide reasonable protection against harmful interference in a residential installation. This equipment generates, uses and can radiate radio frequency energy and, if not installed and used in accordance with instructions, may cause harmful interference to radio or television reception, which can be determined by turning the equipment off and on, the user is encouraged to try to correct the interference by one or more of the following measures:
- Reorient or relocate the receiving antenna.
- Increase the separation between the equipment and receiver.
- Connect the equipment into an outlet on a circuit different from that to which the receiver is connected.
- Consult the dealer or experienced radio/TV technician for help.



更正记录

2017.08.15	原始

订单编号	SO201707004	客户	Sakar	物料名称	快速指南	物料编码	77-007-01159
工厂型号	MZX499	客户品牌	Altec®	规格/材质	MZX499N_EN, 285(57×5)×210(70×3)mm, 80g书写纸, 单黑图文双面印刷		
版本	A	客户型号	MZX499N-BLK	描述	AB1522S		
单位	mm(1:1)	工程设计	陈敬勇	业务审核		批准	日期 2017-08-15