

## 2.1 Speaker System with Subwoofer



### USER'S GUIDE



Standard Version

### 2.1 Speaker System with Subwoofer

#### Main Unit

##### 1. Subwoofer

Display 3D screen effect on the front panel while playing music; and present heavy bass sound from the bottom speaker unit

**2. Left and right speakers**  
Display 3D screen effect on the front panel while playing music

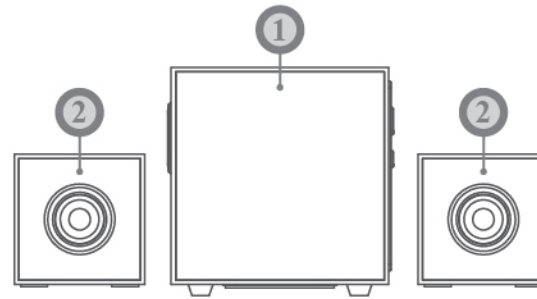

#### Rear and Side Views of Subwoofer

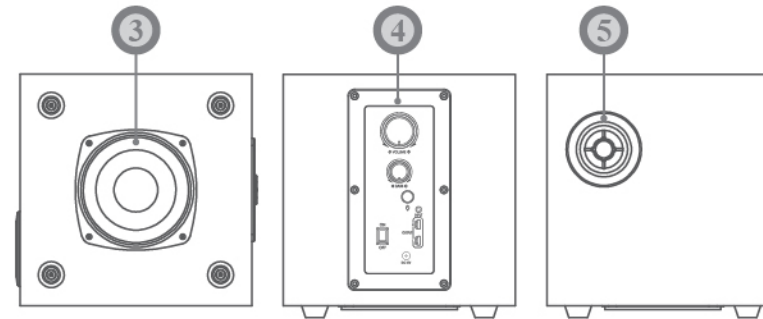

##### 3. Amplifier

On the bottom of the subwoofer

##### 5. Vent

On the left side of the subwoofer.

##### 4. Side control pod

On the right side of the subwoofer. Controls main power, volume, bass, LED lights on/off, and connects with DC power cord and audio input/output.

#### Features

- 2.1 channel stereo sound
- Built-in amplifier
- Bass controls
- 3 surround speakers; left, right, and subwoofer
- 3D screen effect on subwoofer and the satellite speakers
- Analog volume control
- 3.5mm stereo audio inputs
- LED lights ON/OFF switch

### Package Contents



STANDARD VERSION



3.5mm audio cable



Power Adapter



User guide

### Safety Instructions



Caution: Electric Shock Hazard

When using this electronic appliance, basic precautions should always be followed to reduce the risk of fire, electrical shock and injury to persons, including the following:

1. Do not use this product near water i.e. bath tub or swimming pool.
2. Unplug from AC outlet when not in use and before cleaning.
3. Close supervision is necessary when used near children.
4. Clean only with dry cloth.
5. Do not attempt to repair the product on your own. It contains no user serviceable parts.

### Regulatory Compliance

#### CE Compliance for Europe

This equipment has been tested and found to comply with the limits for European Council Directive on the approximation of the law of the member states relating to electromagnetic compatibility (89/336/EEC) according to EN55022 Class B.

### Control panel

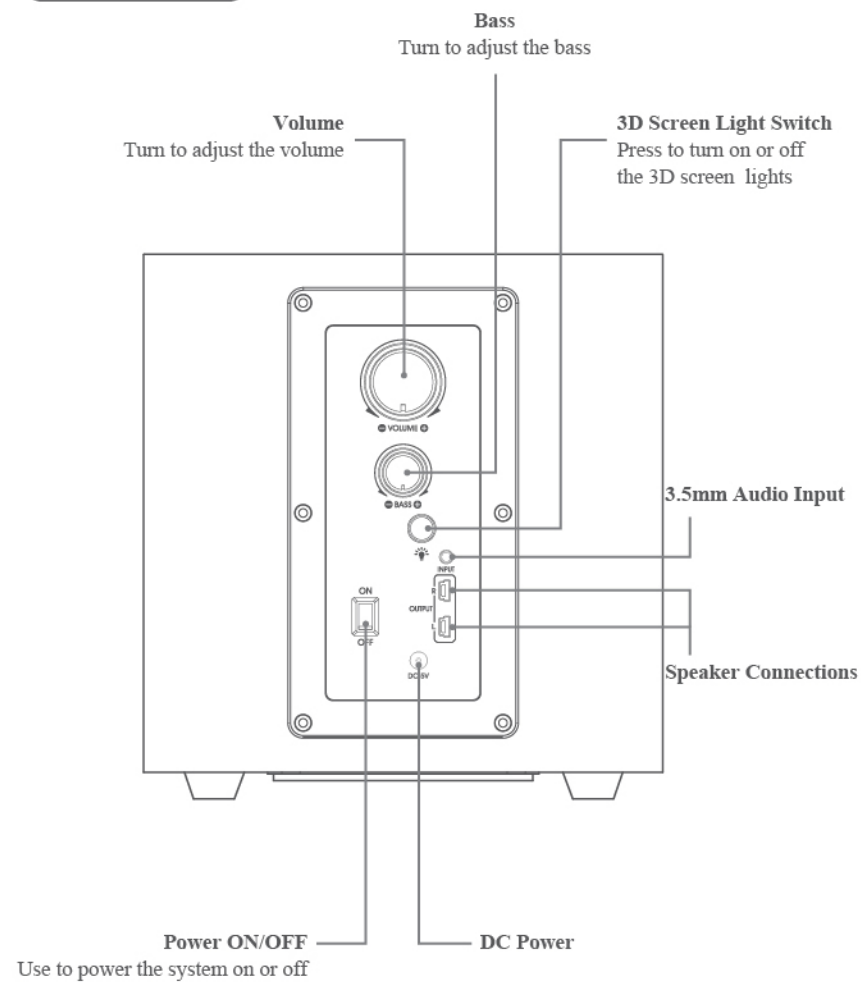

### Product Setup

#### Connecting the Speakers

Connect the included speakers to the corresponding speaker connections on the back of the speaker system.

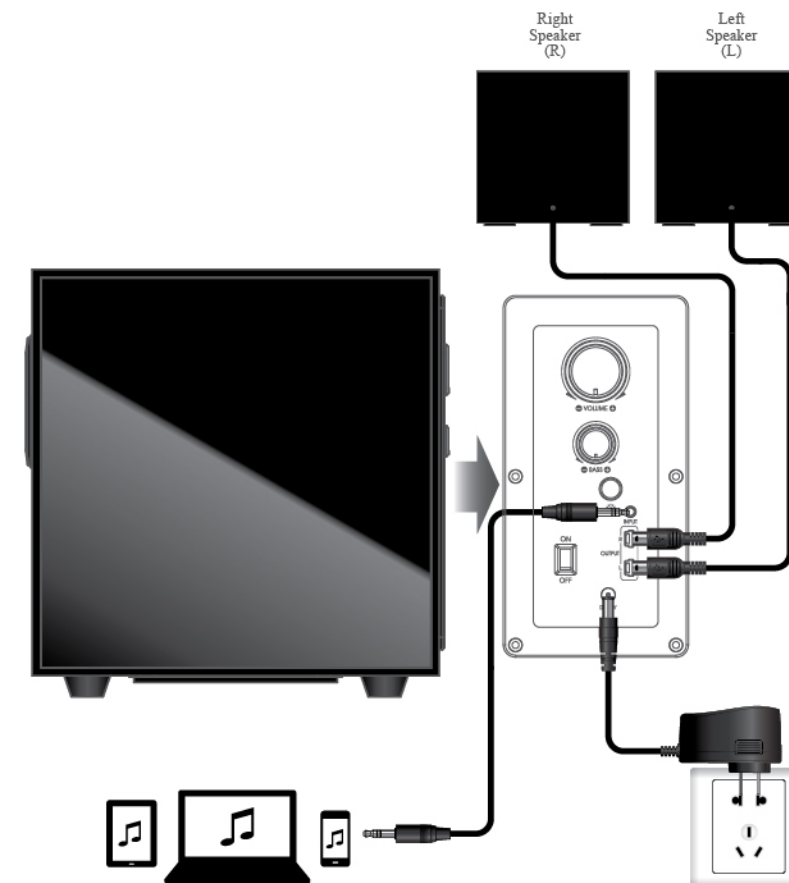

#### AUX Mode

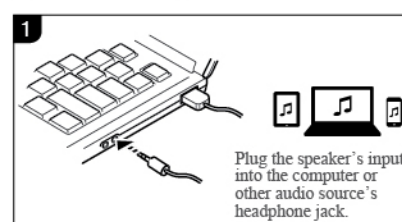

#### Bluetooth Mode

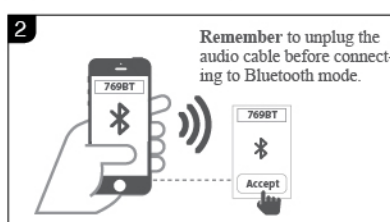

### Optimum Settings

1. For best tonal fidelity, we recommend setting your audio source to line level output and use the speaker to control overall volume level.
2. This speaker system is most efficient when the volume level is set between 50% to 90%. You get highest sound quality and minimum distortion within these volume levels.
3. Place the satellite speakers at least 10 inches from each other. This enhances stereo sound effect and perceived sound field.
4. Provide ample space around the subwoofer unit. It needs enough room to move massive amount of air!
5. To further enhance lower frequencies, sound quality, and light effect on the screen, do not place the subwoofer unit near walls.

### Troubleshooting

If no sound, ensure that:	<ul style="list-style-type: none"> <li>- Audio input, speaker cables, and DC power cord are securely attached.</li> <li>- The sound volume of audio source is turned up and not muted. Also ensure that the control pod volume is not turned to the minimum setting.</li> <li>- It may be necessary to close and restart the music player software.</li> <li>- Also check that the AC wall outlet or power strip has power.</li> </ul>
If one or more speakers have little or no sound, ensure that:	<ul style="list-style-type: none"> <li>- All cables are connected properly.</li> <li>- Main and subwoofer level controls are properly adjusted on control pod.</li> <li>- Audio settings are adjusted for proper use.</li> <li>- Audio source's sound (control panel) volume is turned up.</li> </ul>
If the satellites or subwoofer exhibit distortion or buzzing:	<ul style="list-style-type: none"> <li>- Turn down audio source's volume (via control panel), and reduce control pod volume.</li> <li>- Turn down subwoofer's volume, as program signal may be too strong.</li> <li>- Plug the subwoofer's power cord into a surge protector.</li> </ul>
If there is noise or hissing and the volume is low even when the main volume is up:	<ul style="list-style-type: none"> <li>- Turn up audio source's sound volume (via control panel).</li> <li>- Turn down main volume on control pod to compensate.</li> <li>- Ensure that software/hardware is properly installed and operating.</li> </ul>

NOTE: This equipment has been tested and found to comply with the limits for a Class B digital device, pursuant to part 15 of the FCC Rules. These limits are designed to provide reasonable protection against harmful interference in a residential installation. This equipment generates uses and can radiate radio frequency energy and, if not installed and used in accordance with the instructions, may cause harmful interference to radio communications. However, there is no guarantee that interference will not occur in a particular installation. If this equipment does cause harmful interference to radio or television reception, which can be determined by turning the equipment off and on, the user is encouraged to try to correct the interference by one or more of the following measures:

- Reorient or relocate the receiving antenna.
- Increase the separation between the equipment and receiver.
- Connect the equipment into an outlet on a circuit different from that to which the receiver is connected.
- Consult the dealer or an experienced radio/TV technician for help

Changes or modifications not expressly approved by the party responsible for compliance could void the user's authority to operate the equipment. This device complies with Part 15 of the FCC Rules. Operation is subject to the following two conditions:

- (1) this device may not cause harmful interference, and
- (2) this device must accept any interference received, including interference that may cause undesired operation.