

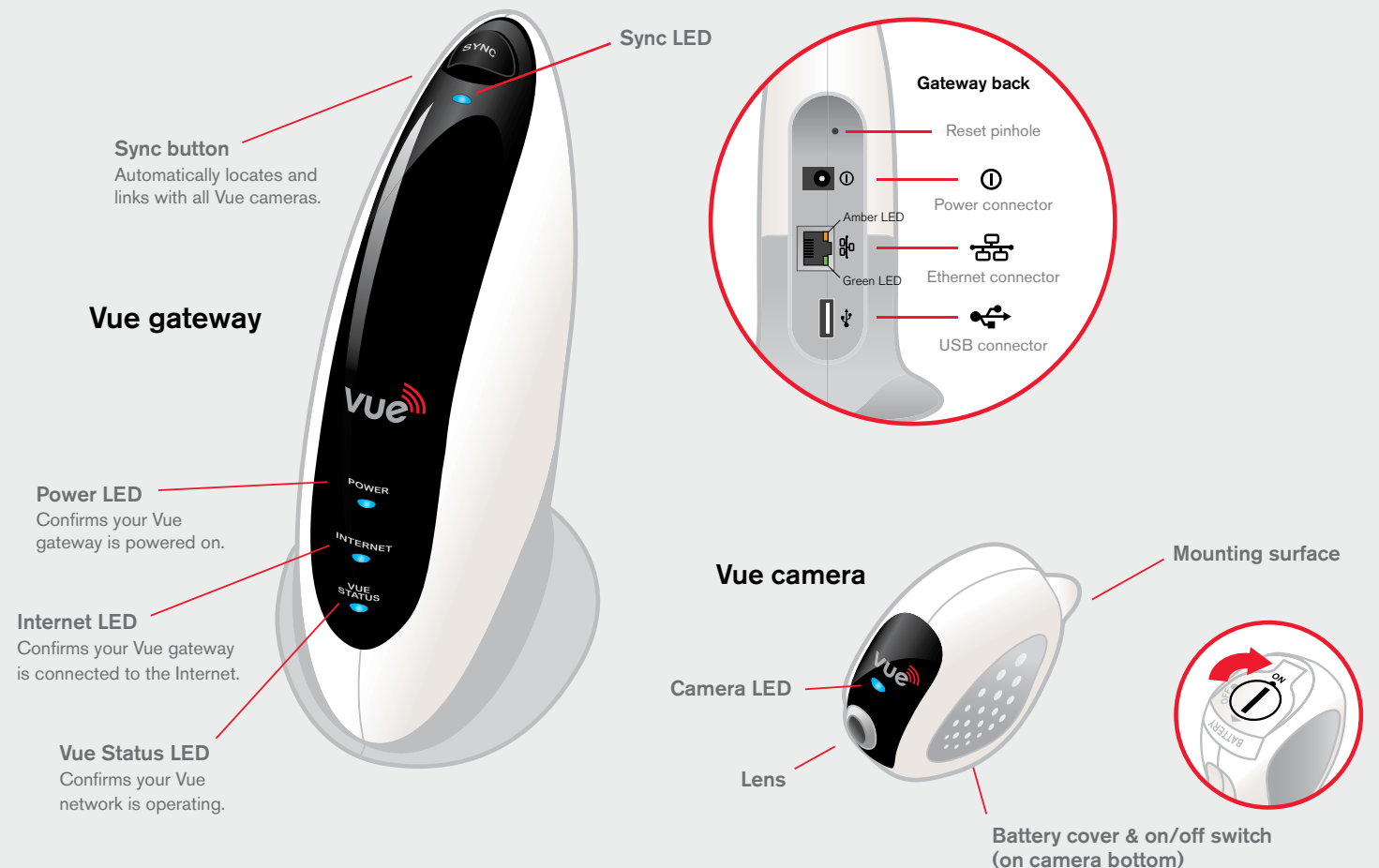

Introducing Vue™.
A small, revolutionary
wire-free video system
that makes it easy to
view your family and
your home from
virtually anywhere –
at anytime.

See what you're missing™

Vue Features



Visit
www.VueZone.com
 to learn more.

Support
www.VueZone.com/support

Avaak, Inc.
 9645 Scranton Road, Suite 110
 San Diego, CA 92121
 Phone: 858.453.9866 / Fax: 858.453.9868
www.avaak.com

© 2009. All rights reserved. Vue, the Vue logo, FrameMesh and See what you're missing are trademarks of Avaak, Inc. Designed in California. Product made in China.

AV16-00081

Quick Install Guide

Welcome!

Thank you for choosing Vue, the fun new way to remotely view your home and your life. Vue is amazingly simple to install and use. Vue gives you the power to easily watch, record and share video or snapshots with friends and family when and where you want.

What's in the box

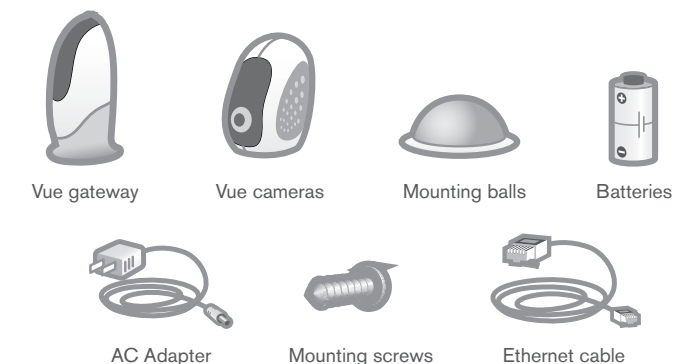

1

Connect the gateway to your network

1. Connect the Ethernet cable to the gateway Ethernet port and any available LAN port on your router.*
2. Connect the power adapter to the gateway and power outlet. The blue Power LED will be on.
3. The blue Internet LED will flash continuously if you have a valid connection. The initial flash may take up to a minute.

* If you are installing a network for the first time, please follow the network installation instructions for your router first.

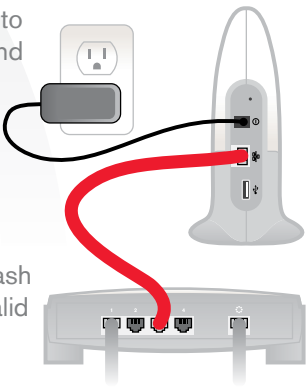

2

Installing camera battery

1. Press down and slide battery cover open.
2. Insert battery as shown.
3. Close battery cover and rotate the power switch to the ON position.
4. LED on camera front will turn on briefly to confirm power ON.

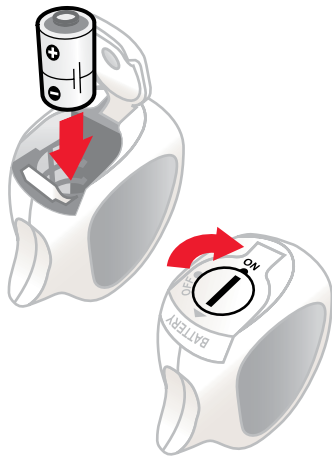

3

Syncing cameras to gateway

Before syncing, confirm that the Internet LED on the gateway front is blinking. (If not, see Troubleshooting)

1. Place camera(s) within 12 inches of the gateway.
2. Press and release the Sync button on the top of the gateway. Blue Sync LED will turn on for 45 seconds.
3. Watch the camera front – Camera LED will blink for 5 seconds to confirm sync.
4. Once synced, cameras can be positioned.



4

Registering your Vue

1. Locate your VGN number on the bottom of the box or gateway.
2. Go to my.VueZone.com and click the **REGISTER NOW** button.
3. Follow the on-screen instructions to register your system.

Your VGN number is located on the bottom of the box and gateway



5

Installing cameras

1. Peel off the adhesive protective layer on the back of the mounting ball. Select a location where you want to install the camera and stick the mounting ball to surface you selected. Alternatively, install the included mounting screw in the desired position, and hang the mounting ball from the screw head.
2. Place the camera on the mounting ball and point the lens in the desired direction.
3. Adjust your camera positioning by viewing the image through your my.VueZone.com account.

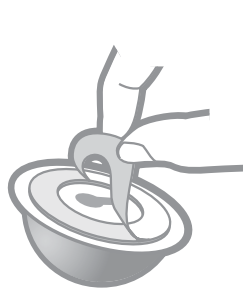

Peel the adhesive strip from the back of the mounting ball.
(Optional mounting screw available)



Position and stick the mounting ball to a flat surface.

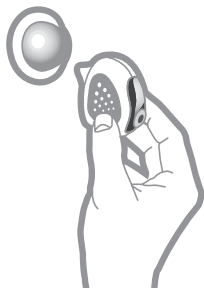

Place the camera on the mounting ball.

6

Start viewing!

1. To confirm that your cameras have linked to the gateway, your active cameras (not grayed out) should appear in the **my cameras** area on your Watch Page at my.VueZone.com.
2. Next, drag a camera icon from the **my cameras** area into the **My Vue** area on the right.
3. Click ► on the camera control bar to start viewing.

Camera Control Bar

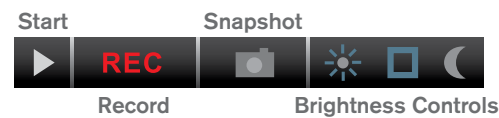

Troubleshooting

Vue gateway

The gateway won't turn on.

Check that the AC power adapter is plugged into both the power outlet and is plugged securely into the back of gateway.

The gateway Internet LED won't come on.

Make sure your gateway ethernet cable is plugged into the LAN port of your router and confirm that the green and amber LEDs on the ethernet port on the back of the gateway are on.

The Sync LED does not come on when the Sync button is pushed.

Make sure that the blue Internet LED on the front is blinking and that you are not streaming video from any camera at the time.



Vue cameras

The camera won't turn on.

Make sure the switch on the camera door is rotated to the ON position. Make sure the battery is properly installed or try a new battery.

No camera icon appears in the my camera area, or the camera will not sync to the gateway.

Check that the camera is powered ON (the Camera LED light will turn on briefly after rotating the switch to the ON position) and within the required 12-inch range of the gateway. Press the sync button again and watch each Camera LED which will blink for 5 seconds to confirm sync.

The camera icon in my.VueZone.com my camera area is grayed out.

Your camera may be too far away from the gateway to receive signal transmission, or your camera battery may be too weak.



This device complies with Part 15 of the FCC Rules. Operation is subject to the following two conditions: (1) This device may not cause harmful interference, and (2) This device must accept any interference received, including interference that may cause undesired operation.

This equipment has been tested and found to comply with the limits for Class B Digital Device, pursuant to Part 15 of the FCC Rules. These limits are designed to provide reasonable protection against harmful interference in a residential installation. This equipment generates and can radiate radio frequency energy and, if not installed and used in accordance with the instructions, may cause harmful interference to radio communications. However, there is no guarantee that interference will not occur in a particular installation. If this equipment does cause harmful interference to radio or television reception, which can be determined by turning the equipment off and on, the user is encouraged to try to correct the interference by one or more of the following measures.

- Reorient or relocate the receiving antenna
- Increase the separation between the equipment and receiver
- Connect the equipment into an outlet on a circuit different from that to which the receiver is connected
- Consult the dealer or an experienced radio/TV technician for help

Caution: Exposure to radio frequency radiation
To comply with FCC RF exposure compliance requirements, a separation distance of at least 20 cm must be maintained between the antenna of this device and all persons. This device must not be co-located or operating in conjunction with any other antenna or transmitter.

Any changes or modifications not expressly approved by the party responsible for compliance could void the user's authority to operate the equipment.

Expand your Vue.

With a Vue personal video network, it's easy to expand your view so you can see more – anywhere, anytime.

Add multiple cameras to see more locations. Add a repeater to extend camera distance from the gateway.

To expand your Vue and see more, go to www.VueZone.com.

