

# Bluetooth stereo headsets

Model : BTR-1

FCC ID : FWHBTR-1

**ABOUT YOUR BTR-1 (blue tooth stereo headset):**

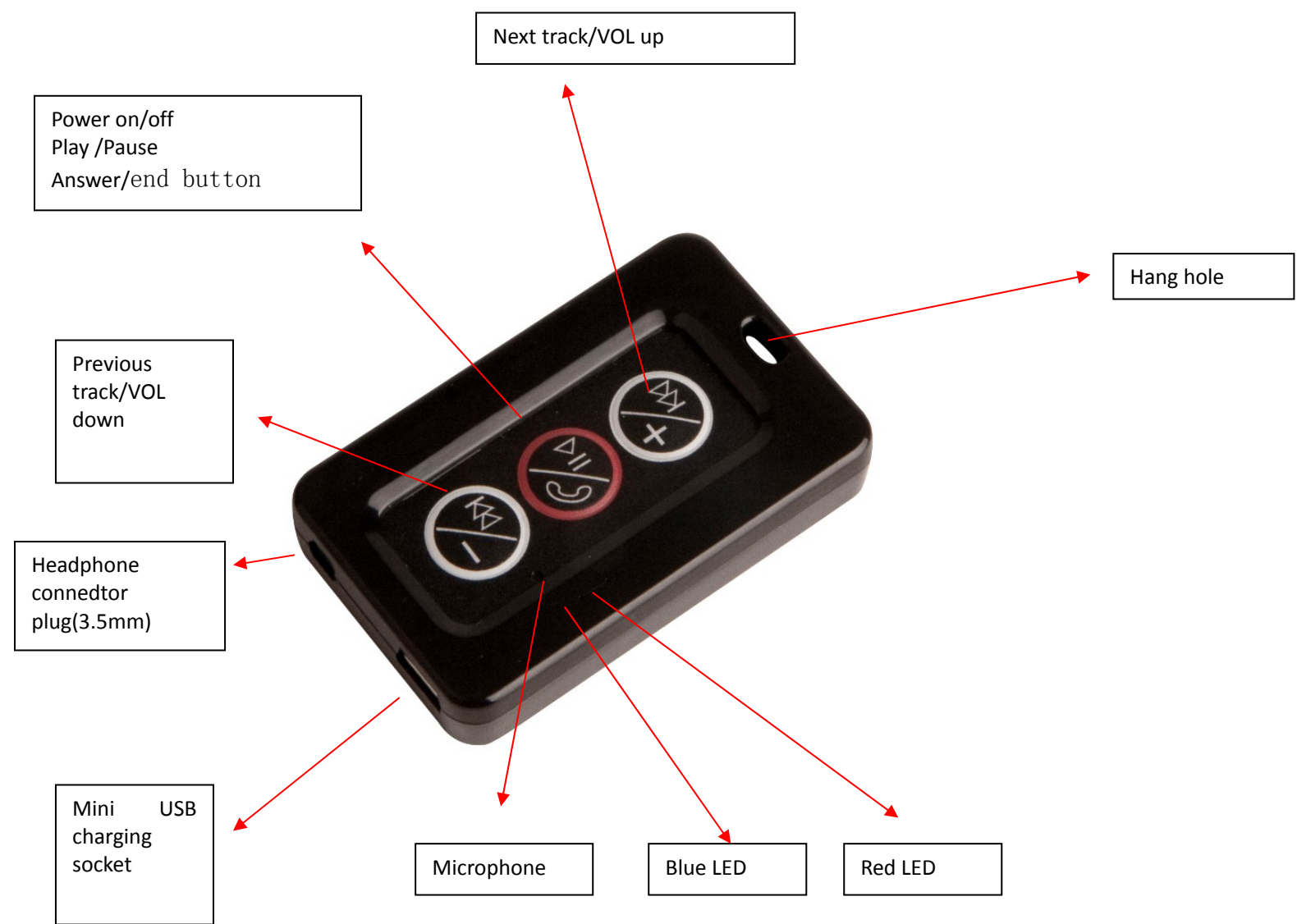

**The BTR-1 (blue tooth stereo headset) has the following function :**

- Answer calls
- End calls
- **Reject calls**
- Calls divert
- Automatic connention
- Play music
- Battery charging protection

**Specifications:**

- HTP
- V2.1 + EDR Class 2
- A2DP
- AVRCP
- ECHO CANCELATION

- Standby time: 300 hours
- Talk time: up to 15 hours
- Music time: up to 14 hours

You should follow three steps before using your headset:

1. Charge your headset
2. Activate Bluetooth on your mobile phone (refer to the manual for your Mobile phone)
3. Pair your headset to your mobile phone

The **BTR-1 (blue tooth stereo headset)** is easy to operate. The buttons performs different functions depending on how long you press them:

Instruction	Duration of press	
Tap	Press briefly	
Press	Approx: 1 second	
Press and hold	Approx: 4 seconds	

Your headset indicates the charging level while charging:

What you see	Status
Solid Red	Charging
Red LED Gets Off	Fully Charged

**Please note:** The lifetime of the battery will be significantly reduced if your device is left uncharged for a long period. We therefore recommend that you recharge your device at least once a month.

BATTERY LEVEL

- When the voltage is below 3.1v, red LED twinks 5 times after every 30 seconds, with warning sound; It’s time to charge the device
- The device gets off when voltage is below 2.9v, in order to protect the device

Turning your headset on and off



- Press and hold the button until you see a burst of flashes on the indicator light (BLUE LED) to turn the headset off.



- Press and hold the button until you see a burst of flashes on the indicator light (RED LED) to turn the headset off.

Pairing your headset with your phone

Headsets are connected to phones using a procedure called ‘ pairing’ . By following a few simple steps, a phone can easily be paired with a headset.

1. Put the headset in pairing mode



Press and hold button until see red and blue LED twinkls in interval. At this time, it gets into pair status

**2. Set your Bluetooth phone to ‘ discover’ the IQ BTR**

Follow your phone’s instruction guide. First make sure that Bluetooth is activated on your mobile phone. Then set your phone to discover the headset. This usually involves going to a ‘ setup,’ ‘ connect’ or ‘ Bluetooth’ menu on your phone and selecting the option to ‘ discover’ or ‘ add’ a Bluetooth device.\* (See example from a typical mobile phone in fig. 1).

**3. Your phone will find the IQ BTR**

Your phone will find the headset under the name **IQ BTR**. Your phone then asks if you want to pair with the headset. Accept by pressing ‘ Yes’ or ‘ OK’ on the phone and confirm with the passkey or PIN = 0000 (4 zeros). Your phone will confirm when pairing is complete.

Fig. 1

if the pairing fails, please turn off the device and repeat the above processes.

**use it whatever way you like**

**Play music** (Some phones may require you to start a media player first)



- Tap the button once

**Pause music**



- Tap the button , tap again to resume playing.

**Answer a call when playing music**



- Tap the and the music will be paused and the call will be connected.

- When you end the call, your music will start again

**Skip one track forward**

- Tap the **Skip Forward** button ; continue tapping to skip several tracks forward.

**Skip one track back**

Tap the **Skip Back** button ; continue tapping to skip several tracks backward.

**Answer a call**



Tap the on your headset to answer a call when phone is ringing.

**End a call**



- Tap the to end an active call.

### Reject a call



- Press and hold the  when the phone rings to reject an incoming call. Depending on your phone settings, the person who called you will either be forwarded to voice mail or hear the busy signal.

### Adjust sound and volume

Press the volume up or down (+ or -) to adjust the volume.

### Taking care of your headset

- Always store the with the power off and safely protected.
- Do not expose the **Product** to rain or other liquids.

### IMPORTANT REGULATORY INFORMATION

This device complies with Part 15 of the FCC Rules: Operation is subject to the following two conditions:

1. This device may not cause harmful interference and
2. This device must accept any interference that is received, including any interference that may cause undesired operation.

### WARNING:

Changes or modifications to this unit not expressly approved by the party responsible for compliance could void the user's authority to operate the equipment.