



ET Mini  
AcTek DLP Mini Projector



## ***User Manual***

Color and appearance may differ from the icons in this manual. Product specifications may change without notice due to improved performance.

V1.0

## Contents

Product Features .....	01
Safety Instructions .....	02
Packing Contents .....	03
Product Overview .....	04
Remote Control .....	06
Projector Control Panel .....	07
Charging .....	07
Turning Projector ON/OFF .....	08
Focus Adjustment .....	09
Adjusting Projector Angle .....	10
On-Screen Display Menu .....	11
Selecting An Input Source .....	13
Wi-Fi Connection .....	14
AirPlay Connection .....	15
DLNA Connection .....	16
Connecting Your Projector to the Internet .....	17
Miracast Connection .....	19
Technical Specifications .....	22

This projector is an all-in-one, portable device designed for family, entertainment, business presentations and it will display as big a screen as you like at any time. The projector integrates high performance DLP projector technology and compact design for vivid images and ease-of-use.

## **Product Features:**

- ★Supports Airplay, DLNA and Miracast.
- ★RGB-LED provides more natural and brilliant color.
- ★Vibrant LED light projection lasts over 20,000 hours.
- ★Built-in, high-capacity Li-ion battery lasts up to 150 minutes of video play time on a single charge.
- ★Built-in multimedia player for playing Video/Music/Text/Photo from micro SD.
- ★Micro HDMI interface; Sound output interface.
- ★Unique design allows to adjust viewing angle from 0 to 90 degrees.
- ★Built-in speakers provide crystal clear and 360° sound.
- ★Instant Power On/Off eliminates warm up/cool down cycles.

Reading this User Manual to quickly learn how to use this product and experience its extraordinary functionality and ease of operation.

- This manual is based on the default settings of the product.
- Some images and screenshots in this manual may slightly differ from the actual products.

## Safety Instructions

To ensure safe use this projector, please carefully follow the guidelines in this User Manual to operate.

- Please select AcTek specified adaptor. Use of other adaptors may cause damage to the projector.
- Unauthorized disassembly, modification, throwing or dropping to this projector should be avoided and will void your warranty.
- The projector should be repaired only by factory-approved technicians.
- The built-in projector battery should be changed only by a factory-trained technician.
- Do not insert or allow metal objects to fall into the projector's vents or drop into the projector to avoid serious damage. If objects have fallen in, immediately turn off the power and contact AcTek Customer Service.
- Keep the projector away from liquids. If liquid is spilled on the projector, instantly turn off the projector and contact our Customer Service Center for instructions.
- Use the projector in an area with good ventilation, temperature between 0-35°C and humidity between 0-85%.
- **Do not block the air outlet/inlet of the projector, otherwise the high temperatures inside of the projector can cause serious damage or even cause a fire hazard.**
- Do not use projector in high ambient light, dirty dusty or strong magnetic field conditions.
- Do not look directly into the projector lens while it's operating to avoid possible damage to your eyes.

## Packing Contents

Your projector package should contain all the items shown below. Please check to be sure that you have all the items, and contact AcTek Customer Service if anything is missing.



Projector



Remote Control



Adaptor



micro SD

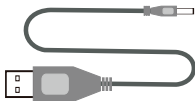

USB CABLE

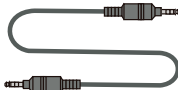

AUX CABLE

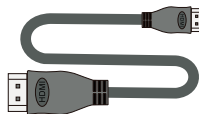

micro HDMI CABLE  
( Optional )

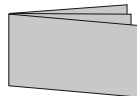

User Manual  
Warranty Card

## Product Overview

(Front)

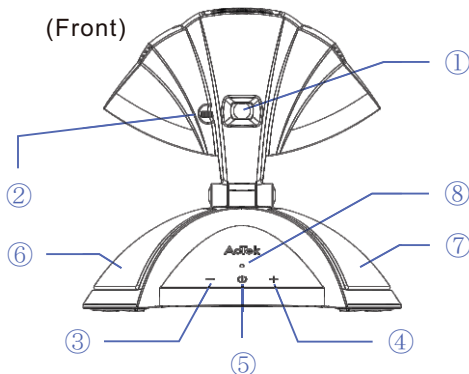

- 1.Lens
- 2.Focus
- 3.Speaker Vol-
- 4.Speaker Vol+
- 5.Speaker Power Switch
- 6.Speaker(left)

(Overlook)

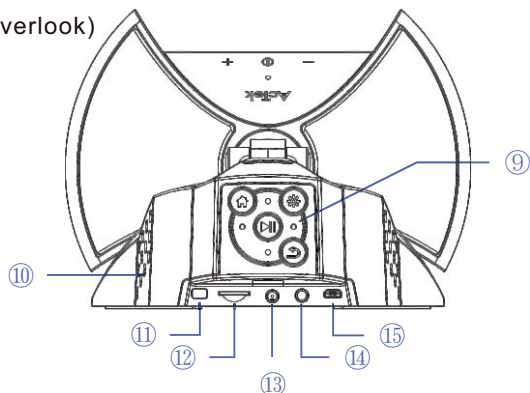

- 7.Speaker(right)
- 8.Power Signal Indicator
- 9.Projector Control Panel
- 10.Air Outlet (1)
- 11.Projector Power Switch
- 12.micro SD Slot
- 13.Power Port
- 14.Headphone Jack
- 15.HDMI Interface

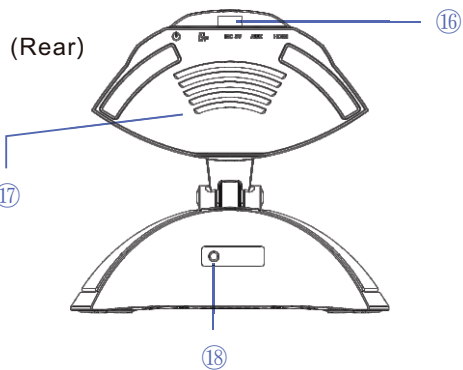

- 16.Remote Control Signal Receiving Port
- 17.Air Outlet (2)
- 18.AUX Port

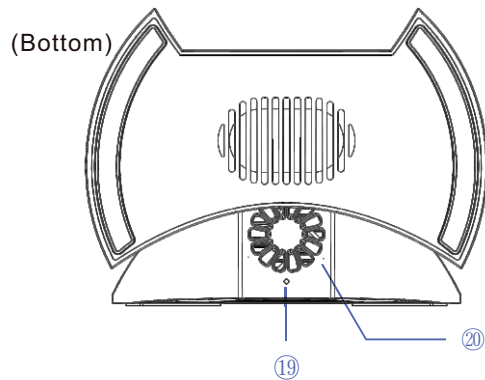

- 19.Reset Button
- 20.Air Inlet

## Remote Control

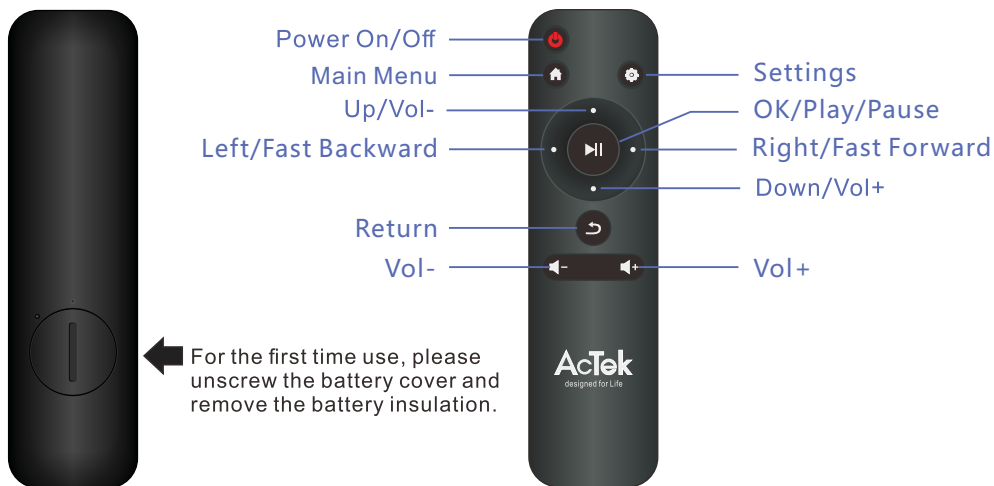

□ Remote control button battery model:CR2032



## Projector Control Panel

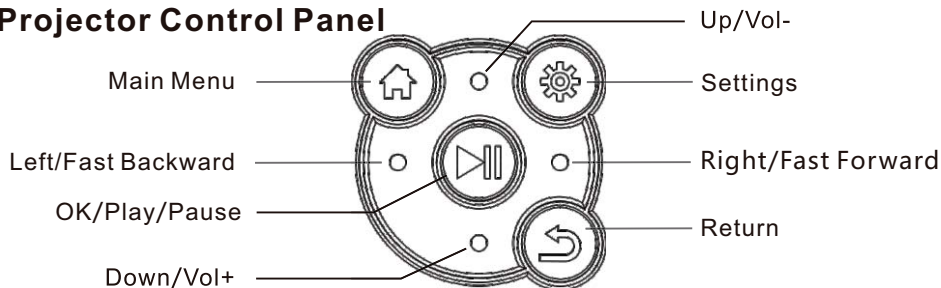

## Charging

Connect the charging cable to the power port of your projector. Connect the other end to the power adaptor.

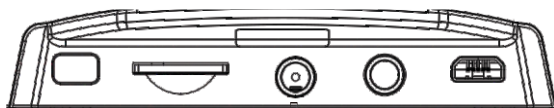

Please use the included charging cable and adaptor

Power adaptor

- ※The projector will be fully charged after 4 hours of charging.
- When fully charged, the power signal indicator will turn off automatically.
- ※To recharge the projector most effectively, it is recommended that charging take place while the projector is off.

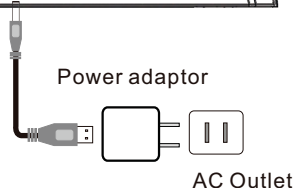

## Turning Projector On/Off

1. Push the projector power button for 2 seconds to turn the projector and speaker on/off together.
2. Push the speaker power button for 3 seconds to turn only the speaker on/off.

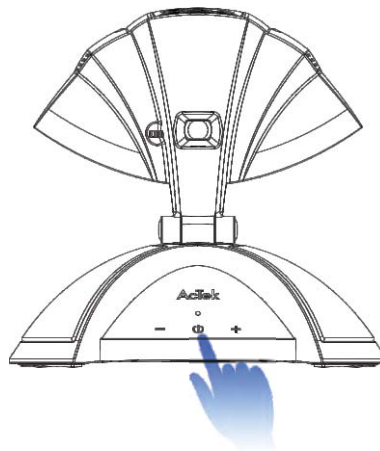
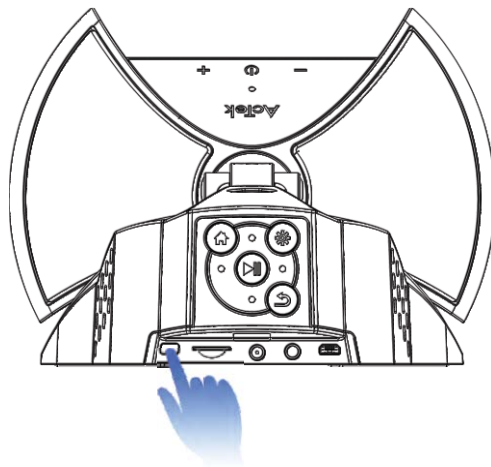

## Focus Adjustment

- ◆ Adjust the location of the projector to obtain a satisfactory projection image size.
- ◆ Rotate the focus ring back and forth to get the clearest image.

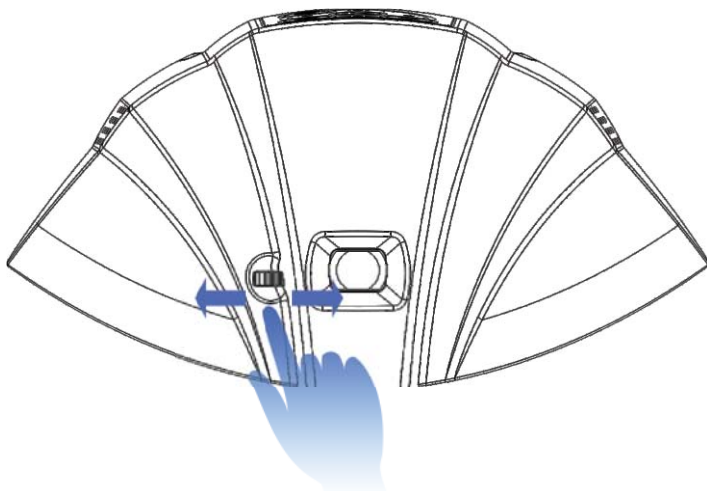

## Adjusting projector Angle

- ♦ By adjusting the top unit back and forth to get the most satisfactory projection angle.

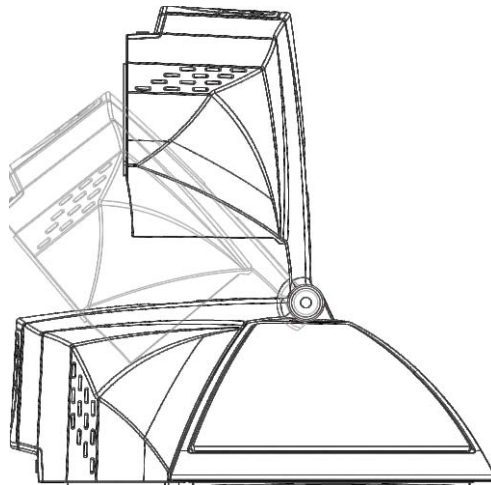
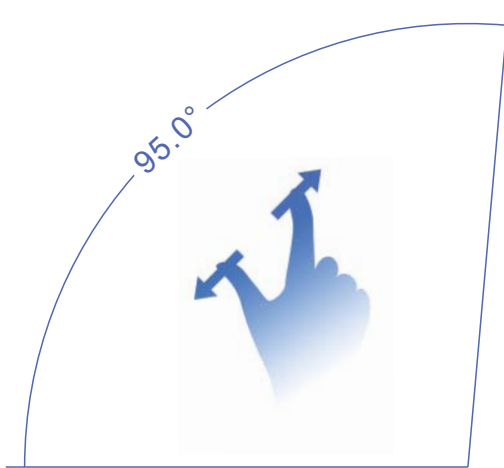

## On-Screen Display Menu



The projector can be operated by remote control or by using the control panel after the on-screen display menu appears.

- WIRELESS

- ◆ Setting this item allows the projector to connect with your phone and mirrors your phone screen. Specific methods of operation will be described later in this Manual.

- HDMI/MHL

- ◆ This function allows you to project local signal sources from HDMI-enabled devices.

- micro SD

- ◆ This function allows you to project local signal sources from the micro SD.

- SETTINGS

- ◆ This item can adjust and set various parameters of the projector.

- Power Indication

- ◆ Displays battery status of the projector.

- Memory card Insert Status Indication

- ◆ Displays micro SD insert status.

## Selecting An Input Source

- ◆ Insert the micro SD as shown below and click "micro SD" in the On-Screen Display menu to allow the projector to read the micro SD content, including videos, music, images and Txt.
- ◆ Connect your HDMI-enabled devices to the projector via the included micro HDMI cable as shown below and click "HDMI/MHL" in the on-screen menu to allow the projector to output the HDMI signal source.

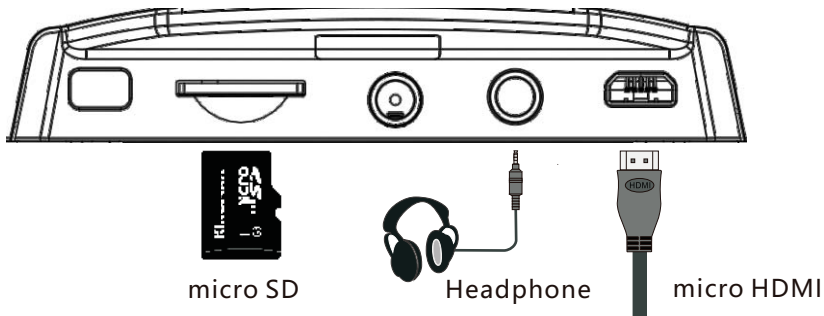

※micro SD supports a maximum capacity of 32G

## Wi-Fi Connection

- ◆ Select "WIRELESS" in the on-screen menu to enter the Projector's Wireless Guide Screen.
- ◆ Access "Wi-Fi Settings" in your smart device. Find the default device name "AcTek -XXXXX" and input password "12345678" to connect.

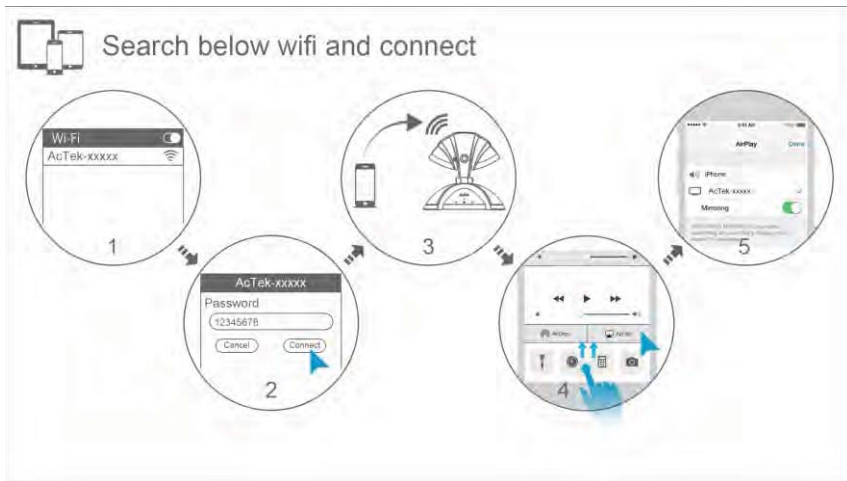



## AirPlay Connection

- ♦ After the projector is successfully connected to Wi-Fi, please operate your iOS device according to the following steps:



1.Slide from the bottom of the smart device to enter the control center.

2.Select “AirPlay Mirroring” as shown in the picture and it will show available mirroring devices.

3.Select the device named “AcTek” and the projector and the smart device will start mirroring.

- ※During mirroring, some video games may have a projection pause as the smart phones normally process the screen in the phone preferentially so the outgoing transmission will slow down.
- ※Please update your iOS to version 7.0 or above. Some iOS devices do not support screen mirroring, such as iPhone 4, iPad 1 and earlier versions.
- ※If iPhone/iPad needs to be connected to the Internet in AirPlay mode, you may need to connect the projector to a wireless network. For details please refer to the instructions on Page 17.
- ※In AirPlay mode, you may not be able to use Safari via 3G or 4G because of iOS limitations.

## DLNA Connection

Photos, videos, music and other media files from smart devices or the Internet can be projected on the big screen through wireless transmission technology in DLNA mode. Before using DLNA, your smart devices need to have installed the applications which support the DLNA playback function, such as YouTube, PPTV and iMediaShare.

Using DLNA should be in Airplay mode. Open Wi-Fi in your smart device and find the default name “AcTek” and connect it by entering the password “12345678”.

For example, open a video in YouTube and click the  DLNA icon on the screen. Select “AcTek-XXXXXX” and the projector will start to display after a few moments.

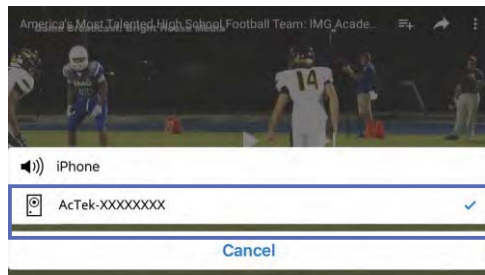

- ※Connect the projector to a wireless network to watch online videos. For details, please refer to the instructions on Page 17.
- ※DLNA icon is different in different software.



## Connecting Your Projector to the Internet

Open the browser in your smart device (Safari in iOS) after enabling the Wi-Fi connection. Typing "192.168.203.1" in the address bar to open the Setup Menu. Click "Internet" and select a local wireless network. Input the password to connect to the local wireless network. After that, you will be able to display online media.

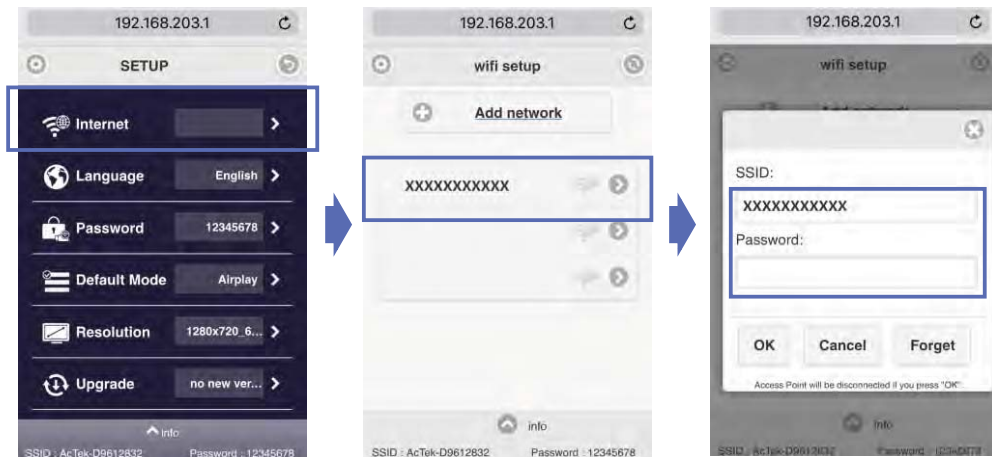

## Interface Introduction



### Set Up:

- Internet: Set up projector to link with your home router and keep internet surfing (Please note that the connection between your smart device and projector may disconnect when you link it to your home router for the 1st time).
- Language: Multiple language selection
- Password: Change default Wi-Fi password
- Default Mode: Select Airplay or Miracast as default for starting up.
- Resolution: Set up output resolution
- Upgrade: Latest firmware upgrade (please note that this will require an internet connection)

## Miracast Connection

- ◆ If the interface is in Airplay mode, use the projector control panel or the remote control to switch to the Miracast interface by pressing play/pause button.
- ◆ Turn on Miracast or wireless display in your smartphone or tablet. Find the preset name of the projector and connect. After connecting, you will be able to mirror the content to the projector.

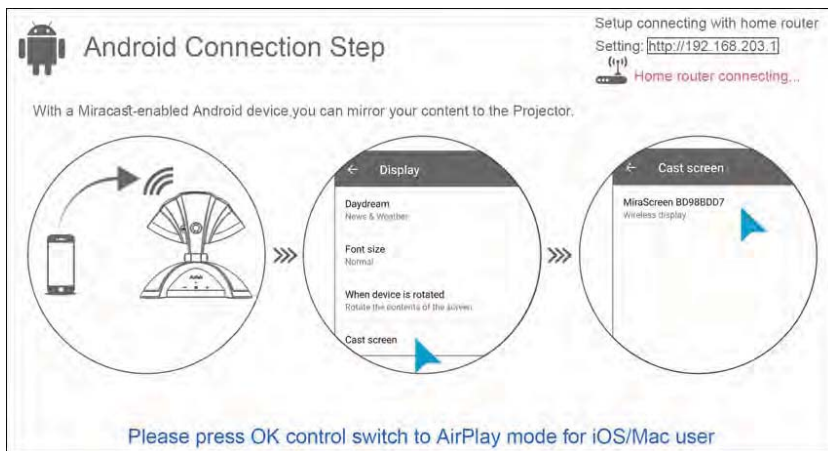

## Miracast Connection for Different Android Devices

The settings and names of Miracast may be different in your smartphone or tablet. Please refer to your device's detailed description.

The following instructions are for several common devices:

(Note: In the following cases, operation may be different due to device system updating. Please refer to the actual situation)

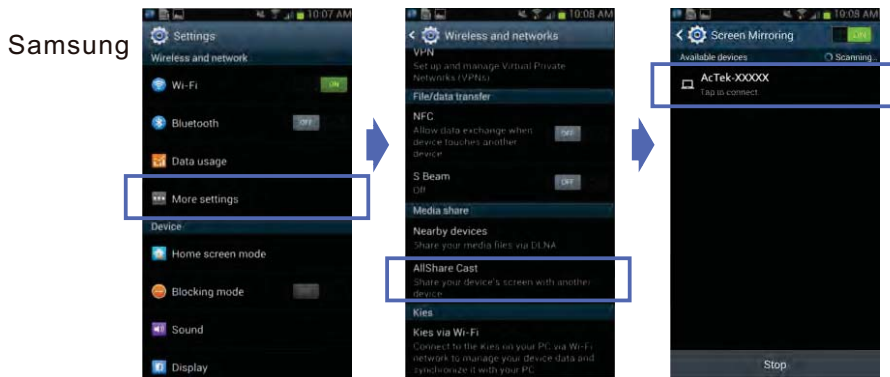

1. Enter Settings in your Samsung device.
2. Select "More settings".

3. Select "AllShare Cast".
4. Find "AcTek-XXXXX". Click on it and wait for a few seconds. Then the projector will mirror your Samsung screen.

## HTC

1. Enter settings in your HTC device.
2. Select “Media output”.
3. When you see “AcTek-XXXXX” on the list, click on it.
4. In a few seconds, the projector will mirror your HTC screen.



- ※1. This feature is only available for those Android devices that support Miracast wireless sharing. Please contact your device supplier for operating instruction if you use other devices.
- ※2. For those Android devices which are upgraded to Android 4.3 or above, there may be compatibility problems. Please wait for the software update.
- ※3. In order not to affect performance, make sure there is no obstacle between the projector and your smart device, and the distance should not exceed 16ft.
- ※4. As Miracast demands high-performance phones or high software optimization ability, some devices will appear to delay or stop when they are running a big application. This is normal and you can try to reconnect or wait for self-optimization by the device.

## Technical Specifications

Standard Resolution	854*480 (compatible with 1080P)
Display Technology	DLP
Light Source	R,G,B primary color LED
Projection Size	37.8inch @1m
Operating System	LuxUI@Android 4.4
CPU	High speed/performance 32-bit RISC CPU
Wireless Connection	AirPlay/DLNA/Miracast
Storage Device	micro SD
HDMI	micro HDMI Input
Headphone Output	3.5mm stereo port
Speaker	4Ω/4W*2
Power Supply	5V 2A
Battery	5000mAh Li-ion battery
Working Temperature	0℃-35℃
Working Humidity	0-85%( Non-condensing)
Dimension (L*W*H)	6"x6.3"x2.5"
Weight	19oz

※This product and the user manual are both subject to further improvement and supplement without prior notice.



## Customer Service

If you need help with the operation of AcTek products, you can reach us by:

1. Sending emails to us at [support@actekcorp.com](mailto:support@actekcorp.com)
2. Visiting our website at [www.actekcorp.com](http://www.actekcorp.com) to find help in our Support page.

## FCC Statement

This device complies with Part 15 of the FCC rules. Operation is subject to the following two conditions: 1) this device may not cause harmful interference, and 2) this device must accept any interference received, including interference that may cause undesired operation.

Note: This equipment has been tested and found to comply with the limits for a Class B digital device, pursuant to part 15 of the FCC Rules. These limits are designed to provide reasonable protection against harmful interference in a residential installation. This equipment generates uses and can radiate radio frequency energy and, if not installed and used in accordance with the instructions, may cause harmful interference to radio communications. However, there is no guarantee that interference will not occur in particular installation. If this equipment does cause harmful interference to radio or television reception, which can be determined by turning the equipment off and on, the user is encouraged to try to correct the interference by one or more of the following measures:

- Reorient or relocate the receiving antenna.
- Increase the separation between the equipment and receiver.
- Connect the equipment into an outlet on a circuit different from that to which the receiver is connected.
- Consult the dealer or an experienced radio/TV technician for help.

Changes or modifications not expressly approved by the party responsible for compliance could void the user's authority to operate the equipment.

### FCC Radiation Exposure Statement

This device complies with FCC RF radiation exposure limits set forth for an uncontrolled environment. This transmitter must not be co-located or operating in conjunction with any other antenna or transmitter.

This device must operate with a minimum distance of 20 cm between the radiator and user body.