

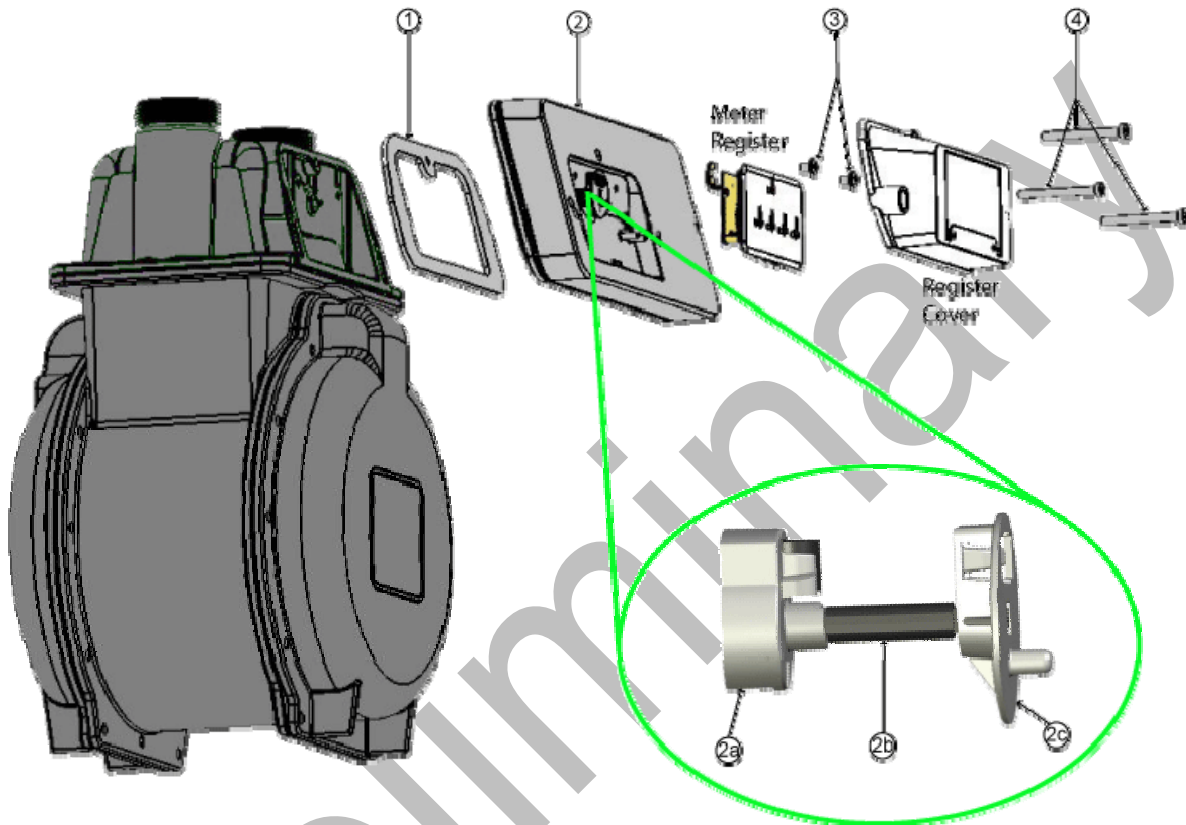

## Purpose & Scope

This instruction provides a procedure for installing a STAR direct-mount MTU on the following Actaris/Sprague/Schlumberger residential gas meters: **175, 250 and 400 (Slant-face)**.



## Parts Required

Ref. #	Item	Part Number	Quantity
1	Gasket	066-11583	1
2	MTU, Direct Mount	506-11583	1
2a	Magnet Coupler	part of 506-7712BSP1	1
2b	Coupler Shaft	part of 506-7712BSP1	1
2c	Register Coupler	part of 506-7712BSP1	1
3	#10 x 3/8" combo head thread form screw, Type B, zinc	069-100012C4A	2
4	10-24 x 2" slotted fillister head machine screw, zinc	069-102464HA	3

# MTU Instruction for Actaris/Sprague/Schlumberger Gas Meters

## Tools Required

To mount the MTU to these meters, you will need the following tools and equipment:

- Safety glasses
- Phillips screwdriver
- Slotted screwdriver

## Installation Procedure

Before installing the MTU, all anti-tamper, safety, and security hardware must be removed from the clear register cover.

**Step 1** - Remove the existing clear register cover by removing the three screws that hold it. Set the cover aside and discard the screws.

**Step 2** - Remove the register by removing the two screws that hold it. Set the register aside and discard the screws.

**Step 3** – Next, mount the register onto the MTU (see illustration below) fastening the register to the MTU with the #10 x 3/8" screws provided.

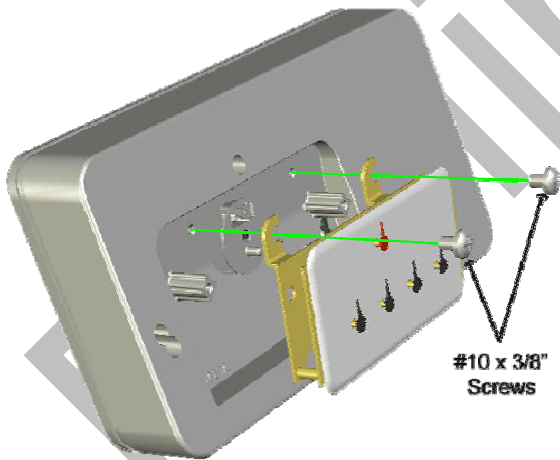

Start the two screws into the mounting holes, and then slide the register beneath the screws, making sure that the wiggler on the register is aligned with the MTU coupler. Tighten both screws to a torque not to exceed 3-5 inch-pounds.



### CAUTION!

Do not over tighten screws. Excessive torque may damage the MTU enclosure. **Use of power tools is not recommended.**

**Step 4** – Check that the register is properly engaged by rotating the coupler on the back of the MTU and observing the register dials.

**Step 5** – Next, Insert the three 10-24 x 2" machine screws through the holes on the register cover and MTU as shown below.

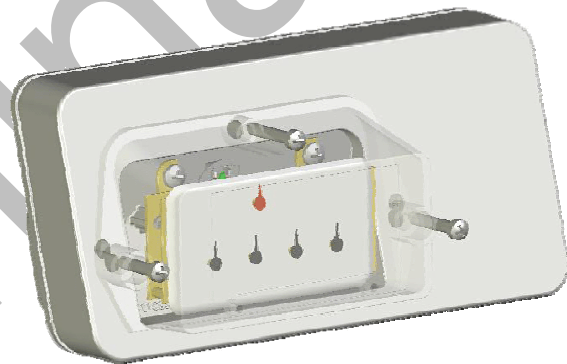

**Step 6**– Turn the MTU over and place the gasket on the back of the MTU so that it aligns over the three mounting screws.



## MTU Instruction for Actaris/Sprague/Schlumberger Gas Meters

**Step 7** – Next, position the MTU on the meter. Rotate the coupler into position to ensure that it engages correctly with the wiggler on the gas meter.

**Step 8** – Now, firmly hand tighten the mounting screws to 12 to 15 in-lb. The gasket should be compressed slightly. Be careful not to over tighten the screws. Excessive torque may damage the MTU enclosure. Because of this, power tools are not recommended for this procedure.

**Step 9** - Replace any anti-tamper, safety, or security hardware onto the plastic cover as required.

**Step 10** – Once Installation is complete, program the MTU using the STAR Programmer Software and your MTU Programmer.



# MTU Instruction for Actaris/Sprague/Schlumberger Gas Meters

---

Preliminary

## ***The FCC wants you to know.....***

This equipment has been tested and complies with Part 15 and Part 90 of the FCC Rules. These limits are designed to provide reasonable protection against harmful interference. This equipment generates, uses and can radiate radio frequency energy, and, if not installed and used in accordance with the instructions, may cause harmful interference to radio communications. However, there is no guarantee that interference will not occur in a particular installation. If this equipment does cause harmful interference to radio or television reception, try to correct the interference by one or more of the following measures:

- Reorient or relocate the equipment.
- Increase the separation distance between the affected equipment and receiver.
- Consult Hexagram, Inc. for help.

Any changes or modifications to this equipment not expressly approved by the Hexagram, Inc. could void the authorization to operate the equipment.

## ***FCC RF Exposure Guidelines***

Hexagram's low power RF devices and their antennas must be fixed-mounted on indoor or outdoor permanent structure(s) providing a separation distance of at least 20 cm from all persons during normal operation. This device is not designed (and it has no external connection) to operate in conjunction with any other antennas or transmitters. No other operating instructions for satisfying RF exposure compliance are needed. This unit has no user or installer serviceable parts, and requires no field adjustment or calibration. Units are sealed at the factory, and disruption of this seal could void the authorization to operate the equipment.

**Hexagram, Inc.**  
23905 Mercantile Road  
Cleveland, OH 44122