



PACKAGE CONTENTS

- Bluetooth mouse
- AA batteries (2)
- Quick Setup Guide

SYSTEM REQUIREMENTS

- Windows® 10, Windows® 8.1, Windows® 8, Windows® 7, or Mac OS 10.X or higher
- One available USB port

FEATURES

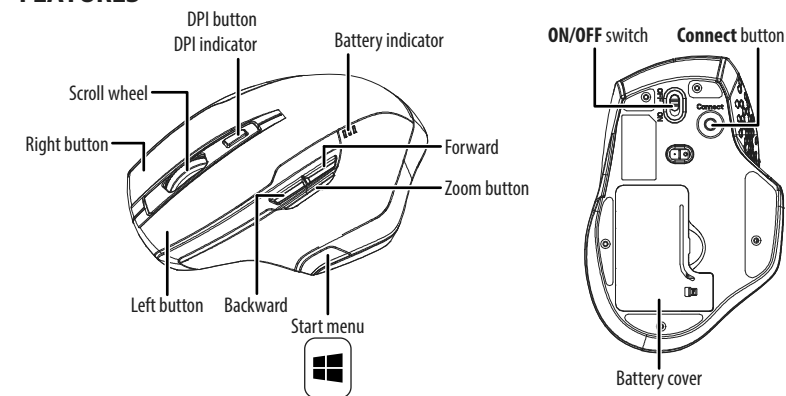

PT-PNMBL8BK
BLUETOOTH MOUSE
QUICK SETUP GUIDE

Before using your new product, please read these instructions to prevent any damage.



INSTALLING THE BATTERIES

1 Remove the battery cover.

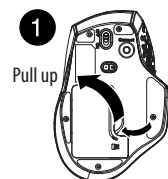

2 Insert two AA batteries (included) into the battery compartment, then replace the battery cover. Make sure that the + and – signs match the symbols in the compartment.

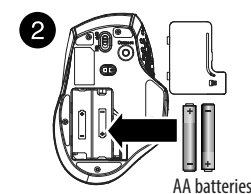

3 Slide the power switch to **ON**.

PAIRING YOUR MOUSE

Windows OS:

1 Slide the power switch to **ON**, then press the **Connect** button on the bottom of your mouse. The DPI indicator blinks.

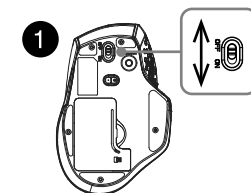

2 Click the Bluetooth icon in your computer's taskbar.

Note: If your adapter is turned off, right-click the icon, then select **Turn adapter on**.

3 Click **Add a device**. Your computer searches for your mouse.

4 Double-click **Bluetooth Mouse**. When pairing is complete, the LED indicator turns off.

Mac OS:

1 Slide the power switch to **ON**, then press the **Connect** button on the bottom of your mouse. The DPI indicator blinks.

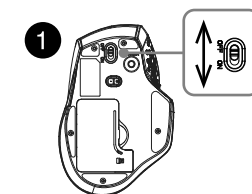

2 Open *System Preferences*, then click **Bluetooth**.

3 Click **+** in the lower-left corner. Your computer searches for your mouse.

4 Double-click **Bluetooth Mouse**. When pairing is complete, the LED indicator turns off.

Note: If your computer has never connected to a Bluetooth device, click **Set Up New Device** to pair your mouse to your computer.

UN-PAIRING YOUR MOUSE

Windows:

1 Click the Bluetooth icon on your task bar.

2 Click **Show Bluetooth Devices**.

3 Right-click **Bluetooth Mouse**.

4 Click **Remove Device** to un-pair the mouse.

Mac:

1 Open *System Preferences*, then click **Bluetooth**.

2 Click the **-** in the lower-left corner.

3 When it asks *Are you sure you want to remove this device?*, click **Remove**.

USING YOUR MOUSE

Turning your mouse on or off

- Slide the OFF/ON switch to turn your mouse off or on.
- Your mouse sleeps after 10 minutes of inactivity to save battery life. Move your mouse or press a button to wake it up.

Final flat size: 482.6 × 148.08 mm
Final fold size: 120.65 × 148.08 mm



V1
FINAL
FOR PRINT

Adjusting mouse sensitivity (DPI):

Note: The default setting is 1600 DPI.

• Press the DPI button repeatedly to cycle your mouse sensitivity. The DPI indicator lights up for 10 seconds to indicate the current setting:

- Bright: 1600 DPI (default)
- Dim: 1200 DPI
- No light: 800 DPI

• You may also be able to adjust your mouse sensitivity with your computer's settings. See your operating system's instructions for more information.

Forward

• Press this button to view the next page in your Internet browser.

Backward

• Press this button to view the previous page in your Internet browser.

Zoom Button (Zoom in /out)

• Press the Zoom button and turn the scroll wheel at the same time to zoom in and out.

Windows Key

• Press this button to access the Start screen.

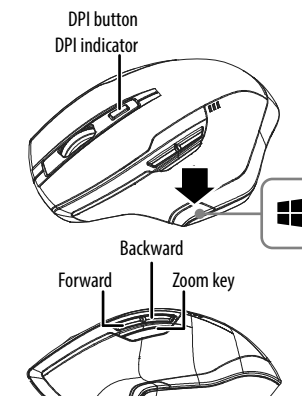

LED INDICATORS

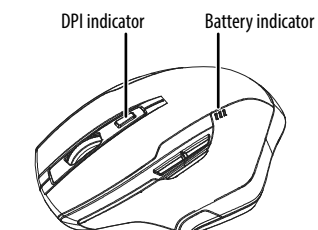

DPI indicator

FUNCTION	DESCRIPTION
Power ON	LED is on for 10 seconds
Pairing	LED blinks (turns off when paired or if pairing fails after 10 minutes)
Low battery	LED blinks for ten seconds
DPI switched	Bright: 1600 DPI Dim: 1200 DPI Off: 800 DPI

Battery indicator**Notes:**

- Your battery status shows for five seconds after turning on your mouse or after waking it from sleep mode.
- The DPI indicator blinks for ten seconds when your batteries need to be replaced.

STATUS	DESCRIPTION
3 LEDs	75~100% of maximum battery
2 LEDs	21~74% of maximum battery
1 LED	5~20% of maximum battery

CLEANING YOUR MOUSE

- Wipe the mouse with a damp, lint-free cloth.

SPECIFICATIONS**Mouse:**

- Dimensions (L×W×H): 4.9×3.3×1.7 in.
(12.52×8.4×4.46 cm)
- Net weight: 4.23±0.18 oz. (119±5 g)
- Batteries: 2 AA alkaline batteries
- Battery life: 12 months (based on average usage)
- Radio frequency: Bluetooth 3.0
- Operating distance: 33 feet (10 m)
- Rating: 3V C.C. - 10 mA
- Compatibility: Bluetooth 2.1, 3.0, 4.0, 4.1

Nano receiver:

- Dimensions (L×W×H): 0.74×0.57×0.25 in.
(1.89×1.45×0.63 cm)
- Weight: 0.17 oz. (.005 kg)
- Interface: USB 1.1, 2.0, 3.0

IMPORTANT SAFETY INFORMATION

- This product has no serviceable parts. Use of controls or adjustments of procedures other than this guide may result in danger.

CAUTION: To use this product properly, please read this guide before installing.

TROUBLESHOOTING**My mouse is not working.**

- Make sure that the battery is installed correctly and that the switch is turned ON. Replace the battery if it still does not work.
- Move your mouse closer to your computer.
- Make sure that your computer meets the system requirements.
- Make sure that your mouse is paired by pressing the connect button on the bottom of your mouse, then pair it with your computer.
- Make sure that the Bluetooth function on your computer or Bluetooth receiver is working.
- Un-pair your mouse from your computer, then re-pair it.

The screen cursor does not move properly.

If your screen cursor lags behind the movement, then your Bluetooth connection may not be able to transmit all of the data from the mouse with the necessary speed. This may be caused by interference from other radio sources, obstructions in the radio wave path, excessive distance from the computer, or a combination of the above.

- Remove any metallic objects from the line of sight between your computer and the Bluetooth mouse.
- If you are using a computer with a built-in Bluetooth antenna, try reorienting the computer until you get a better data rate.
- If you are using a Bluetooth dongle, use a USB extension cable and place the Bluetooth dongle onto your desktop or somewhere in sight of your Bluetooth mouse.
- Move the mouse closer to your Bluetooth dongle.
- Turn off the mouse, and then turn it on again for a better connection.
- Disconnect any Bluetooth audio devices, such as headsets, that may be connected to your computer.
- Switch off any other devices operating in the 2.4 GHz radio spectrum, such as a Wi-Fi network or mobile telephone, or move their antennas further away from your computer.

LEGAL NOTICES**FCC Statement**

This device complies with Part 15 of the FCC Rules. Operation is subject to the following two conditions: (1) this device may not cause harmful interference, and (2) this device must accept any interference received, including interference that may cause undesired operation.

FCC Caution

Changes or modifications not expressly approved by the party responsible for compliance could void the user's authority to operate this equipment.

Note: This equipment has been tested and found to comply with the limits for a Class B digital device, pursuant to Part 15 of the FCC Rules. These limits are designed to provide reasonable protection against harmful interference in a residential installation. This equipment generates, uses and can radiate radio frequency energy and, if not installed and used in accordance with the instructions, may cause harmful interference to radio communications. However, there is no guarantee that interference will not occur in a particular installation. If this equipment does cause harmful interference to radio or television reception, which can be determined by turning the equipment off and on, the user is encouraged to try to correct the interference by one or more of the following measures:

- Reorient or relocate the receiving antenna.
- Increase the separation between the equipment and receiver.
- Connect the equipment into an outlet on a circuit different from that to which the receiver is connected.
- Consult the dealer or an experienced radio/TV technician for help.

RSS-Gen & RSS-247 statement:

This device complies with Industry Canada licence-exempt RSS standard(s). Operation is subject to the following two conditions: (1) this device may not cause interference, and (2) this device must accept any interference, including interference that may cause undesired operation of the device.

Le présent appareil est conforme aux CNR d'Industrie Canada applicables aux appareils radio exempts de licence. L'exploitation est autorisée aux deux conditions suivantes : (1) l'appareil ne doit pas produire de brouillage, et (2) l'utilisateur de l'appareil doit accepter tout brouillage radioélectrique subi, même si le brouillage est susceptible d'en compromettre le fonctionnement.

RSS-102 Statement:

This equipment complies with Industry Canada radiation exposure limits set forth for an uncontrolled environment.

Cet équipement est conforme à l'exposition aux rayonnements Industrie Canada limites établies pour un environnement non contrôlé.

ONE-YEAR LIMITED WARRANTY**CONTACT PLATINUM**

For customer service, call 1-800-499-3964

The Pt logo is a registered trademark of Best Buy.
PLATINUM is a trademark of Best Buy and its affiliated companies
Distributed by Best Buy Purchasing, LLC
7601 Penn Ave South, Richfield, MN 55423 U.S.A.
©2017 Best Buy. All rights reserved.
Made in China