

Acumen Model L

Fireplace Remote Control Operating Instructions For The Homeowner

The Model L Remote Control is designed for use with decorative gas fireplace and wall heaters using a Millivolt gas valve.

BEFORE YOU BEGIN:

Warning The pilot flame must be lit, with the gas control valve turned to "ON", for the remote to work correctly. Read all of the safety precautions in the owner's manual included with your fireplace before using this remote control. The thermostat is not intended for unattended use.

INSTALLING FRESH BATTERIES:

Note: It is not necessary to re-set your private code when installing fresh batteries.

The fireplace **MUST** be OFF before replacing transmitter batteries.

INSTALL BATTERIES INTO RECEIVER:

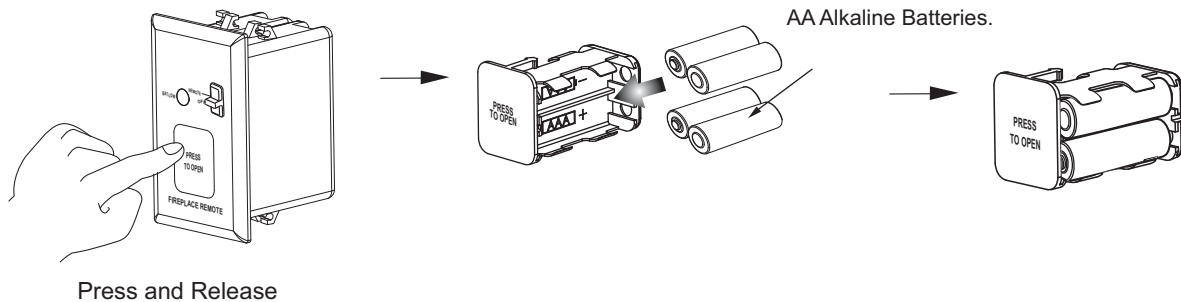

INSTALL BATTERIES INTO TRANSMITTER:

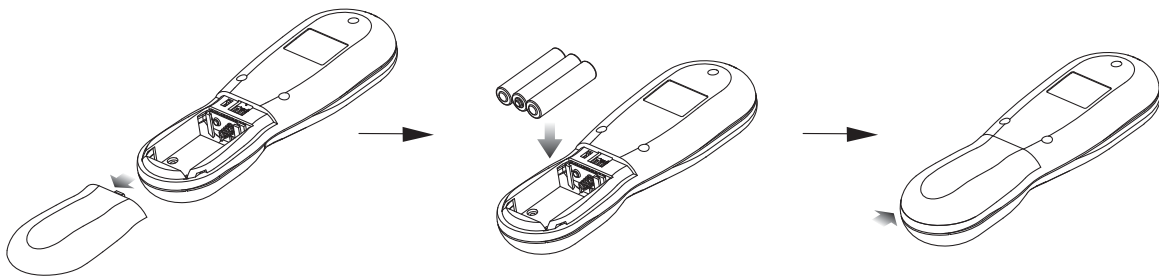

Replace Batteries At Least Every 6 Months.

WARNING: THE REMOTE TRANSMITTER WILL AUTOMATICALLY SWITCH OFF THE FIREPLACE WHEN THE BATTERIES IN THE REMOTE TRANSMITTER ARE LOW.

RECEIVER OPERATION:

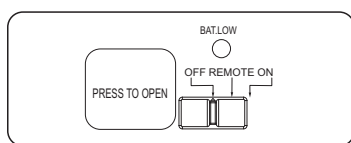

Fireplace Off

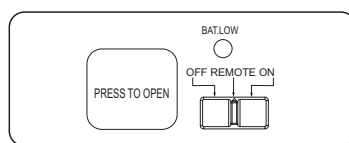

Fireplace Controlled
by Remote

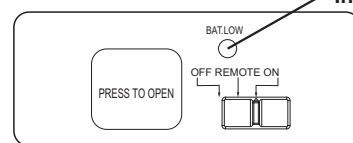

Fireplace On

TRANSMITTER OPERATION:

WARNING: IT TAKES SOME TIME FOR THE RECEIVER TO RESPOND TO THE TRANSMITTER. DO NOT PRESS THE BUTTONS MORE THAN ONCE WITH 2 SECONDS FOR CORRECT OPERATION.

SETTING THE CLOCK / TEMPERATURE MODE. See Figure 2

Press and hold the Clock button for approximately 2 seconds until the hour display starts to flash (Remote must be in Auto mode). Use the Up and Down buttons to set the hour. Pressing the Clock button again will cause the minute display to flash. Use the Up and Down buttons to set the minutes.

Press the Clock button a third time to activate the °F or °C display. Use the Up and Down buttons to adjust for the desired modes. To exit the setting mode, press the Clock button.

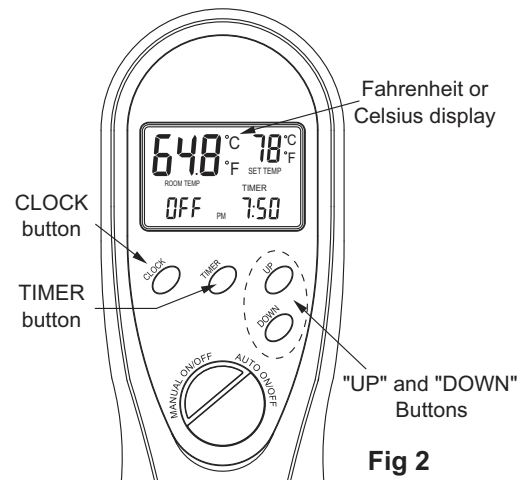

Auto Mode. See Figure 3

Auto mode works like a thermostat, turning the heater on and off to meet the desired temperature.

CAUTION:

THE REMOTE RECEIVER WILL AUTOMATICALLY TURN OFF THE FIREPLACE AFTER SIX HOURS OF UNINTERRUPTED OPERATION. PRESS AUTO ON/OFF BUTTON ON THE REMOTE TRANSMITTER TO RESET THE REMOTE CONTROL, THEN PRESS AUTO ON/OFF BUTTON AGAIN TO RESUME OPERATION.

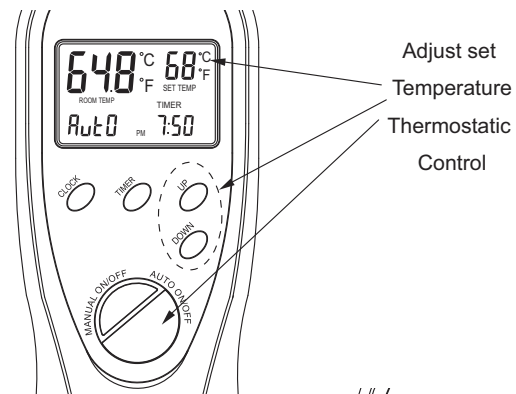

Manual Mode. See Figure 4

1. Press the Manual On/Off button once to light the fireplace. Push the button again to turn it off.
2. In Manual mode the Remote Transmitter will not turn the fireplace off/on even if the room temperature exceeds the target temperature.

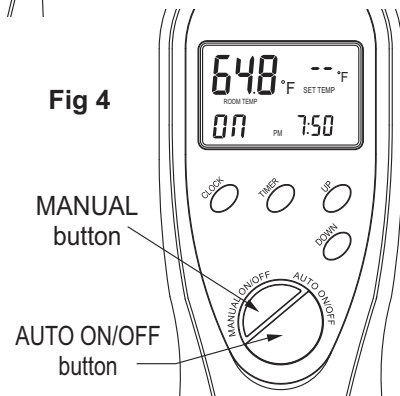

TIMER OPERATION. See Figure 5

1. You can set the timer to the length of time you want the fireplace to operate (1 to 120 minutes).
2. Press the TIMER button once. The Timer display "---" will blink.
3. Press the Up and Down buttons to set the timer. The LCD will display the time chosen.
4. The timer setting can be canceled at any time by pressing and holding the "TIMER" button.
5. Press Manual or the Auto On/Off button to turn on the fireplace.
6. The fireplace will turn off at the end of the timer setting.

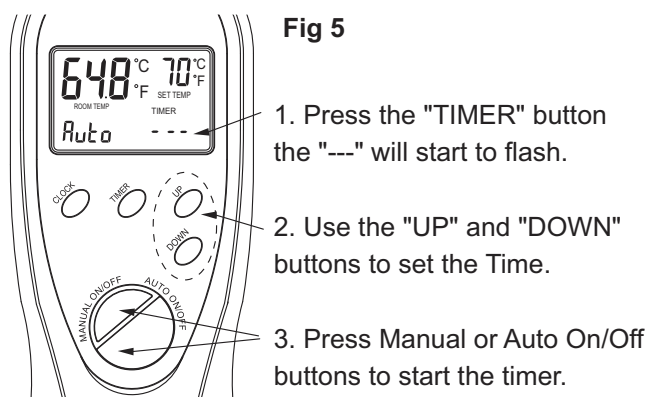

Child-Proof Feature, See Figure 6

The Child-Proof switch disables the buttons on the front of the Remote. Thermostat and timer functions continue to operate.

1. Remove the cover at the back of the Remote Transmitter to expose the CHILD-PROOF switch.
2. Slide the CHILD-PROOF switch to position marked C/P to activate the CHILD-PROOF function. "Child-Proof" will appear on the LCD.
3. In CHILD-PROOF mode the Remote Transmitter will not operate the Remote Receiver until the "child-Proof" code is used or the switch is returned to the other position.
4. Press the Up and Down buttons in the following sequence:

Up-Down-Down-Up-Down

within 2 seconds button function will be temporarily restored, "Child-Proof" will disappear from the LCD.

5. If no button is pressed within 2 minutes, the Remote Transmitter will return to Child-Proof function and "Child-Proof" will reappear on the LCD until the Child-Proof switch is slid back to the other position or the up-down sequence is repeated.

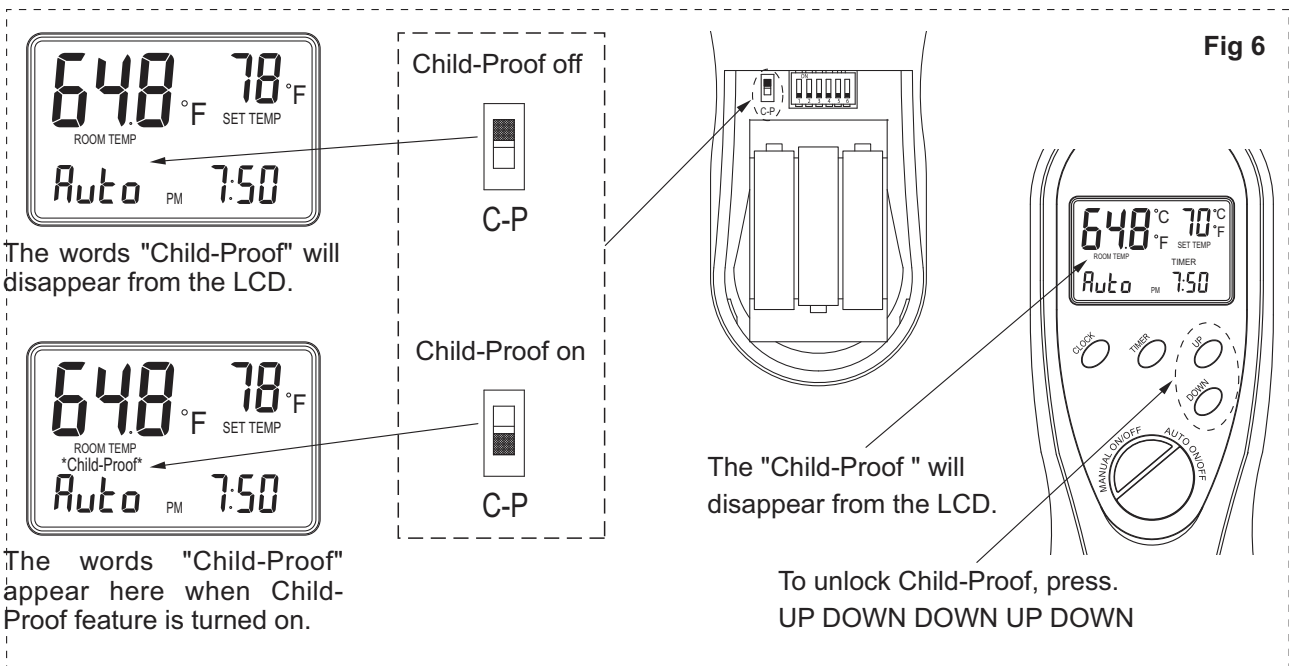

SET PRIVATE CODE. See Figure 7

A privacy code can be set to prevent accidental operation of the fireplace by other nearby transmitters.

1. Remove the cover on the back of the Remote Transmitter to expose the code switches. Slide the code switches to your choice of On or Off positions. Factory setting is all "off".
2. Make sure the slide switch on the Remote Receiver is at Off position.
3. Take the Remote Transmitter close to the fireplace or the Remote Receiver (less than 2-10 feet from the fireplace or Remote Receiver is recommended.)
4. Slide the slide switch on the Remote Receiver to REMOTE position.
5. Install fresh AAA alkaline batteries into the Remote Transmitter.
6. Press any button on the Remote Transmitter, the Remote Receiver will produce a "beep" sound when it receives the code from the Remote Transmitter.
7. If you do not hear a "beep" sound from the Remote Receiver, remove the batteries from the Remote Transmitter and slide the slide switch on the Remote Receiver to Off position, wait for 1 minute and repeat steps 3 to 6.
8. Replace the cover of the Remote Transmitter and the Receiver. The system is now ready to operate.
9. If you desire to operate multiple Remote Receivers with the one Remote Transmitter, continue to hold the button on the Remote Transmitter as you bring the Remote Transmitter within 2-10 feet of each Remote Receiver then slide the slide switch on the Remote Receivers to REMOTE position. Each will acknowledge receipt of coding with a beep.

SET PRIVATE CODE:

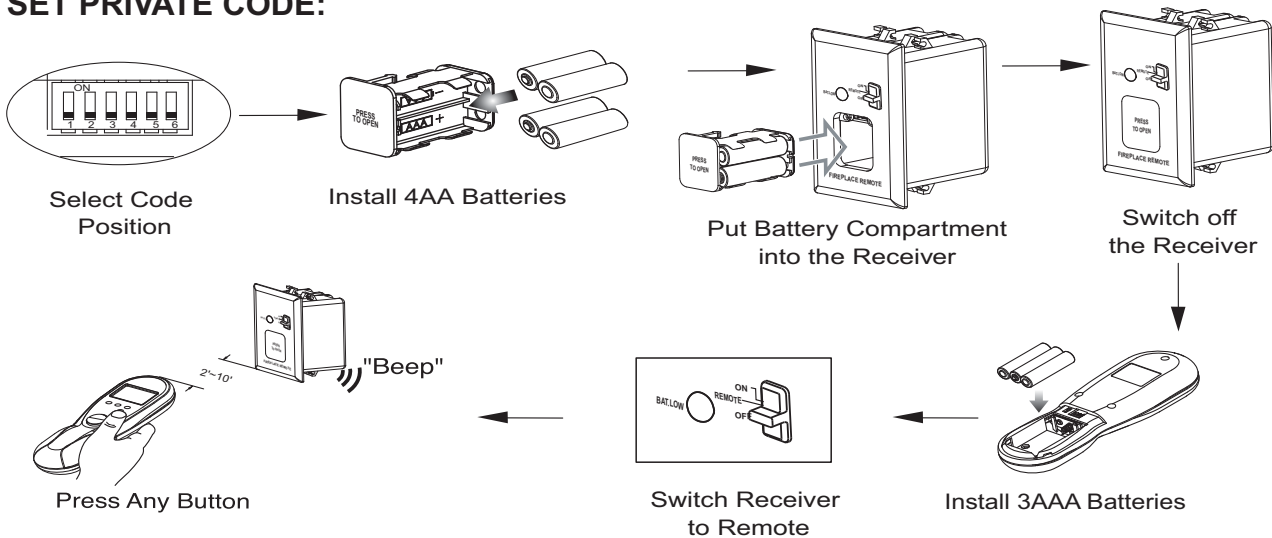

Attention: Important Safety Feature 6HR Safety Timer (FACTORY DEFAULT IS "ON")

Enable - Timer Set to "ON"

In case of Transmitter failure (Mal-function / Battery run out) or out of transmission range, The Receiver will shut down the fireplace automatically after 6Hr of no Transmitter signal detection.

Disable - Timer Set to "OFF"

The Receiver & Fireplace will continue operate in the last setting and will not shut off automatically even in case of Transmitter failure. (Note: Not recommended)

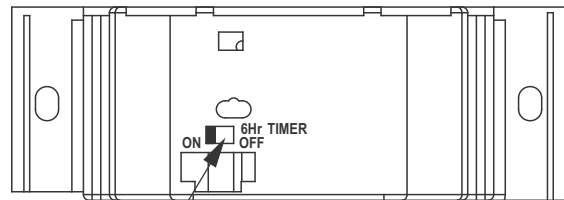

	First 2Hr since last signal received	Following 4Hr	6 th Hr since last signal received
Receiver/Fireplace Status	ON	Intermittent and Check For Transmitter Signal	Shut down if no signal received

FCC Requirements

Warning: Changes or modifications to this unit not expressly approved by the party responsible for compliance could void the user authority to operate the equipment. This equipment has been tested and found to comply with the limits for a Class B digital device, pursuant to Part 15 of the FCC Rules. These limits are designed to provide reasonable protection against harmful interference in a residential installation. This equipment generates, uses, and can radiate radio frequency energy and, if not installed and used in accordance with the instructions, may cause harmful interference to radio communications. However, there is no guarantee that interference will not occur in a particular installation. If this equipment does cause harmful interference to radio or television reception, which can be determined by turning the equipment off and on, the user is encouraged to try to correct the interference by one or more of the following measures:

- Reorient or relocate the receiver antenna.
- Increase the separation between the equipment and receiver.
- Connect the equipment into an outlet on a circuit different from that to which the receiver connected.
- Consult the dealer or an experienced radio TV technician for help.

This device complies with Part 15 of the FCC Rules.

Operation is subject to the following two conditions:

- (1) This device may not cause harmful interference, and
- (2) This device must accept any interference received, including interference that may cause undesired operation.

Canadian Equipment Requirements

This digital apparatus does not exceed the (class A/Class B)* limits for radio noise emissions from digital apparatus set out in the Radio Interference Regulations of the Canadian Department of Communications. Le present appareil numerique n'emet pas de bruits radioelectriques dépassant les limites applicables aux appareils numeriques (de la class A/de la class B)* prescrites dans le Reglement sur le brouillage radioelectrique edicte par le ministere des Communications du Canada.

This device complies with RSS-210 of Industry and Science Canada. Operation is subject to the following two conditions: (1) this device may not cause interference, and (2) this device must accept any interference, including interference that may cause undesired operation of the device.

All wiring should be done by a qualified electrician and shall be in compliance with local codes and with the National Electric Code ANSI/NFPA No. 70-current (in the United States), or with the current CSA C22.1 Canadian Electric Code (in Canada).

Acumen Model L

Fireplace Remote Control Installation Instructions

PLEASE LEAVE THE INSTRUCTIONS TO THE HOMEOWNER.

The Model L Remote Control is designed for use with decorative gas fireplace and wall heaters using a millivolt gas valve.

Installation Precautions:

The Model L Remote Control is tested safe when installed in accordance with this installation manual. It is your responsibility to read all instructions before starting installation and to follow these instructions carefully during installation.

The Model L Remote Control **MUST** be installed by a qualified service technician.

The Model L Remote Control is carefully engineered and **MUST** be installed only as specified. If you modify it or any of its components, you may possibly cause a fire hazard.

Installation Instruction

1.0 Installing the Receiver

1. Make sure the slide switch on the Remote Receiver is at the OFF position.
2. Connect the wires to the TH and TPTH terminals of the Millivolt valve. See *Figure 1*.
3. **Installing the Remote Receiver to a Wall Mount:**
 - Secure the Remote Receiver to the wall mount.
 - Use the screws provided to secure the face blade to the Remote Receiver. See *Figure 2*.

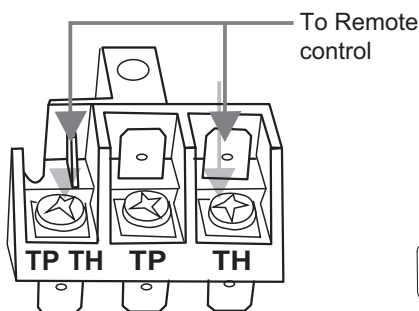

Figure 1

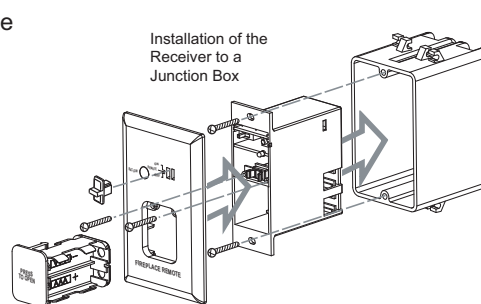

Figure 2

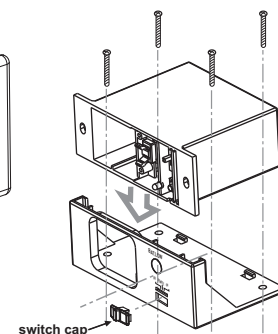

Figure 3

4. **Installing the Remote Receiver to a Fireplace:**
 - Secure the Fireplace Mounting plate to the base pan of the fireplace.
 - Slide the Remote Receiver into the fireplace mounting plate. See *Figure 3*.
5. Put the switch cap to the slide switch.
6. Slide the battery compartment into the Remote Receiver. See *Figure 4*.

- In order to prevent the Remote Receiver (fireplace installation only) from overheating, put a heat shield (option item) above the Remote Receiver. See *Figure 5*.

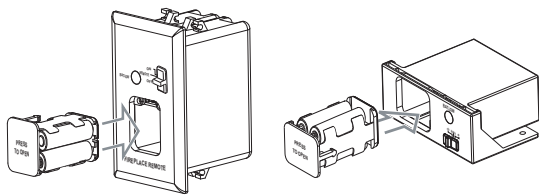

Figure 4

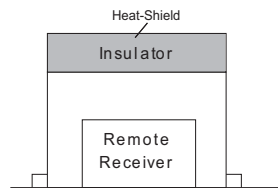

Figure 5

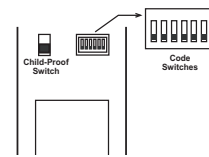

Figure 6

2.0 IMPORTANT SAFETY FEATURE:

You can set a private code into your system to prevent accidental operation by another transmitter nearby. See *Figure 6*.

2.1 Coding Instructions:

- Remove the cover on the back of the Remote Transmitter to expose the code switches. Slide the code switches to your choice of ON or OFF positions. **FACTORY SETTING IS ALL "OFF"**.
- Make sure the slide switch on the Remote Receiver is at OFF position.
- Keep the Remote Transmitter and the Remote Receiver within 2-10 feet.
- Slide the slide switch on the Remote Receiver to REMOTE position.
- Install fresh AAA alkaline batteries into the Remote Transmitter.
- Press any button on the Remote Transmitter, the Remote Receiver will produce a 'beep' sound when it receives the code from the Remote Transmitter.
- If you do not hear a 'beep' sound from the Remote Receiver, remove the batteries from the Remote Transmitter and slide the slide switch on the remote receiver to OFF position, Wait for 1 minute, and repeat step 2 to 6.
- Replace the cover of the Remote Transmitter and the Receiver. The system is now ready to operate.

FCC Requirements

Warning : Changes or modifications to this unit not expressly approved by the party responsible for compliance could void the user authority to operate the equipment. This equipment has been tested and found to comply with the limits for a Class B digital device, pursuant to Part 15 to the FCC Rules. These limits are designed to provide reasonable protection against harmful interference in a residential installation.

This equipment generates, uses, and can radiate radio frequency energy and, if not installed and used in accordance with the instructions, may cause harmful interference to radio communications. However, there is no guarantee that interference will not occur in a particular installation. If this equipment does cause harmful interference to radio or television reception, which can be determined by turning the equipment off and on, the user is encouraged to try to correct the interference by one or more of the following measures:

- Reorient or relocate the receiver antenna.
- Increase the separation between the equipment and receiver.
- Connect the equipment into an outlet on a circuit different from that to which the receiver is connected.
- Consult the dealer or an experienced radio TV technician for help.

This device complies with Part 15 of the FCC Rules.

Operation is subject to the following two conditions:

- (1) This device may not cause harmful interference, and
- (2) This device must accept any interference received, including interference that may cause undesired operation.

Canadian Equipment Requirements

This digital apparatus does not exceed the (class A/Class B)* limits for radio noise emissions from digital apparatus set out in the Radio Interference Regulations of the Canadian Department of Communications. Le present appareil numerique n'emet pas de bruits radioelectriques depassant les limites applicables aux appareils numeriques (de la class A/de la class B)* prescrites dans le Reglement sur le brouillage radioelectrique edicte par le ministere des Communications du Canada.

This device complies with RSS-210 of Industry and Science Canada. Operation is subject to the following two conditions: (1) this device may not cause interference, and (2) this device must accept any interference, including interference that may cause undesired operation of the device.

All wiring should be done by a qualified electrician and shall be in compliance with local codes and with the National Electric Code ANSI/NFPA No. 70-current (In the United States), or with the current CSA C22.1 Canadian Electric Code (in Canada).