

Instruction Manual

RPWL220A Wireless MyChime™ Bell Push

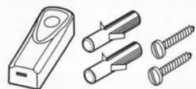

Safety

Always follow the manufacturer's advice when using power tools and wear suitable protective equipment (e.g. safety goggles) when drilling holes. Before drilling holes in walls, check for hidden electrical cables or water pipes. The use of a cable/pipe locator may be advisable if in doubt.

Installation Guide

1. Open bell push & insert batteries (2 AAA-not included).

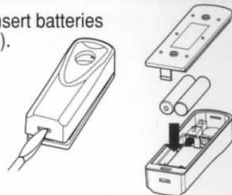

2. Choose a code between 1 & 16. Apply the same code for bell push and chime.

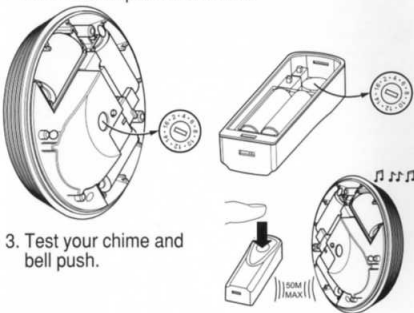

3. Test your chime and bell push.

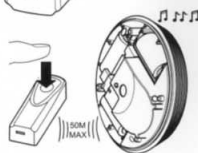

Selecting The Tune For Your Bell Push

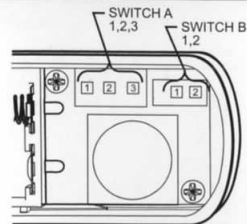

Switch A = Tunes	Switch B Position 1	Switch B Position 2
3=Chime tunes	Plays the same selected tune	Plays your list of songs one after the other
2	Westminster 8 note	Westminster 8 note
1	Westminster 3 note	Westminster 3 note

To change your tune	Switch B Position 2 to play through your list of tunes by pressing the push until desired tune is reached. Then,	Switch B Position 1 to select desired tune
------------------------	------------------------------------------------------------------------------------------------------------------------------------	-----------------------------------------------------

Any additional bell pushes can be set to either one of the remaining tune selections.
Note: If Switch B position 1 is selected for pushes prior to any additional, that setting will apply to all additional pushes.

Mounting Your Bell Push Button

Drill two 1/4" mounting holes for the push back plate. Do not mount on or next to a metal surface.

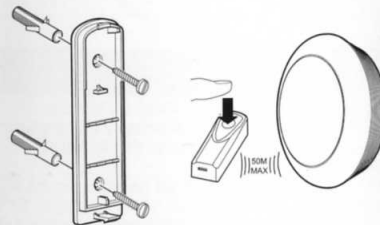

Dense walls and metal can reduce range. Before final installation, adjust distance and position between bell push and chime while operating the push to optimize the chime within your environment.

Troubleshooting

Chime does not work...

- Check that the batteries are the correct type. Only use alkaline batteries.
- Check that the batteries are fitted correctly (polarity correct).
- Check that the batteries are not loose.
- The chime could be out of range of the bell push.
- Check that the bell push channel switch and the chime channel switch are in the same position. See instruction in step 2.

Chime does not play tune selected...

- Ensure you have selected the right options. See instructions.

Disposal & Recycling

Batteries and waste electrical products should not be disposed of with household waste. Please recycle where these facilities exist. Check with your local authority or retailer for recycling advice.

Guarantee

Honeywell guarantees this product for 1 year from the date of purchase. Proof of purchase is required; this does not affect your statutory rights. If you require further information about your product, call the Honeywell helpline at 1-800-468-1502.

Declaration

Honeywell hereby declares that this product complies with Part 15 of the FCC rules and Industrial Canada standards.

This device operation is subject to the following two conditions:

- (1) This device may not cause harmful interference, and
- (2) This device must accept any interference received, including interference that may cause undesired operation.

Caution: Changes or modifications not expressly approved by the party responsible for regulatory compliance could void the users authority to operate the equipment.