

INSTALLATION INSTRUCTIONS



TSSC-FOB - Installation and Setup Guide

WIRELESS KEY TRANSMITTER FOR USE WITH TSSC

GENERAL INFORMATION

The Wireless Key is a portable wireless transmitter for use only with TSSC-BASE.

Buttons are typically used for arming and disarming, but can be programmed for any appropriate zone response.

- To activate a programmed function press and hold the appropriate key(s) until the LED begins to flash (about 1/2 second).
- The factory-installed replaceable lithium battery provides power for up to 5 years.

The Wireless Key transmitter supports all eight (8) functions and has a high security (encrypted) mode that sends rolling-code encrypted messaging to the RF receiver.

ENROLLING THE TSSC-FOB

For complete details on how to enroll the Wireless Key transmitter, access the TSSC Installer App (<https://portal.adtpulse.com/activation>).

When enrolling, note the following:

- Each Wireless Key transmitter has two unique serial numbers assigned during manufacture.
- Each button on the Wireless Key also has a distinct "loop" number (refer to the Loop Number diagram above) that you must program into the control during installation.

NOTE: Programming the Loop Number(s) can only be done through the TSSC Installer App.

NOTE: Serial #2 is one (1) digit higher than serial #1, which is printed on the rear of the transmitter.

USING HIGH SECURITY MODE IN TSSC-FOB

Activate High Security mode in the TSSC Installer App. Activation syncs the Wireless Key with the security system.

ASSIGNING A WIRELESS KEY TO A USER

If the Wireless Key is assigned to arm and disarm the system, the TSSC Installer App forces user assignment. After enrollment, follow the instructions in the TSSC Installer App.

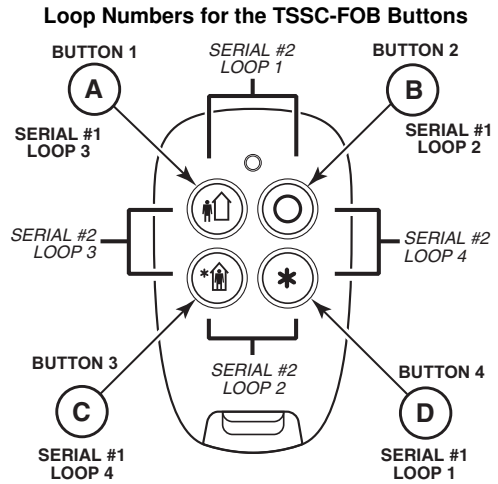

Using a Button: To activate a programmed function, press and hold the appropriate buttons for at least one second or more. The LED will flash.

Note: The LED will continue flashing and transmissions will continue to be sent ONLY while the button is being pressed.

For Serial #2 functions: If 2 appropriate buttons are pressed together for about one second until the LED flashes and immediately released, the LED flashing will continue. This confirms the 2 button function was accepted.

tssc-001-V1

REPLACING THE BATTERY

The LED will not flash during transmission if the battery is low. Replace the battery as follows.

1. Remove the screw from the case back and remove the case back.
2. Insert the blade of a small screwdriver under the battery as shown.
3. Twist the screwdriver to release the battery.
4. With the Positive (+) end of a new battery facing UP, insert the battery as shown, sliding it under the gold tab, then pressing down to snap into place.

IMPORTANT: Positive (+) end must face up.

Use Panasonic CR2032, Duracell DL2032, or SENER CR2032 lithium battery only.

5. Replace the case back and replace the screw to secure the case.



- Improper installation will result in damage to the battery.
- Do not remove the printed circuit board.

Failure of Replaceable Batteries

This Wireless Key is designed to provide several years of battery life under normal conditions. The expected battery life is a function of the device environment, usage and type. Ambient conditions such as high humidity, high or low temperatures, or large temperature fluctuations may reduce the expected battery life.

If the batteries need to be replaced, this device reports a low battery condition to the Base unit as a trouble condition when a button is pressed. In addition the LED will not flash when a button is pressed. However, if the device is unused for a long period of time, it may fail to operate as expected. Regular testing and maintenance will keep the system in good operating condition for the lifetime of the product.

IMPORTANT! This Wireless Key is intended as a convenience to the user and should not be considered as a life safety device.

SPECIFICATIONS

Unit Dimensions: 2.33" x 1.33" x 0.54" (59.2mm x 33.8mm x 14mm)

Battery: 3V, 210mAh, Panasonic CR2032, Duracell DL2032, or SENER CR2032

WARRANTY INFORMATION

For the latest warranty information, please go to: <http://www.security.honeywell.com/hsc/resources/wa>
Refer to the Installation Instructions for the TSSC-BASE with which this device is used for limitations of the entire Alarm System.

IMPORTANT SECURITY NOTICE

Please inform the User about the security importance of their wireless key, and what to do if it is lost. Explain that the wireless key is similar to their keys or access card. If lost or stolen, another person can compromise their security system. They should immediately notify the Dealer/Installer of a lost or stolen wireless key. The Dealer/Installer will then remove the wireless key programming from the security system.

FEDERAL COMMUNICATIONS COMMISSION STATEMENTS

The user shall not make any changes or modifications to the equipment unless authorized by the installation Instructions or User's Manual. Unauthorized changes or modifications could void the user's authority to operate the equipment.

FCC/IC STATEMENT

This device complies with Part 15 of FCC Rules, and RSS-210 of IC. Operation is subject to the following two conditions: (1) This device may not cause harmful interference, and (2) This device must accept any interference received, including interference that may cause undesired operation.

Cet appareil est conforme à la partie 15 des règles de la FCC & de RSS-210 des industries Canada. Son fonctionnement est soumis aux conditions suivantes: (1) Cet appareil ne doit pas causer d'interférences nuisibles. (2) Cet appareil doit accepter toute interférence reçue y compris les interférences causant une réception indésirable.

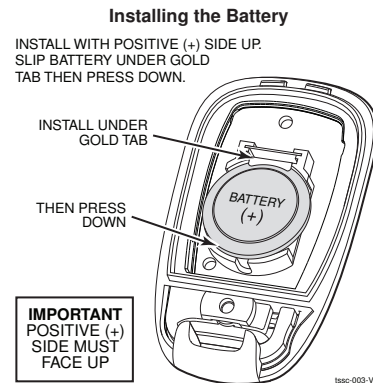
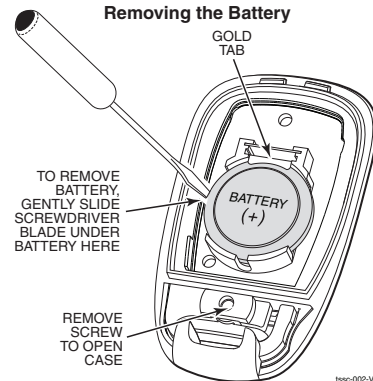

The FCC ID and IC Certification Number can be found in the battery compartment.



800-13960V2 3/16 Rev. A



ADT Security Services
1501 Yamato Rd
Boca Raton, FL 33431
Copyright © 2013