

## INSTALLATION AND SETUP GUIDE

### GENERAL INFORMATION

The 5834 key transmitter is a portable wireless transmitter for use only with wireless alarm systems that support 5800 Series receivers. Note the following:

- Buttons are typically used for arming and disarming, but can be programmed for any zone response.
- A button must be pressed and held for at least 1/2 second to activate the transmitter. This feature minimizes the possibility of accidental transmissions.
- The factory-installed replaceable lithium battery provides power for up to five (5) years.
- The 5834-4 transmitter provides up to eight (8) functions and has an optional high security (encrypted) mode that sends rolling-code encrypted messaging to the RF receiver.

**High Security Mode Note:** If used in high security mode, must be used with a receiver or control that supports high security mode. i.e., 5881EN, 5883, 6150RF, or 6160RF receiver or a LYNXR Series control panel (Revision 13.1 or higher).

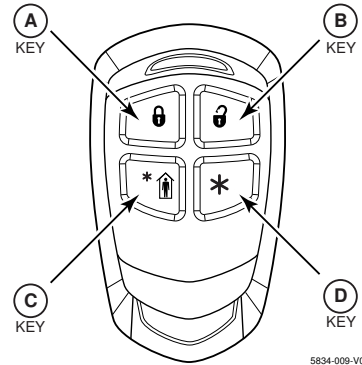

**5834-4  
4-Button Transmitter**

**Using a Button:** To activate a programmed function, press and hold the appropriate key(s) for at least 1/2 second.

### PROGRAMMING

For complete details on how to program the transmitter at the control panel, see the control unit's Installation Instructions. When programming, note the following:

- Each 5834 transmitter has two unique serial numbers assigned during manufacture.
- Each button on the unit also has a distinct "loop" number (refer to Loop Number diagrams below) that you must program into the control panel during installation.
- Assign each button to an individual zone and designate the Input Type as "BR" (Button Type RF).
- When prompted for the serial number, press and release the appropriate button twice, or, manually enter the serial number at the keypad.

**NOTE:** Serial #2 is one (1) digit higher than serial #1, which is printed on the rear of the transmitter.

- To enroll serial number 1 for use in High Security mode, simultaneously press and hold the **A - B - C** buttons  
To enroll serial number 2 for use in High Security mode, simultaneously press and hold the **B - C - D** buttons

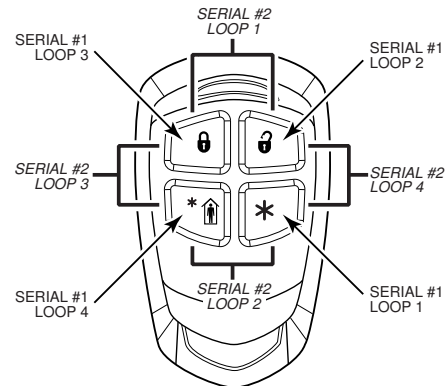

**NOTE**

- SERIAL #1 FUNCTIONS ACTIVATE WHEN THE RESPECTIVE BUTTON IS HELD DOWN AT LEAST 1/2 SECOND.
- SERIAL #2 FUNCTIONS ACTIVATE WHEN THE TWO RESPECTIVE SERIAL #2 BUTTONS ARE PRESSED AT THE SAME TIME AND HELD DOWN AT LEAST 1/2 SECOND.

**Loop Numbers for the 5834 Keyfob Buttons**

### SELECTING STANDARD OR HIGH-SECURITY MODE



If used with LYNXR Series controls earlier than Revision 13.1, the Standard Mode must be selected.

To select Standard or High Security mode, simultaneously press and hold the indicated buttons for five seconds.

For Standard Mode	<b>B - C - D</b>
For High-Security Mode	<b>A - C - D</b>

The LED flashes green when transmitting in Standard Mode and red when transmitting in High-Security Mode.

### ASSIGNING A WIRELESS KEY TO A USER

- On most control panels, if the wireless key is assigned to arm and disarm the system, you must assign it to a user in order for it to operate. This is accomplished through User Code programming at the control panel. See the control panel's Installation and Setup Guide for specific instructions on programming User Codes. The table on the next page summarizes the procedures.
- If you are programming arming and disarming functions on both serial numbers, each serial number must be assigned to a separate user.

### On Vista 32/40/50/50P/100, and up

You must assign a user to the button in order for it to operate.

To assign a user number to the Arm/Disarm button:

1. Enter [4-digit User Code] + [8] + [User No.] + [4-digit new User Code].
2. Answer Yes or No to the "Open/Close Report ?" question.
3. Answer Yes to the "RF Button ?" question.
4. Enter the zone number assigned to the Arm/Disarm button.
5. Keypad shows the summary of user information on its display.
6. Test Arm/Disarm button to make sure it operates correctly.

### REPLACING THE BATTERY

The LED will not flash during transmission if the battery is low. Replace the battery as follows.

1. Remove the screw from the case back, then remove the case back.
2. Insert the blade of a small screwdriver under the battery as shown below.
3. Twist the screwdriver to release the battery.
4. With the Positive (+) end of a new battery facing UP, insert the battery as shown, sliding it under the gold tab, then pressing down to snap into place.

**IMPORTANT:** Positive (+) end must face up.

Use Maxell CR2032 or Duracell DL2032 lithium battery only.

5. Replace the case back and replace the screw to secure the case.



- **Improper installation will result in damage to the battery.**
- **Do not remove the printed circuit board.**

### Failure of Replaceable Batteries

This wireless key has been designed to provide several years of battery life under normal conditions. The expected battery life is a function of the device environment, usage and type. Ambient conditions such as high humidity, high or low temperatures, or large temperature fluctuations may reduce the expected battery life.

This device will report a low battery condition to the control panel as a trouble condition, when the batteries need to be replaced. In addition the LED will not flash when a button is pressed. However, if the device is unused for a long period of time, it may fail to operate as expected. Regular testing and maintenance will keep the system in good operating condition for the lifetime of the product.

**IMPORTANT!** This wireless key is intended as a convenience to the user and should not be considered as a life safety device. If life safety is important, please select a supervised wireless key (e.g. type 5802MN).

### WARRANTY INFORMATION

For the latest warranty information, please go to:  
<http://www.security.honeywell.com/hsc/resources/wa/index.html>

### On Vista-20P/15P/10P and variants

You must assign a user to the button in order for it to operate, and must enter a sequence of keystrokes as described below.

**NOTE:** There is a two-second timeout for keystroke commands on Vista P series panels, therefore you must enter the keystrokes as quickly as possible.

1. Enter [4-digit Master Code] + [8] + [User Number] + [# 4] + [two digit zone number] assigned to the job.
2. Test Arm/Disarm and other functions to confirm proper operation.

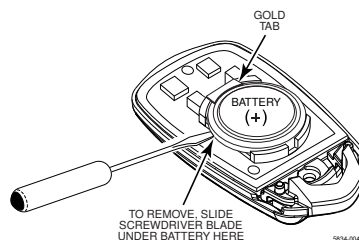

### Removing the Battery

INSTALL WITH POSITIVE (+) SIDE UP. SLIP BATTERY UNDER GOLD TAB THEN PRESS DOWN

INSTALL UNDER GOLD TAB THEN PRESS DOWN

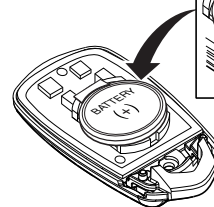

### Installing the Battery

### SPECIFICATIONS

**Unit Dimensions:** 2.25" x 1.25" x 0.5"  
(57mm x 31.75mm x 12.7mm)

**Battery:** 3V, 210mAh, Maxell CR2032, Duracell DL2032

REFER TO THE INSTALLATION INSTRUCTIONS FOR THE CONTROL WITH WHICH THIS DEVICE IS USED FOR LIMITATIONS OF THE ENTIRE ALARM SYSTEM.

### FEDERAL COMMUNICATIONS COMMISSION STATEMENTS:

The user shall not make any changes or modifications to the equipment unless authorized by the installation Instructions or User's Manual. Unauthorized changes or modifications could void the user's authority to operate the equipment.

### FCC NOTICE

This device complies with Part 15 of FCC Rules, and RSS 210 of IC. Operation is subject to the following two conditions: (1) This device may not cause harmful interference, and (2) This device must accept any interference received, including interference that may cause undesired operation.

Cet appareil est conforme à la partie 15 des règles de la FCC & de RSS 210 des industries Canada. Son fonctionnement est soumis aux conditions suivantes: (1) Cet appareil ne doit pas causer d'interférences nuisibles. (2) Cet appareil doit accepter toute interférence reçue y compris les interférences causant une réception indésirable.



800-05637 7/10 Rev. A

**Honeywell**

2 Corporate Center Drive, Suite 100  
P.O. Box 9040, Melville, NY 11747

Copyright © 2010 Honeywell International Inc.  
[www.honeywell.com/security](http://www.honeywell.com/security)