

This bi-directional wireless keyfob is intended for use with Honeywell controls that support SiX™ series devices.

PLEASE GO TO THE BOTTOM OF THE NEXT PAGE FOR FCC/IC AGENCY STATEMENTS

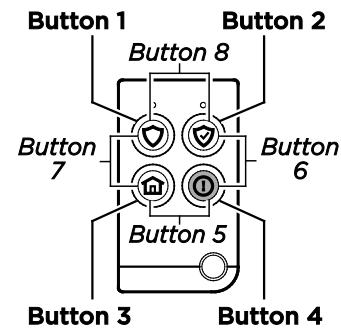

Enroll and Program the RF6FOB

1. Set Lyric Smart Controller in Programming mode and go to the Keys enrollment screen.
2. Select the appropriate Key Type for the application (i.e., 4 Button or 8 Button).
3. Press and release the top 2 buttons on RF6FOB to activate the enrollment process.
4. The LEDs alternately flash green during enrollment (typically, about 8 seconds, but may take longer, depending on signal strength between the RF6FOB and the control).
5. When the LEDs light solid green for 3 seconds and the RF6FOB emits a chirp, press the buttons again to complete enrollment.

Note: If enrollment is not confirmed, press and release the top two buttons again to restart the enrollment process.

Follow instructions in the Control's programming guide to program the RF6FOB services.

Note: once enrolled in a system, the RF6FOB cannot be used with another control panel until it is removed from the control panel. When removed from a system, the keyfob will revert to factory default settings.

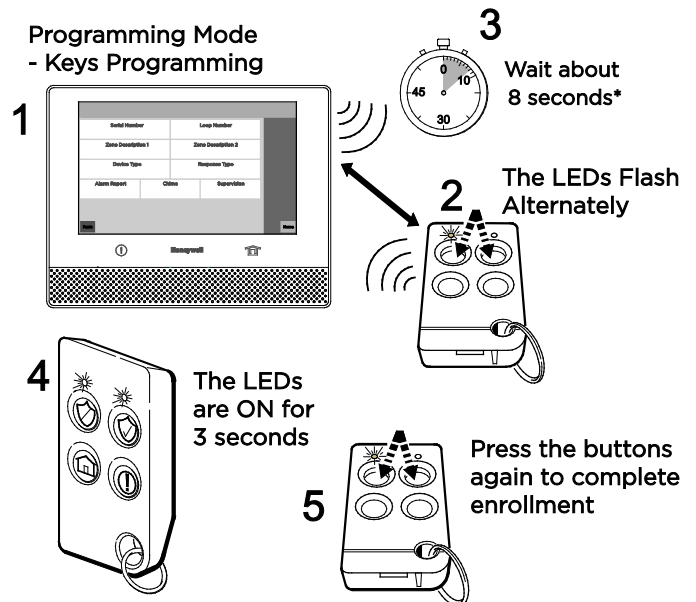

***Note:** Depending on the signal strength between the device and the control, the enrollment period may take longer than 8 seconds.

System Status and Sounder Indications

The RF6FOB can be used to control the Lyric Smart Controller system (e.g., arm, disarm the system); and receive system status information (armed status, not ready to arm, in alarm, in RF transmission mode, and more). Refer to the System Status Indications table for details.

System Status Indications Table		
LEDs	Sounder	System Status
RED ON steady for 2-3 seconds	2 beeps	System Armed (any mode)
RED Flashing slowly for 2-3 seconds	4 beeps	Alarm in progress
RED Flashing rapidly for 2-3 seconds	4 beeps	System in Panic Mode
GREEN ON steady for 2-3 seconds	1 beep	Disarmed, Ready to Arm
GREEN Flashing slowly for 2-3 seconds	silent	Disarmed, Not Ready to Arm
Single, quick GREEN flash	silent	RF Transmission
OFF	1 second beep	Not Hearing From Panel
GREEN LEDs Flash alternately for 8 seconds, then ON for 3 seconds	chirp for confirmation	RF6FOB Enrollment

Battery Replacement

When the battery is low, the LEDs do not flash during transmission. To replace the battery:

1. Remove the screw from the back housing.
2. Use a screwdriver to gently separate the front and back housings.
3. Use a screwdriver to gently remove the battery.
4. Replace with new Lithium, 3V, 210mAh battery as shown. Recommended replacement batteries: Maxell CR2032 or Duracell DL2032
5. Replace front housing.
6. Secure with the cover screw.

BATTERY CAUTION: Risk of fire, explosion and burns. Do not recharge, disassemble, heat above 212° F (100° C) or incinerate. Dispose of used batteries promptly. Keep away from children.

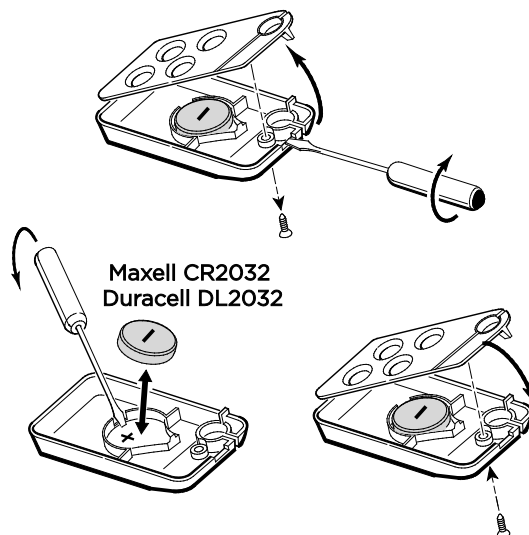

Specifications:

Battery: CR2032, DL2032

RF Frequency: 2.4GHz

Operating Temperature: 32° to 122° F / 0° - 50° C

Relative Humidity: 5 - 95%, non-condensing

Dimensions: 11 mm H x 65.5 mm L x 36 mm W / 0.43" H x 2.58" L x 1.42" W

Approval Listings:

RoHS

FCC / IC

ANSI/UL1023; ANSI/UL985

ULC ORD C1023; ULC S545

SIA CP-01

C-Tick



FEDERAL COMMUNICATIONS COMMISSION & INDUSTRY CANADA STATEMENTS

The user shall not make any changes or modifications to the equipment unless authorized by the Installation Instructions or User's Manual. Unauthorized changes or modifications could void the user's authority to operate the equipment.

FCC / IC STATEMENT

This device complies with Part 15 of the FCC Rules, and RSS-210 of Industry Canada. Operation is subject to the following two conditions: (1) This device may not cause harmful interference, and (2) This device must accept any interference received, including interference that may cause undesired operation.

Cet appareil est conforme à la partie 15 des règles de la FCC & de RSS-210 des Industries Canada. Son fonctionnement est soumis aux conditions suivantes: (1) Cet appareil ne doit pas causer d'interférences nuisibles. (2) Cet appareil doit accepter toute interférence reçue y compris les interférences causant une réception indésirable.

RF Exposure Warning - The antenna(s) used for this device must not be co-located or operating in conjunction with any other antenna or transmitter except in accordance with FCC multi-transmitter product procedures.

Attention - L'antenne (s) utilisé pour cet appareil ne doit pas être co-localisées ou opérant conjointement avec une autre antenne ou émetteur non conformant avec les procédures FCC pour les produits à multi-transmetteurs.

Support and Warranty

REFER TO THE INSTALLATION INSTRUCTIONS FOR THE CONTROL WITH WHICH THIS DEVICE IS USED, FOR DETAILS REGARDING LIMITATIONS OF THE ENTIRE ALARM SYSTEM.

IMPORTANT! This wireless key is intended as a convenience to the user and should not be considered as a life safety device.

For the latest U.S. warranty information, please go to www.honeywell.com/security/hsc/resources/wa or Please contact your local authorized Honeywell representative for product warranty information.