

Honeywell | Home

Installation Instructions

Wireless Doorbell Adapter

FPO

RPWL4045A2000

Preparation

In the box you will find

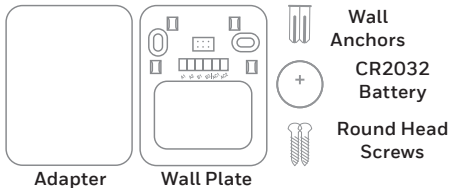

To install you will need



Safety

Turn Power OFF

To protect yourself and your equipment, turn off the power at the breaker box or switch that controls your heating/cooling system.



Before proceeding with the installation, please note the following safety warnings:

- Always follow the manufacturer's advice when using power tools and wear suitable protective equipment (e.g. safety goggles) when drilling holes, etc.
- Before drilling holes in walls, check for hidden electricity cables and water pipes. The use of a cable/pipe locator is advisable if in doubt.

For help please visit yourhome.honeywell.com or call 1-800-468-1502.

Choose a Location

Choose a location that is not near a heat source or on something that moves (like a door).

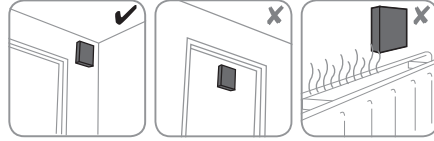

Install Adapter

1. Separate the adapter from the wall plate.
2. Open the battery cover in the wireless adapter and install the CR2032 battery.
3. Remove the existing doorbell chime from the wall.
4. Screw the wall plate to the wall using the included screws and anchors (if necessary).
Drill 1/4 inch holes for the anchors.

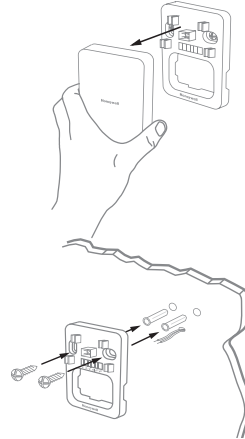

Wiring

1. Make sure at least 1/3-inch of each wire is exposed for easy insertion into the wire terminals.
2. Insert the wires into the appropriate terminals. Refer to the wiring diagrams below.
3. Connect the wires to the adapter terminals. You can connect one or two doorbell pushes and transformers.

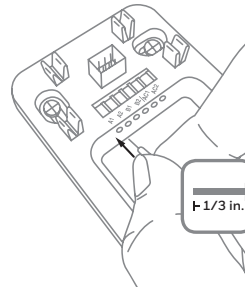

A1/A2	Connect to one push button
B1/B2	Connect to a second push button (if used)
AC1	Connect to one line voltage transformer (if used)
AC2	Not used

4. When the wiring is complete, turn the power back on.

Wiring 1 (A only) or 2 (A and B) Pushes

Wiring 1 (A only) or 2 (A and B) Pushes with 1 Transformer

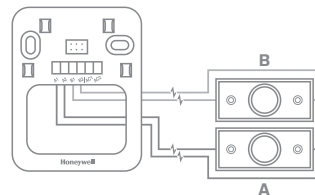
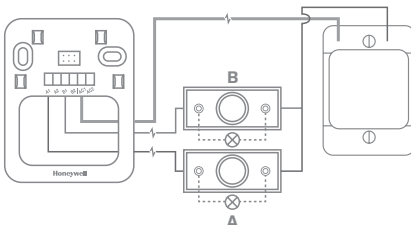

Pairing the Adapter and the Doorbell

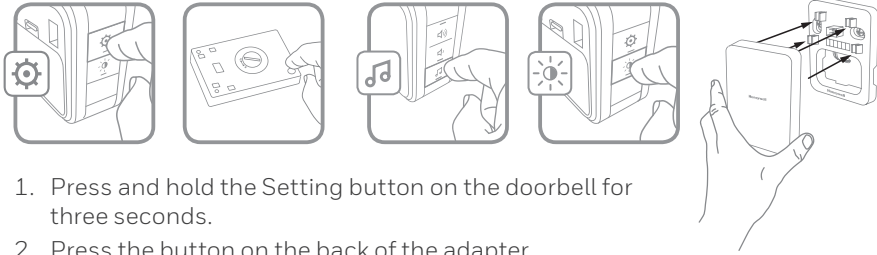

1. Press and hold the Setting button on the doorbell for three seconds.
2. Press the button on the back of the adapter.
3. Within 12 seconds of pressing the button on the adapter, press the Music button to select the ring for the doorbell.
4. Within 12 seconds of pressing the button on the adapter, press the Sunlight button to select a halo light color (if available) for that doorbell.
5. When the wiring is complete, snap the wireless adapter onto the wall plate.

Maintenance

Your adapter requires no maintenance except to periodically change the battery. If using the correct battery, its life should be approximately:

- Up to 2 years; replace with CR2032 lithium battery

Low Battery Notification

When the adapter battery is low an LED on the front of the adapter gives 3 short flashes until batteries are replaced.

Specifications

Doorbell Push	
Operating Temperature	14°F to 104°F (-10°C to 40°C)
RF Frequency US/Canada	916.8 MHz
Range (open field)	350 ft. (106 m)
Sound Level (typical)	-
RF Power	<1mW
Battery Type	CR2032
Battery Life (5 activations/day)	Up to 2 years



FCC Regulations

This device complies with part 15 of the FCC Rules. Operation is subject to the following two conditions: (1) This device may not cause harmful interference, and (2) this device must accept any interference received, including interference that may cause undesired operation.

The grantee is not responsible for any changes or modifications not expressly approved by the party responsible for compliance. Such modifications could void the user's authority to operate the equipment.

This equipment has been tested and found to comply with the limits for a Class B digital device, pursuant to part 15 of the FCC Rules. These limits are designed to provide reasonable protection against harmful interference in a residential installation. This equipment generates, uses and can radiate radio frequency energy and, if not installed and used in accordance with the instructions, may cause harmful interference to radio communications. However, there is no guarantee that interference will not occur in a particular installation. If this equipment does cause harmful interference to radio or television reception, which can be determined by turning the equipment off and on, the user is encouraged to try to correct the interference by one or more of the following measures:

- Reorient or relocate the receiving antenna.
- Increase the separation between the equipment and receiver.
- Connect the equipment into an outlet on a circuit different from that to which the receiver is connected.
- Consult the dealer or an experienced radio/TV technician for help.

This transmitter must not be co-located or operating in conjunction with any other antenna or transmitter. This equipment should be installed and operated with a minimum distance of 20 millimeters between the radiator and your body.

FCC ID: HS9-RPWL4045A

IC Regulations

CAN ICES-3(B)/ NMB-3(B)

This device complies with Industry Canada licence-exempt RSS standard(s). Operation is subject to the following two conditions: (1) this device may not cause interference, and (2) this device must accept any interference, including interference that may cause undesired operation of the device.

CAN ICES-3(B)/NMB-3(B)

The device meets the exemption from the routine evaluation limits in section 2.5 of RSS 102 and compliance with RSS-102 RF exposure, users can obtain Canadian information on RF exposure and compliance.

This transmitter must not be co-located or operating in conjunction with any other antenna or transmitter. This equipment should be installed and operated with a minimum distance of 20 millimeters between the radiator and your body.

IC ID: 573R-RPWL4045A

Warranty

1-year limited warranty

Honeywell warrants this product, excluding battery, to be free from defects in workmanship or materials, under normal use and service, for a period of one (1) year from the date of first purchase by the original purchaser. If at any time during the warranty period the product is determined to be defective due to workmanship or materials, Honeywell shall repair or replace it (at Honeywell's option).

If the product is defective,

- return it, with a bill of sale or other dated proof of purchase, to the place from which you purchased it; or
- call Honeywell Customer Care at 1-800-468-1502. Customer Care will make the determination whether the product should be returned to the following address:

Honeywell Return Goods, Dock 4 MN10-3860, 1885 Douglas Dr. N., Golden Valley, MN 55422, or whether a replacement product can be sent to you.

This warranty does not cover removal or reinstallation costs. This warranty shall not apply if it is shown by Honeywell that the defect was caused by damage which occurred while the product was in the possession of a consumer.

Honeywell's sole responsibility shall be to repair or replace the product within the terms stated above. HONEYWELL SHALL NOT BE LIABLE FOR ANY LOSS OR DAMAGE OF ANY KIND, INCLUDING ANY INCIDENTAL OR CONSEQUENTIAL DAMAGES RESULTING, DIRECTLY OR INDIRECTLY, FROM ANY BREACH OF ANY WARRANTY, EXPRESS OR IMPLIED, OR ANY OTHER FAILURE OF THIS PRODUCT. Some states do not allow the exclusion or limitation of incidental or consequential damages, so this limitation may not apply to you.

THIS WARRANTY IS THE ONLY EXPRESS WARRANTY HONEYWELL MAKES ON THIS PRODUCT. THE DURATION OF ANY IMPLIED WARRANTIES, INCLUDING THE WARRANTIES OF MERCHANTABILITY AND FITNESS FOR A PARTICULAR PURPOSE, IS HEREBY LIMITED TO THE ONE YEAR DURATION OF THIS WARRANTY. Some states do not allow limitations on how long an implied warranty lasts, so the above limitation may not apply to you.

This warranty gives you specific legal rights, and you may have other rights which vary from state to state.

If you have any questions concerning this warranty, please write Honeywell Customer Care, 1985 Douglas Dr, Golden Valley, MN 55422 or call 1-800-468-1502.

Automation and Control Solutions

Honeywell International Inc.

1985 Douglas Drive North

Golden Valley, MN 55422

yourhome.honeywell.com

® U.S. Registered Trademark.
© 2016 Honeywell International Inc.
33-00195EFS-01 M.S. 02-16
Printed in U.S.A.

Honeywell



33-00195EFS-01



Honeywell | Home

Installation Instructions

Wireless Doorbell Adapter

FPO

RPWL4045/2000

Preparation

In the box you will find

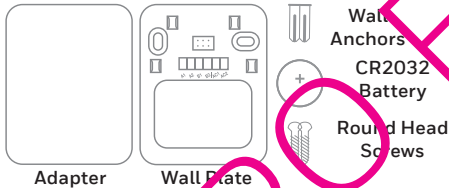

To install you will need

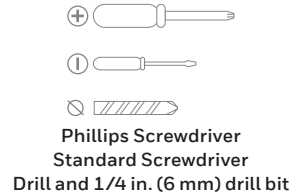

Safety

Turn Power OFF

To protect yourself and your equipment, turn off the power at the breaker box or switch that controls your heating/cooling system.



Before proceeding with the installation, please note the following safety warnings:

- Always follow the manufacturer's advice when using power tools and wear suitable protective equipment (e.g. safety goggles) when drilling holes, etc.
- Before drilling holes in walls, check for hidden electricity cables and water pipes. The use of a cable/pipe locator is advisable if in doubt.

For help please visit yourhome.honeywell.com or call 1-800-468-1502.

Choose a Location

Choose a location that is not near a heat source or on something that moves (like a door).

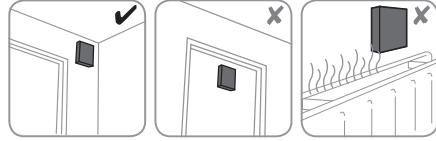

Install Adapter

1. Separate the adapter from the wall plate.
2. Open the battery cover in the wireless adapter and install the CR2032 battery.
3. Remove the existing doorbell chime from the wall.
4. Screw the wall plate to the wall using the included screws and anchors (if necessary).

Drill 1/4 inch holes for the anchors.

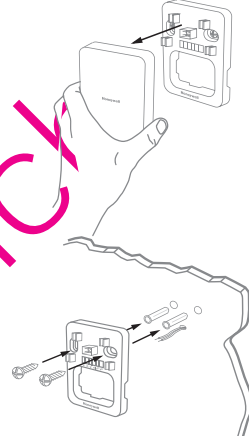

Wiring

1. Make sure at least 1/3-inch of each wire is exposed for easy insertion into the wire terminals.
2. Insert the wires into the appropriate terminals. Refer to the wiring diagrams below.
3. Connect the wires to the adapter terminals. You can connect one or two doorbell pushes and transformers.

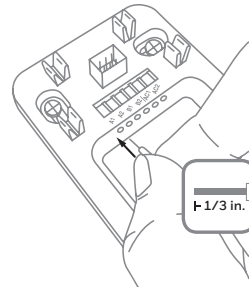

A1/A2	Connect to one push button
B1/B2	Connect to a second push button (if used)
AC1	Connect to one line voltage transformer (if used)
AC2	Not used

4. When the wiring is complete, turn the power back on.

Wiring 1 (A only) or 2 (A and B) Pushes

Wiring 1 (A only) or 2 (A and B) Pushes with 1 Transformer

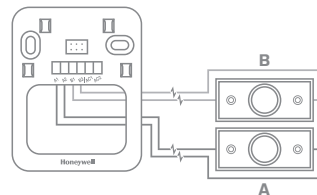
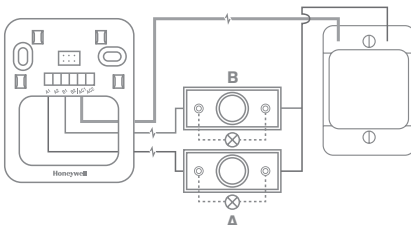

Pairing the Adapter and the Doorbell

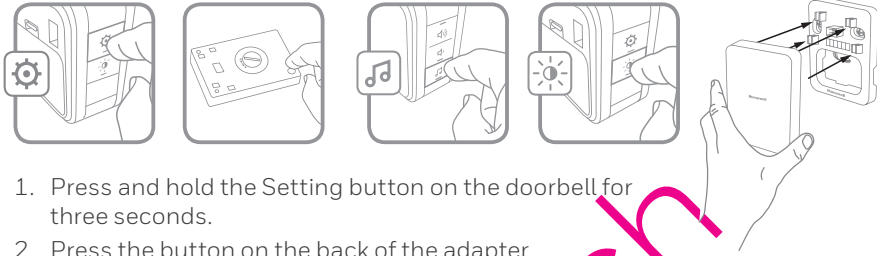

1. Press and hold the Setting button on the doorbell for three seconds.
2. Press the button on the back of the adapter.
3. Within 12 seconds of pressing the button on the adapter, press the Music button to select the ring for the doorbell.
4. Within 12 seconds of pressing the button on the adapter, press the Sunlight button to select a halo light color (if available) for that doorbell.
5. When the wiring is complete, snap the wireless adapter onto the wall plate.

Maintenance

Your adapter requires no maintenance except to periodically change the battery. If using the correct battery, its life should be approximately:

- Up to 2 years; replace with CR2032 lithium battery

Low Battery Notification

When the adapter battery is low an LED on the front of the adapter gives 3 short flashes until batteries are replaced.

Specifications

Doorbell Push	
Operating Temperature	14°F to 104°F (-10°C to 40°C)
RF Frequency US/Canada	916.8 MHz
Range (open field)	350 ft. (106 m)
Sound Level (typical)	-
RF Power	<1mW
Battery Type	CR2032
Battery Life (5 activations/day)	Up to 2 years



Règlement de la FCC

Cet appareil est conforme à la partie 15 du règlement de la FCC. Son fonctionnement est soumis aux deux conditions suivantes: (1) Ce dispositif ne doit pas causer d'interférences nuisibles et (2) ce dispositif doit accepter toutes les interférences reçues, y compris celles pouvant causer un fonctionnement non souhaité.

Le bénéficiaire n'est pas responsable des changements et modifications non expressément approuvés par la partie responsable de la conformité. De telles modifications peuvent annuler le droit de l'utilisateur à utiliser l'équipement.

Cet équipement a été testé et est conforme aux limites des dispositifs numériques de Classe B, conformément à la Partie 15 du règlement de la FCC. Ces limites sont conçues pour fournir une protection raisonnable contre les interférences nuisibles dans une installation résidentielle. Cet équipement génère, utilise et peut émettre de l'énergie de radiofréquence, et s'il n'est pas installé et utilisé conformément aux instructions, peut causer des interférences nuisibles aux communications radio. Il n'y a toutefois aucune garantie qu'une interférence ne se produira pas dans une installation particulière. Si cet équipement cause des interférences nuisibles à la réception radio et télévision, ce qui peut être déterminé en éteignant le dispositif et en le rallumant en marche, il est recommandé à l'utilisateur de tenter de corriger l'interférence par l'une des mesures suivantes:

- Réorientez ou déplacez l'antenne réceptrice.
- Augmentez la séparation entre l'équipement et le récepteur.
- Branchez l'équipement dans la prise d'un circuit différent de celui auquel le récepteur est connecté.
- Consultez le distributeur ou un technicien radio/TV compétent pour obtenir de l'aide.

Cet émetteur ne doit pas être Co-placé ou ne fonctionnant en même temps qu'aucune autre antenne ou émetteur. Cet équipement devrait être installé et actionné avec une distance minimum de 20 millimètres entre le radiateur et votre corps.

FCC ID: HS9-RPWL4045A

Réglementation IC

CAN ICES-3(B)/ NMB-3(B)

Le présent appareil est conforme aux CNR d'Industrie Canada applicables aux appareils radio exempts de licence. L'exploitation est autorisée aux deux conditions suivantes: (1) il ne doit pas produire de brouillage et (2) l'utilisateur du dispositif doit être prêt à accepter tout brouillage radioélectrique reçu, même si ce brouillage est susceptible de compromettre le fonctionnement du dispositif.

Le dispositif rencontre l'exemption des limites de puissance d'évaluation dans la section 2.5 de RSS 102 et la conformité à l'exposition de RSS-102 rf, utilisateurs peut obtenir l'information canadienne sur l'exposition et la conformité de rf.

Cet émetteur ne doit pas être Co-placé ou ne fonctionnant en même temps qu'aucune autre antenne ou émetteur. Cet équipement devrait être installé et actionné avec une distance minimum de 20 millimètres entre le radiateur et votre corps.

IC ID: 573R-RPWL4045A

Garantie

Garantie limitée d'un an

Honeywell garantit ce produit, à l'exception des piles, contre tout défaut de pièce ou de main-d'œuvre, durant une période d'un (1) an à partir de la date d'achat initial par le consommateur d'origine si le produit est utilisé et entretenu convenablement. En cas de vice de pièce ou de main-d'œuvre pendant la période de garantie, Honeywell remplacera ou réparera le produit, à sa discrétion.

Si le produit est défectueux, (i) renvoyez-le avec la facture ou une autre preuve d'achat date au lieu d'achat; ou (ii) appelez le service à la clientèle de Honeywell en composant le 1-800-468-1502. Le service à la clientèle déterminera si le produit doit être retourné à l'adresse suivante: Honeywell Return Goods, Dock 4MN10-3860, 1885 Douglas Dr. N., Golden Valley, MN 55422, ou si un produit de remplacement peut vous être expédié.

La présente garantie ne couvre pas les frais de retrait ou de réinstallation. La présente garantie ne s'appliquera pas s'il est démontré par Honeywell que la défaillance est due à un endommagement du produit qui s'est produit lorsque le consommateur l'avait en sa possession.

La responsabilité exclusive de Honeywell se limite à réparer ou à remplacer le produit conformément aux modalités susmentionnées. HONEYWELL N'EST EN AUCUN CAS RESPONSABLE DES PERTES OU DOMMAGES, Y COMPRIS LES DOMMAGES INDIRECTS OU ACCESSOIRES DÉCOULANT DIRECTEMENT OU INDIRECTEMENT D'UNE VIOLATION QUELCONQUE D'UNE GARANTIE, EXPRESSE OU TACITE, APPLICABLE AU PRÉSENT PRODUIT, OU TOUTE AUTRE DÉFAILLANCE DU PRÉSENT PRODUIT. Certaines provinces ne permettent pas l'exclusion ou la restriction des dommages indirects ou accessoires et, par conséquent, la présente restriction peut ne pas s'appliquer.

CETTE GARANTIE EST LA SEULE GARANTIE EXPRESSE FAITE PAR HONEYWELL POUR CE PRODUIT. LA DURÉE DE TOUTE GARANTIE IMPLICITE, INCLUANT LES GARANTIES DE QUALITÉ MARCHANDE OU D'ADAPTATION À UNE UTILISATION PARTICULIÈRE, EST LIMITÉE PAR LES PRÉSENTES À LA PÉRIODE D'UNE ANNÉE DE LA PRÉSENTE GARANTIE. Certaines provinces ne permettent pas de limiter la durée des garanties tacites et, par conséquent, la présente limitation peut ne pas s'appliquer.

La présente garantie donne au consommateur des droits spécifiques et certains autres droits qui peuvent varier d'une province à l'autre.

Pour toute question concernant la présente garantie, prière d'écrire aux Services à la clientèle de Honeywell à l'adresse suivante: Honeywell Customer Relations, 1985 Douglas Dr, Golden Valley, MN 55422, ou encore composer le 1-800-468-1502.

Automation and Control Solutions

Honeywell International Inc.

1985 Douglas Drive North

Golden Valley, MN 55422

yourhome.honeywell.com

® U.S. Registered Trademark.
© 2016 Honeywell International Inc.
33-00195EFS-01 M.S. 02-16
Printed in U.S.A.

Honeywell



33-00195EFS-01



Honeywell | Home

Installation Instructions

Wireless Doorbell Adapter

FPO

RPWL4045A2000

Preparation

In the box you will find



Adapter

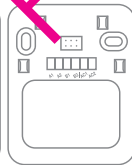

Wall Plate



Wall
Anchors
CR2032
Battery
Round Head
Screws

To install you will need



Phillips Screwdriver
Standard Screwdriver
Drill and 1/4 in. (6 mm) drill bit

Safety

Turn Power OFF

To protect yourself and your equipment, turn off the power at the breaker box or switch that controls your heating/cooling system.



Before proceeding with the installation, please note the following safety warnings:

- Always follow the manufacturer's advice when using power tools and wear suitable protective equipment (e.g. safety goggles) when drilling holes, etc.
- Before drilling holes in walls, check for hidden electricity cables and water pipes. The use of a cable/pipe locator is advisable if in doubt.

For help please visit yourhome.honeywell.com or call 1-800-468-1502.

Choose a Location

Choose a location that is not near a heat source or on something that moves (like a door).

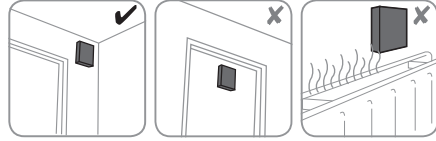

Install Adapter

1. Separate the adapter from the wall plate.
2. Open the battery cover in the wireless adapter and install the CR2032 battery.
3. Remove the existing doorbell chime from the wall.
4. Screw the wall plate to the wall using the included screws and anchors (if necessary).

Drill 1/4 inch holes for the anchors.



Wiring

1. Make sure at least 1/3-inch of each wire is exposed for easy insertion into the wire terminals.
2. Insert the wires into the appropriate terminals. Refer to the wiring diagrams below.
3. Connect the wires to the adapter terminals. You can connect one or two doorbell pushes and transformers.

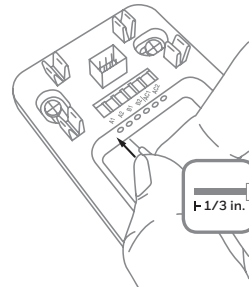

A1/A2	Connect to one push button
B1/B2	Connect to a second push button (if used)
AC1	Connect to one line voltage transformer (if used)
AC2	Not used

4. When the wiring is complete, turn the power back on.

Wiring 1 (A only) or 2 (A and B) Pushes

Wiring 1 (A only) or 2 (A and B) Pushes with 1 Transformer

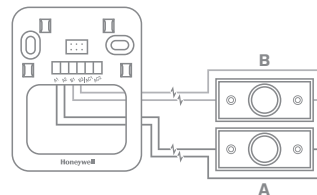
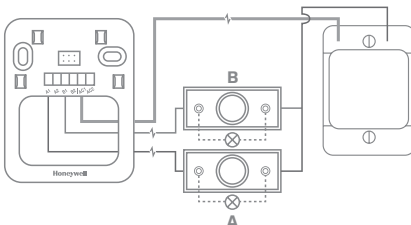

Pairing the Adapter and the Doorbell



1. Press and hold the Setting button on the doorbell for three seconds.
2. Press the button on the back of the adapter.
3. Within 12 seconds of pressing the button on the adapter, press the Music button to select the ring for the doorbell.
4. Within 12 seconds of pressing the button on the adapter, press the Sunlight button to select a halo light color (if available) for that doorbell.
5. When the wiring is complete, snap the wireless adapter onto the wall plate.

Maintenance

Your adapter requires no maintenance except to periodically change the battery. If using the correct battery, its life should be approximately:

- Up to 2 years; replace with CR2032 lithium battery

Low Battery Notification

When the adapter battery is low an LED on the front of the adapter gives 3 short flashes until batteries are replaced.

Specifications

Doorbell Push	
Operating Temperature	14°F to 104°F (-10°C to 40°C)
RF Frequency US/Canada	916.8 MHz
Range (open field)	350 ft. (106 m)
Sound Level (typical)	-
RF Power	<1mW
Battery Type	CR2032
Battery Life (5 activations/day)	Up to 2 years



Regulaciones FCC

Este dispositivo cumple con la Sección 15 de las regulaciones de la FCC. El funcionamiento está sujeto a las dos condiciones siguientes: (1) este dispositivo no debe causar interferencia perjudicial y (2) este dispositivo deberá aceptar cualquier interferencia que se reciba, incluyendo la interferencia que pudiese causar el funcionamiento no deseado.

El cesionario no es responsable de los cambios o modificaciones que no estén expresamente aprobados por la parte responsable del cumplimiento. Tales modificaciones podrían invalidar el derecho del usuario para hacer funcionar el equipo.

Este equipo fue probado y cumple con los límites de los dispositivos digitales clase B, conforme a la Sección 15 de las regulaciones de la FCC. Estos límites están diseñados para ofrecer una protección razonable contra la interferencia perjudicial en una instalación residencial. Este equipo genera, utiliza y puede irradiar energía de radiofrecuencia y, si no se instala y se utiliza según las instrucciones, puede producir una interferencia perjudicial en la comunicación radial. Sin embargo, no hay garantía de que no habrá interferencia en una instalación particular. Si este equipo produce una interferencia perjudicial en la recepción televisiva o radial, lo cual puede determinarse al apagar y encender el equipo, se recomienda que el usuario intente corregir la interferencia tomando una o más de las siguientes medidas:

- Vuelva a orientar o ubicar la antena receptora.
- Aumente la distancia entre el equipo y el receptor.
- Conecte el equipo a un tomacorriente en un circuito diferente a aquel en el que está conectado el receptor.
- Consulte con su distribuidor o con un técnico experto en radio/televisión para recibir ayuda.

Este transmisor no debe estar ubicado ni funcionando conjuntamente con cualquier otra antena o transmisor. Este equipo se debe instalar y hacer funcionar con una distancia mínima de 20 milímetros entre el radiador y su cuerpo.

FCC ID: HS9-RPWL4045A

Regulaciones IC

CAN ICES-3(B)/NMB-3(B)

Este dispositivo cumple con la(s) norma(s) RSS exentas de licencia de la industria de Canadá. El funcionamiento está sujeto a las dos condiciones siguientes: (1) es posible que este dispositivo no cause interferencia y (2) este dispositivo debe aceptar cualquier interferencia recibida, incluso la que puede producir un funcionamiento no deseado del dispositivo.

CAN ICES-3(B)/NMB-3(B)

El dispositivo cumple con la exención de los límites de la evaluación rutinaria de la sección 2.5 de RSS 102 y el cumplimiento con la exposición a RF RSS-102. Los usuarios pueden obtener más información canadiense sobre exposición y acatamiento de las normas de RF.

Este transmisor no debe estar ubicado ni funcionando conjuntamente con cualquier otra antena o transmisor. Este equipo se debe instalar y hacer funcionar con una distancia mínima de 20 milímetros entre el radiador y su cuerpo.

IC ID: 573R-RPWL4045A

Garantía

Garantía limitada de 1 año

Honeywell garantiza que este producto, excluyendo la batería, no tiene defectos en la mano de obra ni en los materiales en condiciones de uso y servicio normales durante un periodo de un (1) año desde la fecha de compra por parte del comprador original. Si en cualquier momento durante el periodo de vigencia de la garantía, se determina que el producto está defectuoso debido a la mano de obra o a los materiales, Honeywell lo reparará o reemplazará (a elección de Honeywell).

Si el producto está defectuoso (i) debido a, con una factura de venta o cualquier otro comprobante de compra con fecha, al lugar donde lo compró; o (ii) llame al Servicio de atención al cliente de Honeywell al 1 (800) 468 1502. En el Servicio de atención al cliente determinará si el producto debe ser devuelto a la siguiente dirección: Honeywell Return Goods, Dock 4 MN10-3860, 1885 Douglas Dr. N., Golden Valley, MN 55422, o si se le puede enviar un producto de reemplazo.

Esta garantía no cubre los gastos de remoción ni de reinstalación. Esta garantía no se aplicará si Honeywell demuestra que el defecto fue causado por daños que se produjeron mientras el producto estuvo en posesión de un consumidor.

La única responsabilidad de Honeywell será la de reparar o reemplazar el producto según los términos mencionados anteriormente. HONEYWELL NO SERÁ RESPONSABLE POR LA PÉRDIDA O EL DAÑO DE NINGÚN TIPO, INCLUYENDO LOS DAÑOS ACCIDENTALES O RESULTANTES DERIVADOS DIRECTA O INDIRECTAMENTE DEL INCUMPLIMIENTO DE LAS GARANTÍAS, EXPLÍCITAS O IMPLÍCITAS, O DE OTRAS FALLAS DE ESTE PRODUCTO. Algunos estados no permiten la exclusión o limitación de los daños accidentales o resultantes, por lo que esta limitación podría no aplicarse en su caso.

ESTA GARANTÍA ES LA ÚNICA GARANTÍA EXPRESA QUE HONEYWELL OTORGA SOBRE ESTE PRODUCTO. LA DURACIÓN DE CUALQUIERA DE LAS GARANTÍAS IMPLÍCITAS, INCLUIDAS LAS GARANTÍAS DE COMERCIABILIDAD E IDONEIDAD PARA UN FIN DETERMINADO, QUEDA, POR EL PRESENTE, LIMITADA A LA DURACIÓN DE UN AÑO DE ESTA GARANTÍA. Algunos estados no permiten limitaciones en relación a la duración de una garantía implícita, de manera que la limitación anterior puede no aplicarse en su caso.

Esta garantía le otorga derechos legales específicos, pero es posible que usted goce de otros derechos que varían de un estado a otro.

Si tiene preguntas acerca de esta garantía, escriba a Honeywell Customer Relations, 1985 Douglas Dr. Golden Valley, MN 55422 o llame al 1-800-468-1502.

Automation and Control Solutions

Honeywell International Inc.

1985 Douglas Drive North

Golden Valley, MN 55422

yourhome.honeywell.com

® U.S. Registered Trademark.
© 2016 Honeywell International Inc.
33-00195EFS-01 M.S. 02-16
Printed in U.S.A.

Honeywell



33-00195EFS-01

