

Honeywell Home



T5 Smart Thermostat

Programmable
Thermostat

Quick Install Guide



RCHT8610WF2006,
RCHT8610WF2014,
RCHT8610WF3005,
RCHT8612WF2005,
RCHT8612WF2015,
RCHT8612WF3006,
RTH8800WF2022,
Read before installing

For more information visit [honeywellhome.com](https://www.honeywellhome.com)

Included in your box:

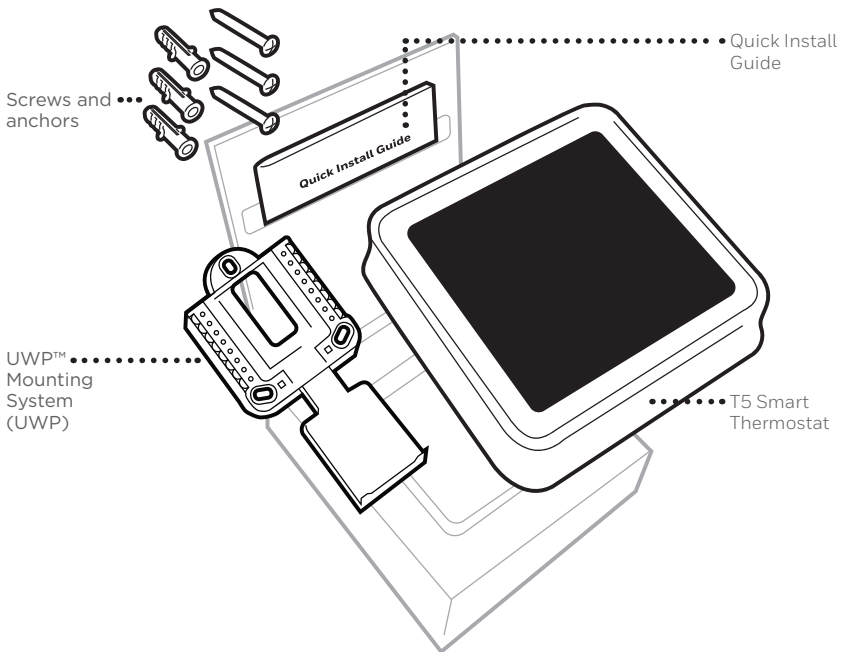

Get the most from T5 Smart Thermostat

Multiple programming options that fit your lifestyle:

-  1. **Location-Based scheduling** – The thermostat uses your smartphone's location to know when you're away, and saves you energy. Through geofence technology, it senses your return and helps make you comfortable upon arrival. You can always manually change your preset Home and Away temperature either on the thermostat or on the Resideo app.
2. **Smart scheduling** – Use a combination of geofencing and time scheduling to fit your busy, active lifestyle.
3. **Time-Based scheduling** – Program your thermostat for one week; each day (each day is a different schedule); Mon-Fri, Sat, Sun; or Mon-Fri, Sat-Sun. All days with four adjustable periods per day.
4. **No scheduling** – Control your comfort manually by adjusting temperature set points only.

Smart Alerts. Push notifications remind you of filter changes and warn you of extreme indoor temperatures.



Smart Response. Learns your heating and cooling system to deliver the optimal temperature at the right time.



Auto Change From Heat to Cool. Automatically determine if your home needs heating or cooling to provide maximum comfort.



Tools you will need:



Phillips screwdriver



Small flat head screwdriver



Pencil



Level

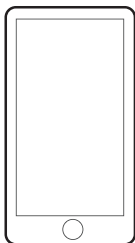

Smartphone
To install your thermostat and photograph existing wiring.



Home Wi-Fi Password



Resideo app
To configure your system and connect to your smartphone.

You may need:

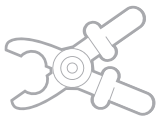

Wire stripper



Needle-nose pliers

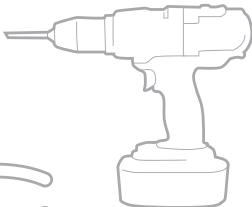

Drill and drill bit (7/32 in (5.6 mm))

**CAUTION: ELECTRICAL HAZARD**

Can cause electrical shock or equipment damage. Disconnect power before beginning installation.

**CAUTION: EQUIPMENT DAMAGE HAZARD**

Compressor protection is bypassed during testing. To prevent equipment damage, avoid cycling the compressor quickly.

**CAUTION: MERCURY NOTICE**

If this product is replacing a control that contains mercury in a sealed tube, do not place the old control in the trash. Contact your local waste management authority for instructions regarding recycling and proper disposal.

**REQUIRED: 24 VAC POWER (“C” WIRE)****CAUTION: ELECTRONIC WASTE NOTICE**

The product should not be disposed of with other household waste. Check for the nearest authorized collection centers or authorized recyclers. The correct disposal of end-of-life equipment will help prevent potential negative consequences for the environment and human health.

Compatibility

- Compatible with most heating, cooling, and heat pump systems
- Required: 24 VAC power (“C” wire)
- Does not work with electric baseboard heat (120-240V)
- Does not work with millivolt systems
- Does not support input (S terminals) for indoor and outdoor sensors
- Does not support relay (U terminals) for ventilation
- Android or iOS smartphone, tablet, or device

For help, contact:

WEB honeywellhome.com

PHONE 1-800-633-3991

SOCIAL Twitter: @Honeywell_Home, Facebook: Honeywell Home

Removing your old thermostat

1 Turn power OFF

 To protect yourself and your equipment, Turn off the power at the breaker box or switch that controls your heating/cooling system.

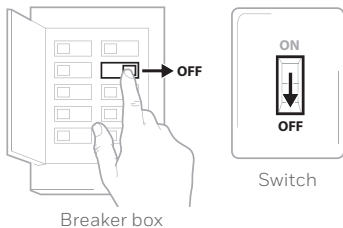

2 Check that your system is off

Change the temperature on your old thermostat. If you don't hear the system turn on within 5 minutes, the power is off.

Note: If you have a digital thermostat that has a blank display, skip this step.

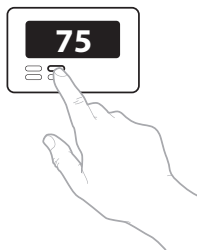

3 Remove your old thermostat from the wall plate

On most thermostats, you can take off the thermostat by grasping and gently pulling. Some thermostats may have screws, buttons, or clasps.

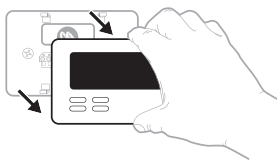

 **Do not remove any wires from your thermostat at this time!**

4 Make sure there are no 120/240V wires



Do you have thick black wires with wire nuts?

Is your thermostat 120V or higher?

If you answered yes to either of these questions, you have a line voltage system and the thermostat will not work.

If you are unsure visit:
honeywellhome.com

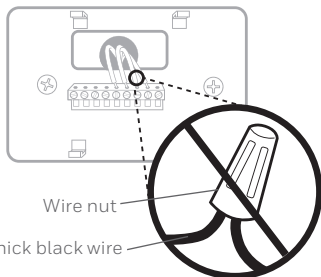

5 Take a picture of how your wiring looks right now

Be sure to include the letters next to the terminals where the wires are inserted. This will be a helpful reference when wiring your thermostat.

Tip: If the color of your wires has faded or if 2 terminals have the same wire color, use the wire labels provided in the package to label each wire.

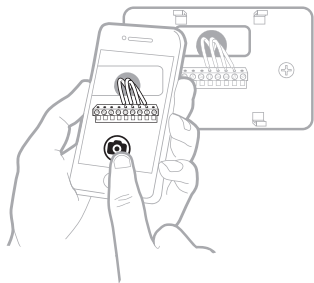

6 Remove any jumpers

A jumper connects one terminal to another terminal. It may look like a small staple or even a colored wire and must be removed before continuing. Use a screwdriver to release wires from terminals.

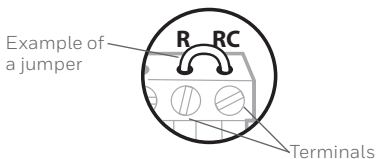

The thermostat does not need jumpers.

- 7 Record if you have wires in the following terminals**
Do not include jumpers as a part of your count. The thermostat does not need jumpers.

Terminal	Wire Color
<input type="checkbox"/> R	_____
<input type="checkbox"/> RH	_____
<input type="checkbox"/> Rc	_____

- 8 Write down the color of the wires**

Check mark the wires that are connected to terminals. Next to the check mark, write down the color of the wire. **Do not include jumpers as a part of your count.**

Check all that apply (Not all will apply):

Terminal	Wire Color	Terminal	Wire Color
<input type="checkbox"/> Y	_____	<input type="checkbox"/> A or L/A	_____
<input type="checkbox"/> Y2	_____	<input type="checkbox"/> O/B	_____
<input type="checkbox"/> G	_____	<input type="checkbox"/> W2 or AUX	_____
<input type="checkbox"/> C	Required	<input type="checkbox"/> E	_____
		<input type="checkbox"/> W	_____
		<input type="checkbox"/> K	_____

S and U terminals are not supported with this thermostat.

If there are wires in terminals that are not listed, you will need additional wiring support. Visit honeywellhome.com to find out if the thermostat will work for you.

9 Disconnect the wires and remove the old wall plate

Use a screwdriver to release wires from terminals.

Tip: To prevent wires from falling back into the wall, wrap the wires around a pencil.

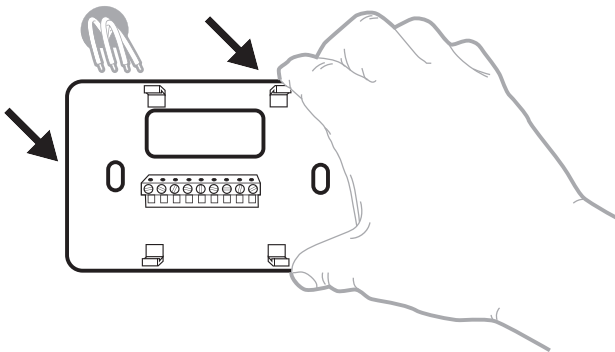

Installing your T5 Smart Thermostat

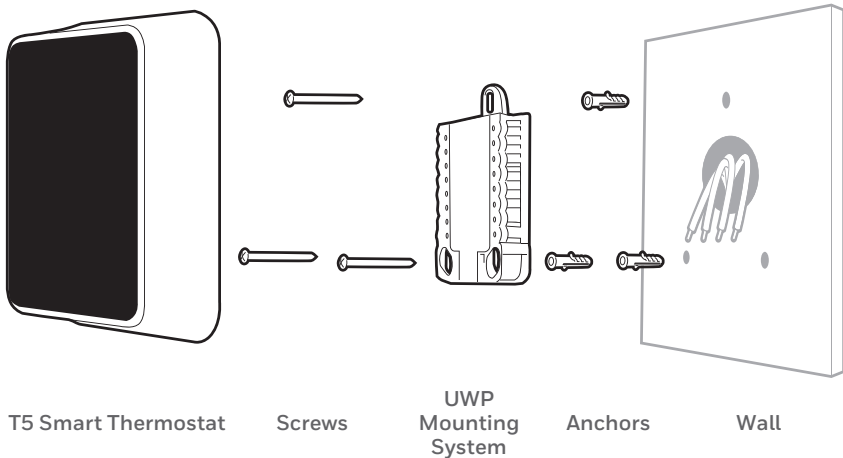

10 Bundle and insert wires through the UWP

Pull open the UWP and insert the bundle of wires through the back of the UWP.

Make sure at least **1/4-inch (6.4 mm)** of each wire is exposed for easy insertion into the wire terminals.

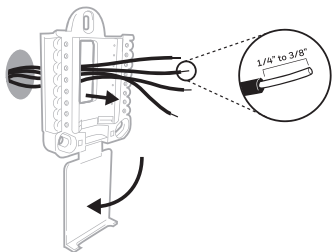

11 Insert the wall anchors

It is recommended that you use the wall anchors included in the box to mount your thermostat.

You can use the **UWP** to mark where you want to place the wall anchors.

- Level the wall plate.
- Mark the location of the wall anchors using a pencil.
- Drill the holes.
- Insert wall anchors.
- Make sure anchors are flush with wall.

Tip: Use a **7/32 (5.6 mm) drill bit**.

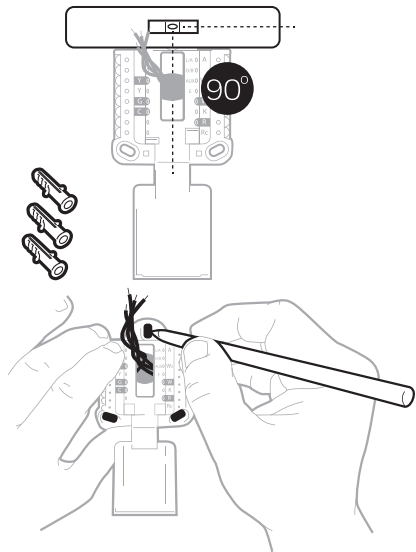

12 Set R-switch position and insert R-wire or wires

Set the R-switch up or down based on your wiring notes in Step 7.

! Insert wires into the inner holes of the terminals on the UWP. The tabs will stay down once the wire is inserted.

If you have 1 R-wire (R, Rh, or Rc)

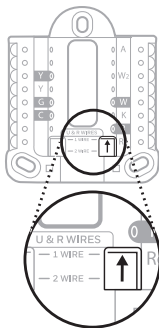

1. Set R-switch to the up position.

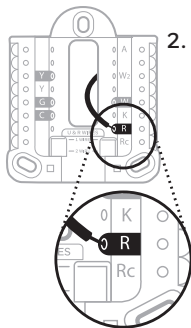

2. Insert your R-wire (R, Rh or Rc) into R-terminal.

or

If you have 2 R-wires (R or Rh, and Rc)

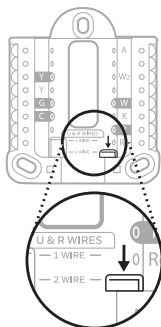

1. Set R-switch to the down position.

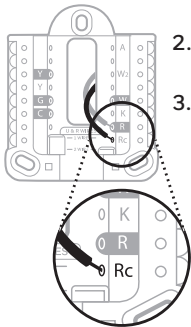

2. Insert your Rc wire into Rc-terminal.
3. Insert your R or Rh wire into R-Terminal.

13 Connect remaining wires from Step 8

Tip: Do not mount the UWP to the wall prior to connecting the wires.

Depress the tabs to put the wires into the inner holes of their corresponding terminals on the UWP (one wire per terminal) until it is firmly in place.

Gently tug on the wires to verify they are secure.

Tip: If you need to release the wires again, push down the terminal tabs on the sides of the UWP.

This wiring is just an example, actual wiring may vary.

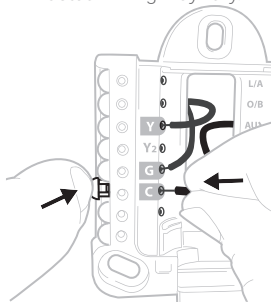

14 Mount the UWP and close the door

Mount the UWP using the provided screws. Install all three screws for a secure fit on your wall. Close the door after you're finished.

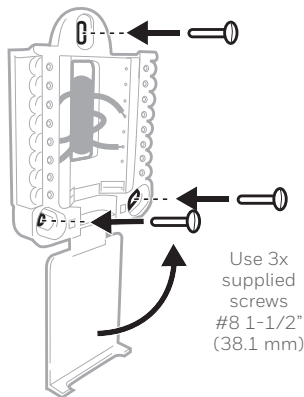

15 Attach your thermostat

Align the thermostat onto the UWP and firmly snap it into place.

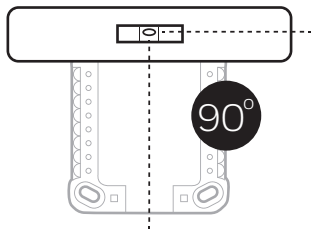

16 Turn your power ON

Turn on the power at the breaker box or switch that controls the heating/cooling system.

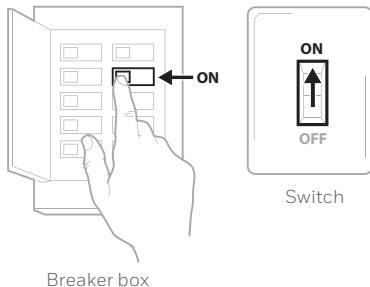

17 Return to the thermostat

Return to the thermostat. Confirm the screen shows **START SETUP**. If it does, continue to “Setup with Resideo App” on page 15.

If your thermostat does not show **START SETUP**, please contact Resideo support.



Setup with Resideo App

- 1 **Start Setup with the app**
Touch **START SETUP** on thermostat.



- 2 **Select to setup with the app**
Touch **Yes** on the **USE APP** screen.

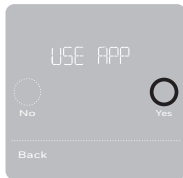

- 3 **Your thermostat is now ready to be configured using the Resideo app**

- a.) Download the “**Resideo**” app from the App store or Google play.
- b.) Open the Resideo app. Your thermostat should appear under Thermostat Found. Tap **SET UP NOW** as shown below to continue. If your thermostat doesn't appear, create an account (if necessary), or sign in to your Resideo account. Then select the T5 Smart Thermostat to install.
- c.) The Resideo app will walk you through the rest of setup.

A

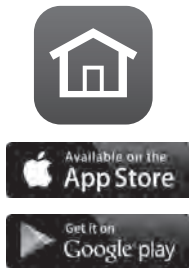

B

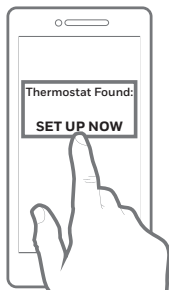

C

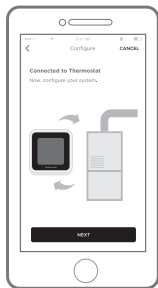

How to use your Resideo App

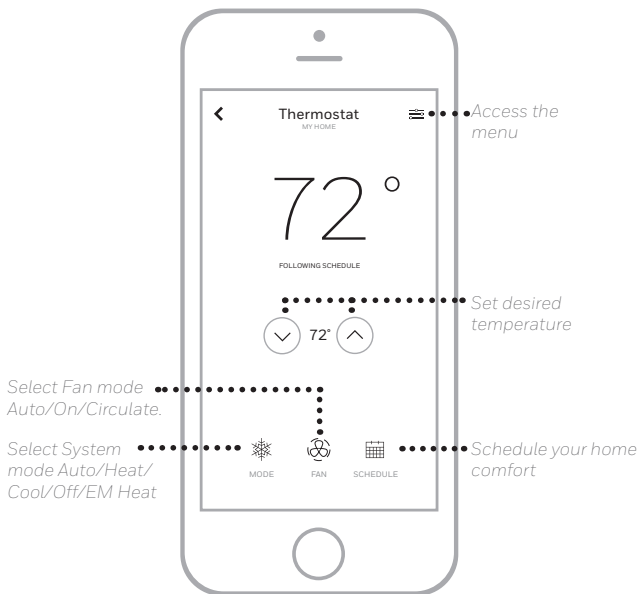

Interested in more Resideo products? Visit honeywellhome.com to learn about all available products connected by the Resideo App.

App is regularly enhanced and may change.

How to use your T5 Smart Thermostat

Desired temperature

Displays desired indoor temperature.

Indoor Temperature

Displays current indoor temperature.

Adjust temperature

Touch + or - to set your desired indoor temperature.

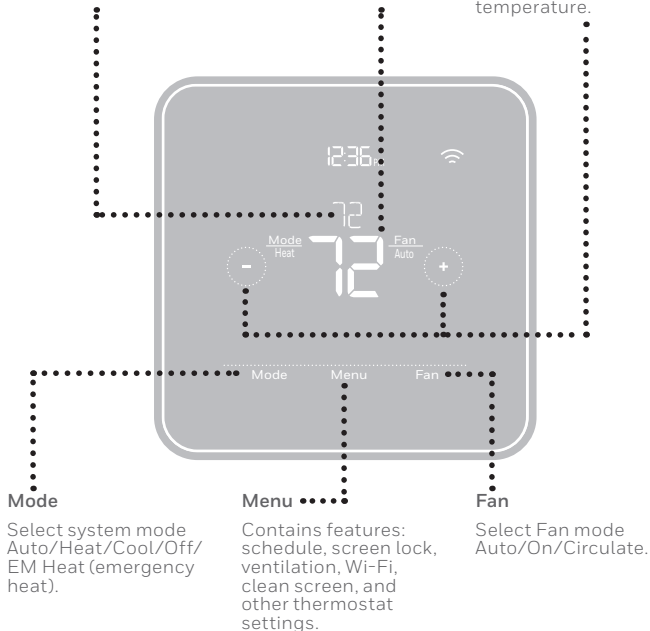

The screen will wake up by touching the center area of displayed temperature.

Manual Setup

If your Wi-Fi network is not working, you can alternatively setup your thermostat manually and connect your phone later.

1 Start manual setup

Touch **START SETUP** to begin.

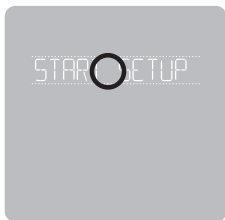

2 Select manual setup

On the **USE APP** screen, touch **No**.



3 Navigate and edit setup options

Use (◀) or (▶) to navigate through all the setup options. To see a list of all setup options, go to pages 20-21.

To edit an option value, touch **Edit** or touch text area.

The value is now blinking. Use (◀) or (▶) to select the correct value.

Touch **Done** or touch text area once the correct value is selected.



Manual Setup (cont.)

4 Finish Setup

Touch  until you see Finish Setup.
Touch **Select** or touch text area.

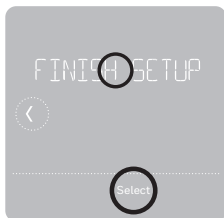

5 Setup Wi-Fi

At the end of setup process you will be prompted to **SETUP WIFI**. If your Wi-Fi is still not working, you have to manually set the time and date. Select **No** on the **SETUP WIFI** screen.



6 Set time and date

Set daylight saving time if you are in an area that follows daylight saving time. Set date, clock format and time on the next screens.



7 Your thermostat is now setup

Refer to page 17 for more information about basic operation.

Equipment Setup Options

Option #	Option Name	Option Value (factory default in bold)
120	Schedule Type	No Schedule MO-SU = Every day the same MO-FR SA SU = 5-1-1 schedule MO-FR SA-SU = 5-2 schedule Each Day = Every day different <i>Note: You can change default MO-FR, SA-SU schedule here. To edit periods during days, temperature setpoints, or to turn Schedule On/Off, touch MENU from the Home screen and go to SCHEDULE.</i>
200	System Type	Conventional Forced Air , Heat Pump, Boiler, Cool Only <i>Note: This option selects the basic system type your thermostat will control.</i>
205	Equipment Type	Conventional Forced Air Heat: Standard Gas, High Efficiency Gas , Oil, Electric, Fan Coil <i>Heat Pump:</i> Air to Air , Geothermal <i>Boiler:</i> Hot Water , Steam <i>Note: This option selects the equipment type your thermostat will control. Note: This feature is NOT displayed if feature 200 is set to Cool Only.</i>
218	Reversing Valve	O/B on Cool , O/B on Heat <i>Note: This option is only displayed if the Heat Pump configured. Select whether reversing valve O/B should energize in cool or in heat.</i>

Equipment Setup Options

Option #	Option Name	Option Value (factory default in bold)
220	Cool Stages/ Compressor Stages (#200=Conv./ #200=HP)	0, 1 , 2 <i>Note: Select how many Cool or Compressor stages of your equipment the thermostat will control. Maximum of 2 Cool/Compressor Stages.</i>
221	Heat Stages/ Aux/E Stages (#200=Conv./ #200=HP)	Heat Stages: 0, 1 , 2 Aux/E stages: 0, 1 <i>Note: Select how many Heat or Aux/E stages of your equipment the thermostat will control. Maximum of 2 Heat Stages for conventional systems. Maximum of 1 Aux/E stage for systems with more than 1 heating equipment type.</i>

Frequently Asked Questions

Will the T5 Smart thermostat still work if Wi-Fi connection is lost?

Yes, the temperature can be adjusted directly at the thermostat. However, some features, including geofencing, are managed only through the Resideo app and will not function while the connection is down. The thermostat will automatically reconnect to Wi-Fi once the network is restored.

The T5 Smart thermostat is not finding the in home Wi-Fi network.

thermostat operates in the 2.4 GHz range. That may be why the thermostat does not see the network but the smartphone, which operates in both the 2.4 and 5.0 GHz range, sees the network. Most routers will broadcast two networks, one SSID on the 5.0 GHz radio and one SSID on the 2.4 GHz radio.

A change was made on the Resideo app but it has not shown up on the T5 Smart thermostat.

There may be a short delay after making temperature and setting changes in the Resideo app.

Can there be multiple users for geofencing?

Yes, there can be multiple users. Geofencing will trigger based on the last person to leave and the first person to return. To properly use geofencing with multiple users:

- Each user needs to create their own account.
- Each user should use their login ID and password across his or her devices, including smartphones and tablets.
- No two users should share the same account.

How are multiple users set up with thermostat?

Access can be given to any or all thermostat locations through the Resideo app. Start by touching the three-line menu icon in the upper left-hand corner of the home screen. Select Manage Users and touch Add User located at the bottom of the screen. Type in the email address of the person to be invited. If they have a account set up, the location will be automatically added to their account. If they don't have an account, they will receive an email invitation prompting them to download the Resideo app and create their own account.

Note: All individuals with access to a thermostat share the same user privileges. Users added will be able to change the thermostat's settings, as well as add or delete other users.

Is there a way to extend the signal strength?

The range or distance of the Wi-Fi signal is determined by the router. Check the router's manual for additional information.

Frequently Asked Questions

There is an alert that says Wi-Fi Signal Lost. What does that mean?

The Wi-Fi signal to the thermostat has been lost. Wait for the thermostat to reconnect or select a new network within the Resideo app configuration menu. If the thermostat is unable to reconnect, you will need to troubleshoot the router to determine the cause.

Why is the thermostat showing up as offline (strike-through Wi-Fi icon) on top of right corner of thermostat display?

If the thermostat displays a strike-through Wi-Fi icon on its screen or shows up as offline on the Resideo app, it has lost connection to the network. Make sure the router is powered and broadcasting. The home's Wi-Fi network may need to be reset by power cycling the router. Consult the router's instruction manual for directions on power cycling. When the network has been restored, the thermostat will automatically reconnect.

An activation email hasn't been received.

An email will be sent from connected-Home@alarmnet.com. An activation email is needed to complete the account setup. If an activation email is not received after five minutes, check the Spam folder of the email account.

If you do not find it in the Spam folder, click on the Resend button and the activation email will be resent. If you still do not receive your activation email, please contact the Technical Support team at 1-800-633-3991 for help.

Regulatory information

FCC REGULATIONS

47 CFR § 15.19 (a)(3)

This device complies with part 15 of the FCC Rules. Operation is subject to the following two conditions:

- 1 This device may not cause harmful interference, and
- 2 This device must accept any interference received, including interference that may cause undesired operation.

47 CFR § 15.21 (USA only)

Changes or modifications not expressly approved by the party responsible for compliance could void the user's authority to operate the equipment.

RF Exposure Warning

This equipment complies with FCC and ICSED radiation exposure limits set forth for an uncontrolled environment. This equipment shall be installed and operated with a minimum distance of 20cm between the radiator and any part of your body

47 CFR § 15.105 (b)

See <https://customer.resideo.com/en-US/support/residential/codes-and-standards/FCC15105/Pages/default.aspx> for additional FCC information for this product.

IC REGULATIONS RSS-GEN

This device contains licence-exempt transmitter(s)/receiver(s) that comply with Innovation, Science and Economic Development Canada's licence-exempt RSS(s). Operation is subject to the following two conditions:

- 1 This device may not cause interference.
- 2 This device must accept any interference, including interference that may cause undesired operation of the device.

Apple® HomeKit™ Setup Code

The T5 Smart Thermostat supports Apple HomeKit. Open HomeKit app, follow the instructions and enter the code displayed on Thermostat when prompted.

2-Year Limited Warranty

For Warranty information go to honeywellhome.com

Use of the Works with Apple badge means that an accessory has been designed to work specifically with the technology identified in the badge and has been certified by the developer to meet Apple performance standards. Apple is not responsible for the operation of this device or its compliance with safety and regulatory standards.

AirPlay, iPad, iPad Air, iPad Pro, iPhone and iPod touch are trademarks of Apple Inc., registered in the U.S. and other countries. HomePod is a trademark of Apple Inc.



resideo
www.resideo.com

Resideo Technologies, Inc.
1985 Douglas Drive North, Golden Valley, MN 55422
honeywellhome.com
33-00363EFS-05 M.S. Rev. 12-22 | Printed in United States



© 2022 Resideo Technologies, Inc. All rights reserved.
The Honeywell Home trademark is used under license from Honeywell International, Inc. This product is manufactured by Resideo Technologies, Inc. and its affiliates.
Tous droits réservés. La marque de commerce Honeywell Home est utilisée avec l'autorisation d'Honeywell International, Inc. Ce produit est fabriqué par Resideo Technologies, Inc. et ses sociétés affiliées.
Todos los derechos reservados. La marca comercial Honeywell Home se utiliza bajo licencia de Honeywell International, Inc. Este producto es fabricado por Resideo Technologies, Inc. y sus afiliados.

Wi-Fi® is a registered trademark of Wi-Fi Alliance®



33-00363EFS-05

Honeywell Home



Thermostat intelligent T5

Thermostat
Programmable

Guide
d'installation
rapide



RCHT8610WF2006,
RCHT8610WF2014,
RCHT8610WF3005,
RCHT8612WF2005,
RCHT8612WF2015,
RCHT8612WF3006,
RTH8800WF2022,
Lire avant l'installation

Pour plus d'informations, visitez [honeywellhome.com](https://www.honeywellhome.com)

Inclus dans cette boîte :

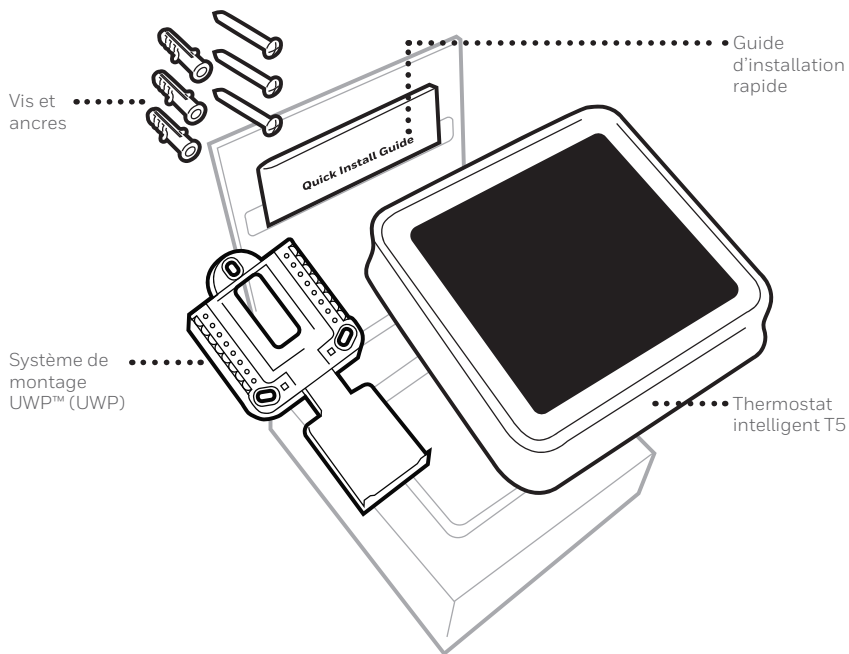

Tirez le maximum de votre thermostat intelligent T5

Plusieurs options de programmation pour votre style de vie :



- 1. Programmation géodépendante** – Le thermostat Il vous permet de réaliser des économies d'énergie en surveillant vos allées et venues en utilisant l'emplacement de votre téléphone intelligent. Grâce à la technologie de géorepérage, il détecte votre retour pour assurer votre confort lorsque vous rentrez chez vous. Vous pouvez changer manuellement votre réglage de température Maison et Absent sur le thermostat ou dans l'application Resideo.
- 2. Programmation intelligente** – Utilisez une combinaison de géorepérage et de programmation horaire pour s'adapter à votre style de vie actif.
- 3. Programmation horaire** – Programmez votre thermostat pour une semaine, pour la journée (chaque journée possédant un programme horaire différent), ou du lundi au vendredi avec un programme identique pour le samedi et le dimanche, ou distinct pour ces deux jours de fin de semaine. Tous les jours avec quatre périodes réglables par jour.
- 4. Pas de programmation** – Contrôlez manuellement votre confort en réglant uniquement les points de consigne de température.



Alertes intelligentes. Des notifications poussées vous rappellent d'effectuer les changements de filtre et vous préviennent des températures intérieures extrêmes.



Smart Response. Apprend le fonctionnement de votre système de chauffage et de refroidissement pour fournir une température optimale au bon moment.



Passage automatique du chauffage au refroidissement. Détermine automatiquement si le domicile nécessite d'être chauffé ou refroidi pour assurer un confort maximum.

Outils requis :



Tournevis cruciforme



Petit tournevis plat



Crayon



Téléphone intelligent
Pour installer le thermostat et prendre une photo du câblage existant.



Niveau



Mot de passe
Wi-Fi de la
résidence



Application Resideo
*Pour configurer votre système
et connecter votre téléphone
intelligent.*

Vous aurez besoin des outils suivants :

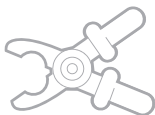

Dénuder de fils

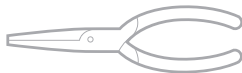

Pince à bec effilé

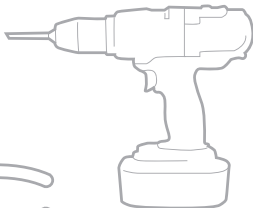

Perceuse et mèche (7/32 po)

**MISE EN GARDE : RISQUE DE CHOC ÉLECTRIQUE**

Peut provoquer des chocs électriques ou endommager le matériel. Couper l'alimentation électrique avant d'effectuer le raccordement.

**MISE EN GARDE : RISQUE DE DOMMAGES DE L'ÉQUIPEMENT**

La protection du compresseur est annulée durant le test. Pour éviter d'endommager l'équipement, évitez d'actionner le compresseur trop rapidement.

**MISE EN GARDE : AVIS RELATIF AU MERCURE**

Si ce produit remplace un régulateur contenant du mercure dans un tube scellé, ne mettez pas l'ancien régulateur à la poubelle. Contactez le responsable de gestion des déchets local pour les instructions concernant le recyclage et l'élimination.

**REQUIS : ALIMENTATION DE 24 V C.A. (FIL C)****MISE EN GARDE : AVIS DE DÉCHETS ÉLECTRONIQUES**

Ne disposez pas ce produit avec les autres ordures ménagères. Recherchez les centres de collecte ou de recyclage accrédités les plus proches. La mise au rebut appropriée de l'équipement en fin de vie aidera à prévenir tout effet potentiellement nuisible à l'environnement et à la santé humaine.

Compatibilité

- Compatible avec la plupart des systèmes de chauffage, refroidissement, et à thermopompes
- Requis : Alimentation de 24 V c.a. (fil C)
- Non compatible avec les chauffages de plinthes électriques (120-240 V)
- Non compatible avec les systèmes à millivolts
- Ne prend pas en charge les entrées (bornes S) des capteurs d'intérieur et d'extérieur
- Ne prend pas en charge le relais (bornes U) pour la ventilation
- Téléphone intelligent, tablette ou dispositif Android ou iOS

Pour obtenir de l'aide, veuillez contacter :

SITE WEB honeywellhome.com

TÉLÉPHONE 1-800-633-3991

RÉSEAUX SOCIAUX Twitter : @Honeywell_Home, Facebook : Honeywell Home

Retrait de l'ancien thermostat

1 Coupez l'électricité

 Pour vous protéger ainsi que pour protéger votre équipement, coupez l'alimentation au niveau du disjoncteur ou de l'interrupteur contrôlant le système de chauffage/refroidissement.

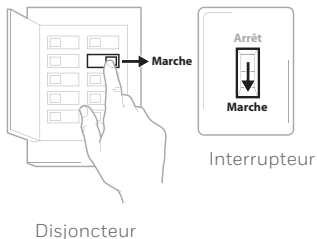

2 Vérifiez que le système est hors tension

Modifiez la température sur l'ancien thermostat. Si le système ne se met pas en marche dans les 5 minutes qui suivent, l'alimentation vers l'appareil est coupée.

Remarque : Si vous avez un thermostat numérique qui a un écran vierge, sautez cette étape.

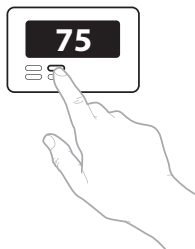

3 Retirez l'ancien thermostat de la plaque murale

Avec la plupart des thermostats, vous pouvez le retirer en saisissant le thermostat et en le tirant doucement. Certains thermostats peuvent avoir des vis, des boutons ou des fermoirs.

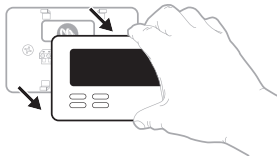

 Ne retirez aucun fil du thermostat à ce stade!

4 Assurez-vous qu'aucun fil de 120/240 V n'est présent



Y a-t-il d'épais fils noirs avec des capuchons de connexion?

Votre thermostat est-il de 120 V ou plus?

Si vous avez répondu oui à l'une ou l'autre de ces questions, votre système fonctionne sur tension secteur et le thermostat ne fonctionnera pas.

En cas d'incertitude, visitez :
honeywellhome.com

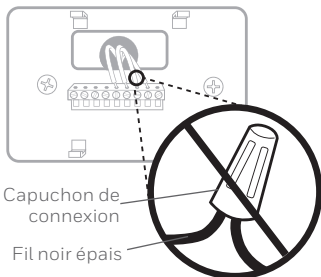

5 Prenez une photo du câblage existant

Veillez à inclure les lettres près des bornes d'insertion des fils. Ceci permettra une consultation plus facile lors du câblage du thermostat.

Conseil : Si la couleur des fils s'est estompée ou si deux bornes ont des fils de même couleur, utilisez les étiquettes de fil fournies dans l'emballage pour étiqueter chaque fil.

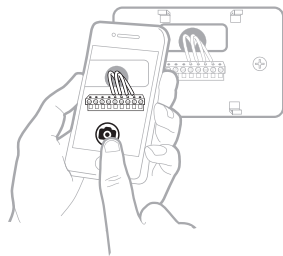

6 Retirez tout cavalier

Un cavalier connecte une borne à une autre. Il peut ressembler à une petite agrafe ou à un fil coloré, et il doit être retiré avant de continuer. Utilisez un tournevis pour dégager les fils des bornes.

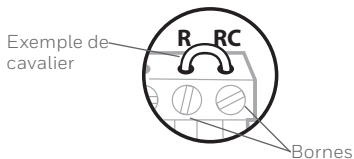

Le thermostat ne fonctionne pas avec des cavaliers.

- 7 **Notez la présence de fils dans les bornes suivantes**
N'incluez pas les cavaliers. Le thermostat ne fonctionne pas avec des cavaliers.

Borne	Couleur de fil
<input type="checkbox"/> R	_____
<input type="checkbox"/> Rh	_____
<input type="checkbox"/> Rc	_____

- 8 **Notez la couleur des fils**

Cochez les fils connectés à des bornes. Indiquez la couleur du fil à côté de la coche. **Ne comptez pas les cavaliers.**

Cochez tous les éléments applicables (les éléments ne s'appliquent pas tous):

Borne	Couleur de fil	Borne	Couleur de fil
<input type="checkbox"/> Y	_____	<input type="checkbox"/> A ou L/A	_____
<input type="checkbox"/> Y2	_____	<input type="checkbox"/> O/B	_____
<input type="checkbox"/> G	_____	<input type="checkbox"/> W2 ou AUX	_____
<input type="checkbox"/> C	Obligatoire	<input type="checkbox"/> E	_____
		<input type="checkbox"/> W	_____
		<input type="checkbox"/> K	_____

Les bornes S et U ne sont pas prises en charge par ce thermostat.

S'il y a des fils sont dans des bornes non énumérées, une assistance supplémentaire sera requise pour le câblage. Visitez honeywellhome.com pour déterminer si le thermostat fonctionnera dans votre configuration.

9 Débranchez les fils et retirez l'ancienne plaque murale

Utilisez un tournevis pour dégager les fils des bornes.

Conseil : Pour éviter que les fils ne tombent derrière le mur, enroulez-les autour d'un crayon.

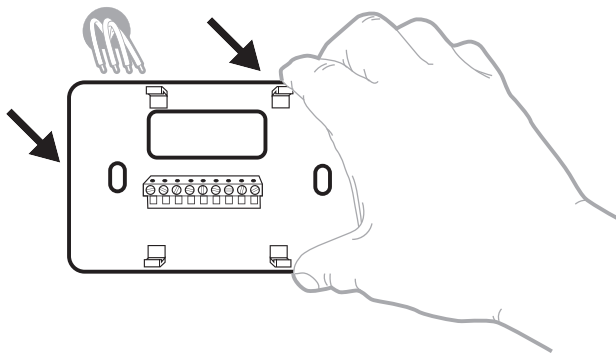

Installation de votre thermostat intelligent T5

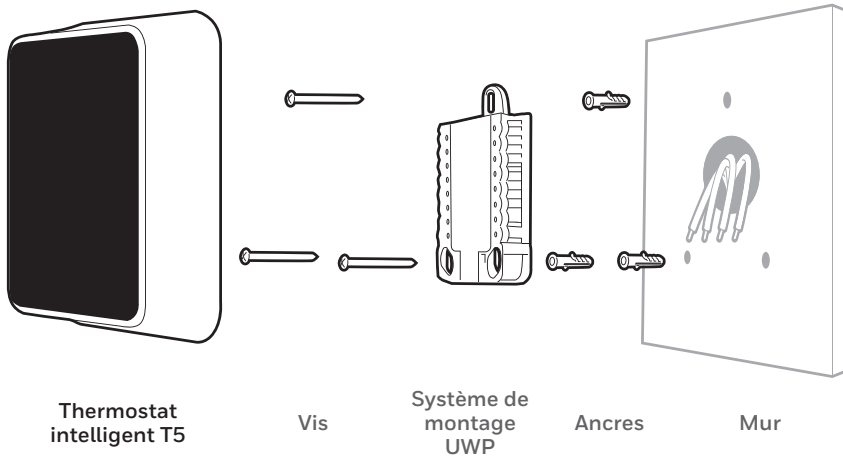

10 Regroupez et insérez les fils dans le système de montage UWP

Ouvrez le système UWP et insérez le faisceau de fils à l'arrière du système UWP. Assurez-vous qu'au moins 1/4 po de chaque fil est exposé pour faciliter l'insertion dans les cosses de câble.

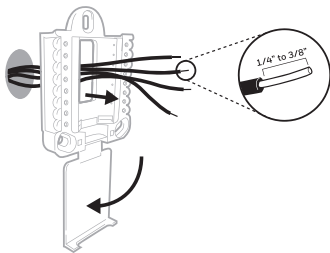

11 Insérez les ancrs murales

Il est recommandé d'utiliser les ancrs murales fournies dans la boîte pour monter le thermostat.

Vous pouvez utiliser le système de montage **UWP** pour marquer l'emplacement des ancrs murales.

- Mettez la plaque murale de niveau.
- Marquez l'emplacement des ancrs murales à l'aide d'un crayon.
- Percez les trous.
- Insérez les ancrs murales.
- Assurez-vous que les ancrs affleurent au mur.

Conseil : Utilisez une mèche 7/32.

