

TRX970

OPERATION MANUAL

REMOTE TRANSCIVER (TX)

A. OLED DISPLAY

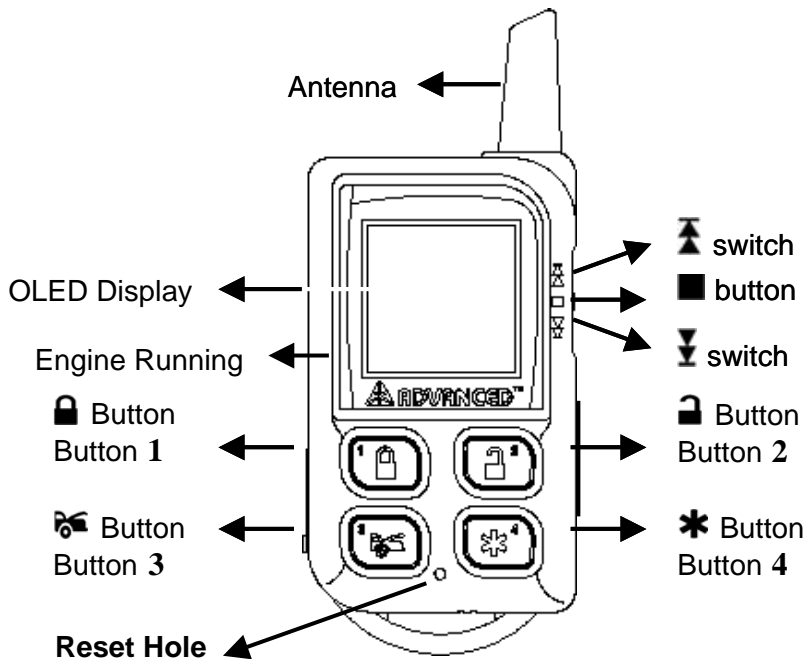
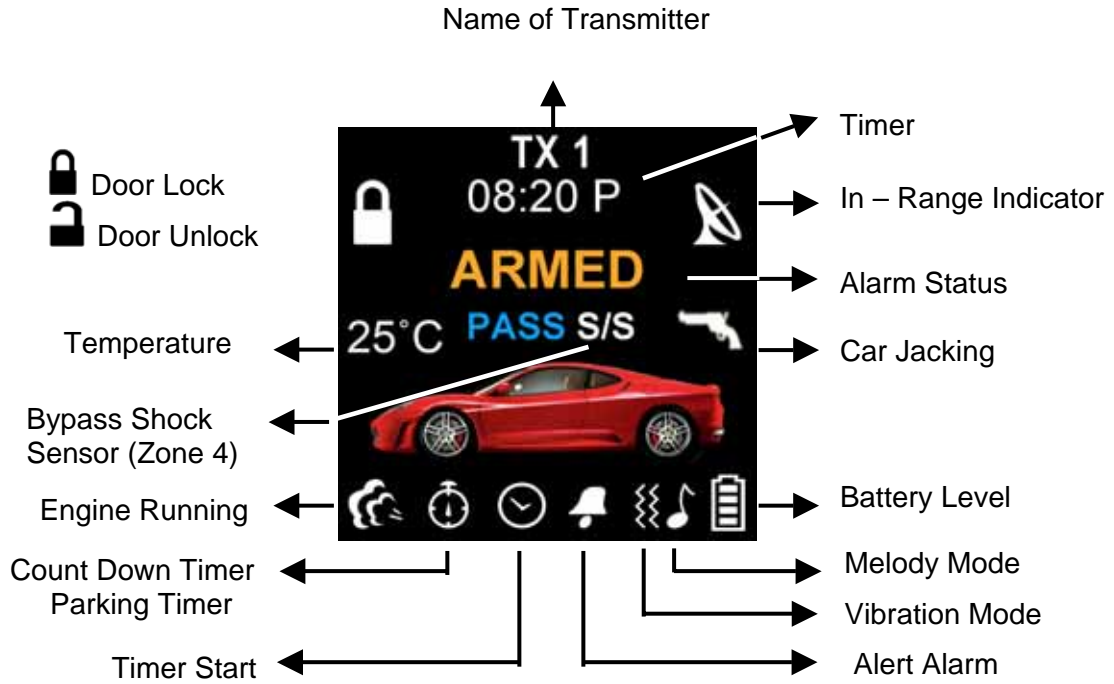

Reset Hole
 In case the remote transceiver malfunction, errors or freeze of display, it is recommended to reset your remote transceiver.

B. CHARGE THE BATTERY

Power by built-in 3.7V lithium polymer battery, if the OLED screen display low battery or  is flash, charge your remote transceiver. While the battery of the Remote Transceiver is under the battery charging, you can push the "■" button to check charging condition.

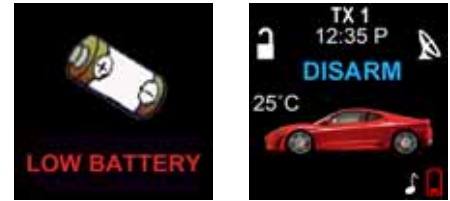

AC Power Supply

The remote transceiver equipped AC POWER SUPPLY / AC ADAPTOR (Output Voltage: 4.2VDC – 5.5VDC and with same USB plug), then you can charge the battery indoors.

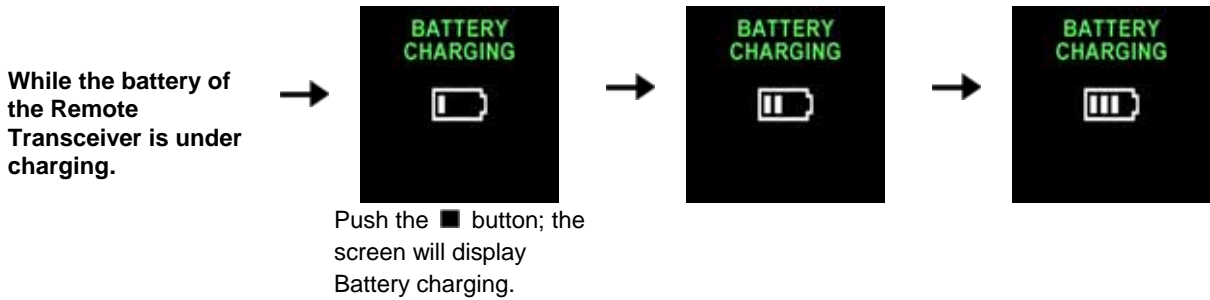

C. SELECT THE TRANSCEIVER’S BUTTON CONFIGURATION:

- Spin up the  Switch to select the transceiver button configuration you need and the OLED screen will display the transceiver button configuration you select.
 - Within 5 seconds press the button 1, 2, 3 or 4 to remote control “button configuration” you selected.
- Note: If 5 seconds of inactivity expired, or push the ■ button, the transceiver button configuration mode will exit.

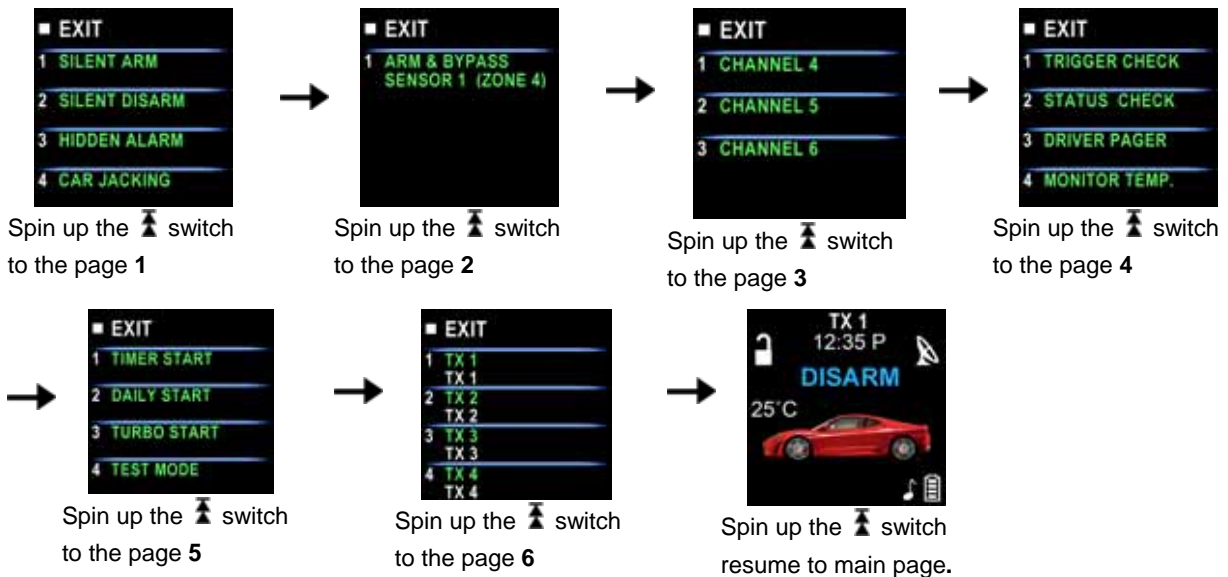

D. SELECT THE TRANSCEIVER FEATURES:

- Spin down the  Switch to select the transceiver feature you need and the OLED screen will display the features you select.
 - Press the button 1, 2, 3 or 4 once within 3 seconds after finished selection and the OLED screen will change the display alternatively.
- Note: If 5 seconds of inactivity expire, or push the ■ button, the transceiver features program mode will exit.



Spin down the switch to the page 1



Spin down the switch to the page 2



Spin down the switch to the page 3



Spin down the switch to the page 4



Spin down the switch to the page 5



Spin down the switch to the page 6



Spin down the switch resume to main page.

E- P1- 1. "BUTTON BI" SETTING: Example: Set the "Button Bi Disable". It has a short "bi" sound while pressing the button of the remote transceiver



Spin down the switch to the page 1

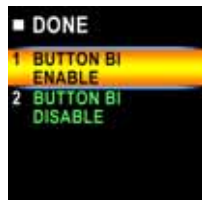

Press the button 1 and it will display previously setting

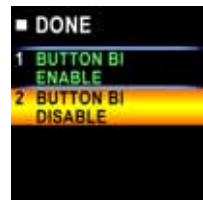

Press the button 2 to change the setting



Press the button and the setting is done.

E- P1- 2. "BUTTON LOCK" SETTING: Example: Set the "Button Lock Enable".



Spin down the switch to the page 1

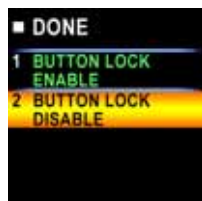

Press the button 2 and it will display previously setting

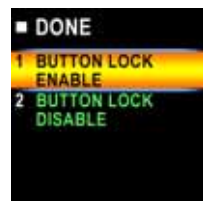

Press the button 1 to change the setting



Press the button and the setting is done.

E- P1- 3. "MELODY / VIBRATION MODE" SETTING: Example: set the Vibration mode.

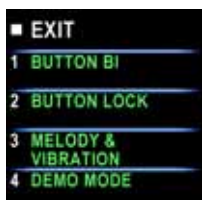

Spin down the switch to the page 1



Press the button 3 and it will display previously setting



Press the button 2 to change the setting

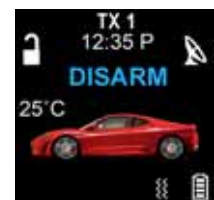

Press the button and the setting is done also the icon will display on the OLED screen

E- P1- 4. "DEMO MODE":



Spin down the switch to the page 1

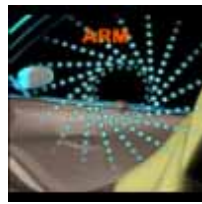

Press the button 4 to start Demo movie



Demo movie playing



Press the any Button to exit.

E- P2- 1. "POWER SAVE" SETTING: Example set the "Power Save Enable".

While the power save mode, the LCD remote transceiver uses "0" current to save the battery power.



Spin down the switch to the page 2

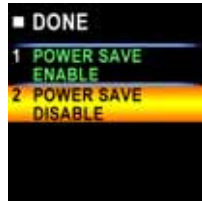

Press the button 1 and it will display previously setting.

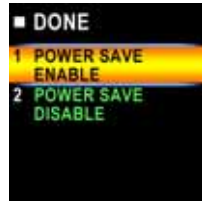

Press the button 1 to change the setting.



Press the button and the setting is done.

E- P2- 2. "PARKING METER" SETTING: Example set the "Parking Meter 30 min.."

Note: When "parking meter" trigger presses any button to stop the beeper.



Spin down the switch to the page 2



Press the button 2



Press the button 1 three times to set the parking timer to 30 minutes.



Press the button to start the parking meter and the icon will flash on the main page.

D- P2- 3. "PARKING AREA" SETTING: Example set the "Parking Area." to "B120"



Spin down the switch to the page 2



Press the button 3, it will display previously parking area



Press the button 2 to clear the parking area, and the "-" flashes for setting.



Spin up the switch to setting the "B"



Press the button 1 and the "-" flashes for setting.



Spin down the switch to set the "1"



Press the button 1 and the "-" flashes for setting.



Spin down the switch to set the "2".

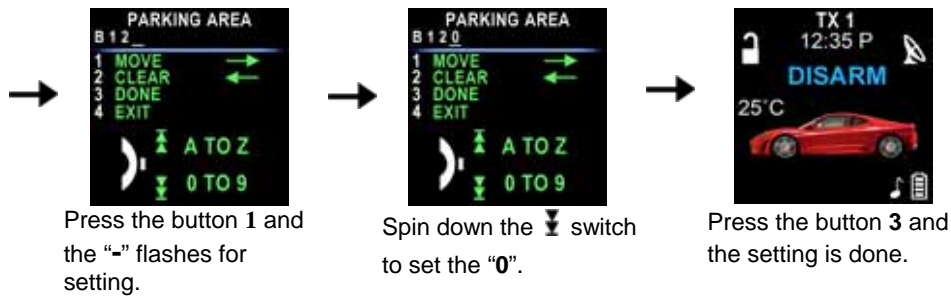

D- P2- 4. "LIGHTING FOR OLED" TIMER SETTING: Example: set the OLED display from 2 seconds to 3 seconds.

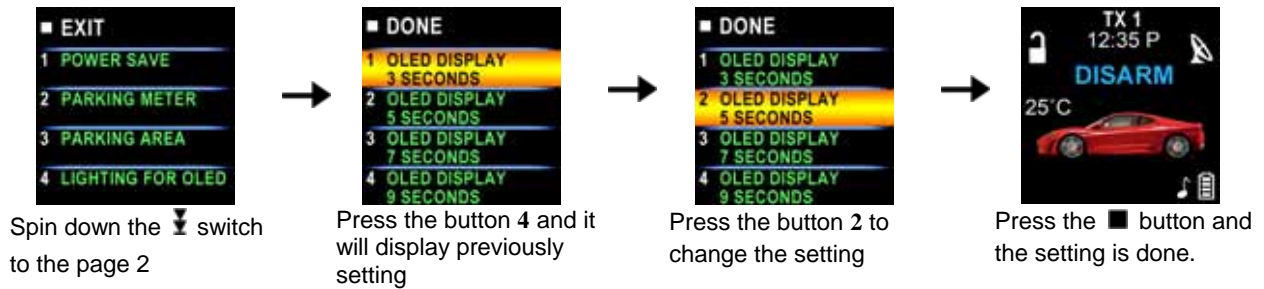

D- P3- 1. "TIMER" SETTING: Example set the timer to 08:20P

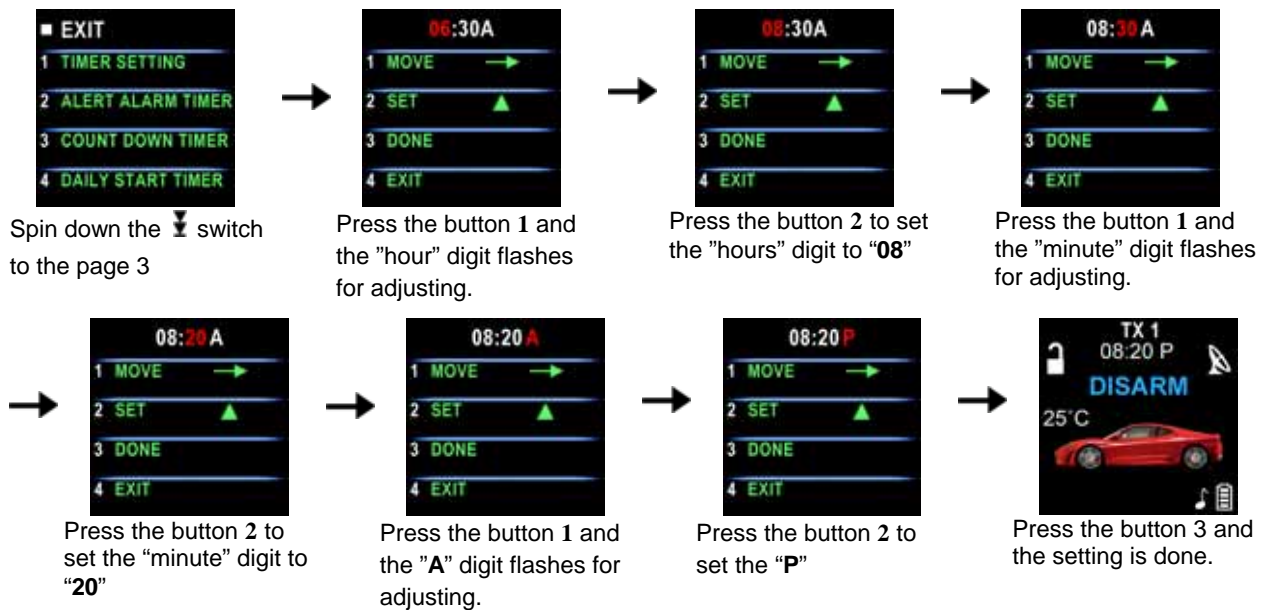

D- P3- 2. "ALERT ALARM TIMER" SETTING: Example set alert alarm timer to 06:30A

Note: When alert alarm timer trigger press any button to stop the beeper.

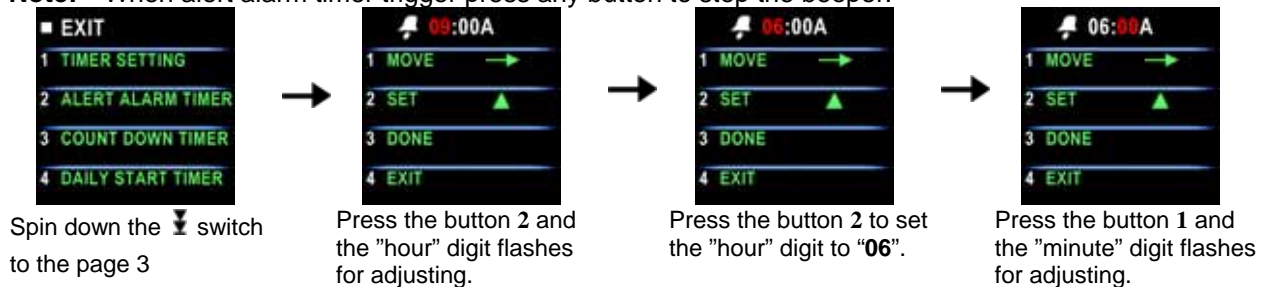

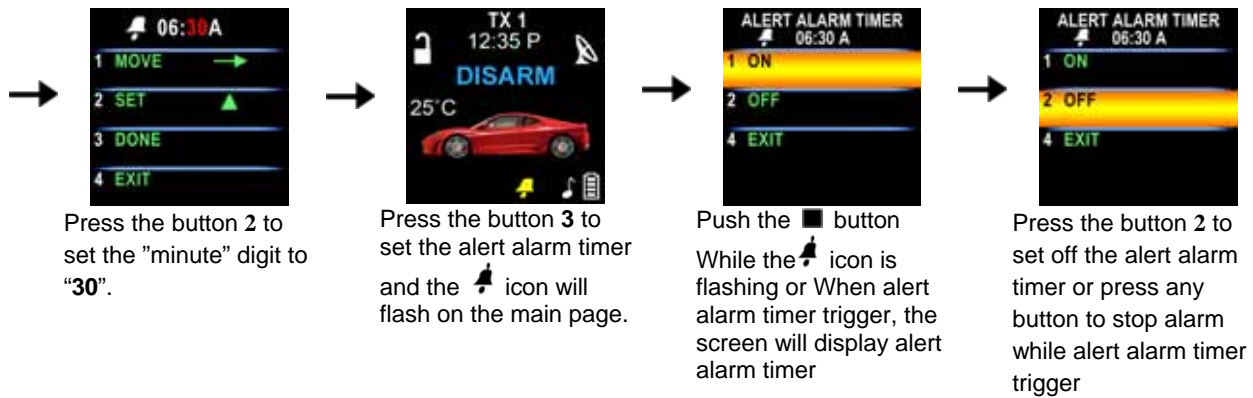

C- P3- 3. "COUNT DOWN TIMER" SETTING: Example set the count down timer to 2:30

Note: When count down timer is trigger, press any button to stop the beeper.

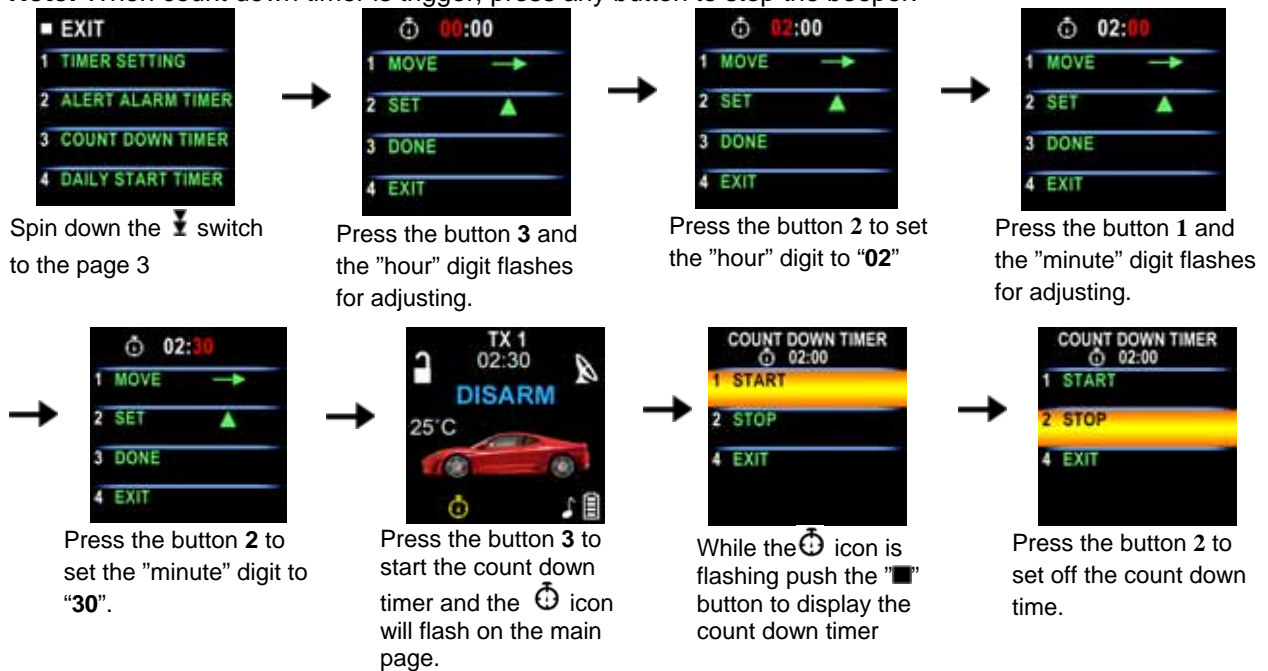

C- P3- 4. "DAILY START TIMER" SETTING: Example set the Daily Start Timer to 05:00A

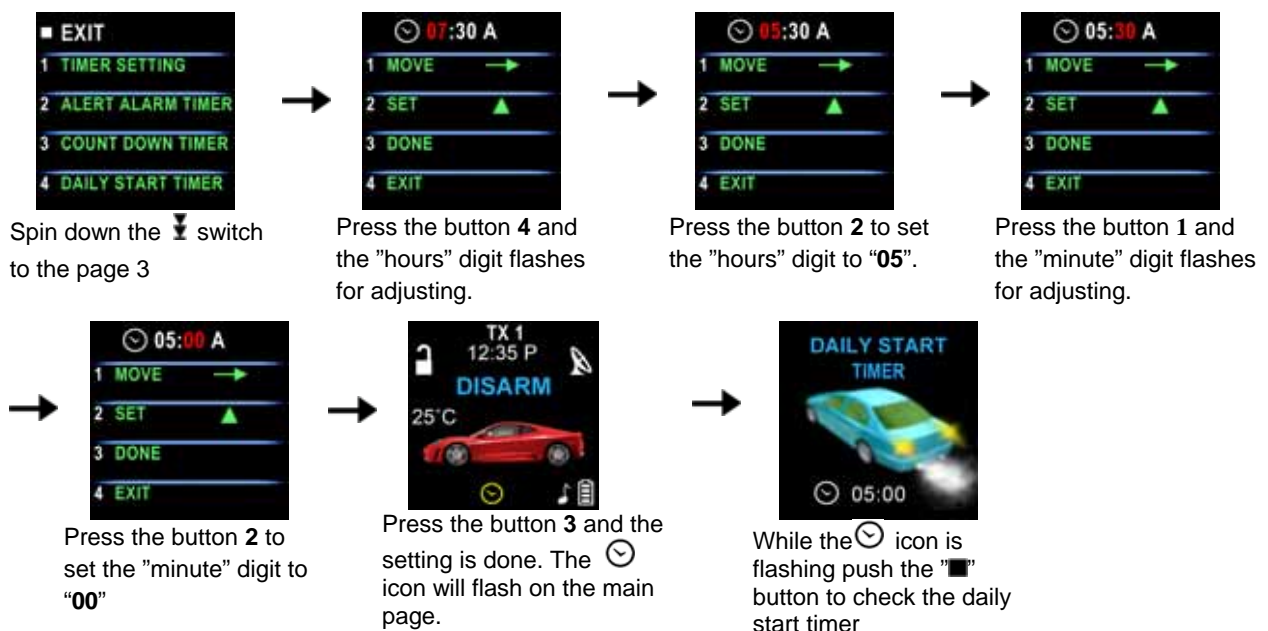

D- P4- 1. "NAME OF TX " SETTING: Example Set Name of Transceiver 1 to **MIKE**



Spin down the switch to the page 4



Press the button 1 and the "-" flashes for setting.



Spin down the switch to set the "M".



Press the button 1 and the "-" flashes for setting.



Spin up the switch to set the "I".



Press the button 1 and the "-" flashes for setting.



Spin down the switch to set the "K".



Press the button 1 and the "-" flashes for setting.



Spin up the switch to set the "E".



Press the button 3 and the setting is done.

D- P5- 1. "NAME OF CHANNEL " SETTING: Example Set Name of channel 4 to **GARAGE DOOR**



Spin down the switch to the page 5



Press the button 1 and the "-" flashes for setting.



Spin up the switch to set the "G".



Press the button 1 and the "-" flashes for setting.



Spin down the switch to setting the "A".

Following the above step to setting Alphabetical to **GARAGE DOOR**



Press the button 1 and the "-" flashes for setting.



Spin down the switch to set the "R".



Press the button 3 and the setting is done.

D- P6- 1. LANGUAGE SETTING: Example set the Language to **English**



Spin down the switch to the page 6



Press the button 1 to set the Language to "ENGLISH".

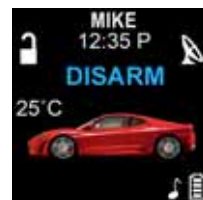

Press the button and the setting is done.

D- P6- 4. SET TO DEFAULTS:



Spin down the switch to the page 6



Press the button 4.



Press the button 1 & 2 at same time to set the defaults.

OPERATION:

A. REMOTE TRANSMITTER OPERATION:

Transmitter Button	System Function	Remark
1	Lock Doors & Arm System / Button 1	
-	Arm and Bypass The Zone 4.	Press twice within 3 seconds
-	Arm System and Hidden Alarm Function	Press within 3 seconds
	Car Locator	Upon armed
(3-second)	Panic function	Press and Hold for 3 seconds.
+	Silent Arming / Disarming	Ignition in "off" position.
+ (2-second)	Active Anti Car-Jacking Mode	Ignition in "on" position press and hold for 2 seconds
2	Unlock Doors & Disarm System / Button 2	
-	Two Steps Door Unlock & Disarm System	Press twice within 3 seconds.
3	Trunk Release	
(2-second)	Trunk Release (Channel 3)	Press and Hold for 2 seconds
-	Passive Arming By-pass	While the system Disarmed.
* 4	Turn Off The Remote Start / Button 4	.
* - *	Activate The Remote Start	Press twice within 3 seconds.
+	Channel # 4 Timer Output	
+	Channel # 5 Timer Output	
+ *	Channel # 6 Timer Output	
	Switching code For 2nd Car Operation.	For regular remote transmitter
	Button Function Selection	For Two way Remote transceiver
	Confirm Button / Back to Main Page	For Two way Remote transceiver
	Feature Selection	For Two way Remote transceiver

This device complies with part 15 of the FCC rules. Operation is subject to the following two conditions.

- (1) This device may not cause harmful interference, and
- (2) This device must accept any interference received, including interference that may cause undesired operation.

Per FCC 15.21, you are cautioned that changes or modifications not expressly approved by the part responsible for compliance could void the user's authority to operate the equipment.

This equipment has been tested and found to comply with the limits for a Class B digital device, pursuant to Part 15 of the FCC Rules. These limits are designed to provide reasonable protection against harmful interference in a residential installation. This equipment generates, uses and can radiate radio frequency energy and, if not installed and used in accordance with the instructions, may cause harmful interference to radio communications. However, there is no guarantee that interference will not occur in a particular installation. If this equipment does cause harmful interference to radio or television reception, which can be determined by turning the equipment off and on, the user is encouraged to try to correct the interference by one or more of the following measures:

- Reorient or relocate the receiving antenna.
- Increase the separation between the equipment and receiver.
- Connect the equipment into an outlet on a circuit different from that to which the receiver is connected.
- Consult the dealer or an experienced radio/TV technician for help.