



# ACR900 POS Terminal User Manual

## I. Installation

### 1. SAM cards / SIM card / Micro SD card

Unclip the trapdoor on the bottom side of the terminal by your nails.

Insert SAM cards / SIM card / Micro SD card to the related card slots.

Close the trapdoor.

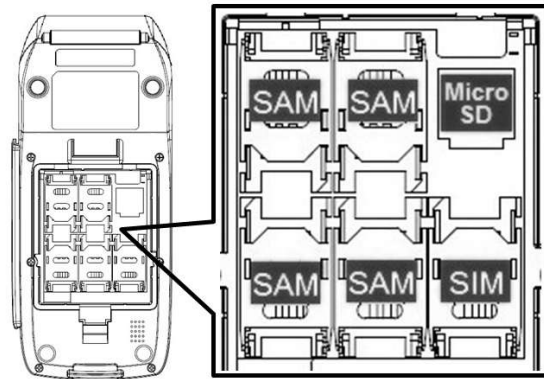

### 2. Rechargeable Battery

Unclip the trapdoor on the bottom side of the terminal by your nails.

Place the battery over the SAM card and SIM card slot. Make sure that metal plates on the battery would touch with the metal contacts in the battery case of terminal.

Close the trapdoor.

### 3. Charging the battery

Connect the 9V DC power supply provided together with ACR900 to the power port on ACR900.

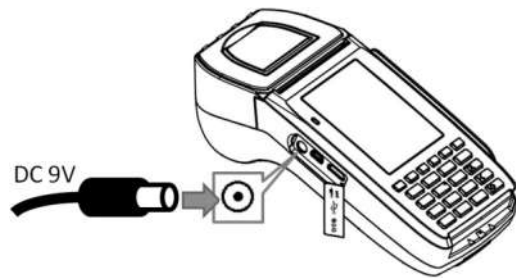

### 4. Paper roll

Lift the tab on the printer cover to open the paper compartment.

Place a paper roll (diameter not over 37mm) in the compartment

Press simultaneously on both upper corners of the printer cover until it clips into position.

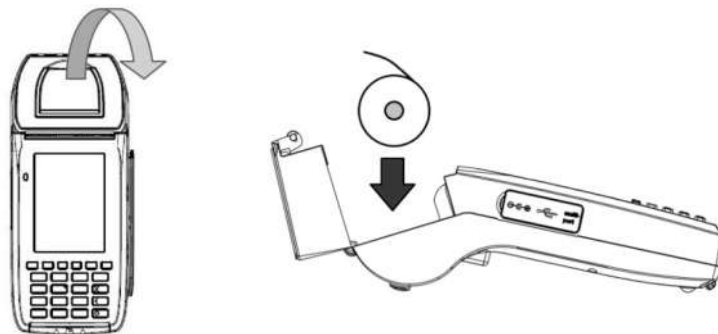

### 5. Connecting to Ethernet, USB devices and Serial devices

Connect the ACR900 to the interface module with the specific cable provided together with ACR900.

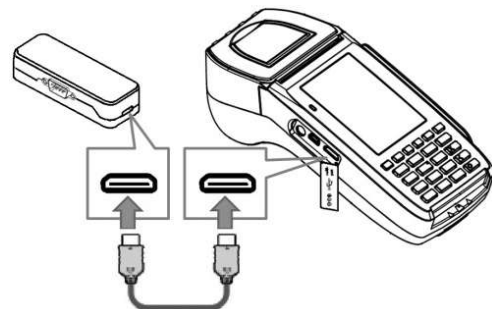

Connect the Ethernet cable, USB cable or Serial cable to the specific port on the interface module





## II. Operating instruction

### 1. Turn ON / OFF

Press  button for 3 seconds to Turn ON.

Press  button for 3 seconds until the LCD shows Turn OFF confirm page; Press  button (enter key) to confirm Turn OFF.

### 2. Sleep / Wake

Press  button and LCD turns off. Press  button again to turn LCD on.

### 3. Reading Smart Card (contact)

Insert the card horizontally with chip facing upward until the card reaches the end in the card slot. Leave the card in the card slot throughout a transaction.

### 4. Reading Smart Card (contactless)

Tap the card firmly in the active zone over the printer cover. Keep the card close to the zone during a transaction.

### 5. Reading Magnetic Stripe Card

Swipe the card with the stripe facing to the terminal either from top to bottom or bottom to top. Use a regular movement inside the track.

### 6. Feeding paper

Press  button to feed paper. DO NOT pull the paper by hand.

### 7. Tearing the printing paper

Pull the receipt against the printer cutter at an angle either from left to right or from right to left.

## III. Caution

Never disassemble the terminal without approval.

Only use the power supply included with the terminal or provided by ACS

Turn off the terminal before opening the trapdoor.

Avoid the terminal contact with water.

## IV. Rechargeable Battery

Only use the rechargeable battery provided together with the terminal or provided by ACS.

Avoid placing the battery directly under the sun, or environment of high temperature or high humidity.

Do not short-circuit the battery

Do not disassemble the battery

### **FCC Caution.**

This device complies with part 15 of the FCC Rules. Operation is subject to the following two conditions: (1) This device may not cause harmful interference, and (2) this device must accept any interference received, including interference that may cause undesired operation.

Any Changes or modifications not expressly approved by the party responsible for compliance could void the user's authority to operate the equipment.

**Note:** This equipment has been tested and found to comply with the limits for a Class B digital device, pursuant to part 15 of the FCC Rules. These limits are designed to provide reasonable protection against harmful interference in a residential installation. This equipment generates uses and can radiate radio frequency energy and, if not installed and used in accordance with the instructions, may cause harmful interference to radio communications. However, there is no guarantee that interference will not occur in a particular installation. If this equipment does cause harmful interference to radio or television reception, which can be determined by turning the equipment off and on, the user is encouraged to try to correct the interference by one or more of the following measures:

- Reorient or relocate the receiving antenna.
- Increase the separation between the equipment and receiver.
- Connect the equipment into an outlet on a circuit different from that to which the receiver is connected.
- Consult the dealer or an experienced radio/TV technician for help.

### **FCC Radiation Exposure Statement:**

Specific Absorption Rate (SAR) information

SAR tests are conducted using standard operating positions accepted by the FCC with the Banking POS Terminal transmitting at its highest certified power level in all tested frequency bands, although the SAR is determined at the highest certified power level, the actual SAR level of the Banking POS Terminal while operating can be well below the maximum value. Before a new model Banking POS Terminal is available for sale to the public, it must be tested and certified to the FCC that it does not exceed the exposure limit established by the FCC, tests for each Banking POS Terminal are performed in positions and locations as required by the FCC. For body worn operation, this model Banking POS Terminal has been tested and meets the FCC RF exposure guidelines when used with an accessory designated for this product or when used with an accessory that contains no metal.