

R2™

REMOTE WIRELESS HEADSET

BY ADVANCED WIRELESS TECHNOLOGIES, INC.

USER'S GUIDE



REMOTE WIRELESS HEADSET IS EXCLUSIVELY DISTRIBUTED BY
GLOBALPLEX WIRELESS

R2 & R2N are trademarks of
Advanced Wireless Technologies, Inc. New York, New York 10022



REMOTE WIRELESS HEADSET IS EXCLUSIVELY DISTRIBUTED BY
GLOBALPLEX WIRELESS

MADE IN KOREA

Caution:

Changes or modifications not expressly approved by Advanced Mobile Solutions would void the user's authority to operate the equipment.

USER'S GUIDE

R2 WIRELESS HEADSET WITH BELT CLIP BASE STATION

Key Features :

- Mobility
- Low emission rate
- Uses AAAA battery for Headset and AAA for belt clip, No charger required.
- 10 hours talk time & 20 days stand by for the headset with AAAA battery
- Auto ON/SLEEP mode to conserve power
- 20 hours of usage & 30 days stand by for the belt clip with AAA battery
- Noise canceling microphone for clear calls
- Light weight, Mechanically stable
- Works on either right or left ear.
- Range: Maximum 1.5meters(5ft.) from the beltdclip to remote headset
- Compatible with all Cellular/Mobile phones
- Hearing Aid compatible!

1. BATTERY INSTRUCTIONS:

- Ensure the AAA battery is installed properly in the Belt clip and AAAA in the Headset. Refer to the battery cover for correct placement.

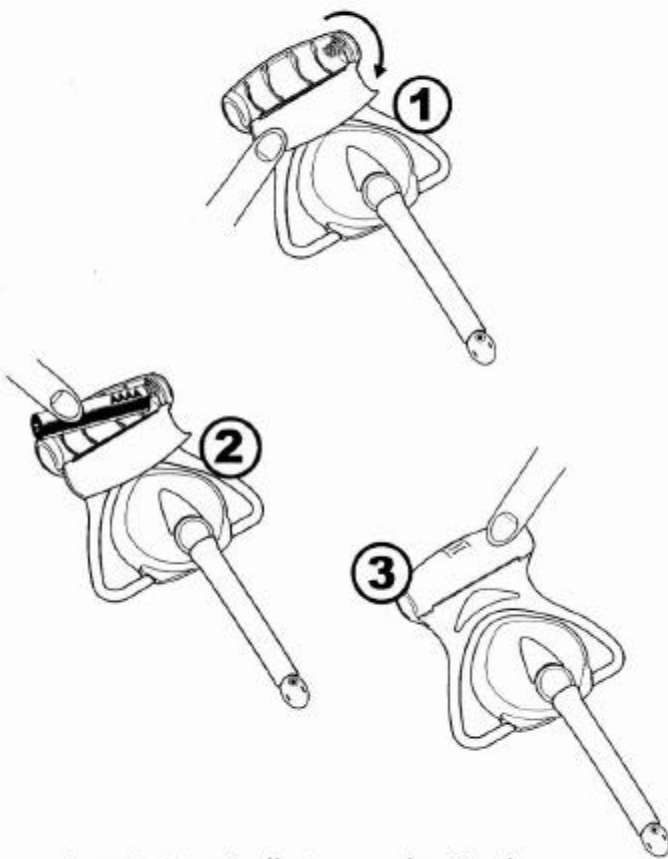

- **Low Battery Indicator on the Headset**
When the battery is within one or two hours of low battery life, you will hear a high beeping tone indicating it is time to replace the battery.

• Belt clip Base Station

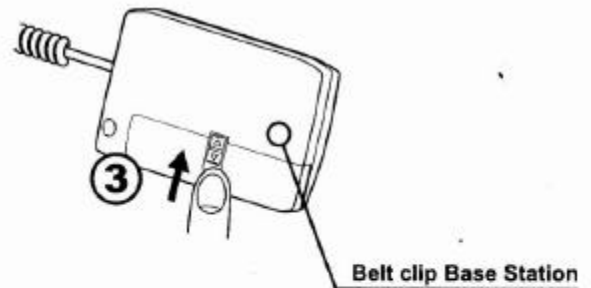
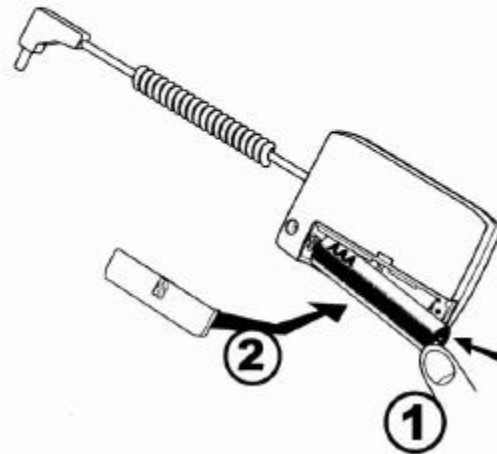

- **Low Battery Indicator on the Belt clip.**
When the battery is within one to two hours of low battery life, you will hear a low beeping tone indicating it is time to replace the battery.

2. OPERATION:

1. Plug in the 2.5 mm audio plug from the Belt clip into the Cellular/Mobile phone. Headset adapter is required if your Cellular/Mobile phone does not have a headset jack. (Consult your sales person)

■ Cellular/Mobile phone WITH Headset Jack

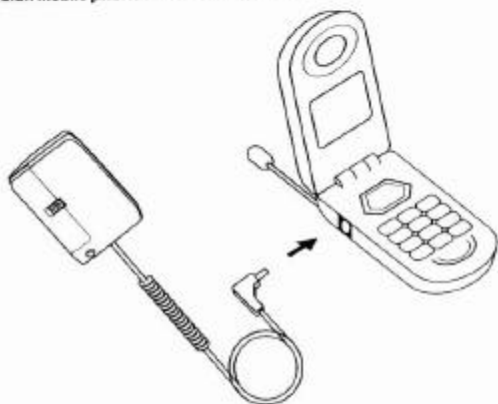

■ Cellular/Mobile phone WITHOUT Headset Jack

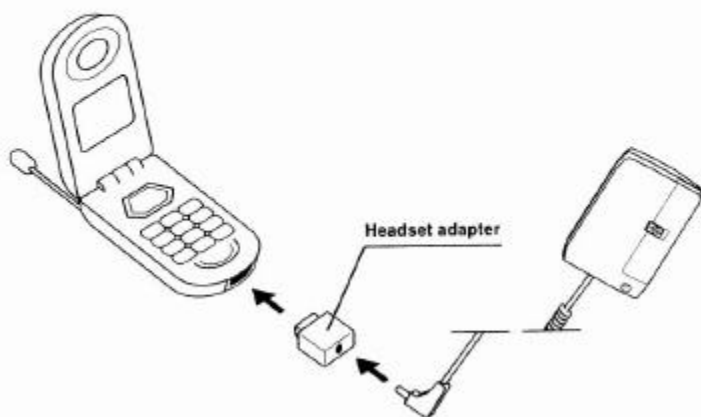

2. The Belt clip plugged into the Cellular/Mobile phone can be carried anywhere within 1.5meters(5ft.) of the Headset.

- The units are designed for long battery life. However, if you are not using the Belt clip and Headset for an extended period of time, please detach the battery from the both units.

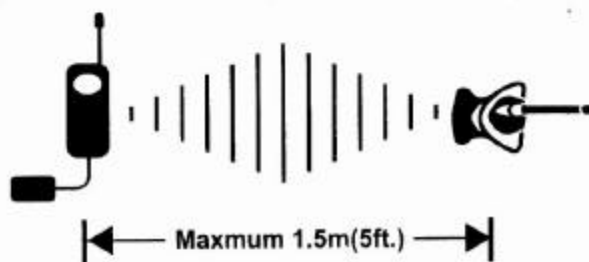

3. Boot Operation Digram

- You may change the color of the boom by replacing the boot as shown below.

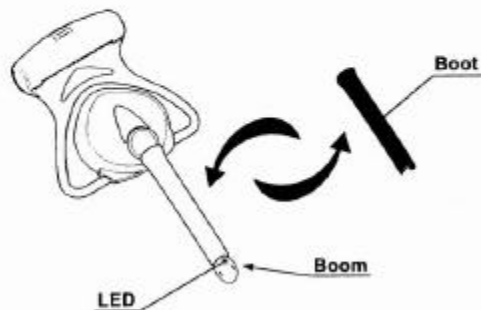

SPECIAL FEATURE:

- The Headset & the Belt clip will automatically assume a sleep mode (battery conservation mode) when the call is NOT in progress. The headset will automatically wake up when a call is received or placed.
- LED on the boom indicates that the Headset is in use. It flashes every 2 seconds while being used.

• Putting on the headset

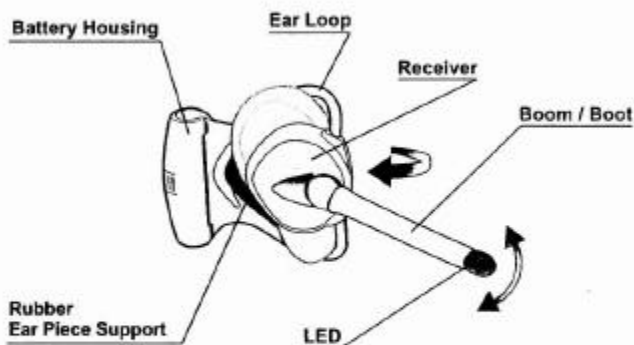

RECEIVING A CALL:

- You should have the Headset on either ear.
 - Simply push the **SEND, ANSWER or YES button** on your Cellular/Mobile Phone to start the conversation.
 - You may set up an any-key answering feature to answer an incoming call by pressing any key on the key-pad except the "Power Key". The Headset provides a simple ring, alerting the user that there is an incoming call.
 - The ringer volume can be adjusted from the Cellular/Mobile phone. To adjust the earpiece volume, simply press the "up" or "down" key on the Cellular/Mobile phone to adjust the earpiece volume during a call.
- Note: This feature cannot be used if the Keypad Lock is on.*
- Please replace the battery, if there is no alerting ring sound from the Headset.
 - To terminate a call simply press the **"END or NO Button"**.

PLACING A CALL:

- You should have the Headset on either ear.
- Place a call as you normally would. Enter the phone number and be sure to press the "SEND" or "YES" button on the Cellular/Mobile phone. You will hear a simple ringing tone in the headset when you press the "SEND" or "YES" button. This alerts you that the call is in progress.

Note: You will hear the Touch Tone when dialing depending upon Cellular/Mobile phone.

3. TROUBLESHOOTING:

If you experience problems with your Headset & the Belt clip, ensure the following:

- Check the power of the Headset & the Belt clip. (Press any key on the keypad except the "Power Key" for more than 2 seconds. If you don't hear any sound from the Headset, please replace the batteries in the Headset & the Belt clip.)
- Both AAA battery in the belt clip and AAAA battery in the headset are installed correctly.
- Check to see the 2.5 mm audio plug from the Belt clip is plugged properly into the Cellular/Mobile phone.
- Cellular/Mobile phone is within service coverage area.
- Headset is within 1.5m(5ft.) of the Belt clip.
- Make sure the Belt Clip Audio Jack is plugged securely into any adapter being used, in order to insure quality transmission.
- Carrier transmission can effect the quality of your conversation. Always check the bars on your phone to make sure you have good signal strength.



STATIC OR INTERFERENCE - ESPECIALLY INSIDE BUILDINGS MAY DEPEND UPON YOUR SERVICE PROVIDER AND THEIR COVERAGE. DISCONNECTS CAN OCCUR WHILE ROAMING AND IS NOT THE FAULT OF THE HEADSET. INTERFERENCE OR STATIC CAN OCCUR DURING THE USE OF CELLULAR/MOBILE PHONES WHEN IN RANGE OF KITCHEN APPLIANCES, POWER TOOLS, COMPUTERS, CAR RADIOS AND TELEPHONE LAND LINES.

WHEN USING THE UNIT WHILE DRIVING KEEP YOUR CAR AIR CONDITIONER LOW WHEN POSSIBLE. THIS WILL ELIMINATE BACK GROUND WIND NOISE DURING CONVERSATION. DRIVING WITH THE WINDOW OPEN OR HAVING A CONVERTIBLE TOP DOWN WILL ALSO CREATE BACK GROUND WIND NOISE.

GSM PHONE WITH EXPOSED ANTENNA'S MAY CAUSE BUZZING SOUND. IT IS RECOMMENDED THAT YOU KEEP THE BASE STATION/ BELT CLIP AT LEAST THREE INCHES FROM THE HANDSET DURING USE.

INTERFERENCE WILL OCCUR WHEN TWO R2 OR R2N UNITS ARE BEING USED WITHIN TEN FEET OF EACH OTHER.

4. MAINTENANCE:

The following suggestions will help you care for your Headset & the Belt clip units.

- Keep the units dry. If they do get wet, wipe with a soft cloth and dry it immediately.
- Use and store only in normal temperature environments.
- Handle the Headset & the Belt clip units gently. Dropping them can cause damage.
- Wipe the Headset & the Belt clip with a dampened cloth occasionally to keep the units looking new.
- Use only a fresh AAA / AAAA battery or rechargeable battery of the recommended size and type for both the Headset and the Belt clip.

5. CAUTION:

Do not attempt the following while driving:

- Putting on or adjusting your Headset.
- Placing a call.
- Changing the battery.



Do not leave the Headset on car dashboard or in direct sunlight.