

Storage

Store Hugs Tags at room temperature.

Warranty

Stanley Healthcare's products are warranted against defects in materials and workmanship and shall perform in accordance with published specifications for a period of one year. Stanley Healthcare reserves the right to change specifications without notice.

Limitation of Liability

This Product has been designed for use to assist in the prevention of infant abduction and/or mother/infant mismatching incidents.

The range, accuracy, function and performance of this Product may vary from the published specifications due to many factors, including, but not limited to, site impairments from structural effects, metal objects in the vicinity, placement of the receiver and transmitter, interference from other electrical devices, atmospheric effects, installation, and maintenance. There may be other factors, which also affect performance of this Product.

Stanley Healthcare ("Stanley") does not guarantee that this Product will detect 100% of infant abductions and/or mother/infant mismatch incidents, nor does Stanley guarantee that this Product will be free from returning false reports of infant abductions and/or mother/infant mismatch incidents.

Monthly testing and maintenance of this Product, as described in the Product documentation, is essential to verify the system is operating correctly and to ensure that the probability of detecting an alarm and/or locating the transmitter are maximized.

The failure to undertake regular testing and maintenance will increase the risk of system failure and failure to detect infant abductions and/or mother/infant mismatch incidents. The failure to undertake regular testing and maintenance will increase the risk of false reports of infant abductions and/or mother/infant mismatch incidents.

Stanley hereby disclaims all warranties, express or implied, arising out of or in connection with any of its Products of the use or performance thereof, including but not limited to, where allowable by law, all other implied warranties or conditions of merchantability, fitness for a particular purpose, and those arising by statute or otherwise in law or from a course of dealing or usage of trade.

Stanley's liability to you or anyone claiming through or on behalf of you with respect to any claim or loss arising out of the use or misuse of Stanley's Product, defective products or materials, improper installation or maintenance of Stanley's Product or products or the system in which they are incorporated, or alleged to have resulted from an act or omission of Stanley or any person, negligent or otherwise, shall be limited to the following, at Stanley's sole option:

- a) the repair or replacement of defective Product or materials supplied by Stanley during the warranty period as set out in the Product documentation; or, at the option of Stanley,
- b) a refund of the purchase price of the Product supplied by Stanley.

In no event shall Stanley be liable for general, specific, indirect, consequential, incidental, exemplary or punitive damages or any losses or expenses suffered by you or anyone else, whether or not Stanley, or its employees, officers, agents, resellers or installers has been informed of the risk of such loss or expense and whether or not such losses or expenses were foreseeable.

Statements

Federal Communication Commission (FCC)

This equipment has been tested and found to comply with the limits for a Class B digital device, pursuant to Part 15 of the FCC rules. These limits are designed to provide reasonable protection against harmful interference in a residential installation.

This equipment generates, uses and can radiate radio frequency energy and, if not installed and used in accordance with the instructions, may cause harmful interference to radio communications. However, there is no guarantee that interference will not occur in a particular installation. If this equipment does cause harmful interference to radio or television reception, which can be determined by turning the equipment off and on, the user is encouraged to try to correct the interference by one or more of the

following measures:

- a) **Reorient or relocate the receiving antenna.**
- b) **Increase the separation between the equipment and receiver.**
- c) **Connect the equipment to an outlet on a circuit different from that to which the receiver is connected.**
- d) **Consult the dealer or an experienced radio/TV technician.**

This device complies with Part 15 of the FCC Rules.

Operation is subject to the following two conditions:

- 1) **This device may not cause harmful interference**
- 2) **This device must accept any interference received, including interference that may cause undesired operation.**

WARNING! Changes or modifications to this unit not expressly approved by the party responsible for compliance could void the user's authority to operate the equipment.

This device complies with FCC Rules Part 15 and with Industry Canada licence-exempt RSS standard(s). Operation is subject to two conditions: (1) This device may not cause harmful interference, and (2) this device must accept any interference that may be received or that may cause undesired operation.

Le present appareil est conforme aux CNR d'Industrie Canada applicables aux appareils radio exempts de licence. L'exploitation est autorisée aux deux conditions suivantes: (1) l'appareil ne doit pas produire de brouillage, et (2) l'utilisateur de l'appareil doit accepter tout brouillage radioélectrique subi, même si le brouillage est susceptible d'en compromettre le fonctionnement.

Hugs®
Infant Protection

Hugs® Wi-Fi Tag User Sheet

Stanley Healthcare

130 Turner Street, Waltham, MA 02453

Phone: +1-888-622-6992

Email: stanleyhealthcare@sbdinc.com

www.stanleyhealthcare.com

Part Number: TAG-HGS-1000

© 2013 Stanley Healthcare. All Rights Reserved. 07/2013: 0980-031 Rev 01.

Instructions for the Hugs® Wi-Fi Tag

Introduction

The Hugs Wi-Fi Tag with BabySense™ functionality is part of the Hugs infant protection system. The Hugs Tag is applied to the infant using a tamper-proof band. From the moment it is activated, the tag begins to send “check in” messages indicating that it is OK. The infant is automatically enrolled in the system and protected against abduction. The Hugs Tag incorporates a special sensor to detect if:

- the tag is removed from the infant
- the band is cut

In addition, attempting to remove the infant without authorization from the protected area will immediately cause an alarm.

The Hugs Tag is reusable, and does not interfere with other hospital or personal medical equipment.

The patented asymmetrical shape of the tag ensures that it does not pinch or irritate the baby’s skin, and also helps prevent it from being kicked off, while still allowing the ankle joint to move freely.

The Hugs Tag is water proof which allows bathing of the infant. It is also resistant to soiling and UV light.

The Hugs Tag has an expiration date of 2 years from the time it is first activated into the Hugs system. After 2 years, you will not be able to admit the tag into the Hugs system.

Cleaning the Tag

Note: The tag is not sterilized at the factory. You may wish to clean it before first use.

The Hugs Tag can be cleaned using a soft-bristle brush. Follow these guidelines for cleaning the tag:

- First, consult with your Infection Control representative for cleaners available to your hospital that have been approved for use on plastics.
- Use a disinfectant with no more than 20% alcohol or enzymatic cleaners with a mild pH such as Enzol or Maxizyme.
- Do not use pathogenic cleaners specified for TB.
- Do not soak the Hugs Tag.
- Do not use an autoclave to clean the tag or serious damage may result.

Items Required

- Hugs Tag (p/n TAG-HGS-1000)
- Hugs Tag bands (p/n 806A1401 or 806A2001)
- Safety scissors

Applying the Tag

The Hugs Tag should be placed on the opposite limb or below other hospital bracelets.

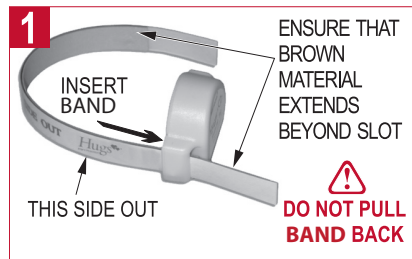

- 1 Align band with tag slot.
- 2 Make sure “This side out” is on the outside.
- 3 Insert band into tag slot starting from bottom of tag.
- 4 Pull through until the brown material extends beyond the slot about 1/4 inch.

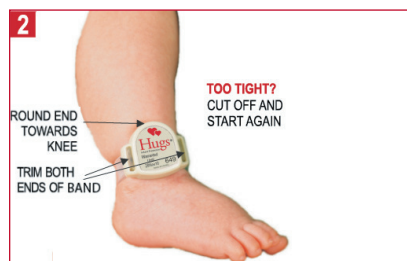

- 1 Wrap tag around baby’s ankle, placing tag on outer aspect of ankle and insert loose end of band into second tag slot.
- 2 Pull band through, and listen for the battery status chime (two short beeps). Check that the tag is snug and does not rotate. The bottom (black) side of the tag and the band must be in light contact with the baby’s skin.
- 3 Trim both ends of band.



Assessing Tag Fit

When you apply a tag to the infant, you need to make sure that a secure fit is obtained. A secure fit is defined as a fit snug enough to prevent the tag from slipping over the heel while ensuring that the back of the tag maintains light contact with the infant’s skin.

- 1 It is recommended that a staff member examine each Hugs Tag and tag site regularly (per hospital policy) for appropriate fit and the absence of any skin irritation.
- 2 If skin irritation is noted, relocate the tag site immediately.
- 3 If the Hugs Tag appears to be too tight, as evidenced by tag or band impressions on the infant’s skin or the inability to move the tag on the skin surface, remove the tag immediately and apply a new band.

Removing the Tag

- 1 Discharge the baby (tag) from the Hugs system.
- 2 Cut the band on the Hugs Tag using safety scissors. Push the band pieces through from the bottom to the top of the tag, using a rocking motion. Make sure no band debris remains around the gold contacts in the slots of the Hugs Tag.
- 3 Return the tag for cleaning and reuse.

Battery Information

The Hugs Tag uses a non-replaceable chargeable battery. (Lithium battery 4.2V).

The Hugs system software automatically displays a Low Battery notification if the Hugs Tag enters a low battery state during use.

If you hear the low battery status chime (Mismatch tone) when you apply the tag, immediately pull the tag from service and place it in the charger.

Handling Information

Battery Handling - This device contains a lithium battery. Do not force open, heat to 212°F (100°C), or dispose of in fire.

X-rays - Do not directly expose the tag to X-rays. (The tag is not affected by stray radiation.)

MRI - This tag contains metal components and is not approved for use near MRI equipment.