

ALCATEL

Versatis P100



USER MANUAL

Before you begin

Electrical safety

- Don't let the base unit or charger gets wet. Electrical equipment can cause serious injury if used while you are wet or standing in water.
- If the base unit or charger ever falls into water, don't retrieve it until you have unplugged the power lead from the mains and the telephone line plug from the telephone socket (base unit only); then pull it out by the unplugged cables.
- Never use your cordless handset outdoors during a thunderstorm unplug the base unit from the telephone line and the mains socket when there are storms in your area. Damage caused by lightning is not covered by the guarantee.

Interference

If the sound quality gets worse as you move around while on a call, this is probably caused by interference between the handset and the base unit, perhaps because you are too near to another phone or other electrical equipment. Move to a different position to clear the interference. If you do not move, your call may be cut off.

NOTE: Radio interference in the environment may occasionally cause a short break in the link between the handset and the base unit while you are on a call. The handset's display will flash briefly, while the unit automatically restores the link.

Out of range warning

If you hear a warning tone during a call, and the sound in the earpiece becomes faint or distorted, you may be going out of range of the base unit. Move nearer to the base unit within 20 seconds, until the warning tone stops. Otherwise, your call may be cut off.

PARTS CHECKLIST

Make sure your package includes the items:

Versatis P100

- 1 Handset
- 1 Base station
- 1 AC power adaptor
- 1 Telephone line cord
- 2 Rechargeable batteries

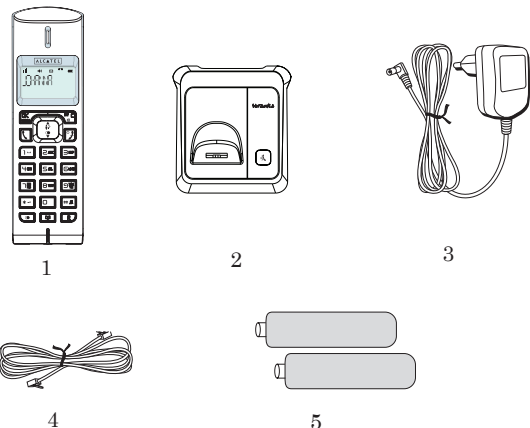

Versatis P100 duo

- 2 Handsets
- 1 Base station
- 1 charger
- 2 AC power adaptors
- 1 Telephone line cord
- 4 Rechargeable batteries

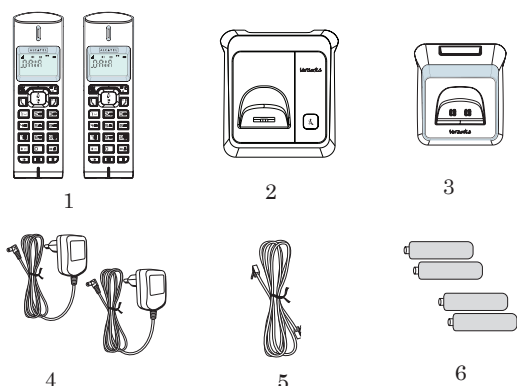

NOTE: If you find any of the parts missing, please contact your local shop where you buy the product. In multi-handset packs, you will find one or more additional handsets, chargers with power supply units and additional rechargeable batteries.

Telephone Jack Requirements

To use this phone, you need a RJ11C type modular telephone jack which might look like the one pictured here. If you don't have a jack, call your local telephone company to find out how to get one installed.

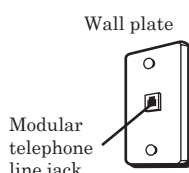

INSTALLATION AND SETUP

CAUTION: Disconnect the phone cord from the wall outlet before installing or replacing the batteries.

- Never install telephone wiring during lightning storm.
- Never touch un-insulated telephone wires or terminals, unless the telephone line has been disconnected at the network interface.
- Never install telephone to operate in wet or damp locations.
- Use only the power pack provided for the base station.
- Use only the supplied NiMH rechargeable batteries.

Installing and Replacing the Batteries

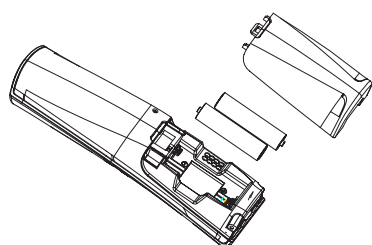

IMPORTANT: If you are not going to use the telephone for more than 30 days, remove the batteries because they may leak and damage the unit.

- Slide open the battery compartment cover.
- Place the 2 batteries as indicated. Respect polarity.
- Slide the battery compartment cover back.
- Put the handset on the base and charge for 15 hours first time. A beep indicates that the handset is properly placed on the base or charger.

NOTE: Don't use non-rechargeable batteries in the handset. They may burst, causing damage.

Installing the base station

Your phone should be placed on a level surface, such as a desk or table top.

- Plug the power supply & line cord into the base station.
- Plug the power supply & line cord into the wall socket.
- Always use the cables provided in the box.

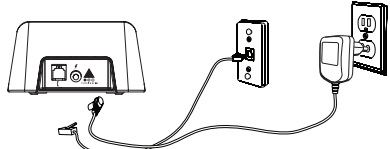

Installing the charger (Versatis P100 duo)

- Plug the power supply into the charger.
- Plug the power supply into the wall socket.
- Always use the cables provided in the box.

CAUTION: Use only the Thomson Telecom power supply that came with this unit. Using other power supplies may damage the unit. Base and charger adaptor type is S002CV0600030, 100-240Vac/6Vdc/300mA.

KEYS AND DISPLAY

Handset Overview

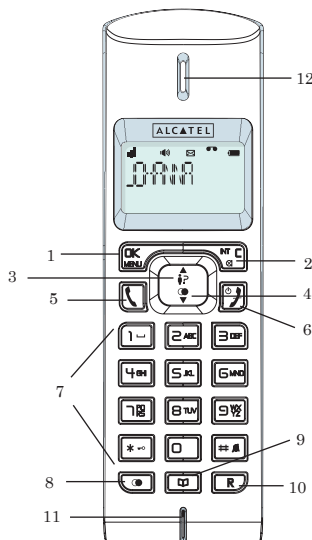

1. LEFT SOFT KEY (MENU/OK)

- In idle mode: Press to access the main menu
- In sub-menu mode: Press to confirm the selection
- During a call: Press to access Intercom/ Phonebook/ Redial List/ Call List

2. RIGHT SOFT KEY (CLEAR/BACK/MUTE/INTERCOM)

- In main menu mode: Press to go back to idle screen
- In sub-menu mode: Press to go back to previous level
- In sub-menu mode: Press and hold to go back to idle screen
- In editing / predialing mode: Press to clear a character / digit
- In editing / predialing mode: Press and hold to delete all the characters / digits
- During a call: Press to mute / unmute the microphone
- In idle mode: Press to intercom another handset

3. UP

- In idle mode: Press to access the call list
- In menu mode: Press to scroll up the menu items
- In Phonebook list / Redial list / Call List: Press to scroll up the list
- During a call: Press to increase the volume
- In ringing: Press to increase the ringer volume

4. DOWN

- In idle mode: Press to access the redial list
- In menu mode: Press to scroll down the menu items
- In Phonebook list / Redial list / Call List: Press to scroll down the list
- During a call: Press to decrease the volume
- In ringing: Press to decrease the ringer volume

5. TALK ON

- In idle / predialing mode: Press to make a call
- In Redial list / Call List / Phonebook entry: Press to make a call to the selected entry in the list
- During ringing: Press to answer a call

6. TALK OFF

- During a call: Press to end a call and go back to idle screen
- In menu / editing mode: Press to go back to previous menu
- In menu / editing mode: Press and hold to go back to idle screen
- In idle mode: Press and hold to power off the handset
- In idle mode (when the handset is powered off): Press and hold to power on the handset

7. ALPHANUMERIC KEYPAD, * (STAR), # (HASH)

- Press to insert a digit / character / * / #
- * key in idle mode: Press and hold to enable or disable the keypad lock
- * key during a call (in Pulse mode): Press to switch to tone mode
- # key in Idle mode: Press and hold to turn on / off the ringer
- 0 key in predialing / number editing mode: Press and hold to insert a pause
- # key in Call List mode: Press to review caller's number if applicable

8. REDIAL LIST

- In idle mode: Press to access the redial list

9. PHONEBOOK

- In idle mode: Press to access the phonebook list

10. FLASH

- In idle / predialing mode: Press to insert a flash
- During a call: Press to dial a flash

11. MICROPHONE

12. EARPIECE

Base Station Overview

- PAGE**
 - Press the Page on the base station to page your handset. It will ring for approximately 60 seconds.
- CHARGING CRADLE**

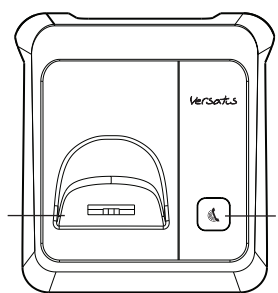

LCD Layout

The screen display gives you information on the current status of the telephone.

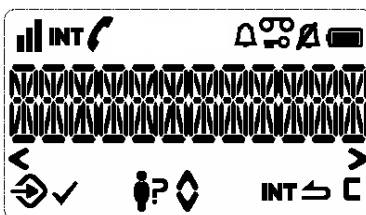

- Scroll up / down the menu items / Phonebook list / Redial list / Call List
- Steady when the handset is in range of the base. Flash when out of range of the base or not registered to the base.
- Steady when an intercom is in progress. Flash when there is an incoming internal call.
- Indicate a call is in progress.
- Indicate that the ringer is switched off.
- Steady when an alarm is set. Flash when the alarm time set before reaches.
- Indicate that the keypad is locked.
- Indicate when there are received new Visual Message Waiting (VMWI) not yet read. Will disappear when all the visual messages have been read.
- Indicate when the battery is fully charged. Whole icon flashes when the battery performs initial charging. Internal block icon flashes when the battery is in final charging stage.
- Indicate when the battery needs charging. Flash when low battery power level is detected.
- Indicate when more characters are existed before the text currently displayed.
- Indicate when more characters are existed after the text currently displayed.
- Press to select more menu options if applicable
- Press to confirm the current selection if applicable.
- Indicate new call in the call list.
- Press <MUTE> to conduct Intercom call when idle
- Press <MUTE> to go back to previous menu level or cancel the current action if applicable
- Press <MUTE> to clear a character or stop the alarm if applicable, press to mute / unmute during a call.

Menu Structure (Handset)

In idle mode, press <MENU/OK> will firstly access the Phonebook menu. Refer to the following for the menu structure.

1. PHONEBOOK

View Records			
ADD	Enter the Name	Enter the Number	Select a Ringer Melody
VIEW			
EDIT			
DELETE			
DELETE ALL	CONFIRM?		
PB STATUS			

2. CALL LIST

View Records			
ADD TO PB	Enter the Name	Edit the Number	Select a Ringer Melody
DELETE			
DELETE ALL	CONFIRM?		
DETAILS			

3. BS SETTINGS

DELETE HS	Enter the PIN	Select a Handset to Delete	
DIAL MODE	TONE		
	PULSE		
FLASH TIME	SHORT		
	MEDIUM		
	LONG		
CHANGE PIN	Enter the Old PIN	Enter the New PIN	Enter the New PIN Again
ECO MODE	ON		
	OFF		

4. HS SETTINGS

RING SETUP	INT RING	Select a Ringer Melody
	EXT RING	Select a Ringer Melody
	RING VOLUME	Select a Ringer Volume
TONE SETUP	KEY TONE	ON
		OFF
	BATTERY TONE	ON
		OFF
	OUT OF RANGE	ON
		OFF
	LANGUAGE	ENGLISH / DEUTSCH / FRANCAIS / РУССКИЙ / ITALIANO / TURKCE/ESPANOL / E*HNIKA / NEDERLANDS / POLSKI / PORTUGUES
	RENAME HS	Enter the Handset Name
	HS DISPLAY	HANDBET NAME
		TIME
	AUTO ANSWER	ON
		OFF
	DIRECT MEM	KEY 1
		KEY 2
		KEY 3

5. DATE & TIME

DATE FORMAT	DD - MM - YY
	MM - DD - YY
TIME FORMAT	12 HR
	24 HR
SET TIME	ENTER TIME
SET DATE	ENTER DATE

6. ALARM

OFF			ON
ON	Set Alarm Time	SNOOZE	OFF

7. REGISTRATION

PIN?

8. DEFAULT

PIN?

Text and Digit Entry Table

The following tables show you where each letter and punctuation character can be found. Respective character table will be used when corresponding menu language is available to select. This will be helpful when storing a name in the phonebook and renaming your handset.

In editing mode, a cursor is displayed to indicate the current text entry position. It is positioned at the right of the last character entered.

WRITING TIPS:

Once a character is selected, the cursor will move to the next position after a short pause.

You can move the cursor within the text by <UP/DOWN> to amend the text entry.

Press <C> to delete the last character.

Press and hold <C> to delete the entire text string.

Key Assignment Overview

Key	Alphanumeric Editing (For phonebook name editing and renaming handset)						Number Editing (For phone number editing, date/time editing)
Key press	1st	2nd	3rd	4th	5th	6th	
1	space	-	1				1
2	A	B	C	2			2
3	D	E	F	3			3
4	G	H	I	4			4
5	J	K	L	5			5
6	M	N	O	6			6
7	P	Q	R	S	7		7
8	T	U	V	8			8
9	W	X	Y	Z	9		9
0	0						0, P (Pause)
*	*	?	/	\	()	*
#	#	.	-	.	&	#	

SETTING THE PHONE

Date and Time Settings

You will need to set the correct time and date so that you know when you received answering machine or call list entries.

Change the date format

- Press <OK> and <UP/DOWN> to select DATE & TIME.
- Press <OK> to select DATE FORMAT.
- Press <UP/DOWN> to select your desired date format (DD-MM-YY or MM-DD-YY).
- Press <OK> to confirm.

Change the time format

- Press <OK> and <UP/DOWN> to select DATE & TIME.
- Press <OK> and <UP/DOWN> to select TIME FORMAT.
- Press <UP/DOWN> to select your desired time format (12 HR or 24 HR).
- Press <OK> to confirm.

Set the time

- Press <OK> and <UP/DOWN> to select DATE & TIME.
- Press <OK> and <UP/DOWN> to select SET TIME.
- Press <OK> to enter the time information. The time entered will be in the format you set in the Change the time format section.
- Press <OK> to confirm.

NOTE: If time has been set before, the current time will display, otherwise, HH:MM will display.

Set the date

- Press <OK> and <UP/DOWN> to select DATE & TIME.
- Press <OK> and <UP/DOWN> to select SET DATE.
- Press <OK> to enter the date information. The date entered will be in the format you set in the Change the date format section.
- Press <OK> to confirm.

NOTE: If date has been set before, the current date will display, otherwise, DD-MM-YY will display.

Alarm Settings

You can use this phone to set an alarm clock. When an alarm is set, the <ALARM Icon> displays on the screen. When the alarm time is reached, the <ALARM icon> and ALARM ON flash on the screen ringing with the alarm melody for a duration of 45 seconds. You can press any key to disable the alarm. If snooze function is activated, the alarm will sound again at the end of the snooze period of seven minutes.

NOTE:

- Key press is still applicable if handset keypad is locked and when the alarm time is reached.
- The alarm volume level is the same as the settings of the handset ringer volume. If the handset ringer is set to VOLUME OFF, the alarm still sounds at VOLUME 1 level.
- During an external call or internal call, if an alarm is set and when the alarm time is reached, the <ALARM icon> and ALARM ON will still flash. An alarm tone will be emitted from the earpiece to notify user the alarm time is reached. Once user press any key or press and hold <TALK OFF> to disable the alarm, it will revert to the call duration screen.
- During paging or ringing, the alarm will not sound when the alarm time is reached. However, if snooze function is enabled, the alarm will sound again at the end of the snooze period provided that it's not ringing or in paging mode at the end of the snooze period.

Turn on/off the alarm

- Press <OK> and <UP/DOWN> to select ALARM.

INTRODUCTION

Thank you for choosing Versatis P100. Before using this phone, please read the SAFETY INSTRUCTIONS first. Your phone comes with various features. Please thoroughly read this user manual for all the feature operation and troubleshooting information you need to install and operate your new phone.

SAFETY INSTRUCTIONS

When using your telephone equipment, basic safety precautions should always be followed to reduce the risk of fire, electric shock and injury, including the following:

- Read and understand all the instructions.
- Follow all warnings and instructions marked on the product.
- Unplug this product from the wall outlet before cleaning. Do not use liquid cleaners or aerosol cleaners. Use a damp cloth for cleaning.
- Do not use this product near water (for example, near a bath tub, kitchen sink, swimming pool).
- Do not overload wall outlets and extension cords as this can result in the risk of fire or electric shock.
- Unplug this product from the wall outlet under the following conditions:
 - When the power supply cord or plug is damaged or frayed.
 - If the product does not operate normally by following the operating instructions.
 - If the product has been dropped and the cabinet has been damaged.
 - If the product exhibits a distinct change in performance.
- Avoid using a telephone (other than a cordless type) during an electrical storm. There may be a remote risk of electric shock from lightning.
- Do not use the telephone to report a gas leak in the vicinity of the leak.
- Use only the supplied NiMH (Nickel Metal Hydride) batteries! The operation periods for the handsets are only applicable with the default battery capacities
- The use of other battery types or non-rechargeable batteries/primary cells can be dangerous. These may cause interference and/or unit damages. The manufacturer will not be held liable for damage arising from such non-compliance.
- Do not use third party charging bays. The batteries may be damaged.
- Please note the correct polarity while inserting the batteries.
- Do not immerse batteries in water, do not place in fire.

IMPORTANT: In order to use this unit, you must subscribe to either the standard Name/Number Caller ID Service.

IMPORTANT: Because cordless phones operate on electricity, you should have at least one phone in your home that isn't cordless, in case the power in your home goes out.

WARNING: TO PREVENT FIRE OR ELECTRICAL SHOCK HAZARD, DO NOT EXPOSE THIS PRODUCT TO RAIN OR MOISTURE.

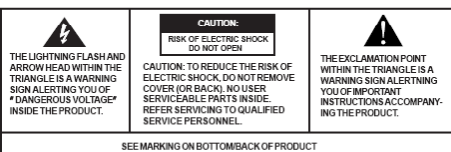

Battery Safety Precautions

- Do not burn, disassemble, mutilate, or puncture. Like other batteries of this type, toxic materials could be released which can cause injury.
- To reduce the risk of fire or personal injury, use only the battery listed in User's Guide.
- Keep batteries out of children.
- Remove batteries if storing over 30 days.

CAUTION: Danger of explosion if battery is incorrectly replaced. Only use GPI or BYD Ni-MH AAA 1.2V/500mAh rechargeable battery or equivalent in the handset. Only use rechargeable batteries with exactly the same specifications as those supplied with the product. Using non-rechargeable or non-conforming batteries can damage the product. The batteries could split or leak if incorrectly inserted, opened or exposed to heat. Never dispose of batteries in a fire: the cell could explode. Check with local code for possible special disposal instruction.

MAIN FEATURES

- FSK/DTMF Caller ID auto detect
- Up to 10 records of received Call Log
- Up to 10 records of Phonebook
- Up to 5 records of Redial List
- Personalized settings for Handset and Base (Ringer, Ringer Volume, Handset Name, etc.)
- Visual Message Waiting Indicator (Network independent)
- Alarm

- Press <OK> and <UP/DOWN> to select **ON/OFF**.

- Press <OK> to confirm.
- NOTE:** If **ON** is selected, you will be asked to set the alarm time.

Set the alarm time (if the alarm is set to be ON)

- Follow Steps 1 to 3 in Section Turn on/off the alarm.
- Enter the alarm time.
- Press <OK> to set the snooze function.
- Press <OK> and <UP/DOWN> to select ON or OFF.
- Press <OK> to confirm.

Handset Settings

Set the ringer melody for internal calls

- Press <MENU> and <UP/DOWN> to select **HS SETTINGS**.
- Press <OK> to select **RING SETUP**.
- Press <OK> to select **INT RING**.
- Press <OK> and <UP/DOWN> to select the desired ringer melody (a total of 5 melodies for your selection) for setting ringer melody for internal calls.

NOTE: The respective ringer melody will be played while browsing the melody list.

- Press <OK> to confirm.

Set the ringer melody for external calls

- Press <MENU> and <UP/DOWN> to select **HS SETTINGS**.
- Press <OK> to select **RING SETUP**.
- Press <OK> and <UP/DOWN> to select **EXT RING**.
- Press <OK> and <UP/DOWN> to select the desired ringer melody (a total of 5 melodies for your selection) for setting ringer melody for external calls.

NOTE: The respective ringer melody will be played while browsing the melody list.

- Press <OK> to confirm.

Set the ringer volume for external calls

- Press <MENU> and <UP/DOWN> to select **HS SETTINGS**.
- Press <OK> to select **RING SETUP**.
- Press <OK> and <UP/DOWN> to select **RING VOLUME**.
- Press <OK> and <UP/DOWN> to select the desired ringer volume (a total of 6 ringer volume levels including **VOLUME OFF**).

NOTE: The respective ringer volume will be played during your selection. If **VOLUME OFF** is selected, <Ringer Off> icon will display.

- Press <OK> to confirm.

Set alert tones

A single beep is emitted when you press a key. You can turn on or off the key tone. You can also turn on the alert tones when low battery and out of range are detected. Low battery tone will be emitted while you are talking with the phone to alert you that you need to charge up your battery.

- Press <MENU> and <UP/DOWN> to select **HS SETTINGS**.
- Press <OK> and <UP/DOWN> to select **TONE SETUP**.
- Press <OK> and <UP/DOWN> to select **KEY TONE / BATTERY TONE / OUT OF RANGE**.
- Press <OK> and <UP/DOWN> to turn on or off these tones.
- Press <OK> to confirm.

Set the handset language

- Press <MENU> and <UP/DOWN> to select **HS SETTINGS**.
- Press <OK> and <UP/DOWN> to select **LANGUAGE**.
- Press <OK> and <UP/DOWN> to select the desired language.
- Press <OK> to confirm.

Rename the handset

- Press <MENU> and <UP/DOWN> to select **HS SETTINGS**.
- Press <OK> and <UP/DOWN> to select **RENAME HS**.
- Press <OK> and enter the name of your handset.
- Press <OK> to confirm.

Choose the information to be displayed in idle

You can choose to display time or handset name in your idle screen.

- Press <MENU> and <UP/DOWN> to select **HS SETTINGS**.
- Press <OK> and <UP/DOWN> to select **HS DISPLAY**.
- Press <OK> and <UP/DOWN> to select **HANDSET NAME** or **TIME**.
- Press <OK> to confirm.

Set the auto answer

If you turn on the Auto Answer, you can pick up the call from the cradle without pressing any key.

- Press <MENU> and <UP/DOWN> to select **HS SETTINGS**.
- Press <OK> and <UP/DOWN> to select **AUTO ANSWER**.
- Press <OK> and <UP/DOWN> to turn on or off the auto answer feature.
- Press <OK> to confirm.

Store direct memory access number

You can store three direct access numbers into digit KEY 1, KEY 2 and KEY 3, which will be convenient for you to dial to these numbers directly.

- Press <MENU> and <UP/DOWN> to select **HS SETTINGS**.
- Press <OK> and <UP/DOWN> to select **DIRECT MEM**.
- Press <OK> and <UP/DOWN> to select any one from KEY 1, KEY 2 and KEY 3.
- Press <OK> and then enter the number you would like to store, or edit the number existed before.
- Press <OK> to confirm.

Base Settings

The current settings are marked an asterisk which is displayed at the rightmost of the menu item.

De-register a handset

You are requested to enter the 4-digit PIN in order to de-register a handset from the base station. The antenna icon on the de-registered handset will blink.

NOTE: You cannot de-register the handset that you are currently using.

- Press <MENU> and <UP/DOWN> to select **BS SETTINGS**.
- Press <OK> to select **DELETE HS**.
- Press <OK> and you are requested to enter the 4-digit system PIN.
- Enter the 4-digit system PIN.
- Press <OK> and a list of registered handsets is displayed
- Press <UP/DOWN> to select one of the handsets that you want to de-register.
- Press <OK> to confirm.

Change the dial mode

- Press <MENU> and <UP/DOWN> to select **BS SETTINGS**.
- Press <OK> and <UP/DOWN> to select **DIAL MODE**.
- Press <OK> and <UP/DOWN> to select **TONE** or **PULSE**.
- Press <OK> to confirm.

Change the flash time

The flash time setting is country dependent. Please contact your local service provider for the correct settings.

- Press <MENU> and <UP/DOWN> to select **BS SETTINGS**.
- Press <OK> and <UP/DOWN> to select **FLASH TIME**.
- Press <OK> and <UP/DOWN> to select your desired flash time (**SHORT, MEDIUM, LONG**).
- Press <OK> to confirm.

Change the system PIN code

A 4-digit system PIN code is used for changing the system settings of the base station. It is used to protect your phone against unauthorized use. The default system PIN code is 0000.

- Press <MENU> and <UP/DOWN> to select **BS SETTINGS**.
- Press <OK> and <UP/DOWN> to select **CHANGE PIN**.
- Press <OK> and you are requested to enter the 4-digit system PIN.
- Enter the old system PIN.
- Press <OK> and enter the new system PIN.
- Press <OK> and enter the new system PIN again.

NOTE: If the new PIN entered in Step 6 is not matched with the new system PIN entered in Step 5, user is requested to enter the valid system PIN again in Step 5.

- Press <OK> to confirm.

Change the ECO mode

- Press <MENU> and <UP/DOWN> to select **BS SETTINGS**.
- Press <OK> and <UP/DOWN> to select **ECO MODE**.
- Press <UP/DOWN> to select **ON** or **OFF**.
- Press <OK> to confirm.

Registration

Your handset(s) and base station is(are) pre-registered. Up to five handsets can be registered to a single base station.

If for some reason, the handset is not registered to the base station (<Antenna icon> flashes even when the handset is near the base station), register your handset according to the following procedure.

- Press and hold <PAGE> on the base station for about five seconds, the base station is entered into registration mode.
- Press <MENU> and <UP/DOWN> to select **REGISTRATION**.
- Press <OK> and you are requested to enter the 4-digit system PIN.
- Enter the 4-digit system PIN.
- Press <OK> to confirm.

If the handset registration is successful, you will hear a confirmation tone and the <antenna icon> will stop flashing. The handset will automatically be allocated the next available handset number. This handset number is shown in the handset display in standby mode. If the handset registration is

unsuccessful, the <antenna icon> will still flash.

Reset Your Phone

You can reset your phone to the default settings. After reset, all your personal settings will be deleted, but your phonebook, call list and redial list entries remain unchanged.

Press <MENU> and <UP/D OWN> to select **DEFAULT**.

Press <OK> and you are requested to enter the 4-digit system PIN.

Enter the 4-digit system PIN.

Press <OK> to confirm.

- Press <OK> to re-confirm.

DEFAULT SETTINGS

Items	Default Values
EXT RING	MELODY 1
INT RING	MELODY 5
HANDSET RING VOLUME	VOLUME 5
EARPIECE VOLUME	VOLUME 2
HANDSET NAME	HANDSET
KEY TONE	ON
BATTERY TONE	ON
OUT OF RANGE	ON
RINGER OFF	OFF
KEYPAD LOCKED	OFF
AUTO ANSWER	OFF
ECO MODE	ON
HS DISPLAY	HS NAME
DATE FORMAT	DD -- MM -- YY
TIME FORMAT	24 HR
DATE	01/01/09
TIME	00:00
ALARM	OFF
MENU LANGUAGE	ENGLISH
DIAL MODE	TONE
FLASH TIME	LONG
SYSTEM PIN	0000

PHONE OPERATION

Make a Call

Preparatory dialing

Enter the phone number and press <TALK ON> to dial the number. Press <C> to clear the entry.

- Direct Dialing

Press <TALK ON> to take the line and enter the phone number.

- Call from Direct Memory

In idle, press and hold <KEY 1>/<KEY 2>/<KEY 3> to dial the number stored.

OR

Press <TALK ON> and then press and hold <KEY 1>/<KEY 2>/<KEY 3> to dial the number stored. If there is no number stored, unit will emit double beep tones.

- Call from the Phonebook

Press <PHONEBOOK> to access the phonebook and press <UP/DOWN> to select the desired phonebook entry. Press <TALK ON> to dial out to the selected phonebook entry. Alternatively, press <MENU/OK> to access the phonebook to get the desired phonebook entry.

- Call from the Call List

Press <UP> to access the Call L ist and press <UP/DOWN> to select the desired Call List entry. Press <TALK ON> to dial out to the selected Call List entry. Alternatively, press <MENU/OK> to access the Call List from the main menu.

- Call from the Redial list

Press <DOWN> or <REDIAL LIST> to access the redial list and press <UP/ DOWN> to select the desired redial number. Press <TALK ON> to dial out to the selected redial number.

- Call Timer

Your handset automatically times the duration of every call. The call timer will display a few seconds after the call has made. It is shown in hours, minutes and seconds format (HH:MM:SS).

Answer a call

If the handset is not on the charging cradle:

When the phone rings, press <TALK ON> to answer a call.

If the handset is on the charging cradle or the base station and if **AUTO ANSWER** is set to **ON**:

When the phone rings, pick up the handset to answer a call.

End a call

During a call connection, press <TALK OFF> to end the call.

OR

Put the handset on the base station to end the call.

Adjust earpiece volume

There are 5 levels (VOLUME 1 to VOLUME 5) to choose from for each of earpiece volume.

During a call:

Press <UP/DOWN> to select volume 1-5. The current setting is shown. When you end the call, the setting will remain at the last selected level.

Mute a call

You can talk to someone nearby without letting the caller hear you during a call.

During a call:

Press <C> to mute the microphone and **MUTED** will display on the screen. Your caller cannot hear you. Press <C> again to unmute the microphone.

Set the silent mode

In idle, press and hold <HASH> to turn off the handset ringer. The <RINGER OFF icon> is displayed on the screen.

Turn on the keypad lock

In idle, press and hold <STAR *> key to turn on the keypad lock. The <KEYPAD LOCK icon> is displayed on the screen.

Redial the last number

You can redial up to 5 of the last numbers called. If you have stored a name in the phonebook to go with the number, the name will be displayed instead. The most recent last number will display at the top of the redial list.

- Redial a Number from the Redial List

- In idle mode, press <DOWN> to access the redial list.
- Remarks: If redial entry with name, press <HASH> to view the number. OR

- Press <REDIAL LIST> to access the redial list.
- Press <UP/DOWN> to browse the redial list.
- Press <TALK ON> to dial to the selected redial number.

NOTE: If there are no numbers in the redial list, the display shows **EMPTY**.

- Store a Redial Number into the Phonebook

- Follow Steps 1 and 2 in the Redial a Number from the Redial List section.
- Press <MENU> to select **ADD TO PB**.
- Press <OK> to enter the name.
- Press <OK> to store the redial number into the phonebook.
- Press <OK> to select phonebook melody.
- Press <UP/DOWN> to browse the melody list. The respective melody will be played when browsing the melody list.
- Press <OK> to confirm.

- Delete a Redial Number

- Follow Steps 1 and 2 in the *Redial a Number from the Redial List* section.
- Press <MENU> and <UP/DOWN> to select **DELETE ALL**.
- Press <OK> to confirm.
- Press <OK> to confirm again.

Find the Handset

You can locate the handset by pressing <PAGE> on the base station. All the handsets registered to the base will produce the paging tone and PAGING is displayed on the screen. You can stop the paging by pressing <TALK ON> / <TALK OFF> / <C> on any handset or <PAGE> on the base again.
NOTE: If there is an incoming call during paging, the phone will ring with the incoming call instead of paging.

Make an Internal Call

This feature is only applicable when there are at least two registered handsets. It allows you to make internal calls, transfer external calls from one handset to another handset and make conference calls. If the calling is not answered within 60 seconds, the called handset will stop ringing and the calling handset will return to standby mode.

NOTE: If only one handset is registered to the base station, press <INT/

RIGHT SOFT KEY> will display **NOT POSSIBLE**.

- Intercom another handset

- In idle mode, press <INT/RIGHT SOFT KEY> and the registered handsets will display except the calling handset.
- Enter the desired handset number to intercom with.
- The called handset rings and press <TALK ON> on the called handset to establish the internal call.

NOTE: If two handsets are registered to the base station, press <INT/RIGHT SOFT KEY> will connect to another handset immediately.

- Call all handsets

- In idle mode, press <INT/RIGHT SOFT KEY> and the registered handsets will display.
- Press <KEY 9> to ring to all registered handsets.

- Transfer an external call to another handset

During an external call:

- Press <MENU> and <UP/DOWN> to select **INTERCOM**.
- Press <OK> to select the desired handset to intercom with.
- The external call is put on hold automatically and the called handset rings.
- Press <TALK ON> on the called handset to establish an internal call.
- Press <TALK OFF> on the calling handset or put the calling handset on the charging cradle to end the current call with the external party.
- The external call is transferred to the called handset.

- Make a 3-way conference call

The conference call feature allows one external call to be shared with two handsets (in intercom). The three parties can share the conversation and no network subscription is required.

During an external call:

- Follow Steps 1 to 4 in section Transfer an External Call to Another Handset.
- Press and hold <STAR * > on the calling handset to establish the conference call.

Any handset hangs up during a conference call will leave the other handset still in connection with the external call.

PRIVATE PHONEBOOK

Your phone can store up to 10 private phonebook entries with names and numbers. Each phonebook entry can have a maximum of 20 digits for the phone number and 12 characters for the name. You can also select different ringtones for your phonebook entries. Phonebook entries are stored alphabetically by name.

Add a new phonebook entry

In idle:

- Press <PHONEBOOK> to access the phonebook.

OR

Press <MENU> to select **PHONEBOOK** main menu item and then press <OK> to access the phonebook.

- Press <MENU> to select **ADD**.
- Press <OK> to enter the name.
- Press <OK> to enter the number.
- Press <OK> and <UP/DOWN> to select the desired ringtone for your phonebook entry.
- Press <OK> to store the phonebook entry.

Search a phonebook entry

In idle:

- Press <PHONEBOOK> to access the phonebook.
- Enter the first character of the name by multi-tap.

View a phonebook entry

In idle:

- Press <PHONEBOOK> to access the phonebook.
- Press <UP/DOWN> to select the desired phonebook entry.
- Press <MENU> and <UP/DOWN> to select **VIEW**.
- Press <OK> and <UP/DOWN> to review the name, number and melody of the selected phonebook entry.

NOTE: If number is more than 12 digits, press <LEFT SOFT KEY> or <RIGHT SOFT KEY> to view the remaining digits.

Edit a phonebook entry

In idle:

- Press <PHONEBOOK> to access the phonebook.
- Press <UP/DOWN> to select the desired phonebook entry.
- Press <MENU> and <UP/DOWN> to select **EDIT**.
- Press <OK> and the current contents of the selected phonebook entry displays.
- Edit the name and press <OK>.
- Edit the number and press <OK>
- Press <UP/DOWN> to select the ringtone and press <OK> to confirm.

Delete a phonebook entry

In idle:

- Press <PHONEBOOK> to access the phonebook.
- Press <UP/DOWN> to select the desired phonebook entry.
- Press <MENU> and <UP/DOWN> to select **DELETE**.
- Press <OK> to confirm.

Delete the entire private phonebook

- Press <PHONEBOOK> to access the phonebook.
- Press <MENU> and <UP/DOWN> to select **DELETE ALL**.
- Press <OK> to confirm.
- Press <OK> to re-confirm.

Check the phonebook usage

You can check how many phonebook entries have been occupied in your phone and how many phonebook entries are available for you to store in the phonebook.

- Press <PHONEBOOK> to access the phonebook.
- Press <MENU> and <UP/DOWN> to select **PB STATUS**.
- Press <OK> to confirm and X/10 USED will display on the screen.

NOTE: X denotes the current number of stored entries, while 10 denotes the capacity of phonebook memory.

CALER DISPLAY (NETWORK DEPENDENT)

This feature is available if you have subscribed the Caller Line Identification service with your network service provider. Your phone can store up to 10 received calls with date/time information in the Call List. The number will be shown on the screen when the phone is ringing. If the number matches with one of the entries in your Private Phonebook, the caller’s name stored in the private phonebook will be displayed alternatively with the number. The handset will ring with the melody associated with that phonebook entry.

If the caller number is disabled to send caller information, **WITHHELD** will display.

If the caller number is not provided, **UNAVAILABLE** will display.

In standby, if three unanswered calls are received, **3 NEW CALLS** will be displayed.