



**CAUTION-ELECTRIC TOY:**  
Not recommended for children under 6 years of age. As with all electric products, precautions should be observed during handling and use to prevent electric shock.  
**CAUTION-SUPERVISION REQUIRED-**  
**ELECTRIC TOY- UNPLUG WHEN NOT IN USE.**  
INPUT: AC 120V 60HZ  
OUTPUT: DC 9.6V 250MA

#5F5E1D3

# 1:10 HONDA NSX SUPER GT

Thank you for purchasing our product-1:10 Radio Control Race Car. Please read the user manual carefully before using the product, and retain the information for future reference.

## Attention

If batteries are misused, there is possibility of heat generation, explosion and battery leakage. Please be aware of the following:  
- Charger used with the toy are to be regularly examined for damage to the cord, plug, enclosure and other parts, and that, in the event of such damage, the toy must not be used with this charger until the damage has been repaired.  
Remove all tags, twist-ties and plastic loops before giving toy to child.  
Contents and colors may vary.  
Do not mix old and new batteries.  
Do not mix alkaline, standard (carbon-zinc), or rechargeable batteries.

## I. Specifications and functions

- Movements: Forward, backward, turn left, turn right, stop.
- Model Scale: 1:10
- Minimum speed: >10 km/h
- Operating range: ≥20 m
- Batteries: 9.6 V rechargeable battery pack for car; two "AA" battery pack for remote control.

## II. Parts Illustration

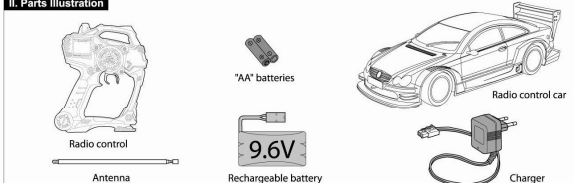

## III. How to charge the battery pack (please perform under parental guidance)

### 1. How to charge

- (1). See diagram 1. Connect battery pack with charger as shown.
- (2). Plug the charger into household socket. (diagram 2)
- (3). Charging takes about 3 hours (Do not charge for too long).
- (4). Unplug charger from the socket.
- (5). See diagram 3. Hold the connection of the charger gently and disconnect both ends follow the direction shown.

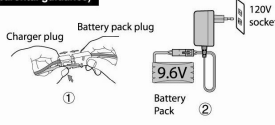

### 2. Usage guide

- (1). For first time usage, charge up fully. If not used for a long period of time, the power will drain away automatically. Overcharging may result in shortening the life of the batteries. (Battery should allow 300-500 times of recharging)
- (2). After usage, the battery pack will heat up and should wait for it to cool down before charging.
- (3). Do not drop, wet or burn the battery pack.
- (4). Keep the battery pack away from reach of young children.
- (5). Do not force the battery pack when removing from the charging unit. Only use the appropriate voltage for charging.
- (6). Never attempt to break up the battery pack.

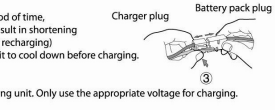

### 3. Charging specifications

- (1). Battery specifications: Ni-Mh Ni 9.6 V
- (2). Charging conditions: Input capacity AC 120V 60Hz/Output capacity DC 9.6 V 250mA/Charging time: 3 hours.

Honda, the Wing and the distinctive designs of Honda motorcycles are trademarks and registered property of Honda Motor Co., Ltd. and used under license from American Honda Motor Co., Inc. All rights reserved.

1

英文版TRU227系列说明书正面 2011-6-2

## IV. Installation of batteries to the control

1. See diagram 1. Remove the cover of the battery cabinet on the control in the order shown.
2. See diagram 2. Install the "AA" battery cell according to the correct polarity.
3. See diagram 3. Close the cover of the battery cabinet on the control in the order shown.

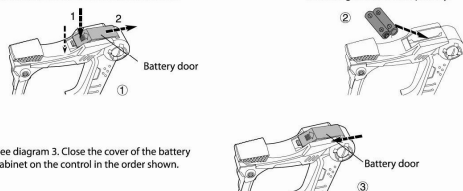

## V. To install and remove antenna

See diagram 1. Insert the antenna to the hole on top of the control; tighten it by turning in clockwise direction.  
See diagram 2. To remove the antenna, turn it counter-clockwise.

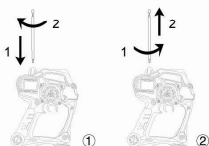

## VI. To install battery to the car

1. See diagram 1. Turn the battery door knob at 180° and open battery door.
2. See diagram 2. Plug in the connectors of the battery pack and the car together.
3. See diagram 3. Insert the 9.6V battery pack into cabinet. Close battery door and turn door knob to lock back.

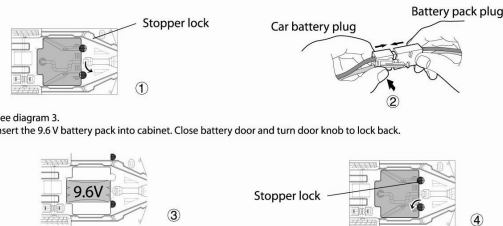

## VII. Methods to operate

1. Switch power button to ON and place it on the ground.

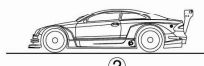

2. Push the controller trigger backward, the car will run forward, and vice versa. Turn the controller rudder counter clockwise, the car will go left, and vice versa.

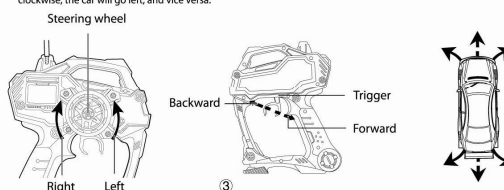

3. To adjust the alignment of the car, twist adjustor tip on car bottom ("R" for right, "L" for left).
4. Make sure to switch the power button to "OFF" once you are finishing racing.



5. Remove the batteries from the car and remote control and store separately.

## VIII. To Consumers

1. Only use this product outdoors in a safe environment.
2. Do not run the car on puddles or sand to avoid circuit failure.
3. Do not pull the wires from the car unit. Broken wire may result function failure.
4. When product is in motion, keep away from moving objects and people.
5. Store the vehicle in a cool, dry place.
6. This product is composed of complicated electronic devices and original parts, please do not attempt to disassemble or alter this product.
7. When batteries are low in power, the car speed will slow down or go out of control. Please change the batteries.

## IX. Regarding frequency and environment

1. When there is another car of similar radio frequency operating nearby, the radio control may not function.
2. When interfered by other radio-waves, the control may not function. Try again at other location or time.
3. This product is designed to run on cement and sand polished surface. If run on wax polished surface, the car cannot move on straight line due to poor contact between the tires and road surface and may also spin 180 degree or pivot.

## NOTE

This equipment has been tested and found to comply with the limits for a Class B digital device, pursuant to Part 15 of the FCC Rules. These limits are designed to provide reasonable protection against harmful interference in a residential installation. This equipment generates, uses and can radiate radio frequency energy and, if not installed and used in accordance with the instructions, may cause harmful interference to radio communications. However, there is no guarantee that interference will not occur in a particular installation. If this equipment does cause harmful interference to radio or television reception, which can be determined by turning the equipment off and on, the user is encouraged to try to correct the interference by one or more of the following measures:  
■ Reorient or relocate the receiving antenna.  
■ Increase the separation between the equipment and receiver.  
■ Connect the equipment into an outlet on a circuit different from that to which the receiver is connected.  
■ Consult the dealer or an experienced radio/TV technician for help.  
This device complies with part 15 of the FCC Rules. Operation is subject to the following two conditions: (1) This device may not cause harmful interference, and (2) this device must accept any interference received, including interference that may cause undesired operation.

Caution: The user is cautioned that changes or modifications not expressly approved by the party responsible for compliance could void the user's authority to operate the equipment.



INCLUDED  
RAY x 1

INCLUDED  
AA x 2

**WARNING:**  
CHOKING HAZARD-Toy contains small parts, Not for children under 3 yrs.

TOYS R US

CONFORMS TO THE SAFETY REQUIREMENTS OF ASTM F963.

FAST LANE is a mark of Geoffroy, LLC, a subsidiary of Toys "R" Us, Inc. © 2011 Geoffroy, LLC. Made in China. Distributed in the United States by Toys "R" Us, Inc., Wayne, NJ 07470. Distributed in Australia by Toys "R" Us (Australia) Pty Ltd., Regents Park NSW 2143. www.toysrus.com

英文版TRU227系列说明书背面 2011-6-2