



85714 Series Remote Control Helicopter



User Manual

3CHANNELS

Thank you very much for purchasing our product – 85714 Series Remote Control Helicopter. Please read the user manual carefully before using the product, and retain the information for future reference.

CAUTION

- Do not mix old and new batteries;
- Non-rechargeable batteries are not to be recharged;
- Exhausted batteries are to be removed from the toy;
- The supply terminals are not to be short-circuited;
- Batteries are to be inserted with the correct polarity;
- Dispose of used batteries properly.
- Batteries should always be replaced by an adult.
- Different types of batteries, new or used are not to be mixed;
- Rechargeable batteries are to be removed from the toy before being charged;
- The helicopter is only to be charged under adult supervision;
- Only batteries of the same or equivalent type as recommended are to be used;
- Do not mix alkaline batteries, standard (carbon-zinc) or rechargeable (Nickel cadmium) batteries.
- Remove batteries from the toy before prolonged storage.
- Do not dispose of battery in fire. Battery may explode or leak as a result.

Specification & Function

- Three channel control: Rise, fall, turn left, turn right, forward, backward and stop.
- Flight height: 15 meters
- Power supply: 6 AA alkaline batteries for remote controller. (Batteries sold separately)
- Remote control distance: equal or more than 20 meters
- Flight time: equal or more than 8 minutes

PACK LIST

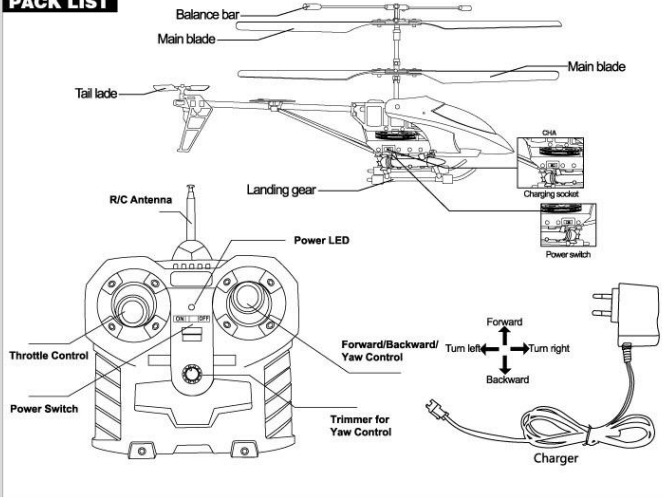

BATTERY INSTALLATION & CHARGING

- Loading of the antenna: screw the antenna clockwise and load it into the screw column of the end of the antenna.
- Battery Installation Transmitter Open the cover of battery case insert 6 batteries (size AA) properly followed by polar indicator, shut the cover of battery case.

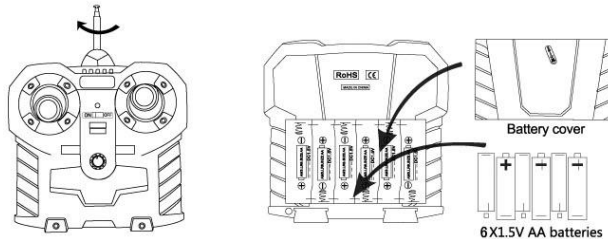

Close the power switch of the helicopter first, connect the charging fork of the charger to the connecting port of the battery. Then plug the charger to the socket. The charging time will be around 2.5 hours.

-Built-in lithium battery (3.7V 1000mAh) inside this product, please pay attention to the safety points below:

- Please do not use the battery to strike or hit against the surface of hard object.
- You can only charge this product by using the original charger which comes together with this product.
- Please don't leave when charging.

- Please do not place it near heated area such as fire or electrothermal device, otherwise it may cause damage or explosion.
- Please do not soak the battery into the water. Battery should be put on the dry and cool place.
- Do not use decomposable battery.

Caution: The user is cautioned that changes or modifications not expressly approved by the party responsible for compliance could void the user's authority to operate the equipment.

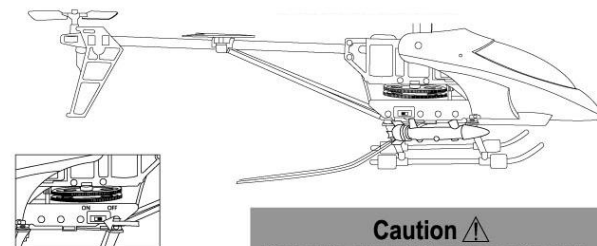

While charging, pull out the switch of the airplane to "OFF" position up.

- Please pull the switch to "OFF" position to avoid excessive discharging of the battery. If the connector is kept connecting, it may cause discharging due to excessive charging and electric consuming for a long time.
- The adapter should be suitable to your local voltage.

FLYING YOUR HELICOPTER

- Move the Power Switch on the helicopter to the ON position, the power indicator will light up.
- Place the helicopter on the ground with the tail pointed towards you.

Hover up and down

When the helicopter flies steadily, you can slowly push the throttle stick up to make helicopter fly higher, or release the stick a bit to make helicopter fly lower. Only small amounts of stick position change are required for smooth flying.

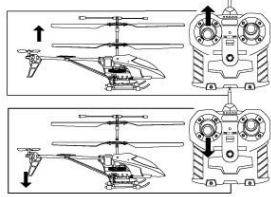

Turn counter clockwise and clockwise

Hold the helicopter at a height. Push the rudder stick toward left to turn counter clockwise, and push the rudder stick toward right to turn clockwise.

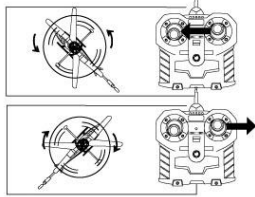

Forward

When you push up the right control lever (steering rudder), the nose inclines to down, the helicopter is moving forward.

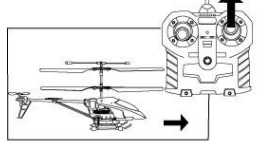

Backward

When you push down the right control lever (steering rudder), the nose inclines to up, the helicopter is moving backward.



Note: If the helicopter rotates whilst in operation, please use the rudder trim to adjust.

If the helicopter spins during flight, follow the procedure below to stop the rotation.

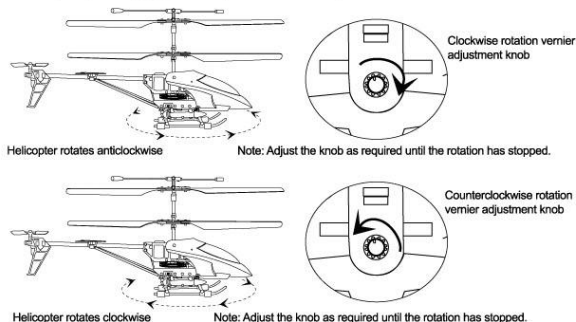

Pack List & Introduction

Pack List

- Charger x1
- Main blade A x1
- Main blade B x1
- Tail lade x1

Introduction

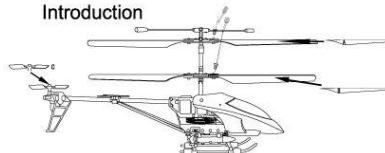

OPERATION

- * Don't operate the helicopter under the direct sun or strong lighting; it will affect the control system of your helicopter.
- * Don't cover the lens of the transmitter. No signal will be released while you cover the lens.
- * Don't stick any other label onto the helicopter; the other label will affect receiving of IR signal.
- * The product uses light-minded materials, it will easy to damage if operate incorrectly, tumble or bump or another factor will shatter the product.

ENVIRONMENT FOR FLIGHT:

1. Fly in indoor environment with calm air condition, outdoor environment with breeze or no wind. Beware of the air circulation from the air-conditioner.
2. Space area: It is recommended to have to have space area over 20ft (W)*30ft (L)*10ft (H).
3. Safety area: It is recommended that there is no electric fan, air-conditioner, reading lamp or other dangerous objects for flying.

IMPORTANT SAFETY INFORMATION:

- Keep SKYROVER™ Helicopter clear from face and eyes at all times.
- Keep fingers away from spinning rotors.
- Always fly in wide open space without any obstacles.
- Do not fly towards people or animals.
- Do not fly under adverse weather condition.
- Always fly in warm and sunny days, with little or no wind.
- Do not fly in temperatures below 45°F/7°C.
- Adult supervision recommended.

WARNING:

CHOKING HAZARD – Toy contains small parts. Not for children under 3 yrs. Please do not touch the high-speed whirling rotor or tail propeller in case of injury.

GuangDong Alpha Animation and Culture Co.,Ltd.

Auldey Industrial Area, Wenguan Rd., Chenghai, Shantou, Guangdong, China (515800)

Tel: (86)20 37598787
Website: www.auldeytoys.com
e-mail: auldey_imd@auldey.cn

Suitable for aged 14 years above



© 2010 AULDEY ALPHA CULTURE LTD. MADE IN CHINA