



1:18 Club Car

User Manual

Suitable Type:

DN815090-2
DN815090-4
DN815090-6

Thank you for purchasing our product -Club Series R/C Car. Please read the user manual carefully before using the product, and retain the information for future reference.

CAUTION

- Not-rechargeable batteries are not to be recharged;
- Rechargeable batteries are to be removed from the toy before being charged;
- Rechargeable batteries are only to be charged under adult supervision;
- Different types of batteries or new and used batteries are not to be mixed;
- Only batteries of the same or equivalent type as recommended are to be used;
- Batteries are to be inserted with the correct polarity;
- Exhausted batteries are to be removed from the toy;
- The supply terminals are not to be short-circuited;
- Do not mix old and new batteries;
- Do not mix alkaline batteries, standard (carbon-zinc) or rechargeable(Nickel-cadmium) batteries.

I. Functions And Specification

- Full Function: Forward, backward, turn left, turn right, stop, self demo, sound & light function;
- Frequencies: 27MHz, 40MHz, 40MHz;
- Scale: 1:18;
- Speed: over 6.5km/h
- Operating range: ≥ 15m
- Batteries: 4 X "AA" batteries for racer; and 2 X "AA" for transmitter; (Not-include in box)

II. Install Batteries To Transmitter

- Use a cross-screwdriver to unscrew screws on transmitter, open battery compartment cover, and insert two "AA" batteries.
- Reinsert battery compartment and screw down.

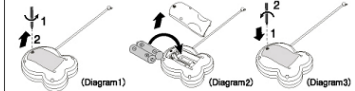

III. Install Batteries To Racer

- Turn the battery door knob at 180° and open battery door;
- Insert four "AA" batteries at correct polarities, close battery door and turn door knob to lock back.

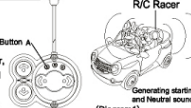
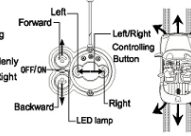
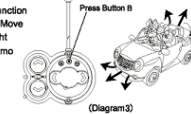
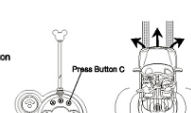
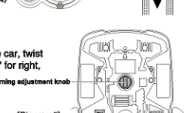

IV. Methods To Operate

- Switch power button to ON and place R/C Racer on the ground.
 
- Press Button A to start the racer, generating starting and Neutral sounds (Diagram 1). Push Forward/Backward Controlling Pole for racer going forward, with front & back lights and accelerating sounds on; pull Pole for backward, with flashing lights and "dud" sounds on. Change Pole movements suddenly for braking sound. Push Left/Right Controlling Pole for left/right turnings and light flashes.
 
- Press Button B for self demo function and 3 types of dynamic music. Move Forward/Backward or Left/Right Controlling Pole to stop self demo function (Diagram 3)
 
- Press Button C for 2 types of music while driving. Press Button C twice to stop this function.
 
- To adjust the alignment of the car, twist adjustor tip on car bottom ("R" for right, "L" for left).
 

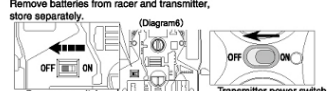
- When finish playing, switch to "OFF" position. Remove batteries from racer and transmitter, store separately.
 

V. To Consumers

- When playing the car indoor, avoid damaging furniture or glass surface.
- To avoid accidents happen, please do not run the car in public. Only use this product in safe outdoor environment.
- When thundering while running the car outdoor, please stop immediately.
- Do not run the car on puddles or sand to avoid circuit failure.
- Do not tilt the antenna incorrectly. Broken antenna may have sharp edges and cause injury.
- Do not pull the wires from the car unit. Broken wire may result function failure.
- When the car is revolving, do not put your hand close to it, nor put it on the rail or clothing to avoid injury.
- Do not run the car toward others.
- Should not drop or bump the car.
- Store the car in cool places and away from fire.
- This product is composed of complicated electronic device and original parts, please do not attempt to disassemble or alter this product.
- When batteries are low in power, the car speed will slow down or out of control. Please change the batteries.
- When the car is out of control, it may be due to battery compartment spring distortion. Adjust spring to proper position according to diagram.
- If the car is under pressure for a long time, the rear test board may be deformed. Hold the rear motor and bend it to the opposite direction until the board is flat again.
- Do not shake the box vigorously to avoid drop out of controller.
- To enable longer life of the batteries, please follow below operations:
 - Remove batteries when not in use;
 - Do not mix old and new batteries; otherwise, the car runs slowly and battery life will die very soon.

VI. Frequency And Environment

- When there is another car of similar radio frequency operating nearby, the controller may not function.
- When interfered by other radio-waves, the controller may not function. Try again at other location or time.
- This product is designed to run on cement and sand polished surface. If run on wet polished surface, the car cannot move straight due to poor contact between the tires and road surface, and may spin 180 degrees or pivot.

WARNING:

CHOKING HAZARD-Toy contains small parts. Not for children under 3 years.

Packing has to be kept since it contains important information

Guangdong Alpha Animation and Culture Co., Ltd.
 ADD: Auldey Industrial Area, Wenguan Rd., Chenghai, Guangdong, China
 Http://www.auldey.com E-mail: auldey_ltd@auldey.com
 Tel: +86-754-5862278
 Fax: +86-754-5870278
 Zip code: 515800
 Awarded Certificates of ISO9001:2000 & ISO14001:2004



(Suitable for aged 3 years (37 months) above)



Phone: +86-20-38598787
FAX: +86-20-37590417
http: // www.auldey.com

NOTE:

This equipment has been tested and found to comply with the limits for a Class B digital device, pursuant to Part 15 of the FCC Rules. These limits are designed to provide reasonable protection against harmful interference in a residential installation. This equipment generates, uses and can radiate radio frequency energy and, if not installed and used in accordance with the instructions, may cause harmful interference to radio communications.

However, there is no guarantee that interference will not occur in a particular installation. If this equipment does cause harmful interference to radio or television reception, which can be determined by turning the equipment off and on, the user is encouraged to try to correct the interference by one or more of the following measures:

- Reorient or relocate the receiving antenna.
- Increase the separation between the equipment and receiver.
- Connect the equipment into an outlet on a circuit different from that to which the receiver is connected.
- Consult the dealer or an experienced radio/TV technician for help.

Changes or modifications not expressly approved by the party responsible for compliance could void the user's authority to operate the equipment.

This device complies with part 15 of the FCC Rules. Operation is subject to the following two conditions: (1) This device may not cause harmful interference, and(2) this device must accept any interference received, including interference that may cause undesired operation.

GUANGDONG ALPHA ANIMATION AND CULTURE CO., LTD.
Auldey Ind. Area,Wenguan Rd.(Central) ,Chenghai,Shantou ,Guangdong,China