

AMROAD

CPW7000/CPW7000R



Manual

amroad

TABLET OF CONTENTS

TABLET OF CONTENTS.....	2
PACKAGE CONTENTS.....	3
INSTALLING THE DEVICE.....	4
FRONT PANEL	5
FUNTION.....	6
SPECIFICATION	7
REGULATORY INFORMATION	8

PACKAGE CONTENTS

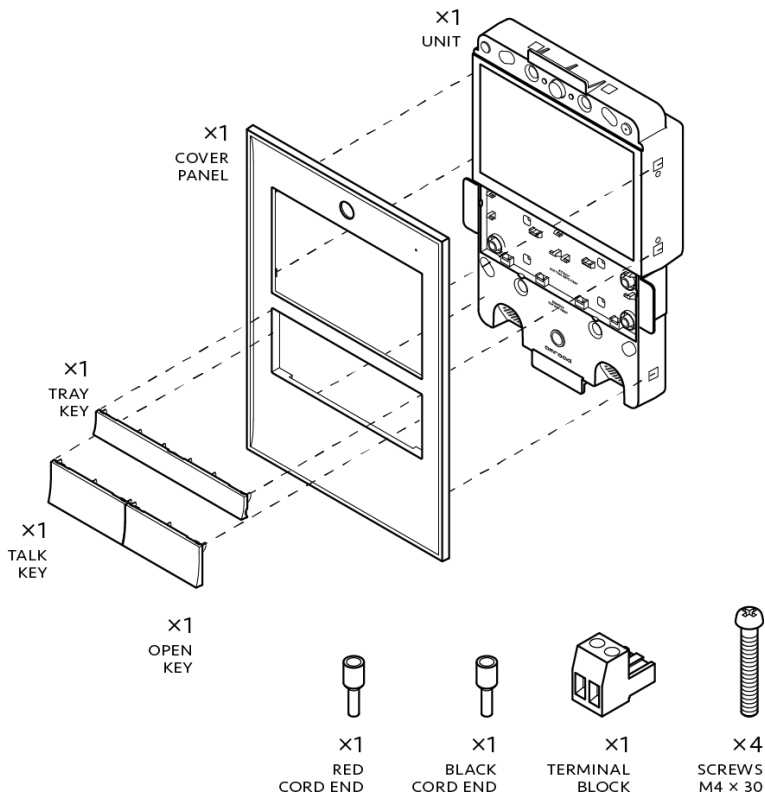

INSTALLING THE DEVICE

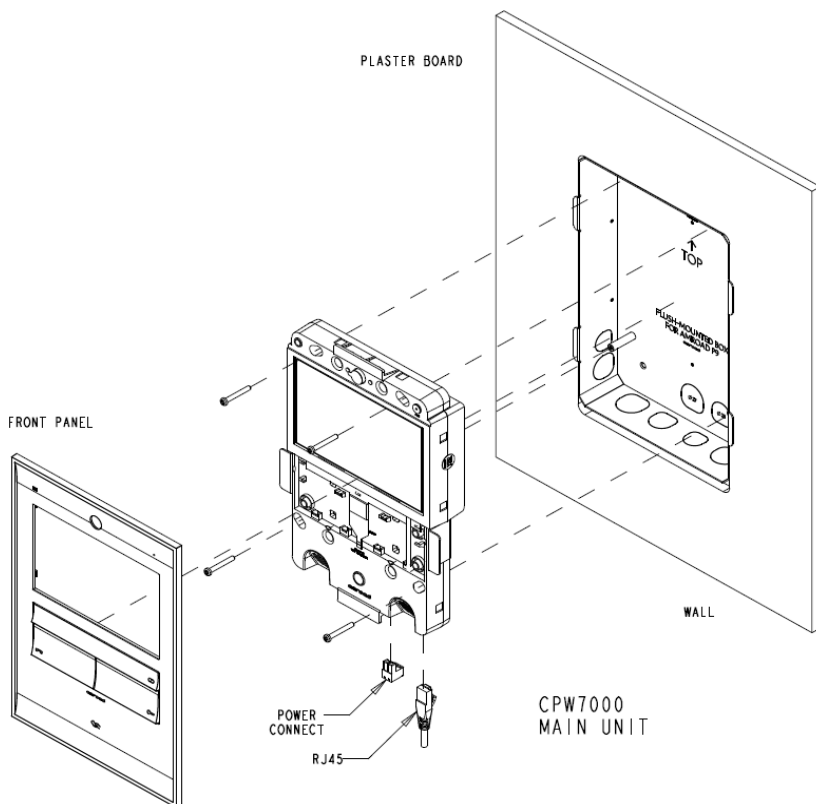

FRONT PANEL



FUNTION

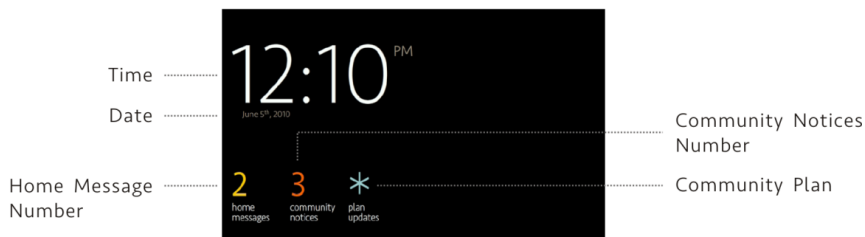

SPECIFICATION

PRODUCT NO.

CPW7000
CPW7000R

LANGUAGE

English
Traditional Chinese

SIP VERSION

SIP 2.0 – RFC3261

PORTS

1 × RJ45
(10/100 Ethernet wire)

1 × 12V DC power input

POWER SUPPLY

12V DC – 2Ainput

PoE(Power Over Ethernet)

SCREEN & CAMERA

7" touch panel
Resolution: 800 × 480 pixel
Format: 15:9

VGA color camera
80° / F3.0

VIDEO CODEC

H.263
(supporting VGA resolution)

H.264
(supporting CIF resolution)

MPEG4 video codec

AUDIO CODEC

G.711 μ audio codec

DIMENSIONS

W200 × H284 × D47mm
(protruding 7mm when mounted)

WARRANTY

2-years warranty

REGULATORY INFORMATION

FCC STATEMENT

This product has been tested and complies with the specifications for a Class B digital device, pursuant to Part 15 of the FCC Rules. These limits are designed to provide reasonable protection against harmful interference in a residential installation. This equipment generates, uses, and can radiate radio frequency energy and, if not installed and used according to the instructions, may cause harmful interference to radio communications. However, there is no guarantee that interference will not occur in a particular installation. If this equipment does cause harmful interference to radio or television reception, which is found by turning the equipment off and on, the user is encouraged to try to correct the interference by one or more of the following measures:

- Reorient or relocate the receiving antenna
- Increase the separation between the equipment or devices
- Connect the equipment to an outlet other than the receiver's

FCC Radiation Exposure Statement

This equipment complies with FCC radiation exposure limits set forth for an uncontrolled environment. This equipment should be installed and operated with minimum distance 20cm between the radiator and your body.

"Changes or modifications are not expressly approved by the manufacturer could void the user's authority to operate the equipment."

CE DECLARATION OF CONFORMITY (EUROPE)

Manufacturer declares that this product conforms to the specifications listed below, following the provisions of the European R&TTE directive 1999/5/EC:

- EN 301 489-1, 301 489-17 General EMC requirements for Radio equipment
- EN 609 50 Safety
- EN 300-328-1, EN 300-328-2 Technical requirements for Radio equipment

Caution: This equipment is intended to be used in all EU and EFTA countries. Outdoor use may be restricted to certain frequencies and/or may require a license for operation. Contact local Authority for procedure to follow.

Note: Combinations of power levels and antennas resulting in a radiated power level of above 100 mW equivalent isotropic radiated power (EIRP) are considered as not compliant with the above mentioned directive and are not allowed for use within the European community and countries that have adopted the European R&TTE directive 1999/5/EC.



WWW.AMROAD.COM.TW

18F.-4, No.150, Jian 1st Rd., Zhonghe Dist.,
New Taipei City 235, Taiwan (R.O.C.)

TEL: 886-2-8226-5686

Fax: 886-2-8226-5687