

# User's Guide for FCC ID: ZWJ-0823 & FCC ID: 2ACBD-0610

## 1. Plug in Device

Plug the included power cable into Device and then into a power outlet. A blue light ring will begin to spin around the top. In about a minute, the light ring will change to orange and the Device will greet you.

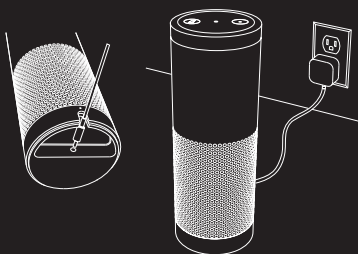

## 2: Download the Device app

[www.XXXXXXX.com/start](http://www.XXXXXXX.com/start)

The app enables you to set up and manage the Device on your phone or tablet. Opening the app will immediately start the setup process. During setup, you will connect Device to the Internet. You may need your Wi-Fi password.

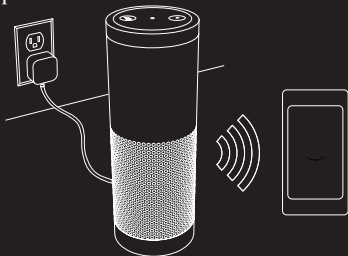

## Device Overview

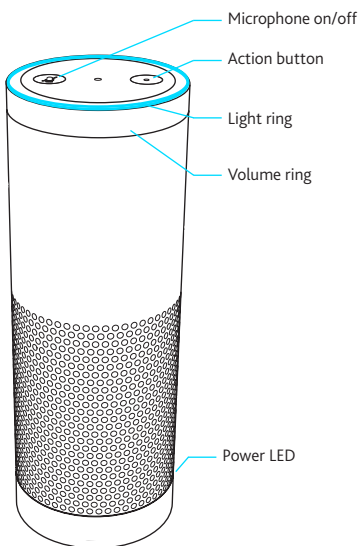

**Action button:** Instead of using the wake word, press this button to wake up Device or to turn off the alarm and timer. To set up Wi-Fi, press this button for five seconds.

**Microphone on/off button:** Press this button to turn the microphone on and off. When the light ring is red, Device cannot hear you.

**Light ring:** The color of the light ring indicates what Device is doing. Blue indicates start-up mode (1 to 3 minutes) and orange indicates Wi-Fi setup mode. Go to the app to learn more about the other colors.

**Volume ring:** Turn the dial clockwise to increase the volume. The light ring fills in as the volume increases.

**Power LED:** A small white indicator light displays when Device is plugged in.

# Legal and Compliance Information

## FCC Compliance Statement

This device complies with Part 15 of the FCC Rules. Operation is subject to the following two conditions:

- This device may not cause harmful interference.
- This device must accept any interference received, including interference that may cause undesired operation.

This equipment has been tested and found to comply with the limits for a Class B digital device, pursuant to Part 15 of the FCC Rules. These limits are designed to provide reasonable protection. This equipment generates, uses and can radiate radio frequency energy and, if not installed and used in accordance with the instructions, may cause interference to radio communications. However, there is no guarantee that interference will not occur in a particular installation. If this equipment does cause harmful interference to radio or television reception, which can be determined by turning the equipment off and on, the user is encouraged to try to correct the interference by one or more of the following measures:

- Reorient or relocate the receiving antenna.
- Increase the separation between the equipment and receiver.
- Connect the equipment into an outlet on a circuit different from that to which the receiver is connected.
- Consult the dealer or an experienced radio/TV technician for help.

Changes or modification not expressly approved by the party responsible for compliance could void the user's authority to operate the equipment.

The Devices meet the FCC Radio Frequency Emission Guidelines and are certified with the FCC as the FCC ID number found on the back of the Device.

## Information Regarding Exposure to Radio Frequency Energy

Your Device is designed and manufactured not to exceed the emission limits for exposure to RF energy set by the Federal Communications Commission of the United States (FCC). This device should be installed and operated with minimum distance 20cm between the radiator & your body. For the remote controller, it meets the RF exposure requirement of low power devices under portable operation. Information on your Device is on file with the FCC and can be found under the Display Grant section of <http://transition.fcc.gov/oet/ea/> after searching on the FCC ID for your Device, which can be found on the product label.

# Device Remote

You can talk to Device just using your voice. The remote is provided to help you when using Device in a loud setting.

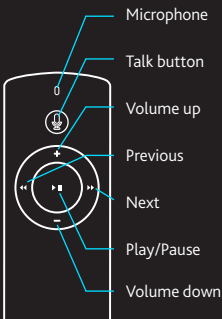

AAA batteries

# Pairing the remote to your Device

Insert the included batteries into the remote. It will automatically pair with Device during setup.

If this is a replacement remote, go to Settings in the Device app. Select your Device, click Add a remote, and follow the instructions there.

## Remote holder

The remote holder easily attaches to magnetic surfaces, or use the included adhesive to attach it to other surfaces.