

STIHL Smart Connector

Instruction Manual



! WARNING

Read Instruction Manual thoroughly before use and follow all safety precautions – improper use can cause serious or fatal injury.

! ADVERTENCIA

Antes de usar la máquina lea y siga todas las precauciones de seguridad dadas en el manual de instrucciones – el uso incorrecto puede causar lesiones graves o mortales.



Entwurf

Contents

1	Introduction	1
2	Guide to Using this Manual	2
2.1	Signal Words	2
2.2	Symbols in Text	2
3	Main Parts	2
3.1	Smart Connector	2
4	IMPORTANT SAFETY INSTRUCTIONS	2
5	Installing the Battery	4
6	Mounting Instructions	5
7	Connecting to the STIHL App	6
8	During Operation	6
9	Troubleshooting Guide	8
9.1	Smart Connector	8
10	Specifications	9
11	FCC 15 Compliance Statement	9
12	Limited Warranty	9
12.1	STIHL Incorporated Limited Warranty Policy	9
13	Addresses	10
13.1	STIHL Incorporated	10

1 Introduction

The STIHL Smart Connector allows you to track the runtime of nearly any piece of outdoor power equipment through the STIHL App. When the Smart Connector is within Bluetooth range of a smartphone running the STIHL App, you can also track the location and status of a connected product.



It is important that you read and observe the following information and warnings. Improper use can cause serious injury.



Read this instruction manual thoroughly before use and periodically thereafter. Careless or improper use of the STIHL Smart Connector can cause serious or fatal injury.

Have your authorized STIHL servicing dealer show you how to use the STIHL Smart Connector.

Do not lend or rent the STIHL Smart Connector without this instruction manual. Allow only persons who fully understand the information in this manual to use the STIHL Smart Connector.

For further information, or if you do not understand any of the instructions in this manual, please go to www.stihlusa.com or contact your authorized STIHL servicing dealer.

Additional assistance can be found on the STIHL App.

SAVE THESE INSTRUCTIONS!

STIHL®

This instruction manual is protected by copyright. All rights reserved, especially the rights to reproduce, translate and process with electronic systems.

2 Guide to Using this Manual

2.1 Signal Words

This manual contains safety information that requires your special attention. Such information is introduced with the following symbols and signal words:

! DANGER

Indicates a hazardous situation that, if not avoided, will result in death or serious injury.

! WARNING

Indicates a hazardous situation that, if not avoided, could result in death or serious injury.

NOTICE

Indicates a risk of property damage, including damage to the machine or its individual components.

2.2 Symbols in Text

The following symbol is included to assist you with the use of the manual:

 Refers to a designated chapter or sub-chapter in this instruction manual.

3 Main Parts

3.1 Smart Connector

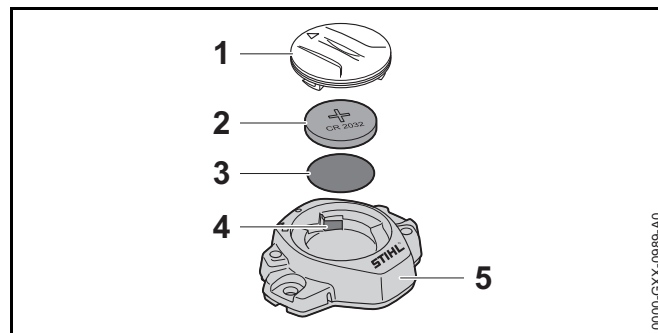

- 1 Cover
- 2 Battery
- 3 Foil
- 4 LED
- 5 Smart Connector

4 IMPORTANT SAFETY INSTRUCTIONS

Battery

! WARNING

- Read all safety warnings and instructions.
- Failure to follow the warnings and instructions may result in electric shock, fire and/or serious injury.
- Save all warnings and instructions for future reference.

- Improper use could result in serious personal injury or property damage.
 - Use the STIHL Smart Connector only as described in these instructions and the STIHL App.
- Use with an unauthorized battery can result in fire, explosion, or leakage of battery fluid.
- Your STIHL Smart Connector is designed for use only with a properly inserted lithium CR2032 button cell battery. Do not attempt to use another button cell or electrical power supply.
- Swallowing or ingesting the button cell battery can cause serious internal chemical burns which may lead to death in less than 2 hours.



- Always secure the battery compartment.
- Keep battery away from children.
- If you think a battery has been swallowed, seek emergency attention immediately.
- Do not induce vomiting.

- Ensure the battery compartment on the STIHL Connector is closed securely.
 - If the compartment will not remain closed, remove the battery and discontinue use. Properly dispose of the battery and replace the Smart Connector.
- Risk of fire and explosion.
 - Never attempt to re-charge the battery.
 - Never heat the battery above 212 °F (100 °C) or place it in or near fires, stoves or other high-temperature locations.
 - Do not crush or expose to microwaves.
 - Use the Smart Connector only with the designated battery.
- High temperatures may cause the battery to generate heat, rupture, leak, ignite or explode.



- Use and store the battery only within an ambient temperature range of 20 °F to 140 °F (-30 °C to 60 °C).
- Never store the battery inside a vehicle in hot weather.

- Risk of short circuit, which could lead to rupture, fire or explosion.



- Keep the battery dry.
- Never stack batteries.
- Never bridge the terminals with wires or with paper clips, coins, keys, nails or other metallic objects that can make a connection from one terminal to another.
- Install the battery according to the polarity (+/-) diagrams on the Smart Connector.

- Leaking battery fluid can cause skin and eye irritation or chemical burns.
 - Never attempt to open or dis-assemble the battery. In the event of leakage, avoid contact with skin and eyes.
 - Clean up spilled fluid with an inert absorbent such as sand or an absorbent cloth.
- Avoid skin and eye contact with battery fluid. Avoid vapor generated from leaking or burning batteries.
 - Rinse affected skin thoroughly with mild soap and water.
 - Flush eyes with clean water for 15 minutes without rubbing.
 - Seek medical attention.
- Handle discharged/depleted batteries carefully.
 - Keep away from children.
 - Properly dispose of batteries immediately at the end of their useful life. Never dispose of battery with household waste.
 - Observe all federal, state and local disposal rules and regulations.

Mounting and Operation

⚠ WARNING

- Before mounting, read and follow all warnings and safety instructions provided with the power equipment.
 - Before mounting, read and follow all warnings and safety instructions provided with the power equipment.
- Use common sense when mounting to reduce the risk of personal injury or property damage.
- Never mount the Smart Connector on product handles, switches, controls, cooling inlets, guards or moving parts.
- Ensure that no electrical parts, cables, fuel lines or other components will be damaged if drilling holes or using screws to install the STIHL Connector.
- Never cover safety warning labels or other on-product markings.
- Never mount the Smart Connector in a manner or in a location that interferes with proper working technique or your ability to control the power tool.
- Never mount in areas on the tool that are exposed to heat or sparks.

Maintenance and Storage

⚠ WARNING

- Reduce the risk of short circuit:
 - Keep the Smart Connector free of foreign matter
 - Clean with a dry cloth or soft, dry brush.
 - Never clean with detergents or solvents, which may damage the polymer housing.
 - Never spray with a pressure washer or otherwise spray with water or other liquids.

- Improper storage can lead to unauthorized use, damage to the Smart Connector and power tool it's connected to, and increase the risk of personal injury and property damage.
 - Reduce the risk of unauthorized use.
 - Store the Smart Connector in a dry, secure place out of the reach of children and other unauthorized users.

5 Installing the Battery

The STIHL Connector is powered by a CR2032 button-cell battery. Never attempt to use any other type of battery.

To install the battery in the Smart Connector:

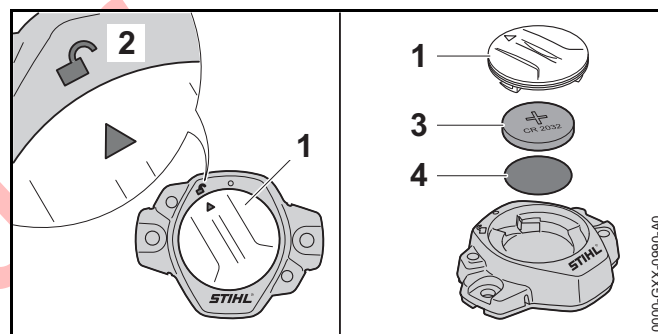

- ▶ Using a coin or flat head screwdriver, turn the Smart Connector cover (1) counter-clockwise to the unlocked position (2).
- ▶ Remove the cover.
- ▶ Remove and discard the protective battery foil (4).
- ▶ Install the battery according to the polarity markings (+/-) on the Smart Connector battery compartment.
- ▶ Replace the cover. The LED (x) will glow green for three seconds when the battery is properly inserted.
- ▶ Turn the cover clockwise to the locked position (x).

6 Mounting Instructions

The Smart Connector can be attached to any piece of gas- or battery-powered outdoor power equipment with sufficient surface area.

For the runtime detection features to activate, locate the Smart Connector within 3.9 in. (10 cm) of the magnetic field created by an electric motor or spark plug.

Before mounting, read and follow all warnings and safety instructions provided with the power equipment. For STIHL equipment, mount the Smart Connector in the manner and in the locations specified in the STIHL App.

⚠ WARNING

- When mounting, use common sense to reduce the risk of personal injury or property damage:
 - Never mount the Smart Connector on product handles, switches, controls, cooling inlets, guards or moving parts.
 - Ensure that no electrical parts, cables, fuel lines or other components will be damaged if drilling holes or using screws to install the STIHL Connector.
 - Never cover safety warning labels or other on-product markings.
 - Never mount the Smart Connector in a manner or in a location that interferes with proper working technique or your ability to control the power tool.
 - Never mount in areas on the tool that are exposed to heat or sparks.

STIHL recommends mounting the Smart Connector with the adhesive backing tape (Illustration A):

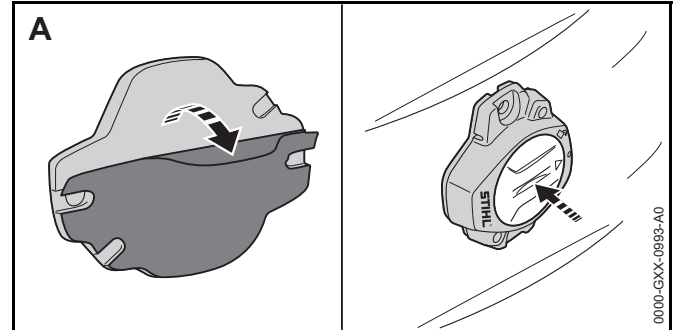

- ▶ Clean the surface with soap and water, removing any dirt or debris.
- ▶ Peel back the adhesive backing film and press the Smart Connector onto any flat surface until it is secure.

Alternatively, you can mount the Smart Connector using two pan-head, self-tapping screws (Illustration B):

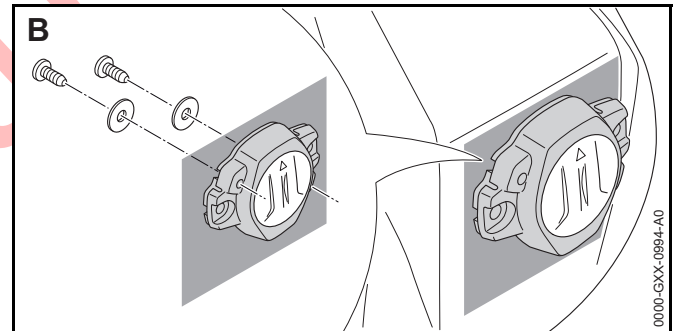

- ▶ Clean the surface with soap and water, removing any dirt or debris.
- ▶ Always pre-drill the mounting holes using an appropriate 1/8 in. or 5/32 in. drill bit.
- ▶ Ensure that no electrical parts, cables, fuel lines or other components will be damaged if drilling holes or using screws to install the STIHL Connector.

Alternatively, you can mount the Smart Connector using two zip ties (Illustration C):

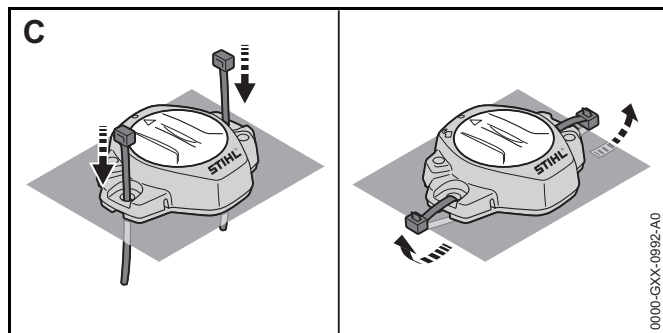

- ▶ Clean the surface with soap and water, removing any dirt or debris.
- ▶ Always pre-drill the mounting holes using an appropriate 1/8 in. or 5/32 in. drill bit.
- ▶ Ensure that no electrical parts, cables, fuel lines or other components will be damaged if drilling holes or using screws to install the STIHL Connector.

7 Connecting to the STIHL App

To download the STIHL App:

- ▶ The STIHL App is available for download at [www.STIHL.com////////\(?\)](http://www.STIHL.com////////(?)) and the following locations:
- ▶ Follow the step-by-step instructions for creating your STIHL App user account.
- ▶ Follow the step-by-step instructions for creating your STIHL App user account.

To link the STIHL Connector to your STIHL App user account:

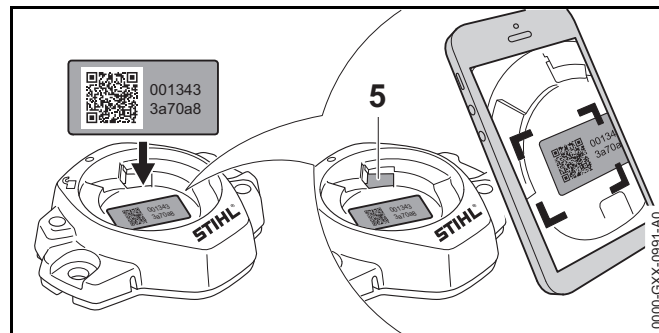

- ▶ In the STIHL App, select "Add Connector." Follow the instructions on your smartphone or tablet.
- ▶ When prompted, scan the QR code inside the Smart Connector's battery compartment.
- ▶ Follow the step-by-step instructions for completing the linking process.
- ▶ Re-install the battery according to the polarity markings (+/-) and secure the cover before starting work.

8 During Operation

Once you have linked your STIHL App account to your STIHL Connector, you will be prompted for information to help you track the location and performance of your equipment.

Runtime detection is only possible if the Smart Connector is attached within 3.9 in. (10 cm) of the electric motor or spark plug.

Once the Smart Connector is attached to a tool and the tool is started or switched on, the Smart Connector will start tracking runtime and submit it to the STIHL App when the smartphone or tablet is in range.

Bluetooth® and location services must be enabled on your mobile device. Location services must be enabled in the STIHL App.

The signal range may vary depending on ambient conditions and the performance of the designated receiving device, i.e., smartphone or tablet. The Bluetooth® range may be significantly limited when the signal is transmitted through metallic barriers (e.g., walls, shelving units, etc.) or near strong electromagnetic fields.

For more information on the STIHL mobile application, please visit www.STIHL.com/????/?? or view the [Help] tab inside the STIHL App.

Separate terms and conditions apply to the use of the STIHL Mobile Application and are available for review through the STIHL App.

Entwurf

9 Troubleshooting Guide

9.1 Smart Connector

Condition	Cause	Remedy
The LED in the Smart Connector does not glow green when the battery is inserted.	Battery is fully depleted.	► Replace the battery.
The LED in the Smart Connector is flashing red.	Battery power is low.	► Replace the battery.
The Smart Connector does not measure runtime correctly.	Battery is low or fully depleted.	► Replace the battery.
	The Smart Connector is not mounted properly.	► Re-mount the Smart Connector in the manner and in the locations specified in this instruction manual or the STIHL App. The signal range may vary depending on ambient conditions.

Entwurf

10 Specifications

- Approved battery type: CR 2032 Lithium Button-Cell
- Battery service life: approximately 12 months
- Ambient temperature range for use and storage: - 20 °F to 140 °F (- 30 °C to 60 °C)
- IP protection rating: IP67 (protection from total dust ingress and protection from immersion up to 3 ft. (1 m) depth, limited ingress protection)
- Data transmission protocol: Bluetooth® 4.2. The mobile receiving devices must be compatible with Bluetooth® version 4.2 and support the Generic Access Profile (GAP).
- Frequency bands: ISM band 2,4 GHz
- Radiated maximum transmission power: 1 mW
- Bluetooth® signal range: maximum 33 ft. (10 m). The signal range may vary depending on ambient conditions and the performance of the designated receiving device, i.e., smartphone or tablet. The Bluetooth® range may be significantly limited when the signal is transmitted through metallic barriers (e.g., walls, shelving units, etc.) or near strong electromagnetic fields.
- Minimum mobile terminal device (e.g., tablet, smartphone) system requirements: Android 4.4 or iOS 9.3

11 FCC 15 Compliance Statement

This device (FCC ID: 2ALP8SC) complies with part 15 of the FCC Rules.

Operation is subject to the following two conditions:

- this device may not cause harmful interference.
- this device must accept any interference received, including interference that may cause undesired operation.

Note: This equipment has been tested and found to comply with the limits for a Class B digital device, pursuant to part 15 of the FCC Rules. These limits are designed to provide reasonable protection against harmful interference in a residential installation. This equipment generates, uses and can radiate radio frequency energy and, if not installed and used in accordance with the instructions, may cause harmful interference to radio communications. However, there is no guarantee that interference will not occur in a particular installation.

If this equipment does cause harmful interference to radio or television reception, which can be determined by turning the equipment off and on, the user is encouraged to try to correct the interference by one or more of the following measures:

- reorient or relocate the receiving antenna,
- increase the separation between the equipment and receiver,
- connect the equipment to an outlet on a circuit different from that to which the receiver is connected,
- consult an authorized STIHL servicing dealer or an experienced radio/TV technician for help.

Do not change or modify this product in any way unless specifically allowed in this manual, since this could void your authority to operate it.

12 Limited Warranty

12.1 STIHL Incorporated Limited Warranty Policy

This product is sold subject to the STIHL Incorporated Limited Warranty Policy, available at <http://www.stihlusa.com/warranty.html>. It can also be obtained from your authorized STIHL dealer or by calling 1-800-GO-STIHL (1-800-467-8445).

13 Addresses

13.1 STIHL Incorporated

STIHL Incorporated
536 Viking Drive
P.O. Box 2015
Virginia Beach, VA
23452-2015

Entwurf

Entwurf

⚠ WARNING

This product contains chemicals known to the State of California to cause cancer, birth defects or other reproductive harm.

⚠ ADVERTENCIA

Este producto contiene productos químicos considerados por el Estado de California como causantes de cáncer, defectos de nacimiento u otra toxicidad reproductora.

[SNR_Complete]

englisch



www.stihl.com



[SNR_Complete]