

INSIGNIA

## QUICK SETUP GUIDE

Portable Bluetooth®  
Audio Receiver

NS-MBTK35/NS-MBTK35-C



## PACKAGE CONTENTS

- Bluetooth receiver
- 3.5 mm audio cable (3 ft.)
- 3.5 mm male-to-male adapter
- 3.5 mm to RCA adapter
- Velcro mounting pads
- Micros USB charging cable
- Carrying pouch
- *Quick Setup Guide*

## FEATURES

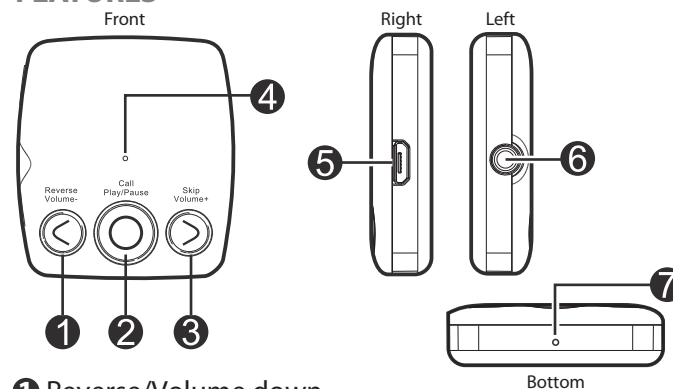

- 1 Reverse/Volume down
- 2 Multi-function button (MFB): Power on/off, pairing, play, pause, call
- 3 Skip/Volume up
- 4 LED indicator
- 5 Micro USB charging port
- 6 Audio jack
- 7 Microphone

## CHARGING THE RECEIVER

Fully charge the Bluetooth receiver before you use it for the first time. When the red LED starts to blink during use, it indicates the battery is low and requires charging.

- 1 Plug the micro USB plug of the USB cable into the micro USB port on your Bluetooth receiver.
- 2 Plug the USB end of the cable into an active USB port, or any USB charger. A steady red LED indicates it is charging.
- 3 Disconnect the receiver from the USB cable when the red LED indicator turns off. It may take up to three hours to fully charge.

## USING BLUETOOTH



To get started, you need to pair the Bluetooth receiver with your phone or device.

- 1 With the receiver turned off, press and hold the MFB  for seven seconds. The LED flashes and the receiver enters pairing mode.
- 2 Activate the phone's Bluetooth function and search for your receiver. Click on the product name "**NS-MBTK35**" to connect. See the instructions that came with your Bluetooth device for information about pairing.
- 3 If you are asked for a password, enter "0000". When pairing is complete, the LED lights solid blue and a tone sounds.





## RECONNECTING TO A PAIRED DEVICE

- 1 Every time the receiver is turned on, it will connect to the last connected device automatically. If you want to pair with another device, turn off the Bluetooth function of the connected device, and repeat the pairing procedure above for the new device.
- 2 If a device does not automatically reconnect, you may need to reselect **NS-MBTK35** on your Bluetooth device.
- 3 If the receiver is not paired to a Bluetooth device for three minutes, it will turn off automatically.



## USING YOUR RECEIVER

- 1 Press and hold the MFB  for two seconds to turn on your receiver. The LED lights solid blue when it is connected to your Bluetooth device.
- 2 When the receiver is turned on, press and hold the MFB  for two seconds to turn off the receiver.

## LISTENING TO MUSIC

- 1 To play/pause audio, press the MFB  once.
- 2 To increase the volume, press  once.
- 3 To reduce the volume, press  once.
- 4 To skip to next track, press and hold .
- 5 To skip to previous track, press and hold .

## MAKING PHONE CALL

- 1 To make a call, use your phone's controls, then select the receiver as the audio source.
- 2 To answer an incoming call, press the MFB .
- 3 To reject an incoming call, press and hold the MFB .
- 4 To end a call, press the MFB  once.

Before using your new product, please read these instructions to prevent any damage.

## USING YOUR WIRED HEADPHONE OR EARPHONE, RECEIVER WITH STEREO OR RECEIVER IN THE CAR

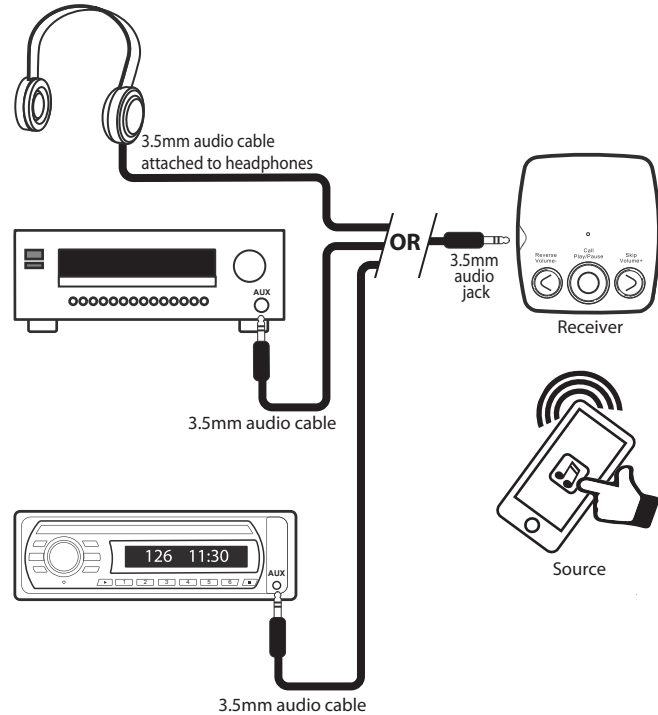

Using your smartphone as the audio source, you can connect a variety of sound devices through your Bluetooth receiver, such as headphones, a stereo receiver, or a car audio system.

## TROUBLESHOOTING

PROBLEM	SOLUTION
No sound or low volume	<ul style="list-style-type: none"> <li>• Turn up the volume on your receiver and Bluetooth device.</li> <li>• Make sure that your Bluetooth device is not muted.</li> <li>• Make sure that your receiver and Bluetooth device are not paired to other devices.</li> </ul>
Cannot connect with Bluetooth	<ul style="list-style-type: none"> <li>• Make sure that your Bluetooth device is turned on, Bluetooth is turned on, and “NS-MBTK35” is selected.</li> <li>• Shorten the distance between your receiver and the Bluetooth device.</li> <li>• Turn your devices off, then on. Re-pair your receiver and Bluetooth device.</li> <li>• Make sure that your receiver and Bluetooth device are not paired to other devices.</li> <li>• Make sure that your Bluetooth device supports the HSP, HFP, A2DP, or AVRCP Bluetooth protocol.</li> </ul>
Bluetooth device keeps unpairing	<ul style="list-style-type: none"> <li>• Shorten the distance between your receiver and your Bluetooth device.</li> <li>• Recharge your receiver and the Bluetooth device's batteries.</li> </ul>
“NS-MBTK35” does not appear on my Bluetooth device	<ul style="list-style-type: none"> <li>• Shorten the distance between your receiver and the Bluetooth device.</li> <li>• Put your receiver into pairing mode, then refresh your list of Bluetooth devices. For more information, see the documentation that came with your Bluetooth device.</li> </ul>
No power	<ul style="list-style-type: none"> <li>• Make sure that your Bluetooth receiver is charged.</li> <li>• Make sure that your Bluetooth receiver is turned ON.</li> </ul>

### FCC Statement:

This equipment has been tested and found to comply with the limits for a Class B digital device, pursuant to part 15 of the FCC Rules. These limits are designed to provide reasonable protection against harmful interference in a residential installation. This equipment generates, uses and can radiate radio frequency energy and, if not installed and used in accordance with the instructions, may cause harmful interference to radio communications. However, there is no guarantee that interference will not occur in a particular installation. If this equipment does cause harmful interference to radio or television reception, which can be determined by turning the equipment off and on, the user is encouraged to try to correct the interference by one or more of the following measures:

- Reorient or relocate the receiving antenna.
- Increase the separation between the equipment and receiver.
- Connect the equipment into an outlet on a circuit different from that to which the receiver is connected.
- Consult the dealer or an experienced radio/TV technician for help.

This device complies with part 15 of the FCC Rules. Operation is subject to the following two conditions: (1) This device may not cause harmful interference, and (2) this device must accept any interference received, including interference that may cause undesired operation.

**Caution:** Changes or modifications not expressly approved by the party responsible for compliance could void the user's authority to operate the equipment.

### Industry Canada Compliance IC Statement

This device complies with Industry Canada's licence-exempt RSSs. Operation is subject to the following two conditions: (1) This device may not cause interference; and (2) This device must accept any interference, including interference that may cause undesired operation of the device.

### Conformité à Industrie Canada Déclaration d'IC

Le présent appareil est conforme aux CNR d'Industrie Canada applicables aux appareils radio exempts de licence. L'exploitation est autorisée aux deux conditions suivantes : (1) l'appareil ne doit pas produire de brouillage, et (2) l'utilisateur de l'appareil doit accepter tout brouillage radioélectrique subi, même si le brouillage est susceptible d'en compromettre le fonctionnement.

La operación de este equipo está sujeta a las siguientes dos condiciones: 1) es posible que este equipo o dispositivo no cause interferencia perjudicial y 2) este equipo debe aceptar cualquier interferencia, incluyendo la que pueda causar su propia operación no deseada.

### ONE-YEAR LIMITED WARRANTY

Visit [www.insigniaproducts.com](http://www.insigniaproducts.com) for details.

### CONTACT INSIGNIA:

For customer service, call 877-467-4289 (U.S. and Canada) or 01-800-926-3000 (Mexico)

[www.insigniaproducts.com](http://www.insigniaproducts.com)

INSIGNIA is a trademark of Best Buy and its affiliated companies. Registered in some countries. Distributed by Best Buy Purchasing, LLC, 7601 Penn Ave South, Richfield, MN 55423 U.S.A. ©2016 Best Buy. All rights reserved. **Made in China**