

Soundcore Infini Mini

User's manual

Model No.: A3370
51005000947 V01

Bedienungsanleitung | Guide d'Utilisation | Guida d'Utilizzo
Manual de Instrucciones | Manual de Instruções | 取扱説明書
用户手册 | 사용자 매뉴얼 | Начальное руководство | دليل الترحيب

01	English
10	Deutsch
19	Français
28	Italiano
37	Español
46	Portuguese
55	日本語
64	简体中文
73	한국어
82	Русский
91	العربية

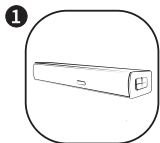

Soundbar

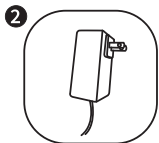

Power Adapter

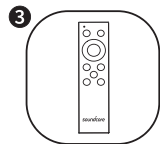

Remote control

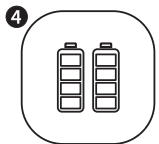

2 x AAA Batteries

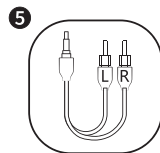

3.5mm to RCA Stereo
Audio Cable

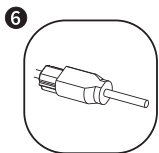

Optical cable

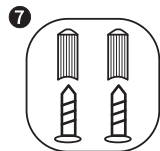

2 x Screws

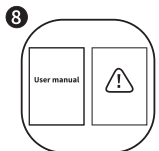

User manual

Deutsch

- 1 Soundbar
- 2 Netzteil
- 3 Fernbedienung
- 4 AAA-Batterien
- 5 Stereo-Audiokabel 3.5 mm auf RCA
- 6 Optisches Kabel
- 7 Dübel und Schrauben für die Wandhalterung
- 8 Benutzerhandbuch

Français

- 1 Barre de son
- 2 Adaptateur d'alimentation
- 3 Télécommande
- 4 Piles AAA
- 5 Câble audio stéréo RCA 3,5 mm
- 6 Câble optique
- 7 Chevilles et vis de fixation murale
- 8 Manuel de l'utilisateur

Italiano

- 1 Soundbar
- 2 Adattatore
- 3 Telecomando
- 4 Batterie AAA
- 5 Cavo audio stereo 3,5 mm a RCA
- 6 Cavo ottico
- 7 Stop e viti per montaggio a parete
- 8 Manuale utente

Español

- 1 Barra de sonido
- 2 Adaptador de alimentación
- 3 Mando a distancia
- 4 Pilas AAA
- 5 Cable de audio estéreo de 3,5 mm a RCA
- 6 Cable óptico
- 7 Tornillos y tacos para montaje en pared
- 8 Manual del usuario

Portuguese

- 1 Soundbar
- 2 Adaptador de alimentação
- 3 Controle remoto
- 4 Pilhas AAA
- 5 Cabo de áudio estéreo RCA de 3,5 mm
- 6 Cabo óptico
- 7 Buchas e parafusos para montagem na parede
- 8 Manual do Usuário

日本語

- 1 サウンドバー
- 2 電源アダプタ
- 3 リモコン
- 4 単四電池
- 5 3.5 mm-RCA ステレオオーディオケーブル
- 6 光ケーブル
- 7 壁掛け用ネジプラグとネジ
- 8 取扱説明書

Русский

- 1 Саундбар
- 2 Адаптер питания
- 3 Пульт ДУ
- 4 Элементы питания типа AAA
- 5 Стере акустический кабель 3,5 мм – RCA
- 6 Оптический кабель
- 7 Крепежные винты и винтовые дюбели
- 8 Руководство пользователя

العربية

- 1 Soundbar
- 2 محوّل الطاقة
- 3 جهاز التحكم عن بُعد
- 4 بطاريات بحجم AAA
- 5 كبل صوت ستريو من نوع RCA بحجم 3,5 مم
- 6 كبل بصري
- 7 مأخذ البراغي والبراغي للتركيب على الحائط
- 8 دليل المستخدم

简体中文

- 1 Soundbar
- 2 电源适配器
- 3 遥控器
- 4 AAA 电池
- 5 3.5mm 转 RCA 立体声音频电缆
- 6 光缆
- 7 壁挂式螺塞和螺丝
- 8 用户手册

한국어

- 1 사운드바
- 2 전원 어댑터
- 3 리모컨
- 4 AAA 배터리
- 5 3.5mm RCA 스테레오 오디오 케이블
- 6 광 케이블
- 7 벽 설치용 나사 플러그 및 나사
- 8 사용 설명서

EN Safety Instructions

- Avoid dropping.
- Do not disassemble.
- Do not submerge in water.
- Avoid extreme temperatures.
- Do not use the device outdoors during thunderstorms.
- Use original or certified cables.
- Do not use any corrosive cleaner / oil to clean.
- The product should not be exposed to dripping or splashing water.
- The adapter shall be installed near the equipment and shall be easily accessible.

At a Glance

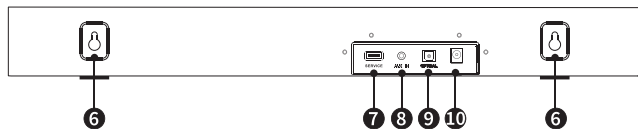
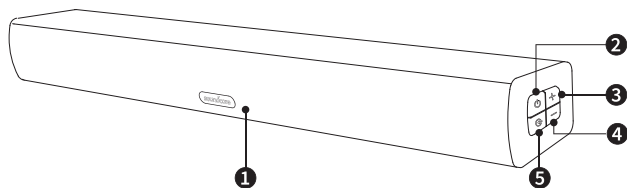

1 Status indicator

Status	Status indicator light
Standby	Solid red
Bluetooth pairing mode	Flashing blue
Bluetooth device connected	Solid blue (stays on for 10 seconds)
AUX	Solid cyan (stays on for 10 seconds)
Mute	Solid yellow
Optical	Solid green (stays on for 10 seconds)
Volume up and down	Flashing white
Maximum volume	Solid white (stays on for 3 seconds)
Minimum volume	Solid white (stays on for 3 seconds)
Music	Flashing white (once)
Movie	Flashing white (3 times)

2 Power button

3 Volume-up control

4 Volume-down control

5 Source input

6 Wall mount holes

7 USB port (Service only)

8 AUX input

9 Optical input

10 Power input

EN Placement

1. Place the Soundbar on a solid surface.

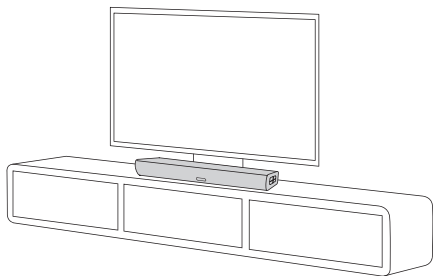

2. To prevent any hazardous situations, no naked flame sources, such as lighted candles, should be placed on or in the vicinity.

• Wall Mount Installation

1. Drill two holes on the wall (approximately 6mm in diameter). The distance between the two holes should be 400mm. Refer to image below:

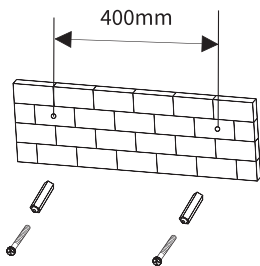

Insert the two screw plugs into the drilled holes, then place the two screws in the screw plugs.

2. Tighten the screws with screwdriver and leave 4mm screw head outside. EN

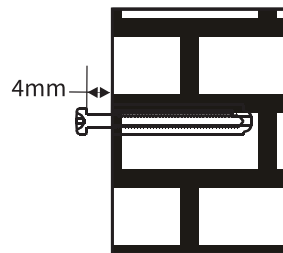

3. Hang the Soundbar on the wall.

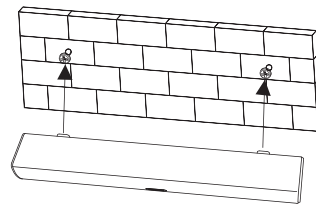

Remote Control

1. Battery installation

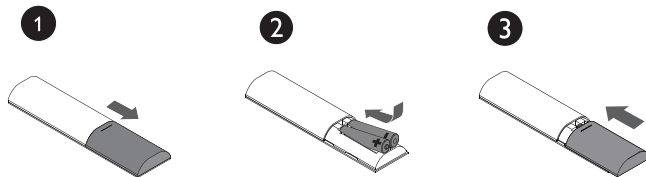



Button	Button functions
1 Power button	Press to switch on the Soundbar. Press the button again to put the Soundbar in standby mode.
2 Volume-up control	To make volume adjustments.
3 Previous	Return to previous track.
4 Play / Pause	To pause / resume playback.
5 Bluetooth button	To activate Bluetooth mode. 1. Press to activate Bluetooth mode. 2. Press and hold for 3 seconds for Bluetooth reconnection.
6 AUX button	To activate the AUX mode.

Button	Button functions
7 Music button	To activate the music equalizer mode.
8 Mute button	To temporarily turn off the sound. Press the button again to turn the sound back on.
9 Next	Move to next track.
10 Volume-down control	To make volume adjustments.
11 Optical button	To activate the optical mode.
12 Movie button	To activate the movie equalizer mode.

The status indicator light will stay on for approximately 10 seconds when the Soundbar is in Bluetooth mode / AUX IN mode / OPTICAL IN mode.

Using Your Soundbar

1. Turn On / Off

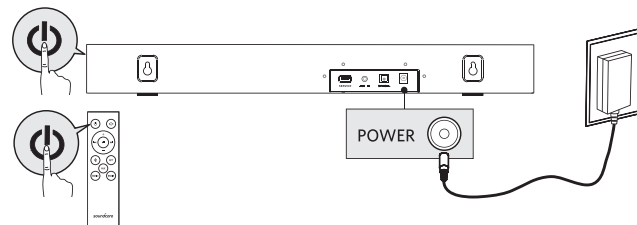

The Soundbar will automatically switch to standby mode when no audio input is received for over 15 minutes.

EN a. Connect to your TV

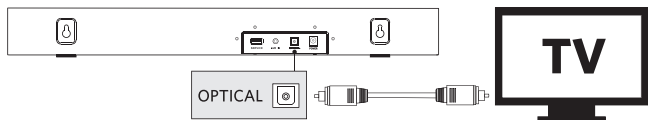

1. Connect optical cable to the optical output port of a stereo audio machine (such as TV / CD / VCR / DVD player ...etc).
 2. Press the OPT button on the remote control to activate optical mode.
- Note: the status indicator light will stay on for 10 seconds.

b. AUX-In mode

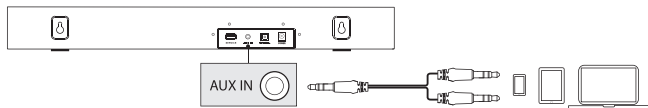

1. Connect audio cable (3.5mm to RCA stereo audio cable) to the audio output port of a stereo audio machine (such as TV / CD / VCR / DVD player ...etc).
 2. Press the AUX button on the remote control to activate AUX mode.
- Note: the status indicator light will stay on for 10 seconds.

c. Bluetooth mode

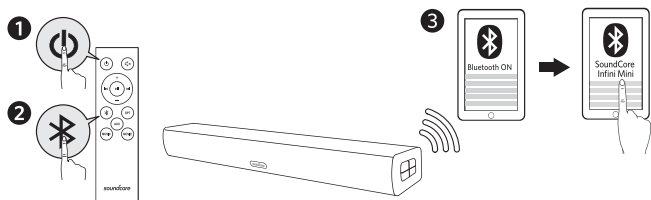

1. Press Power button on the remote control to switch on the Soundbar.
2. Press the Bluetooth button on the remote control to activate Bluetooth mode.
3. Turn on the Bluetooth of your device, search for Soundcore Infini Mini on your Bluetooth list then select connect.

Flashing Blue	Bluetooth mode is activated
Solid Blue	Connected to device Note: the status indicator light will stay on for 10 seconds.

When turned on, Soundcore Infini Mini Soundbar will automatically connect to the last connected device if available. If not, press the Bluetooth button to activate Bluetooth mode.

Having connection problems? Remove Soundcore Infini Mini from your device's Bluetooth history and ensure it's less than 10 meters away. Then try pairing again. To get the best sound quality, make sure there is a clear line of sight between the connected device and your Soundbar.

d. Respond to your TV remote control

Use your own TV remote control to control your Soundbar (Applicable for most of Vizio / LG / Philips TVs).

Press and hold Volume-down control and Source input button (on Soundbar) for more than 3 seconds to activate the remote control learning mode, then press Power button on the Soundbar and press the Power button on your TV remote control.

Note: only power, source input and volume of your Soundbar can be controlled by your TV remote control.

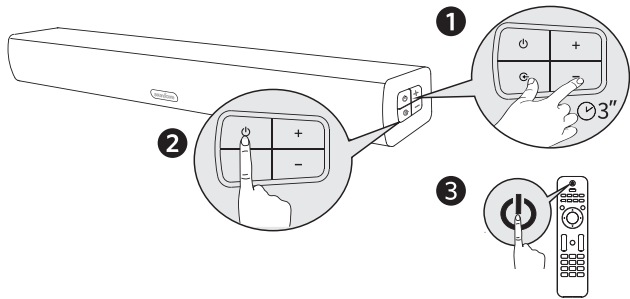

When not in use, store your Soundbar in a cool place.

Declaration of Conformity

Hereby, Anker Innovations Limited declares that the radio equipment type A3370 is in compliance with Directive 2014/53/EU. The full text of the EU declaration of conformity is available at the following internet address:

<https://www.anker.com/products>

Maximum output power: 4.0dBm

Frequency band: 2.4G band (2.4000GHz-2.4835GHz)

Specifications



Specifications are subject to change without notice.

Input: 18 V $\overline{\text{=}}$ 2.2 A

Audio output: 20 W x 2

Size : 550 x 63 x 94 mm / 21.6 x 2.5 x 3.7 in

Weight (without packaging): 1190 g / 42 oz

Bluetooth version: V2.1 + EDR

Range: 10 m / 33 ft

Sicherheitsinformationen

- Nicht fallenlassen.
- Nicht zerlegen.
- Nicht in Wasser tauchen.
- Extreme Temperaturen meiden.
- Das Produkt nicht bei Gewitter im Freien verwenden.
- Nur Original- oder zertifizierte Kabel verwenden.
- Weder scharfe Reinigungsmittel noch Öl verwenden.
- Das Produkt keinen Flüssigkeitropfen oder -spritzern aussetzen.
- Das Netzteil muss in der Nähe des Geräts installiert werden und leicht zugänglich sein.

Auf einen Blick

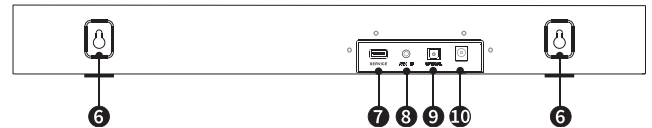
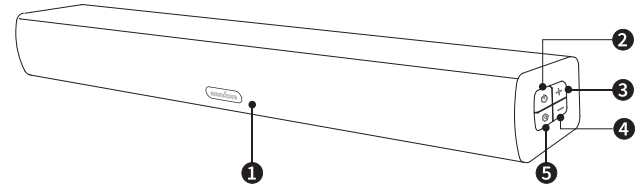

Status	Statusanzeige-Licht
Standby	Leuchtet rot
Bluetooth pairing mode	Blinkt blau
Bluetooth-Gerät verbunden	Leuchtet blau (10 Sekunden lang)
AUX	Leuchtet türkis (10 Sekunden lang)
Stummgeschaltet	Leuchtet gelb
Optisch	Leuchtet grün (10 Sekunden lang)
Lauter/leiser	Blinkt weiß
Max. Lautstärke	Leuchtet weiß (3 Sekunden lang)
Min. Lautstärke	Leuchtet weiß (3 Sekunden lang)
Musik	Blinkt einmal weiß
Film	Blinkt dreimal weiß

- 2 Ein-/Aus-Taste
- 3 Lautstärkeregler (auf)
- 4 Lautstärkeregler (ab)
- 5 Eingang
- 6 Löcher für Wandhalterung
- 7 USB-Anschluss (nur Service)
- 8 AUX-Eingang
- 9 Optischer Eingang
- 10 Stromeingang

Platzierung

1. Stellen Sie den Soundbar auf eine solide Oberfläche.

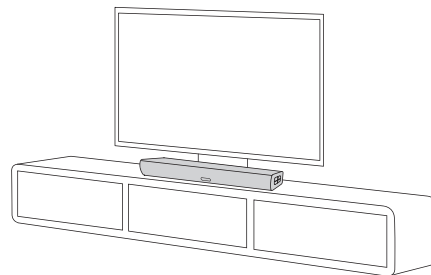

2. Zur Vermeidung von Gefahren dürfen keine offenen Flammen wie z. B. Kerzen auf dem Gerät oder in unmittelbarer Nähe platziert werden.

• Montage der Wandhalterung

1. Zwei Löcher in die Wand bohren (ca. 6 mm Durchmesser). Der Abstand zwischen den beiden Löchern muss 400 mm betragen. Siehe Abbildung unten:

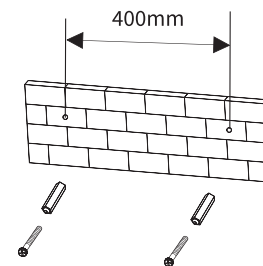

Die beiden Dübel in die Löcher stecken und dann die beiden Schrauben in die Dübel stecken.

- DE** 2. Die Schrauben mit einem Schraubendreher eindrehen, bis nur noch 4 mm Schraubenkopf freiliegen.

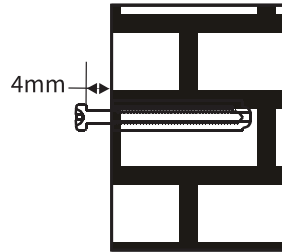

3. Den Soundbar an die Wand hängen.

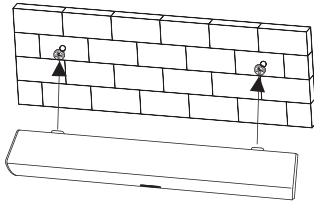

Fernbedienung

1. Batterien einsetzen

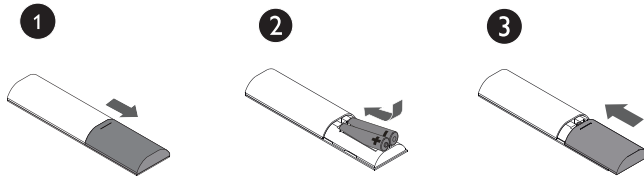

2. Tasten der Fernbedienung

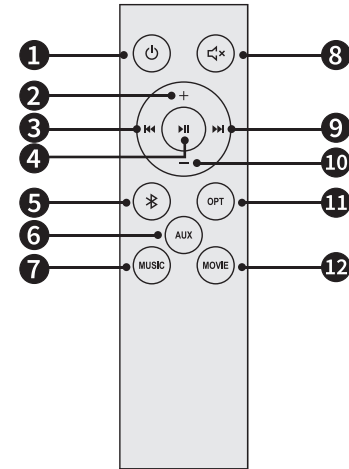

Taste	Tastenfunktionen
1 Ein-/Aus-Taste	Zum Einschalten des Soundbar drücken. Taste erneut drücken, um den Soundbar in den Standby-Modus zu schalten.
2 Lautstärkeregl. (auf)	Lautstärke anpassen.
3 Zurück	Zurück zu einem vorigen Track.
4 Wiedergabe/Pause	Wiedergabe unterbrechen/fortsetzen.
5 Bluetooth-Taste	Bluetooth-Modus aktivieren. 1. Zum Aktivieren des Bluetooth-Modus drücken. 2. 3 Sekunden lang gedrückt halten, um Bluetooth-Verbindung wiederherzustellen.
6 AUX-Taste	AUX-Modus aktivieren.