



# Owner's Manual

## Roav Smart Car Charger FO

### Safety Instructions

SAVE THESE INSTRUCTIONS - This manual contains important safety and operating instructions for the car charger (Model R5113).

Please read and understand all instructions before using this product. If damage is caused by failure to follow the instructions, the warranty does not apply.

- Read all instructions and cautionary markings before using this product.
- Do not expose to rain, moisture, or snow.
- Use of an attachment is not recommended or sold by the manufacturer may result in a risk of fire, electric shock, or injury to persons.
- Do not operate this car charger if it has received a sharp blow, been dropped, or otherwise damaged in any way; take it to a qualified service person.
- Do not disassemble this car charger; take it to a qualified service person when service or repair is required. Incorrect reassembly may result in a risk of electric shock or fire.
- To reduce risk of electric shock, unplug this car charger before attempting any maintenance or cleaning. Turning off controls will not reduce this risk.
- To reduce risk of fire or electric shock, do not interconnect output terminations.
- Avoid long exposure to direct sunlight, which may cause

- damage to the device.
- Exposing this product to open flames may cause it to explode.
- Do not use this product in strong magnetic fields.
- Use a dry, soft lint-free cloth to clean. Do not use any corrosive cleaner or oil to clean.
- CAUTION - For continued protection against risk of fire, replace only with the same type and ratings of fuse, fuse rating is 32V DC / 5A.
- Always obey traffic laws and pay attention to the road. Do not attempt to use this device while driving, as some features are limited while the vehicle is in motion. Failure to pay full attention to the operation of your vehicle could result in death, serious injury or property damage. You assume total responsibility and risk for using this device.

#### Consignes de sécurité importantes

CONSERVEZ CES CONSIGNES - Ce manuel contient d'importantes instructions de sécurité et d'utilisation relatives au chargeur de voiture modèle R5113.

Veuillez lire et comprendre toutes les instructions avant d'utiliser ce produit. Si le non-respect des instructions entraîne des dommages, la garantie ne s'appliquera pas.

- Lisez toutes les instructions et les mises en garde avant d'utiliser ce produit.
- Ne pas exposer à la pluie, l'humidité ou la neige.
- L'utilisation d'un accessoire non recommandé ou vendu par le fabricant peut entraîner un risque d'incendie, de choc électrique ou de blessure.
- Ne pas utiliser ce chargeur de voiture s'il a reçu un coup

- violent, s'il est tombé ou s'il a été endommagé de quelque façon que ce soit ; l'apporter à un technicien qualifié.
- Ne pas démonter ce chargeur de voiture ; l'apporter à un technicien qualifié lorsqu'une réparation est nécessaire. Un réassemblage incorrect peut entraîner un risque d'électrocution ou d'incendie.
- Pour réduire les risques d'électrocution, débrancher le chargeur de voiture avant d'effectuer toute opération d'entretien ou de nettoyage. La désactivation des commandes ne réduit pas ce risque.
- Pour réduire les risques d'incendie ou d'électrocution, ne pas interconnecter les terminaisons de sortie.
- Éviter toute exposition prolongée à la lumière directe du soleil, qui pourrait endommager l'appareil.
- L'exposition de ce produit à des flammes nues peut provoquer son explosion.
- Ne pas utiliser ce produit dans des champs magnétiques puissants.
- Utiliser un chiffon sec, doux et non pelucheux pour le nettoyage. Ne pas utiliser de nettoyant corrosif ni d'huile.
- ATTENTION - Pour une protection continue contre les risques d'incendie, ne remplacer le fusible que par un fusible de même type et de même spécification. Le fusible utilisé est de 32V DC / 5A.

- Keep these instructions.
- Do not drop, puncture or disassemble this product.
- This product shall not be exposed to dripping or splashing.
- Avoid long exposure to direct sunlight, which may cause damage.

- Exposing this product to open flames may cause explosion.
- Do not use the product in strong magnetic field.
- Use clean, soft cloth to clean. Do not use any corrosive cleaner/oil to clean.
- Keep your attention on the road. Do not operate the controls of this product while driving.

### Introduction

#### Features

- Hands-free call
- Streaming music to a car stereo via FM transmission or the AUX-Out socket
- Charging via Two USB charging ports
- Anker PowerIQ technology for faster device charging

#### What's Included

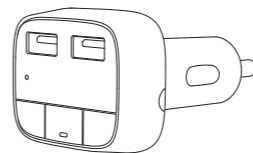

Roav Smart Car Charger FO

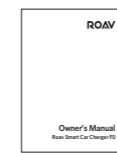

Manual

### At a Glance

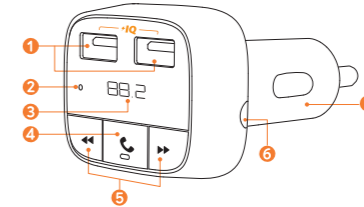

- 1 USB charging port
- 2 Microphone
- 3 LED display
- 4 Multifunction button
- 5 Multifunction button
- 6 AUX-Out socket
- 7 Car charger adapter

LED indicators	Status
Bluetooth / FM frequency flashes alternately	No Bluetooth connection detected
FM frequency is displayed	Bluetooth connected
FM frequency flashes	Enter FM mode
Call icon	Incoming call
Handset icon	In a call in hands-free mode
Smartphone icon	In a call through smartphone

- 4 Multifunction button
  - 5 Multifunction button
  - 6 AUX-Out socket
  - 7 Car charger adapter
- Press and hold for 3 seconds to power on/off.



## Get Started

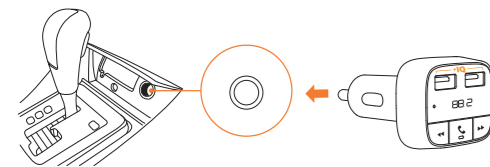

- 1 Plug Roav smart car charger FO into your vehicle's cigarette lighter socket.
- 2 Start your vehicle's engine and the LED display will light up.  / FM frequency will flash alternatively. Once you have completed step **4**, you should hear a "waiting to pair" voice prompt.



- 3 Enable Bluetooth on your smartphone and search for available Bluetooth devices. Select "Roav FO\_XXXX" and connect. Once successfully connected, FM frequency will be displayed. Once you have completed step **4**, you should hear a "successfully paired" voice prompt.

7



- 4 Turn on the FM radio on your car audio deck and tune to an unoccupied frequency (you should hear white noise). Press and hold the multifunction button on car charger until the FM frequency flashes. Press or hold  /  until the transmitting frequency matches the frequency your car stereo is tuned to.

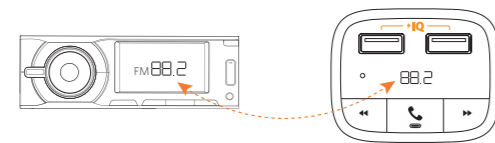



8

## Play Music

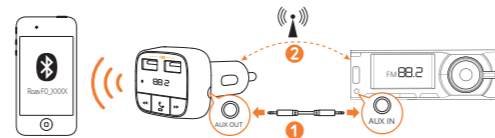
When the car charger is successfully connected with your smartphone, you can play music from your phone. Music can then be streamed to your car's audio system via FM transmitter or Aux-Out socket.



Play / Pause	Press 
Previous / Next track	Press  / 

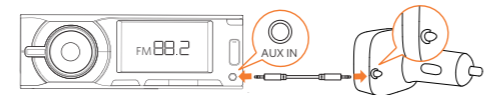

To further reduce echo and cabin noise on your calls and music, you can connect a 3.5 mm AUX cable (not provided) to the AUX-Out socket of the Roav smart car charger and the AUX-In socket of your car's audio system.



9

## Make Hands-Free Calls

When the car charger is successfully connected with your smartphone, you can enjoy convenient hands-free calls.

Answer / End a call	Press 
Reject a call	Press and hold  for 1 second

## Charge Your Devices

 The car charger is equipped with two USB charging ports. You can charge two devices simultaneously with a maximum output of 5V/4.8A.

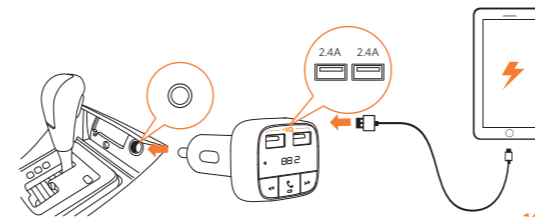

10

## Specifications

 Specifications are subject to change without notice.

DC input: 12V - 24V

Power output: 5V  $\equiv$  4.8A max

Bluetooth: V4.2

Bluetooth transmission distance: 10 m / 393.7 in

FM frequency range: 87.5-108 MHz

FM transmission range: 2 m / 78.7 in

Operating temperature range: -20°C to 40°C / -4°F to 104°F

Storage temperature range: -40°C to 85°C / -40°F to 185°F

11

## Notice

### FCC Statement

This device complies with Part 15 of the FCC Rules. Operation is subject to the following two conditions: (1) this device may not cause harmful interference, and (2) this device must accept any interference received, including interference that may cause undesired operation.

**Warning:** Changes or modifications not expressly approved by the party responsible for compliance could void the user's authority to operate the equipment.

**Note:** This equipment has been tested and found to comply with the limits for a Class B digital device, pursuant to Part 15 of the FCC Rules. These limits are designed to provide reasonable protection against harmful interference in a residential installation.

This equipment generates uses and can radiate radio frequency energy and, if not installed and used in accordance with the instructions, may cause harmful interference to radio communications. However, there is no guarantee that interference will not occur in a particular installation. If this equipment does cause harmful interference to radio or television reception, which can be determined by turning the equipment off and on, the user is encouraged to try to correct the interference by one or more of the following measures: (1) Reorient or relocate the receiving antenna. (2) Increase the separation

12

between the equipment and receiver. (3) Connect the equipment into an outlet on a circuit different from that to which the receiver is connected. (4) Consult the dealer or an experienced radio/TV technician for help.

### FCC Radio Frequency Exposure Statement

The device has been evaluated to meet general RF exposure requirements. The device can be used in fixed/mobile exposure condition. The min separation distance is 20cm.



## Customer Service

 12-month limited warranty

 Lifetime technical support

 support@goroav.com

 +1(800) 988 7973 (US) Mon-Fri 9:00-17:00 (PT)

 @GoRoav

 @GoRoav

14