



## Owner's Manual Roav SmartCharge Halo

### Important Safety Instructions

SAVE THESE INSTRUCTIONS – This manual contains important safety and operating instructions for the car charger (Model R5122).

Please read and understand all instructions before using this product. If damage is caused by failure to follow the instructions, the warranty does not apply.

- Read all instructions and cautionary markings before using this product.
- Do not expose to rain, moisture, or snow.
- Use of an attachment is not recommended or sold by the manufacturer may result in a risk of fire, electric shock, or injury to persons.
- Do not operate this car charger if it has received a sharp blow, been dropped, or otherwise damaged in any way; take it to a qualified service person.
- Do not disassemble this car charger; take it to a qualified service person when service or repair is required. Incorrect reassembly may result in a risk of electric shock or fire.
- To reduce risk of electric shock, unplug this car charger before attempting any maintenance or cleaning. Turning off controls will not reduce this risk.

- To reduce risk of fire or electric shock, do not interconnect output terminations.
- Avoid long exposure to direct sunlight, which may cause damage to the device.
- Exposing this product to open flames may cause it to explode.
- Do not use this product in strong magnetic fields.
- Use a dry, soft, lint-free cloth to clean. Do not use any corrosive cleaner or oil to clean.
- CAUTION - For continued protection against fire risk, replace only with the same type and ratings of fuse. The fuse rating is 63V DC / 7A.
- Always obey traffic laws and pay attention to the road. Do not attempt to use this device while driving, as some features are limited while the vehicle is in motion. Failure to pay full attention to the operation of your vehicle could result in death, serious injury or property damage. You assume total responsibility and risk for using this device.

### Consignes de sécurité importantes

CONSERVEZ CES CONSIGNES - Ce manuel contient d'importantes instructions de sécurité et d'utilisation relatives au chargeur de voiture modèle R5122.

- Veillez lire et comprendre toutes les instructions avant d'utiliser ce produit. Si le non-respect des instructions entraîne des dommages, la garantie ne s'appliquera pas.
- Lisez toutes les instructions et les mises en garde avant d'utiliser ce produit.
  - Ne pas exposer à la pluie, l'humidité ou la neige.
  - L'utilisation d'un accessoire non recommandé ou vendu par le fabricant peut entraîner un risque d'incendie, de choc électrique ou de blessure.
  - Ne pas utiliser ce chargeur de voiture s'il a reçu un coup violent, s'il est tombé ou s'il a été endommagé de quelque façon que ce soit ; l'apporter à un technicien qualifié.
  - Ne pas démonter ce chargeur de voiture ; l'apporter à un technicien qualifié lorsqu'une réparation est nécessaire. Un réassemblage incorrect peut entraîner un risque d'électrocution ou d'incendie.
  - Pour réduire les risques d'électrocution, débrancher le chargeur de voiture avant d'effectuer toute opération d'entretien ou de nettoyage. La désactivation des commandes ne réduit pas ce risque.
  - Pour réduire les risques d'incendie ou d'électrocution, ne pas interconnecter les terminaisons de sortie.
  - Éviter toute exposition prolongée à la lumière directe du soleil, qui pourrait endommager l'appareil.

- L'exposition de ce produit à des flammes nues peut provoquer son explosion.
- Ne pas utiliser ce produit dans des champs magnétiques puissants.
- Utiliser un chiffon sec, doux et non pelucheux pour le nettoyage. Ne pas utiliser de nettoyant corrosif ni d'huile.
- ATTENTION - Pour une protection continue contre les risques d'incendie, ne remplacer le fusible que par un fusible de même type et de même spécification. Le fusible utilisé est de 63V DC / 7A.

- ① Keep these instructions.
- ② Do not drop, puncture or disassemble this product.
- ③ This product shall not be exposed to dripping or splashing liquids.
- ④ Avoid long exposure to direct sunlight, which may cause damage to this product.
- ⑤ Exposing this product to open flames may cause explosion.
- ⑥ Do not use this product in strong magnetic fields.
- ⑦ Use a clean, soft cloth to clean. Do not use any corrosive cleaner/oil to clean.

### Introduction

#### Features

- Anker PowerIQ charging technology
- Quick Charge 3.0 charging technology
- Companion Roav Charger app with car battery monitor and car locator.
- LED indicator ring with colors customizable via the Roav Charger app.

#### What's Included

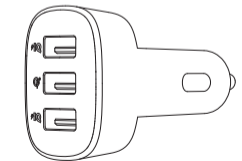

#### At a Glance

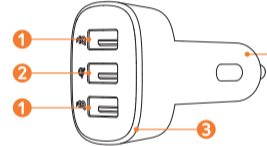

- ① USB charging port (PowerIQ)
- ② USB charging port (Quick Charge 3.0)
- ③ LED indicator ring
- ④ Adapter

### Getting Started

- ① Download the Roav Charger app from the App Store (iOS devices) or Google Play (Android devices).



- ② Plug Roav SmartCharge Halo into your vehicle's cigarette lighter socket. Start the engine and Roav SmartCharge Halo will automatically power on.



Model: R5122  
51005001098 V01

### LED Indicator Ring Status

Status	LED Indicator Ring
Power on	Turns blue
Waiting Bluetooth connect	Flashes slowly for 90 seconds
Bluetooth connected	Steady blue (by default)
Bluetooth not connected	Steady red (by default)
Power off	Off

Note: Users can customize colors for connection status on the Roav Charger app.  
Users can also turn off the LED indicator ring via Roav Charger app.

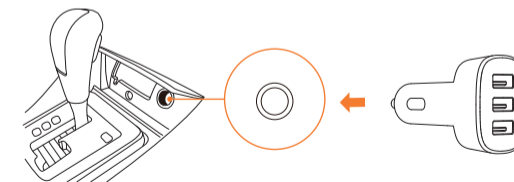

3 Open the Roav Charger app and follow the instructions to connect the device via Bluetooth. Enable Bluetooth on your smartphone and search for available Bluetooth devices. Select "Roav Halo\_XXX" and connect. Once connected, the LED indicator ring will turn blue by default.

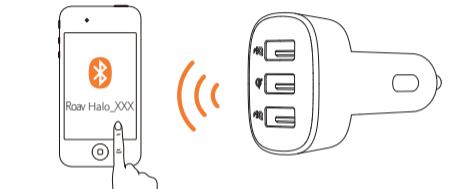

4 Now you can locate your car, set a parking timer, check your vehicle's car battery, customize the colors of the LED indicator ring, and find out more via the Roav Charger app.

### Charge Your Devices

Roav SmartCharge Halo has three USB charging ports. You can charge three devices at the same time with a maximum output power of 30W.

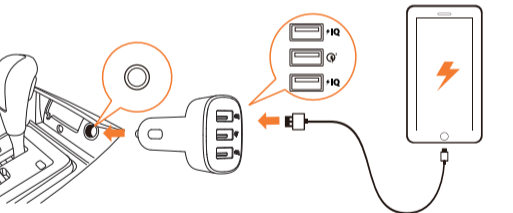

### Specifications

Specifications are subject to change without notice.

DC input: 12V-24V  
Power IQ output: 5V = 2.4A  
Quick Charge 3.0 output: 3.6V-6.5V = 3A, 6.5V-9V = 2A, 9V-12V = 1.5A  
Total wattage: 30W  
Bluetooth: V4.1  
Operating temperature range: -20°C to 40°C / -4°F to 104°F  
Storage temperature range: -40°C to 85°C / -40°F to 185°F

### Notice

#### FCC Statement

This device complies with Part 15 of the FCC Rules. Operation is subject to the following two conditions: (1) this device may not cause harmful interference, and (2) this device must accept any interference received, including interference that may cause undesired operation.  
**Warning:** Changes or modifications not expressly approved by the party responsible for compliance could void the user's authority to operate the equipment.

**Note:** This equipment has been tested and found to comply with the limits for a Class B digital device, pursuant to Part 15 of the FCC Rules. These limits are designed to provide reasonable protection against harmful interference in a residential installation.

This equipment generates uses and can radiate radio frequency energy and, if not installed and used in accordance with the instructions, may cause harmful interference to radio communications. However, there is no guarantee that interference will not occur in a particular installation. If this equipment does cause harmful interference to radio or television reception, which can be determined by turning the equipment off and

on, the user is encouraged to try to correct the interference by one or more of the following measures: (1) Reorient or relocate the receiving antenna. (2) Increase the separation between the equipment and receiver. (3) Connect the equipment into an outlet on a circuit different from that to which the receiver is connected. (4) Consult the dealer or an experienced radio/TV technician for help.

#### FCC Radio Frequency Exposure Statement

The device has been evaluated to meet general RF exposure requirements. The device can be used in fixed/mobile exposure condition. The min separation distance is 20cm.



Qualcomm Quick Charge is a product of Qualcomm Technologies, Inc. Qualcomm and Quick Charge are trademarks of Qualcomm Incorporated, registered in the United States and other countries. All Qualcomm Incorporated trademarks are used with permission.



Apple and the Apple logo are trademarks of Apple Inc., registered in the U.S. and other countries. App Store is a service mark of Apple Inc., registered in the U.S. and other countries.

Google Play and the Google Play logo are trademarks of Google Inc.

### Customer Service

- 18-month limited warranty
- Lifetime technical support
- support@goroav.com
- +1(800) 988 7973 (US) Mon-Fri 9:00-17:00 (PT)

@GoRoav @GoRoav

© Anker Innovations Limited All rights reserved. ROAV and the ROAV logo are trademarks of Anker Innovations Limited registered in the United States and other countries. All other trademarks are the property of their respective owners.