

Roav Bolt Owner's Manual

Important Safety Instructions

SAVE THESE INSTRUCTIONS – This manual contains important safety and operating instructions for the car charger of Roav Bolt (Model R5360).

Please read and understand all instructions before using this product. If damage is caused by failure to follow the instructions, the warranty does not apply.

- Read all instructions and cautionary markings before using this product.
- Do not expose to rain, moisture, or snow.
- Use of an attachment not sold by the manufacturer is not recommended and may result in a risk of fire, electric shock, or injury to persons.
- Do not operate this car charger if it has received a sharp blow, been dropped, or otherwise damaged in any way; take it to a qualified service person.
- Do not disassemble this car charger; take it to a qualified service person when service or repair is required. Incorrect reassembly may result in a risk of electric shock or fire.
- To reduce risk of electric shock, unplug this car charger before attempting any maintenance or cleaning. Turning off controls will not reduce this risk.
- To reduce risk of fire or electric shock, do not interconnect output terminations.
- Avoid long exposure to direct sunlight, which may cause damage to the device.
- Exposing this product to open flames may cause it to explode.
- Do not use this product in strong magnetic fields.
- Use a dry, soft lint-free cloth to clean. Do not use any corrosive cleaner or oil to clean.
- CAUTION - For continued protection against risk of fire, replace only with the same type and ratings of fuse, fuse rating is 32V DC / 7A.
- Always obey traffic laws and pay attention to the road. Do not attempt to use this device while driving, as some features are limited while the vehicle is in motion. Failure to pay full attention to the operation of your vehicle could result in death, serious injury or property damage. You assume total responsibility and risk for using this device.

FR:

Consignes de sécurité importantes

CONSERVEZ CES CONSIGNES - Ce manuel contient d'importantes instructions de sécurité et d'utilisation relatives au chargeur de voiture modèle R5360.

Veillez lire et comprendre toutes les instructions avant d'utiliser ce produit. Si le non-respect des instructions entraîne des dommages, la garantie ne s'appliquera pas.

- Lisez toutes les instructions et les mises en garde avant d'utiliser ce produit.

- Ne pas exposer à la pluie, l'humidité ou la neige.
 - L'utilisation d'un accessoire non recommandé ou vendu par le fabricant peut entraîner un risque d'incendie, de choc électrique ou de blessure.
 - Ne pas utiliser ce chargeur de voiture s'il a reçu un coup violent, s'il est tombé ou s'il a été endommagé de quelque façon que ce soit ; l'apporter à un technicien qualifié.
 - Ne pas démonter ce chargeur de voiture ; l'apporter à un technicien qualifié lorsqu'une réparation est nécessaire. Un réassemblage incorrect peut entraîner un risque d'électrocution ou d'incendie.
 - Pour réduire les risques d'électrocution, débrancher le chargeur de voiture avant d'effectuer toute opération d'entretien ou de nettoyage. La désactivation des commandes ne réduit pas ce risque.
 - Pour réduire les risques d'incendie ou d'électrocution, ne pas interconnecter les terminaisons de sortie.
 - Éviter toute exposition prolongée à la lumière directe du soleil, qui pourrait endommager l'appareil.
 - L'exposition de ce produit à des flammes nues peut provoquer son explosion.
 - Ne pas utiliser ce produit dans des champs magnétiques puissants.
 - Utiliser un chiffon sec, doux et non pelucheux pour le nettoyage. Ne pas utiliser de nettoyant corrosif ni d'huile.
 - ATTENTION - Pour une protection continue contre les risques d'incendie, ne remplacer le fusible que par un fusible de même type et de même spécification. Le fusible utilisé est de 32V DC / 7A.
-

Introduction

What's Included

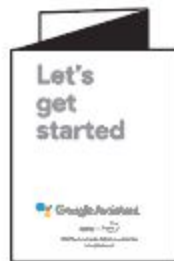
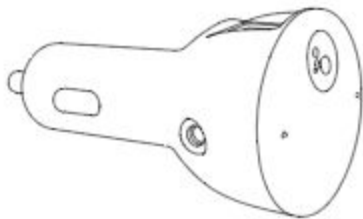



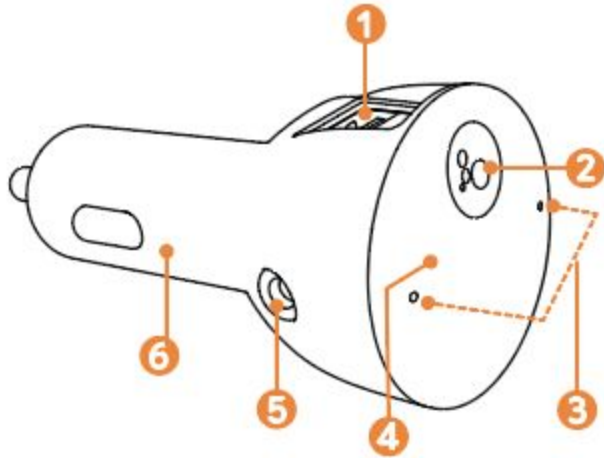

At a Glance





- ① USB charging port
- ② Multifunction button
- ③ Microphones
- ④ LED indicator
- ⑤ Aux out socket
- ⑥ Adapter



Button Controls

Interactions

| Action | Gesture |
|------------------------------|---|
| Talk to the Google Assistant |  |
| Stop the Google Assistant |  |
| Get notifications |  |
| Mute/Unmute microphone |  |
| Reset and forget all pairing |  |

Call Mode

| | |
|-------------------------|---|
| Answer an incoming call |  |
| End an active call |  |
| Ignore an incoming call |  |

-  Single press
-  Long press (0.5 sec)
-  Very long press (12 sec)

LED Indications (to be updated)

| Status | LED Ring Indicator | Description |
|--------------------------|---|---|
| Connected | Alternately pulses dim white, then simultaneously flashes and glows white | The companion app is connected to the device. |
| Disconnected | Alternately dims and fades out | The companion app has disconnected from the device. |
| Ready to pair | Alternately glows and dims blue from left to right | The device's pairing list is empty. |
| Listening | Simultaneously pulses white | Listening for hotword |
| Thinking | Alternately pulses white | Query is detected, retrieving answer |
| Hotword, hotword timeout | Simultaneously pulses white, and then fades out | Hotword is detected, listening for more audio |
| Non-VUI response | Breathing white light | No voice response |
| Responding | Simultaneously pulses white | Responding to query |
| Mic off | Orange light dims to 50% brightness | Microphone off |
| Reset | Orange light glows alternately for 12 seconds | Reset all the pairing |

Note: More LED indicator status will be updated later.

Using Roav Bolt

1. Download the Google Assistant app from the App Store or Google Play. If your phone has the app installed, skip this step.



2. Plug Roav Bolt into your vehicle's cigarette lighter socket and then start the engine.

- Roav Bolt will show a blue animated light.

Setting up the Google Assistant

Getting started

1. Go to **Settings > Bluetooth** to pair your phone with Roav Bolt.
 - The Google Assistant setup notification will pop up.

iOS users can open the Google Assistant app, click "set up" card and go to step 3 directly.

2. Click on the notification to proceed to the Google Assistant setup.
3. Follow the on-screen instructions on the Google Assistant app to complete setup.

Set up the Google Assistant

There are two ways to set up the Google Assistant according to your car's Bluetooth features.

- When your phone is paired with your car using Bluetooth:

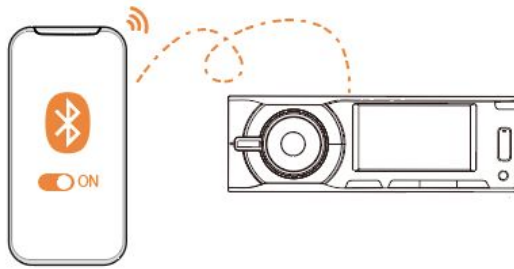

1. Pair your phone with Roav Bolt.

- A “Bluetooth Pairing Request” prompt will pop up. (iOS devices only)

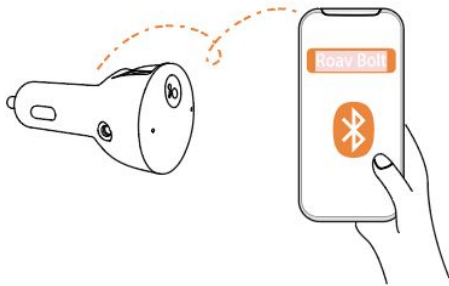

2. Make sure your car's Bluetooth is connected correctly.

3. Test your car's stereo.

- You'll hear a tone to test the connection.

- When your phone is not paired with your car:

1. Pair your phone with Roav Bolt.

- A “Bluetooth Pairing Request” prompt will pop up. (iOS devices only)

2. Select either option to play audio from your car's speakers.

Option A. Select “Car's Bluetooth”

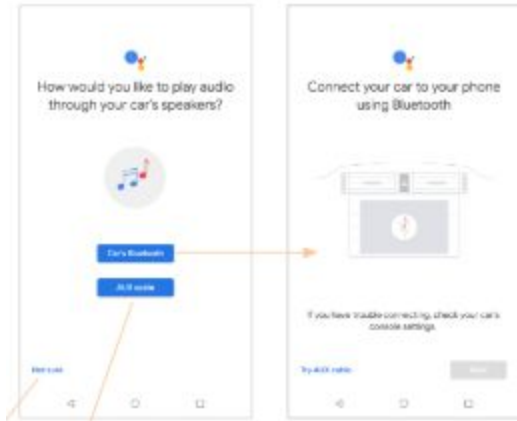

- ① Switch your car stereo to Media/Bluetooth. Make sure your car supports media audio and phone audio via Bluetooth.
- ② Go to **Settings > Bluetooth** to search for your car's Bluetooth, and then connect.
- ③ Go back to the Google Assistant, and test your car's stereo.
 - You'll hear a tone to test the connection.

Note: If your car doesn't support Bluetooth (media audio and phone audio), select "Aux cable".

Option B. Select "Aux cable"

- ① Switch your car stereo to Aux mode.
- ② For iPhone users, go to **Settings > Bluetooth** to search Roav Bolt's Bluetooth, and then connect. Both "Roav Bolt" and "Roav Bolt_LE" should be connected.

For Android phone users, wait until Roav Bolt is paired with your phone.

- ③ Use the Aux cord to connect Roav Bolt to your car. (A picture showing connection process will be added.)

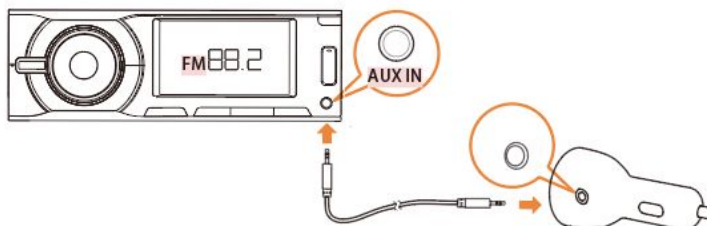

- ④ Test your car's stereo.
 - You'll hear a tone to test the connection.

Using the Google Assistant

The Google Assistant comes with a voice service feature. You can play music, get turn-by-turn navigation, manage everyday tasks, and easily control smart devices by using your voice.

Follow the on-screen instructions in the Google Assistant app, say “**OK Google**” or “**Hey Google**”, or



The Google Assistant Command

→ Roav Bolt will respond instantly.

→ Visit assistant.google.com/ for more information, or download the Google Assistant app on your iOS/Android device.

→ To enable more skills on your device, please visit the "**What it can do**" page on assistant.google.com/

.

Charging Your Devices

Roav Bolt has two USB charging ports. You can charge two devices at the same time with a maximum output of 5V / 4.8A.

A picture showing how to charge your devices will be added.

Specifications

Note: Specifications are subject to change without notice.

DC input: 12V - 24V

Power output: 5V = 4.8A max

Bluetooth: V4.1

Bluetooth transmission distance: 33ft / 10m

Aux out: 3.5 mm audio output

Operating temperature range: -20°C to 40°C / -4°F to 104°F

Storage temperature range: -40°C to 85°C / -40°F to 185°F

Notice



This product complies with the radio interference requirements of the European Community.

Declaration of Conformity

Hereby, Anker Innovations Limited declares that this device is in compliance with the essential requirements and other relevant provisions of Directive 2014/53/EU. For the declaration of conformity, visit the Web site www.goroav.com.

This product can be used across EU member states.

The product shall only be connected to a USB Interface of version 2.0 or higher.

The device complies with RF specifications when the device used at 20mm from your body.

BT Operating Frequency Range: 2402-2480 MHz

The following importer is the responsible party (contact for EU matters only)

Importer: Anker Technology (UK) Ltd

Importer Address: Suite B, Fairgate House, 205 Kings Road, Tyseley, Birmingham, B11 2AA, United Kingdom



This product is designed and manufactured with high quality materials and components, which can be recycled and reused.



This symbol means the product must not be discarded as household waste, and should be delivered to an appropriate collection facility for recycling. Proper disposal and recycling helps protect natural resources, human health and the environment. For more information on disposal and recycling of this product, contact your local municipality, disposal service, or the shop where you bought this product.



FCC Statement

This device complies with Part 15 of the FCC Rules. Operation is subject to the following two conditions: (1) this device may not cause harmful interference, and (2) this device must accept any interference received, including interference that may cause undesired operation.

Warning: Changes or modifications not expressly approved by the party responsible for compliance could void the user's authority to operate the equipment.

Note: This equipment has been tested and found to comply with the limits for a Class B digital device, pursuant to Part 15 of the FCC Rules. These limits are designed to provide reasonable protection against harmful interference in a residential installation.

This equipment generates uses and can radiate radio frequency energy and, if not installed and used in accordance with the instructions, may cause harmful interference to radio communications. However, there is no guarantee that interference will not occur in a particular installation. If this equipment does cause harmful interference to radio or television reception, which can be determined by turning the equipment off and on, the user is encouraged to try to correct the interference by one or more of the following measures: (1) Reorient or relocate the receiving antenna. (2) Increase the separation between the equipment and receiver. (3) Connect the equipment into an outlet on a circuit different from that to which the receiver is connected. (4) Consult the dealer or an experienced radio/TV technician for help.

FCC Radio Frequency Exposure Statement

The device has been evaluated to meet general RF exposure requirements. The device can be used in fixed/mobile exposure condition. The min separation distance is 20cm.

The following importer is the responsible party.

Company Name: Fantasia Trading LLC

Address: [9155 Archibald Avenue](#), Suite 202, Rancho Cucamonga, CA, 91730, US

Telephone: +1 (909) 484 1530

IC Statement

This device complies with Industry Canada licence-exempt RSS standard(s). Operation is subject to the following two conditions:

- (1) this device may not cause interference, and
- (2) this device must accept any interference, including interference that may cause undesired operation of the device."

Le présent appareil est conforme aux CNR d'Industrie Canada applicables aux appareils radio exempts de licence. L'exploitation est autorisée aux deux conditions suivantes:

- (1) l'appareil n' doit pas produire de brouillage, et
- (2) l'utilisateur de l'appareil doit accepter tout brouillage radioélectrique subi, même si le brouillage est susceptible d'en compromettre le fonctionnement."

This Class B digital apparatus complies with Canadian ICES-003.
Cet appareil numérique de la classe B est conforme à la norme NMB-003 du Canada.

IC RF Statement:

When using the product, maintain a distance of 20 cm from the body to ensure compliance with RF exposure requirements.

Lors de l'utilisation du produit, maintenez une distance de 20 cm du corps afin de vous conformer aux exigences en matière d'exposition RF.

Trademark



The Google Assistant and all related logos are trademarks of Google LLC.

Apple and the Apple logo are trademarks of Apple Inc., registered in the U.S. and other countries.

“Android” is a registered trademark of Google LLC in the United States and other countries.

“iOS” is a registered trademark of Apple Inc. in the United States and other countries.



The Bluetooth® word mark and logos are registered trademarks owned by Bluetooth SIG, Inc.

Other trademarks and trade names are those of their respective owners.

Customer Service



12-month limited warranty



Lifetime technical support



support@goroav.com



(US) +1 (800) 988 7973 Mon-Fri 9:00-17:00 (PT)



Live Chat on Roav app and website



@GoRoav



@GoRoav

Anker Innovations Limited

Room 1318-19, Hollywood Plaza, 610 Nathan Road, Mongkok, Kowloon, Hong Kong

© Anker Innovations Limited. All rights reserved. ROAV and the ROAV logo are trademarks of Anker Innovations Limited, registered in the United States and other countries.

Model: R5360
