

Welcome Guide

Multi-Functional Car Jump Starter External Battery

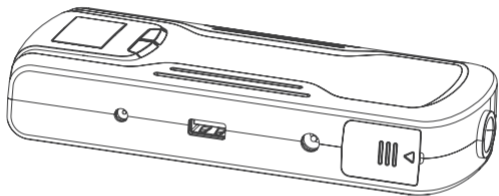

Multi-Functional Car Jump Starter External Battery

Package Contents

- Anker® 12000mAh External Battery
- 15V / 1A Adapter
- 15V / 1A Car Adapter
- Charging Base for Car Adapter
- Jumper Clamps
- Welcome Guide

Identification of Parts



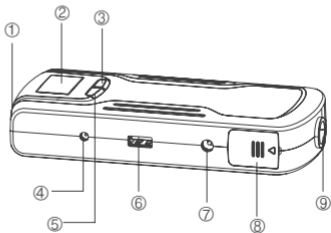



1. LED flashlight
2. LCD power monitor
3. Flashlight button
4. DC input port
5. Power button
6. 5V / 2.1A USB output port
7. 12V / 10A DC output port
8. 12V jump starter port
9. Compass





Technical Specifications

Capacity	12000mAh /44.4Wh
Net Weight	439g / 15.5oz
Size	162 × 78 × 32mm / 6.2 × 3.0 × 1.3in
DC Input	15V / 1A
USB Output	5V / 2.1A
DC Output	12V / 10A
Starting Current	200A
Peak Current	400A (3 sec)
Operating Temperature	0-40°C / 32-104°F

LCD Monitor Display

Indicator	Status
	Charging in progress
	≥60% power remaining
Alarm	<50% power remaining
 (flashing)	<10% power remaining
	USB output port charging
	Flashlight on
	% power remaining

Note:

Press the power button  to power on the external battery. When powered on, press the flashlight button  to activate the LED flashlight and toggle between intense light, strobe light, SOS and off. To cancel the alarm, double press the power button, and hold to power off.

How to Charge Your Anker Jump Starter Battery

1. Connect either (a) the included AC adapter to a wall socket or (b) the included car adapter to a cigarette lighter socket.
2. Plug the remaining end of the chosen adapter into the Jump Starter Battery's input port.
3. Press the power button to begin charging. The Jump Starter Battery will take 4 hours to fully charge via the AC adapter or car adapter.

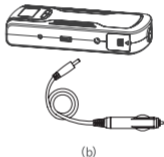
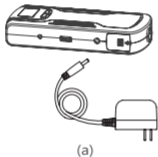

How to Use the Anker Jump Starter Battery to Start a Car

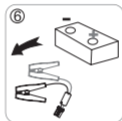
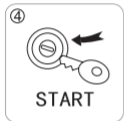
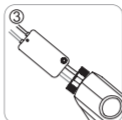
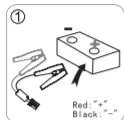

1. Make sure the Jump Starter Battery is at least 20% charged.
2. Connect the red clamp to the positive "+" end of your car's battery and the black clamp to the negative "-" end.
3. Plug the power cable attached to the clamps into the 12V jump starter port.
4. Press the power button. The green LED will light up to show the battery is on.
5. Start your vehicle and remove the battery within 30 seconds of your car starting.
6. Remove the clamps from the battery.

How to Charge Phones, Tablets and Other Electronic Devices

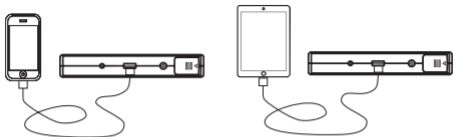

1. Plug the USB end of your charging cable into the Jump Starter Battery's 5V output port.
2. Attach the remaining end of your USB charging cable to your device.
3. Press the power button to begin charging.

How to Charge 12V Devices or Vehicles

1. Plug the AC adapter or car adapter into the Jump Starter Battery's 12V output port.
2. Connect the remaining end of the adapter to your 12V device or vehicle.
3. Press the power button to begin charging.

Usage Notes

1. To protect the long-term capacity of your device's battery, please unplug the power wire promptly after the device is fully charged.
2. Keep the product away from extreme heat or cold, as well as any flammable items or damp places. Also avoid dropping, hitting or throwing the product.
3. Please fully charge your external battery at least once every 3 months to avoid shortening its lifespan.
4. Do not try to charge and discharge the Jumper Starter Battery at the same time, as this may reduce the battery's lifespan.
5. The clamps should not be used for any activity other than jump starting a car.

ATTENTION

- To avoid injury and/or damage to your device or vehicle, do not connect the red and black clamps together.
- Remove the battery within 30 seconds of starting your car.

WARNING

- Contains explosive material.
- Contact with battery acid can cause severe burns and blindness.
- Do not disassemble or place near fire.
- Keep out of reach of children.

Warranty

Our company provides customers with a warranty of **18 MONTHS** from the date of purchase.

Contact Us

For any inquiries or comments concerning our products, please send an email to support@ianker.com, and we will respond to you as soon as possible. If there is any quality-related issue with the product, you may request a REPLACEMENT OR REFUND by submitting a request form at www.ianker.com/support.

Statement

- We're only able to provide after-sales service for purchases made directly from Anker. If you purchased through a different retailer, please contact them for any exchange or refund requests.
- Please note that unauthorized reselling of Anker products is prohibited.



1-800-988-7973 (U.S.) Mon-Fri 9:00-5:00 (PST)

www.ianker.com
support@ianker.com