

# Quick Setup Guide

## Digital Pen

아날로그로 쓰고,  
디지털로 본다.

### How to use the Android application

- User can do Bluetooth pairing with simple steps once the pen already registered as bluetooth device

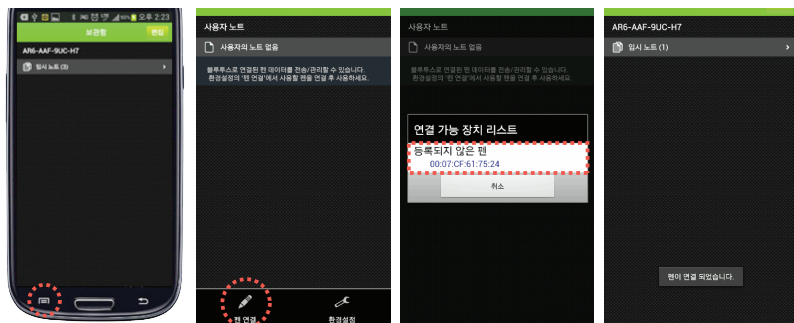

1. Click the option button
2. Click the Pen connection button
3. Select your device
4. Message for success to connect between the pen and the Android mobile device.

- Check the connection between the pen and the Android mobile device. The green LED keeps turn-on status when the pen is connected correctly
- User can write a pen to exclusive notes or can view the saved note on the Android mobile device

### Function

- Transmission in real time : Real time transmission the written contents by the digital pen from exclusive notes to the Android mobile device or computer in real time.
- Transmission after saving : The digital pen can save the written contents when it is not paired in Bluetooth.

(NOTE) To save the written contents, the pen should keep the turn-on status when it is written but it is no problem to save when the pen is not paired with Bluetooth.

### LED Mode

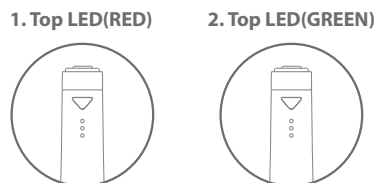

- 1. Top LED(RED)** : Blinking : Warning the low battery or memory full  
Keep on : Warning the discharged battery level or pen working error
- 2. Top LED(GREEN)** : Blinking : Transmission after saving / Keep on : Transmission in real time

### Mobile(Android) Ver.

### Function and Mode

### How to install the Android app.

- Search the app. named PenHub using the keyword "ADP-611" in Google Play and please download and install the PenHub.
- Supported OS version  
- The PenHub can work under Android OS ver. 3.0(Honey comb) to 4.4(Kitkat) with BLE H/W

### How to Bluetooth pairing(Registering) in Android mobile device.

1. Run the PenHub application
2. Put the ADP-611 to search mode by turn-off and turn-on again.



3. Click the option button
4. Click the Pen connection button
5. Tab the "Pen connection(Auto)"



6. Select the ADP-611
7. Input the PIN code as "0000"
8. Done the pairing

9. Please turn off and on after Bluetooth pairing(Registering)

### Mobile(Android) Ver.

### Unpacking

01. Digital Pen 611
02. Starter Note A5
03. Micro USB Cable
04. Pen Cap
05. Refill / Stylus

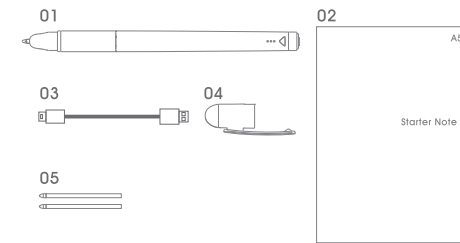

### Specification

Model	ADP-611
Weight	30g
Communication	BLE
Operating angle	-20 ~ +40 degree
External interface	Micro USB Cable for charging
Size	165 x 12.4 x 14mm
Battery	Li-Polymer
Charging method	Standard USB charging

### Caution

- Do not disassemble or otherwise attempt to change the form of the Digital Pen 611.
- Do not crush, puncture or shred the Digital Pen 611.
- Do contact the C/S center when the Digital pen doesn't work.
- Do not insert any other writing thing except supplied refill
- The pen is not working under
  - turned off
  - exceeded from the operation degree
  - put hand or something over the front of the pen(optical sensor)
- Do not choke down the pen cap or refill.
- Do pay attention not to get pierced by a refill
- Do not let the pen come in contact with liquids and do not dry with heater by force
- Do not place the pen in or near a heat source.
- Do use the pen in the condition of room temperature.
- Do not use the chemicals such as alcohol to clean the pen. Do use a piece of soft cloth.
- Do not use incompatible charger. Misuse or use of incompatible charging device could result in damage to the equipment and a possible risk of fire, explosion, or leakage, leading to serious injuries, damages to your pen.

- \* Wireless device encountered interference from other devices.
- \* Don't attempt to use the battery improperly or replace yourself - you may damage the battery, which could cause overheating and injury.
- \* Do dispose of the battery in accordance with local regulations. Never dispose of battery in a fire because it may explode.

This device complies with Part 15 of the FCC Rules. Operation is subject to the following two conditions: (1) this device may not cause harmful interference, and (2) this device must accept any interference received, including interference that may cause undesired operation.

CAUTION : Any Changes or modifications not expressly approved by the manufacturer could void the user's authority to operate the equipment.

This equipment has been tested and found to comply with the limits for a Class B digital device, pursuant to part 15 of the FCC Rules. These limits are designed to provide reasonable protection against harmful interference in a residential installation. This equipment generates, uses and can radiate radio frequency energy and, if not installed and used in accordance with the instructions, may cause harmful interference to radio communications. However, there is no guarantee that interference will not occur in a particular installation. If this equipment does cause harmful interference to radio or television reception, which can be determined by turning the equipment off and on, the user is encouraged to try to correct the interference by one or more of the following measures:

- Reorient or relocate the receiving antenna.
- Increase the separation between the equipment and receiver.
- Connect the equipment into an outlet on a circuit different from that to which the receiver is connected.
- Consult the dealer or an experienced radio/TV technician for help.