

## Installing an AirPort Extreme Card

AirPort offers an affordable and easy way to provide wireless Internet access anywhere in the home, at work, or in the classroom. You can install an AirPort Extreme Card in your Power Mac G5.

**Important:** You must install an AirPort Extreme Card. Older AirPort Cards will not work in this Power Mac G5.

- 1 Open your computer following the directions on page 64.
- 2 Position the AirPort Extreme Card with the Apple logo facing up and insert the card into the AirPort Extreme Card connector.

Insert the AirPort Extreme Card into the card slot. The Apple logo on the card should be facing up. Press the card firmly into the connector located on the main logic board.

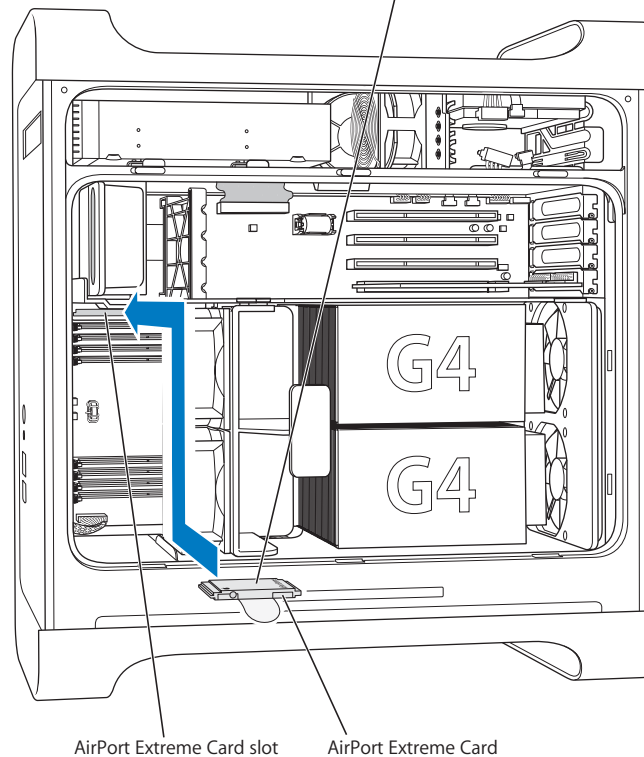

- 3 Carefully connect the coaxial antenna wire to the port on the end of the AirPort Extreme Card, allowing it to snap into the antenna jack.
- 4 Replace the front fan assembly, air deflector, and side panel, following the directions that begin on page 70.

- 5 Attach the AirPort antenna to the AirPort antenna port (  ) on the back panel.

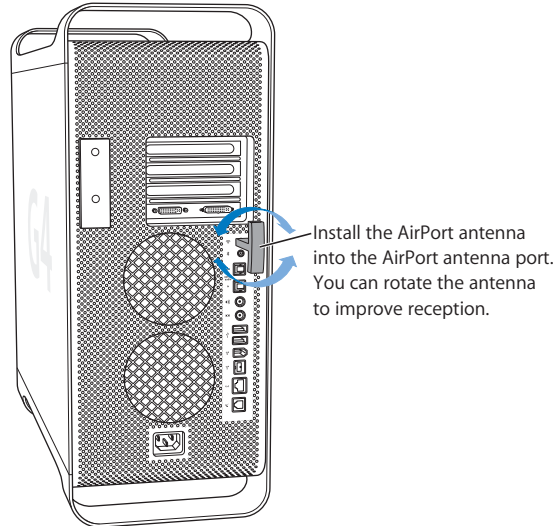

**Warning:** The FCC Rules require that the operator or a nearby person be more than 1 centimeter (0.4 inches) away from the Airport Extreme antenna during transmission. In addition, the Airport Extreme antenna must not be co-located with any other transmitter or antenna except for the Apple Bluetooth antenna model A1067.

## Replacing the Battery

Your computer has a 3.6 V lithium battery on the main logic board. If your computer has intermittent problems starting up or random changes in its date and time settings, you may need to replace the battery. Purchase a replacement battery from an Apple-authorized dealer.

**Important:** Batteries contain chemicals, some of which may be harmful to the environment. Please dispose of used batteries according to your local environmental laws and guidelines.