

Find thousands more
great ideas online

Brookstone®

845794

Merrimack, New Hampshire USA 03054 • 800-846-3000 • Brookstone.com

Brookstone®

Big Blue® Media Tower

ALL-IN-ONE MUSIC AND TV SOUND SYSTEM

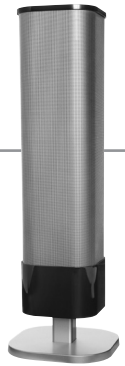

TABLE OF CONTENTS

Warnings and Cautions.....	1
Location of Parts and Controls.....	5
Set Up	8
Pairing Your Device	8
Using Big Blue After Pairing.....	9
Adjusting Volume	9
Adjusting Bass.....	10
Adjusting Treble.....	11
Using Optical Source	11
Using RCA Source.....	11
Using Aux Out.....	12
Compatibility.....	12
Troubleshooting.....	13
Specifications.....	14
Warranty	16

but Brookstone, in so far as permitted by law, provides these products “as is.” This warranty does not apply to: a) damage caused by failure to follow instructions relating to product’s use or the installation of components; b) damage caused by accident, abuse, misuse, fire, floods, earthquake or other external causes; c) damage caused by service performed by anyone who is not a representative of Brookstone; d) accessories used in conjunction with a covered product; e) a product or part that has been modified to alter functionality or capability; f) items intended to be periodically replaced by the purchaser during the normal life of the product including, without limitation, batteries or light bulbs; g) any product sold “as is” including, without limitation, floor demonstration models and refurbished items; or h) a product that is used commercially or for a commercial purpose.

BROOKSTONE SHALL NOT BE LIABLE FOR INCIDENTAL OR CONSEQUENTIAL DAMAGES RESULTING FROM THE USE OF THIS PRODUCT, OR ARISING OUT OF ANY BREACH OF THIS WARRANTY. TO THE EXTENT PERMITTED BY APPLICABLE LAW, BROOKSTONE DISCLAIMS ANY AND ALL STATUTORY OR IMPLIED WARRANTIES, INCLUDING, WITHOUT LIMITATION, WARRANTIES OF MERCHANTABILITY, FITNESS FOR A PARTICULAR PURPOSE AND WARRANTIES AGAINST HIDDEN OR LATENT DEFECTS. IF BROOKSTONE CANNOT LAWFULLY DISCLAIM STATUTORY OR IMPLIED WARRANTIES, THEN TO THE EXTENT PERMITTED BY LAW, ALL SUCH WARRANTIES SHALL BE LIMITED IN DURATION TO THE DURATION OF THIS EXPRESS WARRANTY.

Some states disallow the exclusion or limitation of incidental or consequential damages or how long an implied warranty lasts, so the above exclusions or limitations may not apply to you. This warranty gives you specific legal rights and you may also have other rights, which vary from state to state.

ONE (1) YEAR LIMITED WARRANTY

Brookstone® warrants this product against defects in materials and/or workmanship under normal use for a period of ONE (1) YEAR from the date of purchase by the original purchaser ("Warranty Period"). If a defect arises and a valid claim is received within the Warranty Period, at its option, Brookstone will either 1) repair the defect at no charge, using new or refurbished replacement parts, or 2) replace the product with a new product that is at least functionally equivalent to the original product, or 3) provide a store credit in the amount of the purchase price of the original product. A replacement product or part, including a user-installable part installed in accordance with instructions provided by Brookstone, assumes the remaining warranty of the original product. When a product or part is exchanged, any replacement item becomes your property and the replaced item becomes Brookstone's property. When a store credit is given, the original product must be returned to Brookstone and becomes Brookstone's property.

Obtaining Service: To obtain warranty service, call Brookstone Limited Warranty Service at 1-800-292-9819. Please be prepared to describe the product that needs service and the nature of the problem. A purchase receipt is required. All repairs and replacements must be authorized in advance. Service options, parts availability and response times will vary. You are responsible for delivery and the cost of delivery of the product or any parts to the authorized service center for replacement, per our instructions.

Limits and Exclusions: Coverage under this Limited Warranty is limited to the United States of America, including the District of Columbia and the U.S. Territories of Guam, Puerto Rico, and the U.S. Virgin Islands. This Limited Warranty applies only to products manufactured for Brookstone that can be identified by the "Brookstone" trademark, trade name, or logo affixed to them or their packaging. The Limited Warranty does not apply to any non-Brookstone products. Manufacturers or suppliers other than Brookstone may provide their own warranties to the purchaser,

CAUTION

- TO REDUCE THE RISK OF ELECTRIC SHOCK, DO NOT REMOVE COVER. THERE ARE NO SERVICEABLE PARTS INSIDE.
- TO REDUCE THE RISK OF FIRE OR ELECTRIC SHOCK, DO NOT EXPOSE THIS UNIT TO RAIN OR MOISTURE.



The lightning flash with arrow-head symbol within an equilateral triangle is intended to alert the user to the presence of uninsulated "dangerous voltage" within the unit's enclosure that may be of sufficient magnitude to constitute a risk of electric shock.



The exclamation point within an equilateral triangle is intended to alert the user to the presence of important operating and maintenance (servicing) instructions in the literature accompanying the unit.

IMPORTANT SAFETY INSTRUCTIONS

All the safety and operating instructions should be read, heeded, adhered to and followed before the unit is operated.

SAFETY AND HANDLING INFORMATION

For maximum product life, do not drop, throw or crush the speaker. Do not expose it to humidity, dust, or operating temperatures outside 32°F to 113°F (0°C to 45°C).

SAVE THESE INSTRUCTIONS!

DANGER

To reduce the risk of electric shock, burns, fire or injury:

1. Do not use while bathing or in a shower.
2. Do not place or store unit where it can fall or be pulled into a tub or sink.
3. Do not place in, drop or submerge in water or other liquid.
4. Do not reach for a unit that has fallen into water. Unplug it immediately.
5. Care should be taken so that objects do not fall and liquids are not spilled onto the unit.

WARNING

1. Close supervision is necessary when this appliance/product is used by or near children or mentally disabled individuals.
2. Use this unit only for its intended use as described in this manual.
3. Unplug this unit during lightning storms or when unused for long periods of time.
4. Never drop or insert an object into any opening.
5. Protect the power cord from being walked on or pinched, particularly at plug outlets, convenience receptacles and the point where it exits the unit.

NOTES

SPECIFICATIONS

Power Supply.....	AC 100V-240V ~ 50/60 Hz (Input) DC 18V/3.5A (Output)
Total Power Output.....	50 Watts
Range.....	Class 2, up to 33 ft (10 m)
Compatibility.....	Bluetooth 2.1 with A2DP and AVRCP
Frequency Range.....	45Hz - 20kHz
Drivers	2 x 1.5" Tweeter + 2 x 3" Mid-range driver + 1 x 4" Subwoofer
Product Weight.....	22 lbs (approximately)
Product Dimensions (Main Unit).....	7.9"l x 7.9"w x 38.2"h

- Do not allow cord to touch hot surfaces. Wrap cord loosely around the unit when storing.
- The unit should be situated away from direct sunlight or heat sources such as radiators, electric heaters, heat registers, stoves, or other units (including amplifiers) that produce heat. Avoid placing on top of stereo equipment that radiates heat.
- Never block the air openings of the unit with materials such as clothing, plastic bags or papers, or place it on a soft surface such as a bed or couch, where the air openings may be blocked.
- Do not overload the electrical outlet. Use the power source only as indicated.
- Do not carry this unit by its cord or use the cord as a handle.
- Never operate this unit if it has a damaged cord or plug, if it is not working properly, or if it has been dropped or damaged, or dropped into water. If the unit's power supply cord or plug is damaged, do not attempt to fix it yourself.
- To avoid the risk of electric shock, do not disassemble or attempt to repair the unit. Incorrect repair can cause risk of electric shock or injury to persons when the unit is used.
- Do not operate in the presence of explosive and/or flammable fumes.
- Never remove the plug from the outlet by pulling the power cord.

FCC INFORMATION

This equipment has been tested and found to comply with the limits for a Class B Digital Device, pursuant to Part 15 of the FCC Rules. These limits are designed to provide reasonable protection against harmful interference in a residential installation. This equipment generates, uses, and can radiate radio frequency energy and, if not installed and used in accordance with the instructions, may cause harmful interference to radio communications. However, there is no guarantee that interference will not occur in a particular installation.

If this equipment does cause harmful interference to radio or television reception, which can be determined by turning the equipment off and on, the user is encouraged to try to correct the interference by one or more of the following measures:

- Reorient or relocate the receiving antenna.
- Increase the distance between the equipment and receiver.
- Connect the equipment to an outlet on a circuit different from that to which the receiver is connected.
- Consult the dealer or an experienced radio/TV technician for help.

This equipment complies with Part 15 of the FCC Rules. Operation is subject to the following two conditions:

1. This equipment may not cause harmful interference.
2. This equipment must accept any interference received, including interference that may cause undesired operation.

Modifications not authorized by the manufacturer may void the user's authority to operate this device.

TROUBLESHOOTING

ISSUE	SOLUTION
Bluetooth disconnection.	Ensure your device is within 33 feet of Big Blue Tower and reconnect your device to Big Blue Tower.
Sound is not clear or there is no sound at all.	Unplug Big Blue Tower and then plug back in. Adjust your device's equalizer. Check Big Blue Tower or your device's volume level.
Music won't play on the speaker.	Make sure Big Blue Tower is plugged in. Confirm device is paired or correct source is selected. Unplug Big Blue Tower and then plug back in. Note: Big Blue Tower remembers the last device paired. If you would like to use another device, pair that device manually. Please refer to page 8 for pairing instructions.

Notes:

- To control Big Blue Media Tower volume with your TV remote, you may need to adjust your TV Audio Settings to enable external speakers. Consult your TV user manual.
- If there are no fixed-level audio outputs on your audio source, connect the Dual RCA Cable to the Y Adapter 3.5mm Cable (included) to connect to a 3.5mm jack.

USING AUX OUT

Connect other equipment or speakers by using audio cords with 3.5mm jacks to the AUX Out Port on the back of Big Blue Tower.

COMPATIBILITY

Bluetooth 2.1 or above device with A2DP and AVRCP.

LOCATION OF PARTS AND CONTROLS (MAIN UNIT)

- | | | |
|---|--------------------------------------|--------------------------|
| 1. Bluetooth® Source with LED Indicator | 4. Bass + | 9. Treble - |
| 2. Digital Source with LED Indicator | 5. Bass - | 10. Treble + |
| 3. Analog Source with LED Indicator | 6. Volume/Bass/Treble LED Indicators | 11. Power/Pairing Button |
| | 7. Volume + | 12. LED Ring |
| | 8. Volume - | |

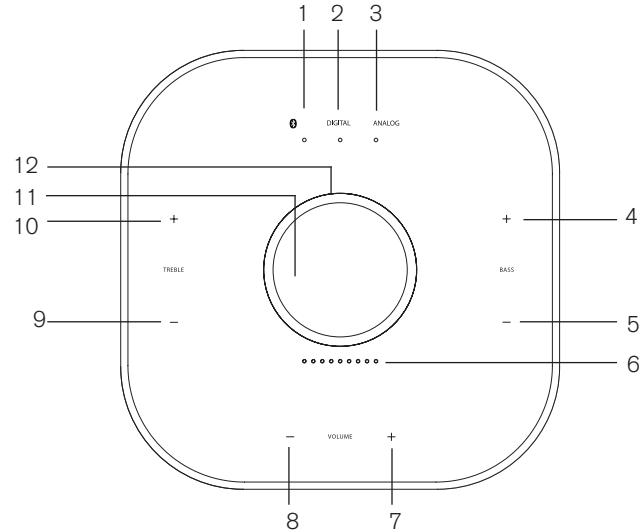

LOCATION OF PARTS AND CONTROLS (MAIN UNIT)

1. RCA In Ports
2. AUX Out Port
3. Optical In Port
4. DC In Port
5. Adapter
Output: 18V, 3.5A
Input: 100-240V AC, 50/60Hz

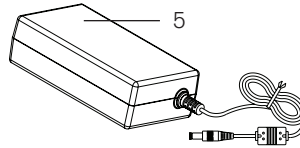
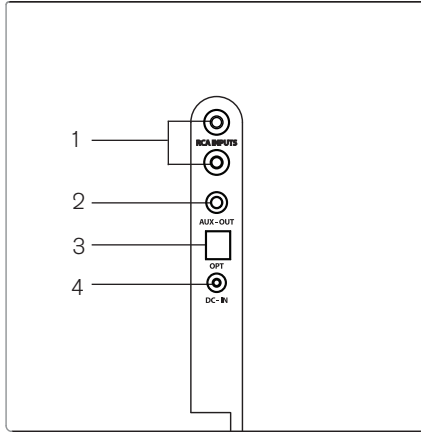

place your finger on the + or — icons continuously to increase/decrease the Treble at an accelerated rate. LEDs will indicate the Treble level is adjusting. On the remote, press the TREBLE + or TREBLE - buttons to increase/decrease the Treble.

USING OPTICAL SOURCE

Connect Big Blue Tower to your TV or other audio source using an Optical cable (included).

1. Tap the DIGITAL touch sensitive control on the main unit or press the SOURCE button on the remote to put Big Blue Tower into DIGITAL mode.
2. Plug one end of the Optical cable into the Optical Out port on the audio source.
3. Plug the other end of the cable into the Big Blue Tower port labeled OPT.
4. Control the audio volume through Big Blue Tower's touch sensitive controls or remote.

USING RCA SOURCE

Connect Big Blue Tower to your audio source using an RCA cable (included).

1. Tap the ANALOG touch sensitive control on the main unit or press the SOURCE button on the remote to put Big Blue Tower into ANALOG mode.
2. Insert one end of the Dual RCA Cable (included) into the appropriately colored R/L LINE IN jacks on audio source's left and right audio output jacks.
3. Insert the other end of the Dual RCA Cable into the appropriately colored R/L LINE IN jacks on Big Blue Tower.
4. Use your audio device to control music playback. Use your audio device and/or Big Blue Tower's touch sensitive controls or remote to control the volume.

decrease the Volume, or place your finger on the + or – icons continuously to increase/decrease the Volume at an accelerated rate. The LEDs will indicate that the Volume level is adjusting. On the remote, press the VOLUME + or VOLUME - buttons to increase/decrease the Volume.

3. Press the MUTE button on the remote to mute Big Blue Tower's sound. Press the MUTE button on the remote again to hear Big Blue Tower's sound.

BLUETOOTH DEVICE SETTINGS

Many Bluetooth Streaming Devices have their own EQ sound settings. To optimize your Big Blue Media Tower listening experience, adjust the EQ settings on your Bluetooth Streaming Device. Consult your device's user manual.

ADJUSTING BASS

1. Adjust the Bass of Big Blue Tower's sound by using the BASS touch sensitive controls on the main unit or the BASS + and BASS - buttons on the remote.
2. On the main unit, tap the BASS + or – icons to slowly increase/decrease the Bass or place your finger on the + or – icons continuously to increase/decrease the Bass at an accelerated rate. LEDs will indicate the Bass level is adjusting. On the remote, press the BASS + or BASS - buttons to increase/decrease the Bass.

ADJUSTING TREBLE

1. Adjust the Treble of Big Blue Tower's sound by using the TREBLE touch sensitive controls on the main unit or the TREBLE + and TREBLE - buttons on the remote.
2. On the main unit, tap the + or – icons to slowly increase/decrease the Treble or

LOCATION OF PARTS AND CONTROLS (REMOTE)

- | | |
|------------------|----------------|
| 1. Power Button | 6. Volume + |
| 2. Source Button | 7. Bass + |
| 3. Treble - | 8. Treble + |
| 4. Bass - | 9. Mute Button |
| 5. Volume - | |

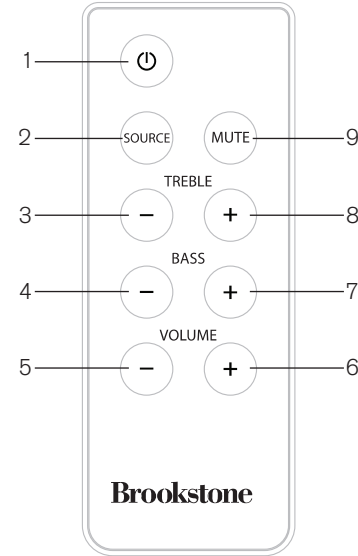

SET UP

1. Connect the ADAPTER's jack to the DC IN POWER PORT on the back of Big Blue Tower.
2. Plug the ADAPTER into an electrical outlet.

PAIRING YOUR DEVICE

1. Prepare your device to pair using Bluetooth, making sure you are within 33 feet of Big Blue Tower. Refer to your device's owner's manual for details if necessary.
2. Press the POWER/PAIRING button on the main unit or the POWER button on the remote to turn on the Big Blue Tower until the LED RING illuminates solid.
3. Tap the BLUETOOTH touch sensitive control on the main unit or press the SOURCE button on the remote to put Big Blue Tower into Bluetooth mode.
4. Press and hold the POWER/PAIRING button on the main unit until the LED RING starts pulsing.
5. The Big Blue Tower is in pairing mode when the LED RING is pulsing. Big Blue Tower will wait for a connection in pairing mode for up to 60 seconds.
6. Once Big Blue Tower is in pairing mode and your device is ready to pair, select "Big Blue Media Tower." If prompted, use 0000 as a PIN for the pairing code.
7. Once Big Blue Media Tower is selected, the LED RING will change to solid blue and two beeps will sound to confirm pairing is complete.

Note: To cancel the pairing mode either press the POWER/PAIRING button on the main unit or the POWER button on the remote to power the unit off, or wait the 60 seconds for Big Blue Tower to cancel pairing automatically. The LED RING will return to solid blue, and the unit will remain on.

USING BIG BLUE AFTER PAIRING

1. Press the POWER/PAIRING button on the main unit or the POWER button on the remote to turn on the Big Blue Tower until the LED RING illuminates solid.
2. Tap the BLUETOOTH touch sensitive control on the main unit or press the SOURCE button on the remote to put Big Blue Tower into BLUETOOTH mode.
3. Big Blue Tower should automatically remember your device. Depending upon your device, you may have to select "Big Blue Media Tower" in your device's menu.
4. To turn Big Blue Tower off, press the POWER/PAIRING button on the main unit or the POWER button on the remote.

Note: When Big Blue Tower is powered on, pressing any button will activate the function LEDs and the LED RING for 5 seconds. After 5 seconds has passed, the LEDs turn off and the LED RING remains on at a very low brightness level.

ADJUSTING VOLUME

1. Adjust the Volume of Big Blue Tower's sound by using the VOLUME touch sensitive controls on the main unit or the VOLUME + and VOLUME - buttons on the remote.
2. On the main unit, tap the VOLUME + or – icons to slowly increase/