

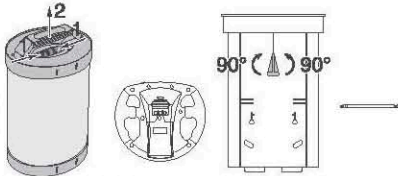

**PREPARATIONS:**

1. As shown in figure 1, press the two locks towards "OPEN" at the same time, and pull the lid and the attached pedestal out of the transparent bottle. Turn the lock that secures the remote controller for 90°, and take out the controller and antenna.



2. Use a phillips screwdriver to loosen the 3 screws at the back of the pedestal, and take off the racing car.

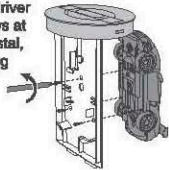

3. Install the antenna onto the controller as illustrated.



4. Loosen the screws of the battery cover of the controller and open the battery cover, install 3x "AA" batteries with the correct polarity, then replace the battery cover and tighten the screws.

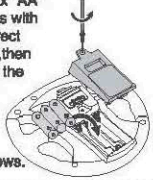

5. Unlock the battery cover on the back of the car by turning the lock for 180°, insert 3x "AA" batteries with correct polarity, replace the battery cover and lock it.

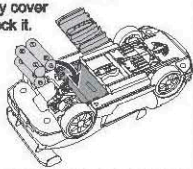

6. The car package can be stacked as shown.

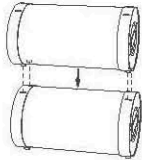

**OPERATION:**

1. Fully extend the antenna when playing; turn the power switch of the controller and the racing car to ON, and place the racing car on the ground.

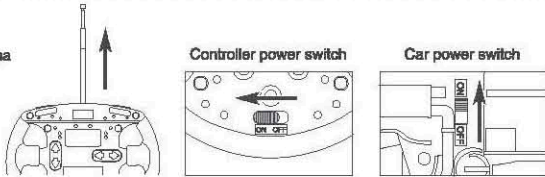

**2. Button function:**

- (1) Diagram 1 shows all buttons with name of function.
- (2) The car is in standby mode when powered on. Press Startup/Shutdown button once, the car goes into action mode and sends out idle engine sound. All other buttons will only work when the car is in the action mode. Press the Startup/Shutdown button again, the car will go back into standby mode, and all other buttons stop to work.
- (3) When in action mode, the car will go forward/backward when the Forward/Backward buttons on the remote controller are pressed. At the same time the car sends out sound simulating a real car going forward/backward, and the headlights will light when the car goes forward, the tail lamps will light when the car goes backward. While moving forward/backward, pressing the Left/Right buttons will make the car do left/right turns. At the same time the lights on the car indicates the direction of the turn.
- (4) In action mode, when the Door open button on the remote controller is pressed, the doors on the car open like illustrated in diagram 2. Pressing the Door close button will make the doors close. On some models the engine hood can be opened manually as shown in diagram 3.
- (5) In action mode, pressing the Horn button on the remote controller makes the car send out horn sound. You can choose to deactivate all sound effects. The Mute button lets you toggle the sound effects OFF and ON.
- (6) In action mode, the Function button on the remote controller can be operated to achieve the following 3 demonstrations: Demo 1: press the Function button and release it when the car beeps for ONE time, all lights and lamps on the car light. Demo 2: press the Function button for about 2 seconds and release it when the car beeps for TWO times, the car will go into a "Dancing" status, moving while sending out musical sound. Demo 3: press the Function button for about 3 seconds and release it when the car beeps for THREE times, the car will go into an "Automatic running" status, and demonstrate moving and turning without receiving signals from the controller. To exit from any of the above 3 demonstrations, press any other button on the remote controller.
- (7) The car has 4 different speeds. You can change between these 4 different speeds by using the Speed up button and the Speed down button.
- (8) The Power indicator light goes on when the controller is switched ON. The Operation indicator light goes on when any of the buttons on the remote controller is pressed.

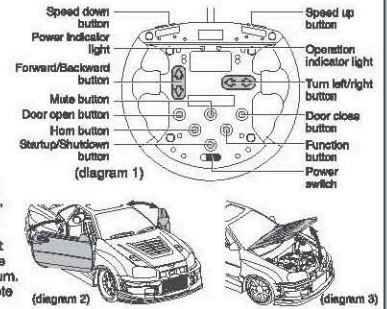

3. Use the fine adjuster on the front end of the bottom of the car to adjust of the car straight-line running performance.

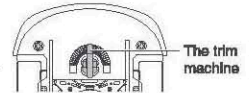

Changes or modifications not expressly approved by the party responsible for compliance could void the user's authority to operate the equipment.

**CAUTION:**

- Do not mix alkaline, standard (carbon-zinc) or rechargeable (nickel-cadmium) batteries.
- Do not mix old and new batteries.
- Only batteries of the same or equivalent type as recommended are to be used.
- Exhausted batteries should be removed from product.
- Do not dispose of batteries in fire, as batteries will explode or leak.
- The supply terminals are not to be short-circuited.
- Batteries are to be inserted with the correct polarity.
- Non-rechargeable batteries are not to be recharged.
- Rechargeable batteries are only to be charged under adult supervision.
- Remove rechargeable batteries from the product before recharging (if removable).
- Remove batteries if the product is not to be used for an extended period.
- The packaging should be kept as it contains important information.