

## MANUAL

### 1 Introduction

This document is made for system test on mass production of dongle (ASR\_030D)  
This product is intended for use in vehicle mounting

#### 1.1 Purpose

The document is to test on producers' proficiency and product's safety.

#### 1.2 Test Preparation

- To conduct the test, iPhone is required.



Caution: the case is compatible with only iPhone6 or iPod.

### 1.3 iPhone and Certification

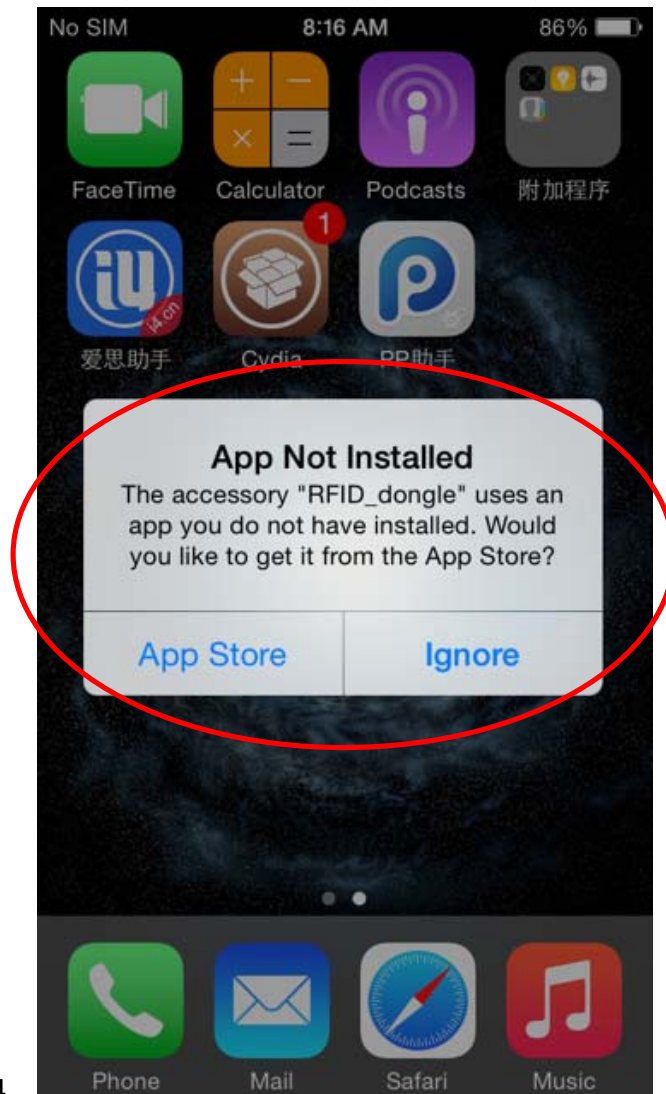

1.4

- Once iPhone is connected to lightning connector, it certifies with dongle device. After certifying, there will be pop-up to choose whether to start App or not as picture above.
- If App is not installed, there will be a sign to download it from App-store.
- When you accept the sign, the App will be launched as below.

### 1.5 Launching the App



- If iPhone and dongle device is certified properly, Unplugged mark will be changed to Plugged. And setting, read, clear, battery and stop button will be active.

## 1.6 Tag Read



- Activates the barcode engine power button, as pictured above.
- When the engine is operating normally, the buzzer sounds and the Connected displayed.
- There are two reading button. One is in App as picture above, and another is switch button on case. By pressing either button, tag information will be displayed as pictured above.



- The quantity for Tag can be set up as above.

## 1.7 Power Management



- As above, check the magcon(Magnetic) connector.



- Attaching the device to the vehicle mounts and charging begins.

\*When the charge in the state that works with the iPhone, it can be charged simultaneously with the device.



- LED will be off when charging is finished.

\* During charging can not be used .

## **1.8 Caution.**

### **1.7.1 Operation**

The device can be used over 20cm from the user.

The device will be automatically off from following situations.

- When receives a phone call, the device automatically turn off the power.
- Include a message, something pop-up by certain Apps.
- When switching from Barcode App to other App or pressing Home button.
- When pressing power button or the display automatically turns off to sleep mode or Barcode App display disappears or the display is covered by Pop-up, it will automatically off the App.

### **1.7.2 Usage**

This product is intended for use in vehicle mounting

Please do not use this product for portable use

This device complies with part 15 of the FCC Rules. Operation is subject to the following two conditions:

- (1) This device may not cause harmful interference, and
- (2) this device must accept any interference received. Including interference that may cause undesired operation

Note : This equipment has been tested and found to comply with the limits for a Class A digital device, pursuant to part 15 of the FCC Rules.

These limits are designed to provide reasonable protection against harmful interference when the equipment is operated in a commercial environment.

This equipment generates, uses, and can radiate radio frequency energy and, if not installed and used in accordance with the instruction manual, may cause harmful interference to radio communications.

Operation of this equipment in a residential area is likely to cause harmful interference in which case the user will be required to correct the interference at his own expense.

Le present appareil est conforme aux CNR d'Industrie Canada applicables aux appareils radio exempts de licence. L'exploitation est autorisee aux deux conditions suivantes :

- (1) l'appareil ne doit pas produire de brouillage, et
- (2) l'utilisateur de l'appareil doit accepter tout brouillage radioelectrique subi, meme si le brouillage est susceptible d'en compromettre le fonctionnement.

Caution: Any changes or modifications in construction of this device which are not expressly approved by the party responsible for compliance could void the user's authority to operate the equipment.

Hereby, Asterisk Inc. Declares that this ASR-0240D is in compliance with the essential requirements and other relevant provisions of directive 1999/5/EC.