

SIZE: 594*420mm

Print bleed: 3mm

AtGAMES AtGames Digital Media, Inc. www.atgames.net



HD

Instruction Manual

MODEL NO. FB3680_V2018

Genesis Flashback Game Console Appearance and Key List

The image below shows the location of the connectors and buttons. Each function is outlined below the image.

- 1 Power Turn the game console's power ON/OFF.
2 MENU Press the button to display in-game menu.
3 Volume Slider (cosmetic)
4 First Player Game Controller Jack
5 Second Player Game Controller Jack
6 Cartridge Slot
7 SD Card Slot
8 Micro-USB Adaptor Jack
9 HDMI Output

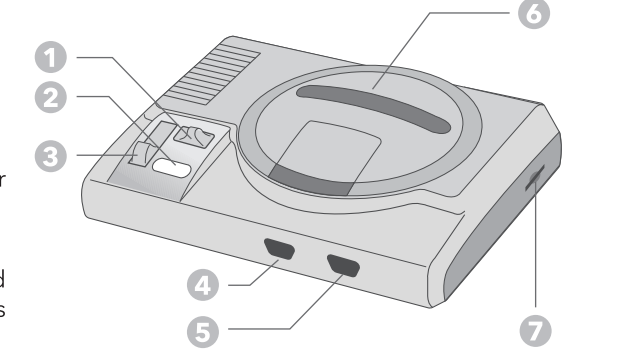

NOTE: Must use the Micro-USB adaptor included as the power supply to the console. Do not connect the Micro-USB adaptor to a power input other than the above specifications. Micro-USB adaptor is not a toy. The socket/cover should be installed near the equipment and should be easily accessible.

What do I do when the power supply is not working? You might be using the wrong Micro-USB adaptor. Please use the one included in the package, which is rated for 5V1A.

Micro-USB Adaptor Specification INPUT: 100V-240V AC/50Hz-60Hz OUTPUT: 5V1A

How to connect the console to a HD TV? Connect the game console to TV using the enclosed HDMI cable. Power on the game console after configuring the TV input to the selected HDMI source.

2.4GHz Wireless Controller Appearance and Key List

The image below shows the location of the connectors and buttons. Each function is outlined below the image.

- P1 ONLY
1 REWIND Press the button to rewind gameplay by 7 seconds.
2 MENU Press the button to display in-game menu.
3 START Press the button to start the game and press it again to pause the game.
4 Directional Pad (D-Pad) Directional Pad for game playing.
5 Power Indicator Press any key and the indicator will light up if there is still battery power left in the controller.
6 Power Turn the controller's power ON/OFF.

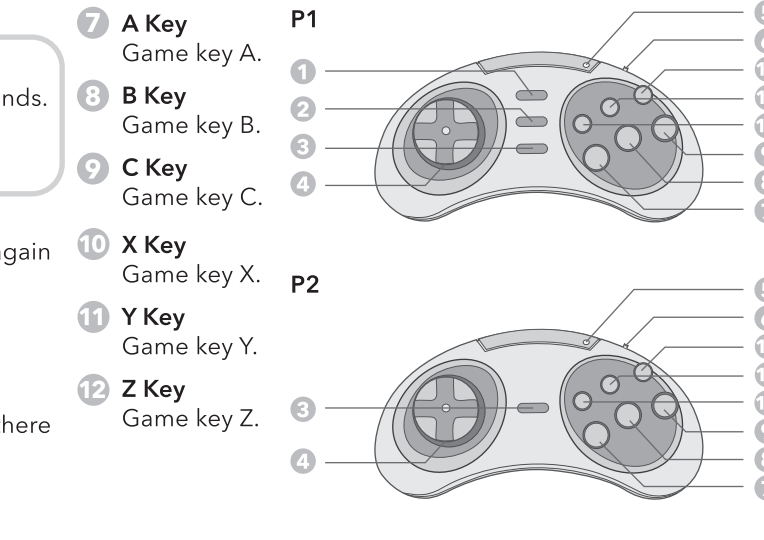

How to confirm the 2.4 GHz wireless controllers are connected to the console?

Three-step diagram showing: 1. Inserting AAA batteries into the back of the controller. 2. Pressing any button on the controller to connect to the console. 3. The power indicator lighting up. Includes a note about IR-based controllers from previous models.

What are the two controller ports on the console for? How to connect wired controllers?

These ports are for optional wired controllers. For 1 player games: Connect a wired controller to the left controller port. For 2 player games: Connect a second wired controller to the right controller port for player two.

What do I do when the controller is not working?

- 1 The batteries may have run out. Change the batteries following the 'Change the batteries for the controllers' section.
2 If you only have a controller plugged into the P2 socket, turn off your console and connect the controller to the P1 (left) controller port. Then, turn on the console and try again.

Change the batteries for the controllers

Diagram showing the battery compartment cover being pushed open and two AAA batteries being inserted with correct polarity. Includes a note about battery life and LED indicators.

HOW DO I START PLAYING?

Flowchart: Power on the game console -> Use the controller to browse menu and select game -> Press the button on the controller to enter the selected game -> Press one of these buttons to begin the game (START).

How do I go back to game menu while playing the game? Press the button to display in-game menu. Select QUIT GAME to go back to the game menu page.

How do I play two-player games?

Diagram showing two players using controllers. Step 1: Follow steps in 'How do I start playing?' section. Step 2: Press the button on the first player game controller to enter the selected game as P1. Step 3: Press the button on the second player game controller to start playing the game as P2.

HOW DO I PLAY CARTRIDGES?

Flowchart: Make sure the game console is powered off -> Insert the cartridge into the cartridge slot -> Power on the game console -> Read the game cartridge and create a temporary entry in the main menu under Cartridge Slot -> Press the button on the controller to start the cartridge game -> Return to the game cartridge after exiting.

Will the cartridge slot support all games? This product has been tested to work with a wide range of cartridge games. However, due to the overall volume and type of available cartridges, cartridge age, and other conditions that may affect functionality, not every available game will be compatible.

Using SD Card

How to upgrade the console via SD card?

- 1 Insert SD card into your PC.
2 Download firmware from AtGames Flashback Zone.
3 Change the file name to sega_update.img.
4 Place the file on the SD card.
5 Insert the SD card into your console, then turn the console on.
6 The request page will pop up once the console is turned on. Choose YES to start upgrading.
7 The console will automatically restart after the update is applied.

NOTE: 1. The request page will pop up again when the console restarts. Choose NO to return to the Main Menu. 2. Don't remove the SD Card when the console is being upgraded. 3. This product is compatible with SD cards that are 16 GB (Gigabyte) or less.

Safety Notice: Do not submerge the game console in water or expose it to extreme heat or to strong magnetic fields. Battery Safety: Never try to short-circuit the battery terminals. Rechargeable batteries are to be removed from the toy before being charged.

SEGA AND SEGA GENESIS GAMES

- Alex Kidd: High-Tech World
Alex Kidd in Miracle World
Alex Kidd in the Enchanted Castle
Alex Kidd: The Lost Stars
Alien Storm
Alienated Beast!
Arrow Flash!
Assault City
Astro Warrior
Baku Baku Animal
Bonanza Bros.
Chakan: The Forever Man
Champions World Class Soccer
Columns
Columns II
Comix Zone
Crack Down
Decap Attack
Defenders of Oasis
Dr. Robotnik's Mean Bean Machine
Dragon Crystal
ESWAT: City Under Siege
Eternal Champions
Fantasy Zone
Fantasy Zone: The Maze
Fatal Labyrinth
Flicky
Gain Ground
Golden Axe
Golden Axe II
Golden Axe III
Jewel Master
Joe & Mac: Caveman Ninja
Judge Dredd
Kenseidon
Kid Chameleon
Kung Fu Kid
Mortal Kombat
Mortal Kombat II
Mortal Kombat III
Mortal Kombat 3
The Ninja
Phantasy Star
Phantasy Star II
Phantasy Star III: Generations of Doom
Phantasy Star IV
Psycho Fox
Ristar
Shadow Dancer: The Secret of Shinobi
Shining Force: The Legacy of Great Intention
Shining Force II: The Ancient Seal
Shining in the Darkness
Shinobi III: Return of the Ninja Master
Side Pocket
Snail Maze
Sonic & Knuckles
Sonic 3D Blast
Sonic Chaos
Sonic Drift 2
Sonic Spinball
Sonic The Hedgehog
Sonic The Hedgehog 2
Sonic The Hedgehog: Triple Trouble
Super Columns
Super Real Darwin (Darwin 4081)
Super Thunder Blade
Sword Of Vermilion
Tails Adventure
The Ooze
Vectorman
Vectorman 2
Virtua Fighter 2

BONUS GAMES

- Air Hockey
Bombor
Bottle Taps Race
Cannon
Checker
Chess
Fight or Lose
Hexagons
Memory
Mr. Balls
Novel Power
Snake
Spider
Warehouse Keeper

AtGames logo and contact information. Includes ISSED Statement and FCC Statement sections.

Game Software and DATA EAST/ATA EAST logos. Includes copyright information and permission to use the software.

FCC Statement and Model No. information. Includes details about interference and regulatory compliance.

HD