

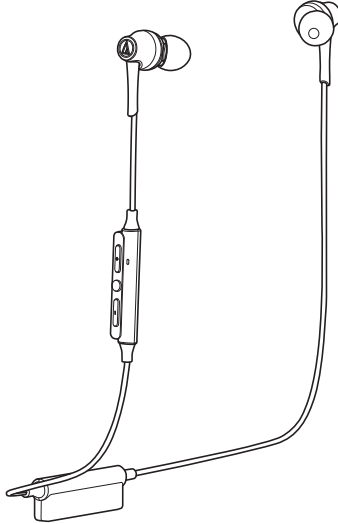

ATH-CKR75BT

User Manual
Wireless Headphones



Introduction

Thank you for purchasing this Audio-Technica product.

Before using the product, please read through the Quick Start Guide and Caution Guide, as well as this user manual when necessary, to ensure that you will use the product correctly.

Safety precautions

Although this product was designed to be used safely, failing to use it correctly may result in an accident. To ensure safety, observe all warnings and cautions while using the product.

Cautions for the product

- Do not use the product near medical equipment. Radio waves may affect cardiac pacemakers and medical electronic equipment. Do not use the product inside medical facilities.
- When using the product in aircraft, follow airline instructions.
- Do not use the product near automatic control devices such as automatic doors and fire alarms. Radio waves may affect electronic equipment and cause accidents due to malfunction.
- Do not disassemble, modify or attempt to repair the product to avoid electric shock, malfunction or fire.
- Do not subject the product to strong impact to avoid electric shock, malfunction or fire.
- Do not handle the product with wet hands to avoid electric shock or injury.
- Disconnect the product from a device if the product begins to malfunction, producing smoke, odor, heat, unwanted noise or showing other signs of damage. In such a case, contact your local Audio-Technica dealer.
- Do not allow the product to get wet to avoid electric shock or malfunction.
- Do not put foreign matter such as combustible materials, metal, or liquid in the product.
- Do not cover the product with a cloth to avoid fire or injury by overheating.
- Follow applicable laws regarding mobile phone and headphone use if using headphones while driving.
- Do not use the product in places where the inability to hear ambient sound presents a serious risk (such as at railroad crossings, train stations, and construction sites).
- The product effectively shields external sound, so you may not hear sound around you clearly while wearing the product. Adjust the volume to a level where you can still hear background sound and monitor the area around you while listening to music.
- Store the earbuds out of the reach of small children.
- When charging, make sure to use the included USB charging cable.
- Do not charge with devices that have quick-charge functionality (with a voltage of 5V or more). Doing so may cause the product to malfunction.
- To prevent damage to your hearing, do not raise the volume too high. Listening to loud sound for an extended period may cause temporary or permanent hearing loss.
- Discontinue use if skin irritation results from direct contact with the product.
- If you begin to feel unwell while using the product, discontinue use immediately.
- When removing the product from your ears, check to make sure the earbuds are still attached to the main unit. If the earbuds become lodged in your ears and you are unable to remove them, consult a physician at once.
- Temporarily discontinue use if you get itchy by its wearing stuffiness.

Safety precautions

Cautions for rechargeable battery

The product is equipped with a rechargeable battery (lithium polymer battery).

- If battery fluid gets into eyes, do not rub them. Rinse thoroughly with clean water such as tap water and consult a doctor immediately.
- If battery fluid leaks, do not touch fluid with bare hands. If fluid remains inside the product, it may cause malfunction. If battery fluid leaks, contact your local Audio-Technica dealer.
 - If fluid gets in your mouth, gargle thoroughly with clean water such as tap water and consult a doctor immediately.
 - If your skin or clothing comes in contact with fluid, immediately wash the affected skin or clothing with water. If you experience skin irritation, consult a doctor.
- To avoid leakage, generation of heat or explosion:
 - Never heat, disassemble or modify the battery, nor dispose of it in a fire.
 - Do not attempt to pierce with a nail, hit with a hammer or step on the battery.
 - Do not drop the product or subject it to strong impact.
 - Do not get the battery wet.
- Do not use, leave or store the battery in the following places:
 - Area exposed to direct sunlight or high temperatures and humidity
 - Inside of a car under the blazing sun
 - Near heat sources such as heat registers
- Charge only with the included USB cable to avoid malfunction or fire.
- The internal rechargeable battery of this product cannot be replaced by the user. The battery may have reached the end of its service life if the usage time becomes significantly shorter even after the battery has been fully charged. If this is the case, the battery needs to be repaired. Contact your local Audio-Technica dealer for repair details.
- When the product is disposed of, the built-in rechargeable battery needs to be discarded properly. Contact your local Audio-Technica dealer to learn how to properly dispose of the battery.

For customers in the USA

FCC Notice

Warning

This device complies with Part 15 of the FCC Rules.

Operation is subject to the following two conditions: (1)

This device may not cause harmful interference, and (2) this device must accept any interference received, including interference that may cause undesired operation.

Caution

You are cautioned that any changes or modifications not expressly approved in this manual could void your authority to operate this equipment.

Note: This equipment has been tested and found to comply with the limits for a Class B digital device, pursuant to part 15 of the FCC Rules. These limits are designed to provide reasonable protection against harmful interference in a residential installation. This equipment generates, uses and can radiate radio frequency energy and, if not installed and used in accordance with the instructions, may cause harmful interference to radio communications. However, there is no guarantee that interference will not occur in a particular installation. If this equipment does cause harmful interference to radio or television reception, which can be determined by turning the equipment off and on, the user is encouraged to try to correct the interference by one or more of the following measures:

- Reorient or relocate the receiving antenna.
- Increase the separation between the equipment and receiver.
- Connect the equipment to an outlet on a circuit different from that to which the receiver is connected.
- Consult the dealer or an experienced radio/TV technician for help.

RF Exposure Statement

This transmitter must not be co-located or operated in conjunction with any other antenna or transmitter used in other systems. This device complies with FCC radiation exposure limits set forth for an uncontrolled environment and meets the FCC radio frequency (RF) Exposure Guidelines. This equipment has very low levels of RF energy that is deemed to comply without testing of specific absorption rate (SAR).

For customers in Canada

IC statement

CAN ICES-3 (B)/NMB-3(B)

This device complies with INDUSTRY CANADA R.S.S. 247.

Operation is subject to the following conditions: (1) This device may not cause harmful interference, and (2) this device must accept any interference received, including interference which may cause undesired operation.

Under Industry Canada regulations, this radio transmitter may only operate using an antenna of a type and maximum (or lesser) gain approved for the transmitter by Industry Canada. To reduce potential radio interference to other users, the antenna type and its gain should be so chosen that the equivalent isotropically radiated power (e.i.r.p.) is not more than that necessary for successful communication.

This device complies with RSS-102 radiation exposure limits set forth for an uncontrolled environment.

Notes on use

- Be sure to read the connected device's user manual before use.
- Audio-Technica will not be liable in any way for any loss of data in the unlikely event that such losses should occur while using the product.
- On public transportation or in other public places, keep the volume low so as not to disturb other people.
- Minimize the volume on your device before connecting the product.
- When using the product in a dry environment, you may feel a tingling sensation in your ears. This is caused by static electricity accumulated on your body, not by product malfunction.
- Do not subject the product to strong impact.
- Do not store the product in direct sunlight, near heating devices, or in hot, humid, or dusty places. Additionally, do not allow the product to get wet.
- When the product is used for a long time, the product may become discolored due to ultraviolet light (especially direct sunlight) and wear.
- If the product is placed in a bag while the included cable or USB charging cable is still connected, the included cable or USB charging cable may become caught, severed, or broken.
- Make sure to hold the plug when connecting and disconnecting the included cable or USB charging cable. The included cable or USB charging cable may become severed or an accident may occur if you pull on the cable itself.
- When you are not using the included cable or USB charging cable, disconnect it from the product.
- This product can be used to talk on the phone only when using a mobile telephone network. Support for telephony apps that use a mobile data network is not guaranteed.
- If you use the product near an electronic device or transmitter (such as a mobile phone), unwanted noise may be heard. In this case, move the product away from the electronic device or transmitter.
- If you use the product near a TV or radio antenna, noise may be seen or heard in the television or radio signal. In this case, move the product away from the TV or radio antenna.
- To protect the built-in rechargeable battery, charge it at least once every 6 months. If too much time passes between charges, the life of the rechargeable battery may be reduced, or the rechargeable battery may no longer be able to be charged.

For a more comfortable Bluetooth communication experience

The effective communication range of this product varies depending on obstructions and radio wave conditions.

For a more enjoyable experience, please use the product as close as possible to the Bluetooth device. To minimize noise and sound disruptions, avoid placing your body or other obstacles between the product's remote and the Bluetooth device.

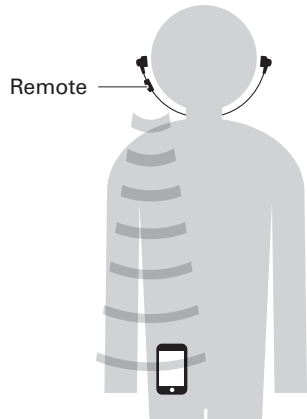

Part names and functions

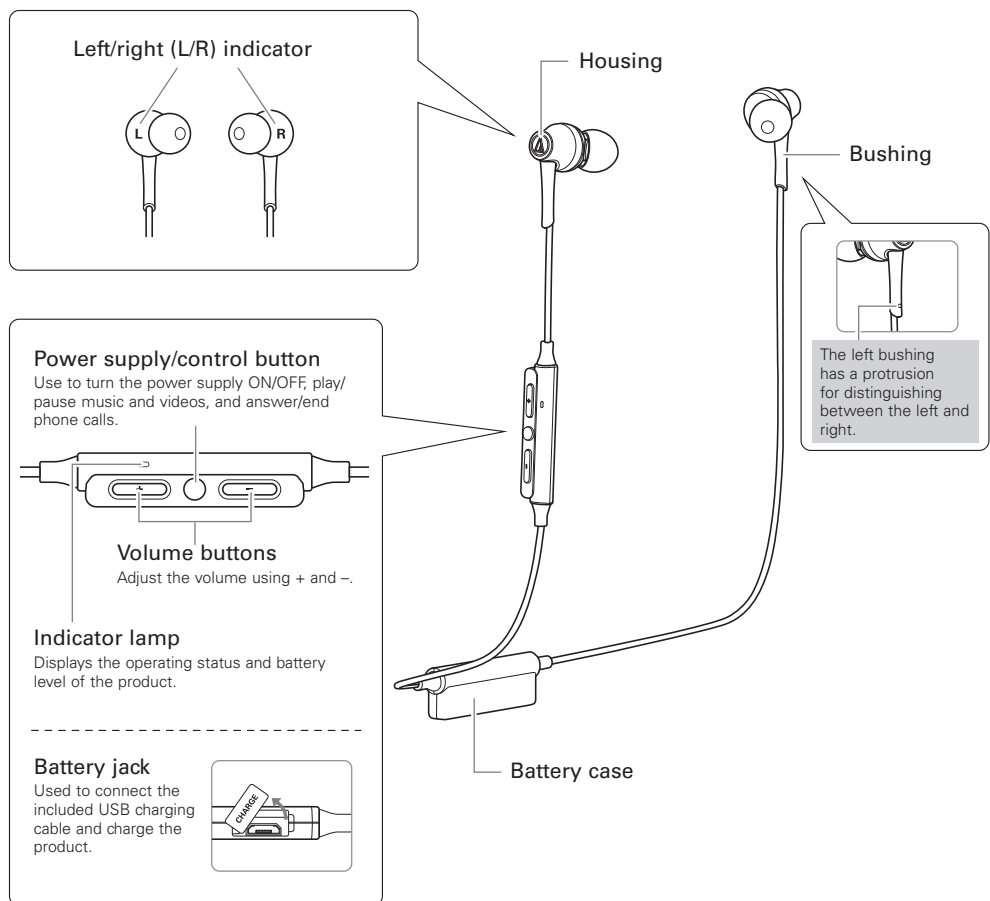

■ Included accessories

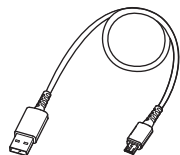

- USB charging cable (30 cm (1'))



- Eartips* (XS, S, M, L)



- Clip

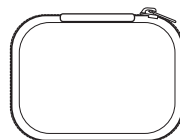

- Case

*At the time of purchase, the M-size eartips are attached to the main unit.

Charging the battery

- Fully charge the battery when using for the first time.
- When the rechargeable battery is running low, the product will sound 2 sets of 2 beeps through the headphones, and an indicator lamp will flash in red. When these beeps sound, charge the battery.
- It takes about 3 hours to charge the battery fully. (This time may vary depending on usage conditions.)
- While the battery is charging, the product's Bluetooth connection remains disabled and therefore the product cannot be used.

1. Open the battery jack cover.
2. Connect the included USB charging cable (micro USB Type B side) to the battery jack.
 - The included USB charging cable is designed for exclusive use with the product. Do not use other cables to charge the product.
 - When inserting the USB charging cable into the USB port or battery jack, check that the jack is facing in the correct direction before inserting it directly (horizontally).

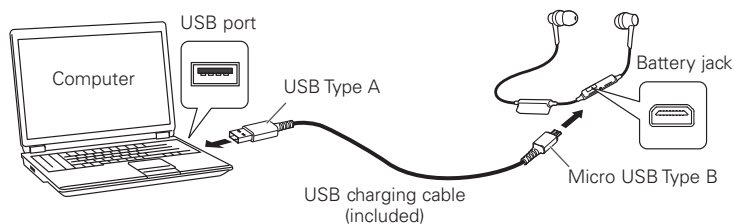

3. Connect the included USB charging cable (USB Type A side) to the computer to start charging.
 - During charging, the indicator lamp lights as follows: *
 - Lit in red: When charging
 - Lit in blue: Charging complete
 - * It may take several seconds for the indicator lamp to light.
4. When charging is complete, disconnect the USB charging cable (USB Type A side) from the computer.
5. Disconnect the USB charging cable (Micro USB Type B) from the battery jack and close the cover firmly.

Connecting via Bluetooth wireless technology

About pairing

To connect the product to a Bluetooth device, the product needs to pair (register) with the device. Once they are paired, you do not need to pair them again.

However, you will need to pair again in the following cases:

- If the product is deleted from the Bluetooth device's connection history.
- If the product is sent out for repair.

Pairing a Bluetooth device

- Read the user manual for the Bluetooth device.
 - Place the device within 1 m (3.3') of the product to perform pairing correctly.
 - To confirm the progress of the pairing process, wear the product while performing this procedure and listen for the confirmation tone.
1. Starting with the product turned off, slide the power switch to the "ON" position.
 - The indicator lamp will light in purple, and then flash in red and blue.
 2. Use your Bluetooth device to begin the pairing process and search for the product. When your Bluetooth device finds the product, "ATH-CKR75BT" will be displayed on the device.
 - For information about using your Bluetooth device, refer to the device's user manual.
 3. Select "ATH-CKR75BT" to pair the product and your Bluetooth device.
 - Some devices may ask for a passkey. In this case, enter "0000". The passkey may also be called a passcode, PIN code, PIN number, or password.
 - The product sounds a confirmation tone when pairing is complete.

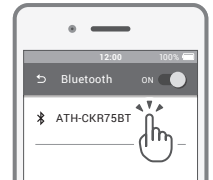

Using the product

The product can use Bluetooth wireless technology to connect to your device and play music, receive phone calls, etc. Use the product for whichever of these purposes suits your needs.

Note that Audio-Technica cannot guarantee the operation of displays, such as the battery level display, or applications via Bluetooth devices.

Power supply ON/OFF

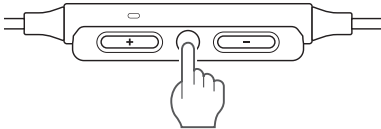
Power supply	Power switch operation		Indicator lamp
ON	Press and hold		Lights in purple, then flashes in red and blue*1*2
OFF			Lights in purple, then turns off*2

*1 It may take several seconds for the indicator lamp to light.

*2 For details, please refer to "Indicator lamp display" (p. 13).

Wearing the product

- Insert the side of the product marked "L" (LEFT) into the left ear and the side marked "R" (RIGHT) into the right ear, and then adjust the eartips.
- Wear the product so that the battery case rests on your back.
- Attach the included clip to the battery case as shown in the figure. It can be used by affixing to a shirt collar, etc.

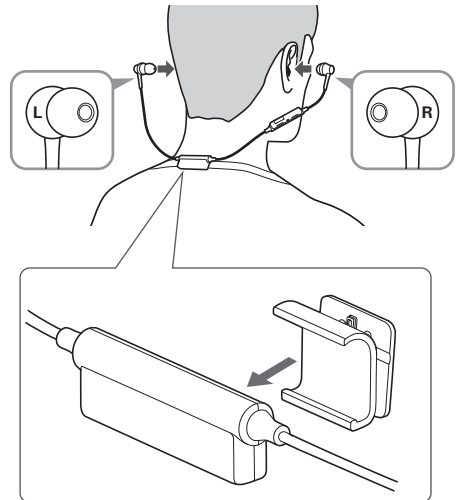

Using the product

Listening to audio

- To connect for the first time, pair the product and your device by Bluetooth wireless technology. If you have already paired the product and your Bluetooth device, turn on the Bluetooth device's Bluetooth connection and turn on the product.
- Use your Bluetooth device to start playback, referring to the device's user manual as necessary.

Power supply/Control button

Press	Play/pause	Plays or pauses music and video playback.*1
-------	-------------------	---

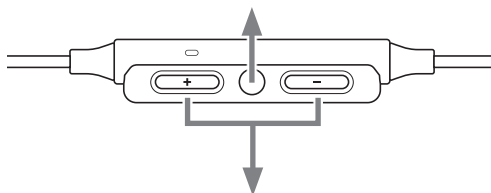

Volume buttons

+ button	Press	Volume up	Increases the volume by 1 level.*2
	Press and hold (for about 2 seconds)	Skip forward	Plays the next track.*1
- button	Press	Volume down	Decreases the volume by 1 level.*2
	Press and hold (for about 2 seconds)	Skip back	Plays the previous track.*1

*1 Some controls may not be available for music and video playback on some smartphones.

*2 A confirmation tone is heard each time you press the button. A low beep is heard when the volume is at the maximum or minimum level.

- The volume control of some devices may not work well with the product.

Using the product

Talking on the phone

- If your Bluetooth device supports telephone features, you can use the product to talk on the phone.
- When your Bluetooth device receives a phone call, the product sounds a ring tone.
- If a call is received while you are listening to music, music playback is paused. When you finish the call, music playback resumes.*¹

When	Operation	Function
Receiving a call	Press the power supply/control button.	Answers the call.
	Press and hold the power supply/control button (for about 2 seconds).	Rejects the call.
Talking on a call	Press the power supply/control button.	Ends the call.
	Press and hold the power supply/control button (for about 2 seconds). ²	Each time you press and hold the button (about 2 seconds), you switch the call to your mobile phone or to the product.* ²
	Press a volume button (+ or -).	Adjusts the volume (+ or -) of the call.

*¹ Depending on your Bluetooth device, music playback may not resume.

*² When you hear a confirmation tone, release the power supply/control button.

- The phone call controls explained above may not be available on some smartphones.

Auto power off function

The product automatically turns off after 5 minutes of not being connected to a device that has its power turned on.

Reset function

If the product does not work or other malfunctions occur, refer to "Charging the battery" (p. 5) and connect the USB charging cable. Make sure the cable is carrying power. Disconnecting and then reconnecting the USB charging cable will reset the product and should resolve any problem you are experiencing. If the problem persists, please contact your local Audio-Technica dealer.

Pressing the reset button does not change any of your settings (pairing information, volume setting, etc.).*

*The SBC priority connection (p. 13) will be disconnected.

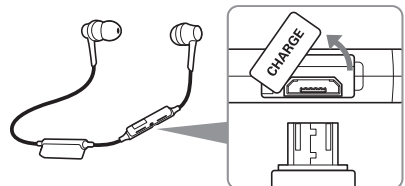

Cleaning

Get into the habit of regularly cleaning the product to ensure that it will last for a long time. Do not use alcohol, paint thinners or other solvents for cleaning purposes.

- To clean, wipe with a dry cloth.
- Natural oils from the skin are particularly likely to build up on the areas where the eartips attach to the headphones (see figure at right). If these areas are not cleaned, the eartips can become detached. Clean them regularly. Do not touch the areas where sound is produced as they are delicate. Doing so may result in malfunction.
- Wipe away any perspiration or dirt from the cable with a dry cloth immediately after use. Failure to clean the cable may cause it to deteriorate and harden over time, resulting in malfunction.
- Wipe the cable's USB plug with a dry cloth if dirty.
- Clean the eartips by removing them from the headphones and manually cleaning them with a diluted mild detergent. After cleaning, dry before using again.

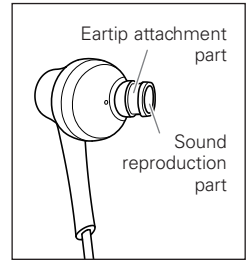

- If the product will not be used for an extended period of time, store it in a well-ventilated place free from high temperatures and humidity.

Eartips

Eartip size

The product includes silicone eartips in 4 sizes (XS, S, M, and L). At the time of purchase, the M-size silicone eartips are attached.

To ensure the best sound quality, select the eartip size that is best suited for you, and adjust the eartips inside your ears for a snug fit. It may be difficult to hear bass sounds if the eartips do not fit snugly in your ears.

Replacing the eartips

Remove the old eartip and attach the new eartip by pushing it onto the headphone at an angle (see figure).

Push firmly on the eartip so that the inside of the eartip expands, and push the eartip onto the post as far as it will go.

- The eartips are designed to be difficult to remove, therefore the fit is very tight when attaching them.

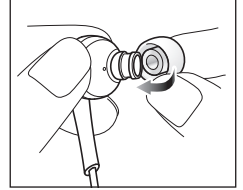

- Periodically remove and clean the eartips as they become dirty easily. Using dirty eartips may cause the headphones themselves to become dirty, resulting in deteriorated sound quality.
- Eartips are consumable parts that degrade through storage and use. If the eartips are loose and easily removed or if they appear to have degraded, purchase replacements.
- When reattaching eartips that were previously removed, be sure to check that they are securely attached. Injury or illness may occur if the eartips become detached and are left inside the ear.

Troubleshooting

Problem	Solution
Power is not supplied.	<ul style="list-style-type: none">• Charge the product.
Unable to pair.	<ul style="list-style-type: none">• Visit our website for information on compatible models.• Confirm that the Bluetooth device communicates using Ver. 2.1+EDR or higher.• Place the product and the Bluetooth device within 1 m (3.3') of each other.• Set the profiles for the Bluetooth device. For procedures on how to set profiles, refer to the Bluetooth device's user manual.
No sound is heard / Sound is faint.	<ul style="list-style-type: none">• Turn on the power of the product and the Bluetooth device.• Turn up the volume of the product and the Bluetooth device.• If the Bluetooth device is set to the HFP/HSP connection, switch to the A2DP connection.• Move away from obstacles between the product and the Bluetooth device, such as people, metal or walls, and place them closer together.• Switch the output of the Bluetooth device to the Bluetooth connection.
Sound is distorted / Noise is heard / Sound cuts out.	<ul style="list-style-type: none">• Turn down the volume of the product and the Bluetooth device.• Keep this product away from devices that emit radio waves such as microwaves and wireless routers.• Keep TVs, radios, and devices with built-in tuners away from the product. These devices can also be affected by the product.• Turn off the equalizer settings of the Bluetooth device.• Remove obstacles between the product and the Bluetooth device and place them closer together.• Adjust your Bluetooth device's settings to disable the aptX codec.
Cannot hear the voice of the caller / Voice of the caller is too quiet.	<ul style="list-style-type: none">• Turn on the power of the product and the Bluetooth device.• Turn up the volume of the product and the Bluetooth device.• If the Bluetooth device is set to the A2DP connection, switch to the HFP/HSP connection.• Switch the output of the Bluetooth device to the Bluetooth connection.
The product cannot be charged.	<ul style="list-style-type: none">• Securely connect the included USB charging cable and charge the product.
Sound is delayed (video and audio are out of sync).	<ul style="list-style-type: none">• Refer to "SBC priority connections (measures for when sound is delayed significantly)" (p. 13) to change the codec connection to SBC.

- For details about how to operate your Bluetooth device, refer to the device's user manual.
- If the problem still remains, reset the product. To reset the product, refer to "Reset function"(p. 9).

Specifications

Headphones

Type	Dynamic
Driver	11.8 mm
Sensitivity	108 dB/mW
Frequency response	5 to 40,000 Hz
Impedance	19 ohms

Microphone

Type	Electret condenser
Polar pattern	Omnidirectional
Sensitivity	-44 dB (1 V/Pa, at 1 kHz)
Frequency response	100 to 10,000 Hz

Communication specifications

Communication system	Bluetooth version 4.1
RF output	0.7 mW EIRP
Maximum communication range	Line of sight - approx. 10 m (33')
Frequency band	2.402 GHz to 2.480 GHz
Modulation method	FHSS
Compatible Bluetooth profiles	A2DP, AVRCP, HFP, HSP
Support codec	Qualcomm® aptX™ audio, AAC, SBC
Supported content protection method	SCMS-T
Transmission band	20 to 20,000 Hz

Other

Power supply	DC 3.7 V lithium polymer battery
Charging time	Approx. 3 hours*
Operating time	Continuous transmission time (music playback): Max. approx. 7 hours* Continuous standby time: Max. approx. 200 hours*
Weight	17.8 g (0.63 oz)
Operating temperature	5°C to 40°C (41° F to 104°F)
Included accessories	<ul style="list-style-type: none">• USB charging cable (30 cm (1') USB Type A / Micro USB Type B)• Eartips (XS, S, M, L)• Clip• Case
Sold separately	<ul style="list-style-type: none">• Eartips

* The above figures depend on operating conditions.

For product improvement, the product is subject to modification without notice.

- The **Bluetooth**® word mark and logos are owned by Bluetooth SIG, Inc. and any use of such marks by Audio-Technica Corporation is under license. All other trademarks are property of their respective owners.
- "AAC" logo is a trademark of Dolby Laboratories.
- Qualcomm is a trademark of Qualcomm Incorporated, registered in the United States and other countries, used with permission aptX is a trademark of Qualcomm Technologies International, Ltd., registered in the United States and other countries, used with permission.

