

AudioSource®

S3D60



Soundbar w/sonic emotion 3D Sound

Quick Start Guide

Congratulations on your purchase of the AudioSource® S3D60 Soundbar the latest in 3D Audio Home Theater technology.

Included in box: S3D60 Sound Bar, Credit Card Style Remote (Battery Included), Product Manual, Quick Start Guide

Installation Sequence

- 1 Connect Source**
A single cable is needed per source.
See table below for common connection types & installation locations.
- 2 Plug power adaptor into rear of sound bar**
- 3 Plug power adaptor into wall outlet**
- 4 Press power button**
- 5 Select source**
- 6 Adjust to desired volume**
- 7 Select mode best suited to source**

Rear Panel

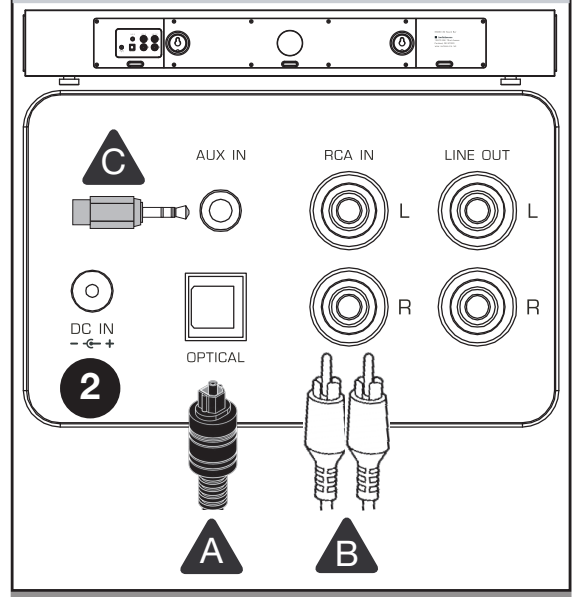

1 Compatible Sources

(Only a single cable is used per source)



Flat Panel TV

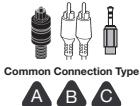

Computer



Game Console

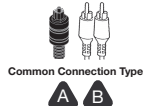

CD / DVD Player

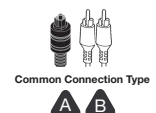

Laptop

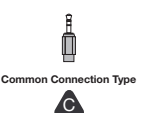

MP3 Player / Cell Phone

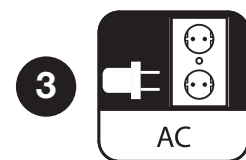

3

Front Panel

